



検具用トグルクランプ -ハンドル立-

TOGGLE CLAMPS FOR CHECKING FIXTURE

-VERTICAL HANDLE-

Fixed Bottom-Vertical Handle Type

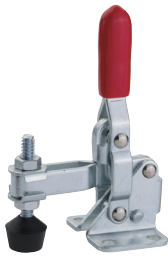

(Clamped)

JQ101A

Catalog No.	JQ101A
Material	SS400
Handle material	PVC (Polyvinyl Chloride)
Surface Treatment	Chromate
Tightening force (N)	490
Weight (g)	60
Handle open-close angle	100°
Arm open-close angle	56°
Accessory	Bolt with rubber
Mounting bolt	M4

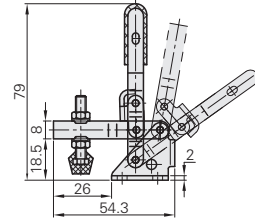
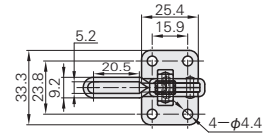

Fixed Bottom-Vertical Handle Type

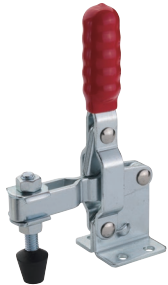

(Clamped)

JQ101D

Catalog No.	JQ101D
Material	SS400
Handle material	PVC (Polyvinyl Chloride)
Surface Treatment	Chromate
Tightening force (N)	1764
Weight (g)	330
Handle open-close angle	100°
Arm open-close angle	60°
Accessory	Bolt with rubber
Mounting bolt	M5

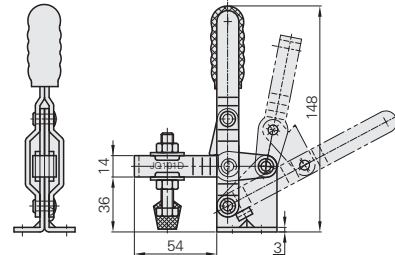
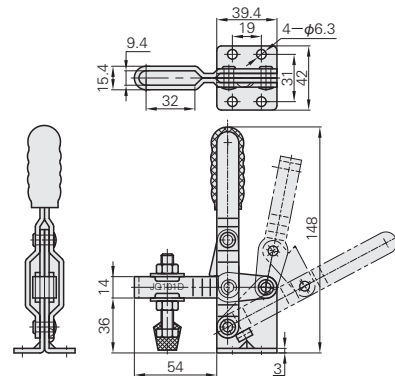

Fixed Bottom-Vertical Handle Type

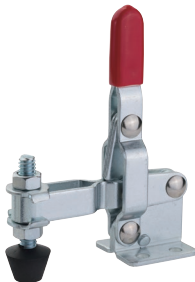

(Clamped)

JQ102B

Catalog No.	JQ102B
Material	SS400
Handle material	PVC (Polyvinyl Chloride)
Surface Treatment	Chromate
Tightening force (N)	980
Weight (g)	115
Handle open-close angle	100°
Arm open-close angle	65°
Accessory	Bolt with rubber
Mounting bolt	M4

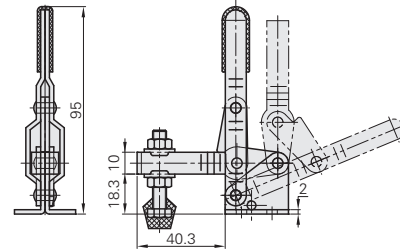
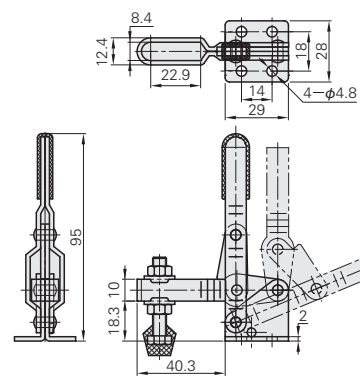

Fixed Bottom-Vertical Handle Type



(Clamped)

JQ12130

Catalog No.	JQ12130
Material	SS400
Handle material	PVC (Polyvinyl Chloride)
Surface Treatment	Chromate
Tightening force (N)	2225
Weight (g)	335
Handle open-close angle	100°
Arm open-close angle	60°
Accessory	Bolt with rubber
Mounting bolt	M6

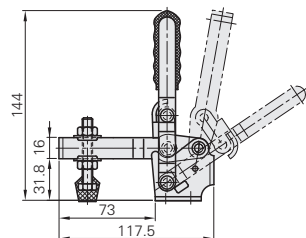
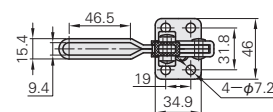

TOGGLE CLAMPS
FOR CHECKING FIXTURE