

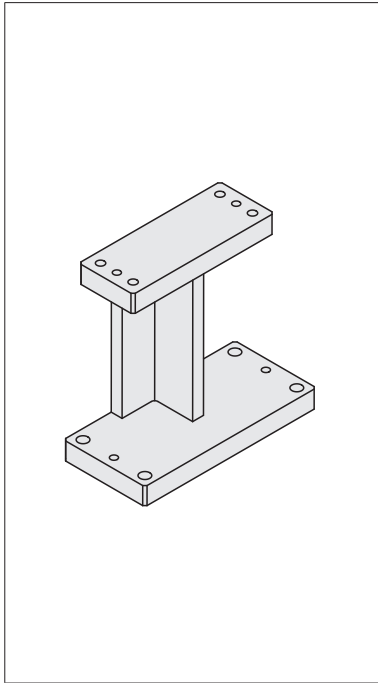

スチール/スチール鋳造回転ユニット用I型スタンド -スチール-

I SHAPE SUPPORT FOR STEEL / CAST STEEL FLIP COMPONENTS

-STEEL-



GZSZ

(W=50)

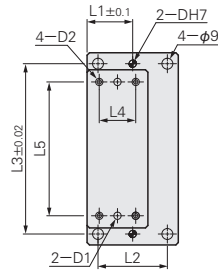

(W=80)

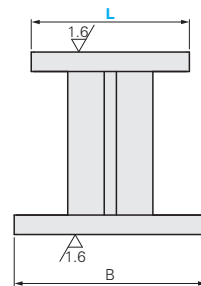
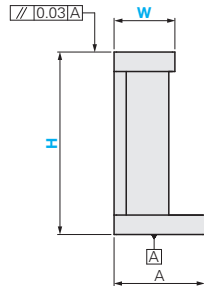
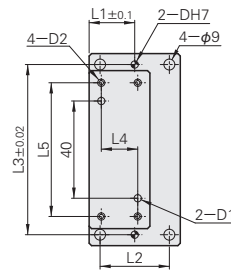

M Material SS400
S Surface Treatment Nickel coating

STAND COMPONENTS

Catalog No.		L	H						L1	L2	L3	L4	L5	D	D1	D2	A	B	
Type	W		100	125	150	175	200	225											250
GZSZ	50	94	100	125	150	175	200	225	250	32.5	45	106	23	78	6	5.8	M6	65	124
		130	100	125	150	175	200	225	250	37.5	57	140	30	110	6	5.8	M8	75	158
	80	112	100	150	200	250	300	51	80	130	63	70	8	7.8	M8	100	148		



Order

Catalog No. — L — H
GZSZ 80 — 112 — 200



Alterations



Catalog No. — L — H — (NBB)
GZSZ 80 — 112 — 200 — NBB



Delivery

Quotation

Alterations	Code	Spec.
<p>No hole for top surface</p>	NBB	No hole for top surface



Example

The top side can be used for mounting various components or serves as the supporting structure.
*Applicable to UZGLM and WSCWM80 series;
*By selecting the “-NBB” alteration (no hole for top surface), components of other specifications or non-standard products may also be mounted through punched holes according to actual circumstances.

