

HYDRAULIC CYLINDER - COMPACT

— Compact (Switch Mounted Double Rod Type) SD 70 • 140kgf/cm² Basic Type —



K-HCMGW-SD70 / K-HCMGW-SD140

[IS]

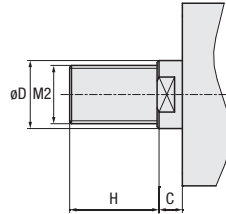

[IN]

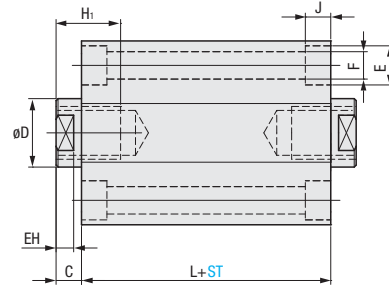
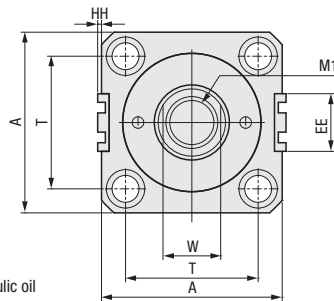
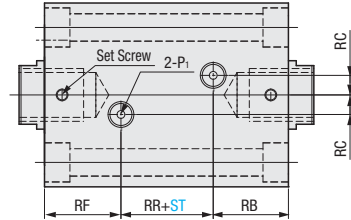

Body (tube) : SUS303
 Rod : S45C+Cr plating
 Piston : AL7075
 Rod End Cap : AL7075
 Applicable operating fluid : General mineral hydraulic oil
 Operating pressure range : 3~70(140)kgf/cm²
 Operating speed range : 8~100mm/sec
 Operating temperature range : -10~80°C

Component : 2 lock nuts
 (IS Type Only)
 2 Auto Switches

Internal Diameter	Rod B Type				A	T	W	L	H ₁	C	EH	E	F	J	RR	RF	RB	RC	P ₁	HH	EE
	D	H	M1	M2																	
32	18	25	M12×P1.75	M16×P1.5	62	47	14	87	15	10	7	11	6.6	6.5	31	28	28	10	PT1/4	2	23
40	22	30	M16×P2	M20×P1.5	70	52	19	87	20	10	7	14	9	8.6	33	27	27	10	PT1/4	2	26
50	28	35	M20×P2.5	M24×P1.5	80	58	24	90	24	11	8	17.5	11	10.8	34	28	28	10	PT1/4	2	30
63	35	45	M27×P3	M30×P1.5	94	69	30	97	33	13	9	20	14	13	37	30	30	10	PT1/4	2	30
80	45	60	M30×P3.5	M39×P1.5	114	86	41	110	36	17	14	23	16	15.2	40	35	35	15	PT3/8	2	30
100	55	75	M39×P4	M48×P1.5	140	105	50	150	45	20	14	26	18	17.5	50	50	50	18	PT1/2	1	30
125	70	95	M48×P5	M64×P2.0	170	130	65	190	50	25	18	32	22	21.5	50	70	70	23	PT3/4	1	30

Part Number		Internal Diameter	1mm increments	Rod End	
TYPE	No.			ST	M
					Female Screw
K-HCMGW (Switch Mounted Double Rod Type)	SD70 SD140	32	5 ≤ ST ≤ 200	IN	IS
		40			
		50			
		63			
		80			
		100			
		125			

* The K-HCMGW type has two default auto switches mounted on the right. If you want to change the quantity of the auto switch, please contact us.



Order

Part Number	Internal Diameter	ST	M
K-HCMGW-SD70	40	80	IN
K-HCMGW-SD140	50	100	IS



Days to Ship

Quotation

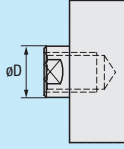
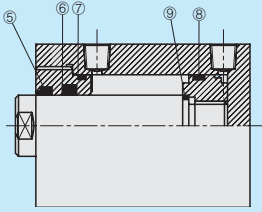
Alterations	Code	Spec.																																															
	CRD	<p>CRD = Rod C series</p> <table border="1"> <thead> <tr> <th rowspan="2">Internal Diameter</th> <th colspan="5">Rod C Type</th> </tr> <tr> <th>D</th> <th>H</th> <th>M1</th> <th>M2</th> <th>W</th> </tr> </thead> <tbody> <tr> <td>40</td> <td>18</td> <td>25</td> <td>M12×P1.75</td> <td>M16×P1.5</td> <td>14</td> </tr> <tr> <td>50</td> <td>22</td> <td>30</td> <td>M16×P2</td> <td>M20×P1.5</td> <td>19</td> </tr> <tr> <td>63</td> <td>28</td> <td>35</td> <td>M20×P2.5</td> <td>M24×P1.5</td> <td>24</td> </tr> <tr> <td>80</td> <td>35</td> <td>45</td> <td>M27×P3</td> <td>M30×P1.5</td> <td>30</td> </tr> <tr> <td>100</td> <td>45</td> <td>60</td> <td>M30×P3.5</td> <td>M39×P1.5</td> <td>41</td> </tr> <tr> <td>125</td> <td>55</td> <td>75</td> <td>M39×P4</td> <td>M48×P1.5</td> <td>50</td> </tr> </tbody> </table> <p>⊗ Internal diameter 32 is not available</p>	Internal Diameter	Rod C Type					D	H	M1	M2	W	40	18	25	M12×P1.75	M16×P1.5	14	50	22	30	M16×P2	M20×P1.5	19	63	28	35	M20×P2.5	M24×P1.5	24	80	35	45	M27×P3	M30×P1.5	30	100	45	60	M30×P3.5	M39×P1.5	41	125	55	75	M39×P4	M48×P1.5	50
Internal Diameter	Rod C Type																																																
	D	H	M1	M2	W																																												
40	18	25	M12×P1.75	M16×P1.5	14																																												
50	22	30	M16×P2	M20×P1.5	19																																												
63	28	35	M20×P2.5	M24×P1.5	24																																												
80	35	45	M27×P3	M30×P1.5	30																																												
100	45	60	M30×P3.5	M39×P1.5	41																																												
125	55	75	M39×P4	M48×P1.5	50																																												
	VIT	<p>VIT = Fluorine rubber seal change for high temperature Ⓢ Destruction temperature is 120°C</p>																																															



 **Part Number**
 K-HCMGW-SD70 — 40 — 80 — IN — CRD
 K-HCMGW-SD140 — 50 — 100 — IS — CRD — VIT

Quotation

<Specifications of auto switch>

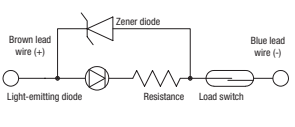
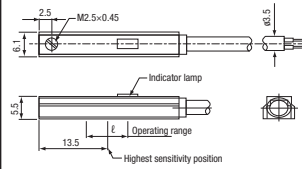
W13H	
	
Usage	Relay, PLC
Load voltage	DC 24V AC 110V
Load current range	5-40mA 5-20mA
Internal voltage drop	3V or less
Indicator lamp	On when red LED turns on
Lead wire length	1m



Part Number
W13H



Quotation

* The default packaging quantity is 1. Please purchase two switches when purchase of 1 hydraulic cylinder.

* Short strokes such as ST5~30 are replaced with low sensitivity switch.

* Please contact us while changing the lead wire length.

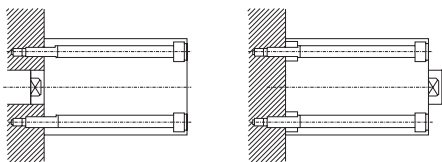
■ Mounting method



■ Terms & Conditions:

- Ⓢ Warranty period: 1 year (based on the date of MISUMI shipment)
 ※ Check the warranty policy for details.
- Ⓢ If the internal part of the cylinder is damaged due to the use of contaminated oil (mixing iron, chips, etc.), repair cost will be charged regardless of the warranty period.
- Ⓢ For the buckling load, please check reference data.
- Ⓢ At the time of mounting, please align the centre of the rod's axis with the direction of load's motion accurately. If the centre is shifted, it may cause malfunction, leakage, packing damage and cylinder damage.
- Ⓢ When using extreme cold, extreme high temperature, extreme low pressure, and extreme high pressure, please contact us before ordering. Packing and seal changes are required depending on the environment.
- Ⓢ If a problem occurs during use, send the hydraulic cylinder without disassembling it for easy identification.