

S45C
HPM1 equivalent
SKD61

SPRUE BUSHINGS

—OLD JIS B TYPE—

Non JIS material definition is listed on P.1351 - 1352

Sprue Bushings
Locating Rings

Electroforming P.773

Details of string eliminator P.747

— Straight type —



RoHS

Part Number		M	H
Normal	String eliminator type		
SJBC	SJBCH	S45C	—
SJBM	SJBMH	HPM1 equivalent	37~43HRC
SJBD	SJBDH	SKD61	48~52HRC

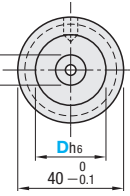
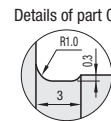
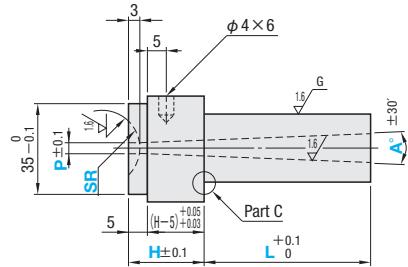

— Tapered type —



RoHS

Part Number		M	H
Normal	String eliminator type		
SJTC	SJTCH	S45C	—
SJTM	SJTMH	HPM1 equivalent	37~43HRC
SJTD	SJTDH	SKD61	48~52HRC

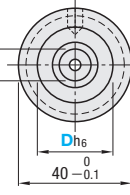
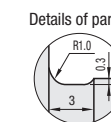
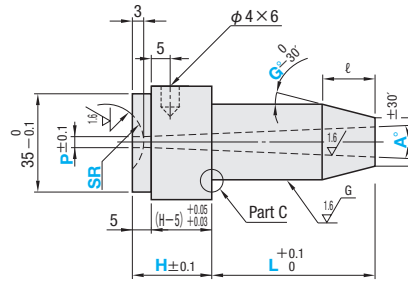

D _{h6}	Part Number		D	H	L ^{(*)2} 0.1mm increments	SR	P	A°	V	G°
	Type									
10 0 -0.009	— Straight type —		10	25	0~120.0	0	2 ^(*)3,4)	—	—	—
	Normal	String eliminator type								
	(S45C)	SJBC SJBCH								
	(HPM1 equivalent) (SKD61)	SJBM SJBMH SJBD SJBDH								
12	— Tapered type —		12	30	0~150.0	10.5	2.5 ^(*)3)	1~4 ^(*)3)	D > V ≥ α + 2	1~10
	Normal	String eliminator type								
	(S45C)	SJTC SJTCH								
	(HPM1 equivalent) (SKD61)	SJTM SJTMH SJTD SJTDH								
13 0 -0.011	— Straight type —		13	25	0~150.0	11	3 ^(*)3)	—	—	—
	Normal	String eliminator type								
	(S45C)	SJTC SJTCH								
	(HPM1 equivalent) (SKD61)	SJTM SJTMH SJTD SJTDH								
16	— Tapered type —		16	30	0~200.0	12	3.5	1~4 ^(*)3)	D > V ≥ α + 2	1~10
	Normal	String eliminator type								
	(S45C)	SJTC SJTCH								
	(HPM1 equivalent) (SKD61)	SJTM SJTMH SJTD SJTDH								
20	— Straight type —		20	25	0~200.0	13	4	—	—	—
	Normal	String eliminator type								
	(S45C)	SJTC SJTCH								
	(HPM1 equivalent) (SKD61)	SJTM SJTMH SJTD SJTDH								

(*)1 The value of α is set in accordance with L dimension. (*)2 L dimension is restricted by P, V and A. (*)3 L dimension limits. Working limits. Conversion Chart of Trigonometric Functions P.1337. Straight type: D - α ≥ 2 (Calculation of α value) α = P + 2(L + (U + H - 3)tan(A/2)). Tapered type: U: with ZC alteration. V - α ≥ 2. L - ℓ ≥ 3 (Calculation of ℓ value) ℓ = (D - V) / (2tan(G - 0.25)). *0.25 is a value that takes G tolerance into account.

Order Part Number — H — L — SR — P — A — V — G

SJBM16 — 25 — 42.0 — SR12 — P3.5 — A3 — V — G

SJTC 20 — 25 — 60.0 — SR11 — P3.5 — A3 — V16.0 — G5

Days to Ship **Quotation**

Price **Quotation**

Alterations Part Number — H — L — SR — P — A — V — G — (AIW · AXW · etc.)

SJBCH20 — 25 — 60.01 — SR11 — P3.5 — A3 — LKC-KC-AIW10-GC10

Quotation

Alterations	Code	AIW	AHW	AXW	ATW	AJW	AKW	AEW	ALW	APW	AUW	ACW	Spec.
Shape A (Trapezoid)	Spec.												• W dimension and GC° selection
	1Code	Quotation											
Designation method AIW10—GC7 Combination with ZC not available. ATW, AJW, AKW, AEW, ALW APW, AUW and ACW have working limits as follows. When D=10, (α - 0.6) ≥ W. When D ≥ 12, (α - 0.4) ≥ W.													
Designation method AHW4—GC7 "Specify in the sequence (shape) (W dimension)—GC°". If you do not make a specification, (AHW4, for example) will be 10°.													

Alterations	Code	BIR	BHR	BXR	BTR	BJR	BKR	BER	BLR	BPR	BUR	BCR	Spec.
Shape B (Semicircle)	Spec.												• R dimension selection
	1Code	Quotation											
Designation method BXR2 Combination with ZC not available. BTR, BJR, BKR, BER, BLR, BPR, BUR and BCR have working limits as follows. When D=10, (α - 0.6) ≥ 2×R. When D ≥ 12, (α - 0.4) ≥ 2×R.													

Alterations	Code	CIQ	CHQ	CXQ	CTQ	CJQ	CKQ	CEQ	CLQ	CPQ	CUQ	CCQ	Spec.
Shape C (Arc+Tangent)	Spec.												• Q dimension selection
	1Code	Quotation											
Designation method CTQ5 Combination with ZC not available. CTQ, CJQ, CKQ, CEQ, CLQ, CPQ, CUQ and CCQ have working limits as follows. When D=10, (α - 0.6) ≥ Q × 1.09. When D ≥ 12, (α - 0.4) ≥ Q × 1.09.													

Alterations	Code	Spec.	1Code
	KC	Adds a key flat on the head.	Quotation
	WKC	Adds two parallel flats on the head.	
	ZC	Undercut machining S, T, U = 0.1mm increments. S ≥ α + 2. α + 2 ≤ T ≤ D - 2(U + tan G). 1.5 ≤ U ≤ 5. L max ≥ L + U. Designation method ZC—S3.5—T4.0—U2.0.	

Alterations	Code	Spec.	1Code
	GKC	Changes the G tolerance. G ₀₋₃₀ → G ₀₋₁₅ . Available for tapered type when ℓ ≤ 15 and (L - ℓ) ≥ 10. Combination with ZC not available.	Quotation
	LKC	L dimension tolerance alteration. L _{+0.1} → L _{0-0.02} . L dimension can be designated at 0.01mm increments when LKC is used. Combination with ZC not available.	
	RC	The step R is processed in the tip bore to prevent the connection between the sprue and the runner from breaking when releasing from the mold. Dimension selection of step R: 1, 2. The step R is cut with an inner R cutter. Surface roughness and position precision are not provided. Available for α ≥ 5. Straight type: D - α - (2×RC) > 2. Tapered type: V - α - (2×RC) > 2. Combination with shapes A, B and C not available. Combination with ZC not available.	