

# Cable Carriers

## Slit Type



Outer Radius Mount Main Body + Flange	Inner Radius Mount Main Body + Flange
SE045F	SZ045F
SE08F	SZ08F
SE14F	SZ14F
SE16F	SZ16F

- <Cautions>**
- ⓘ A package includes a cable carrier assembled with specified number of links and two corresponding flanges (1 Moving End + 1 Fixed End).
  - ⓘ Install the flange fixed end on the lower side, and moving end on the upper side. (Refer to the Positional Relationship in External Dimension Diagram)
  - ⓘ Insert cables through slits (openings) on the outer or inner circumference.

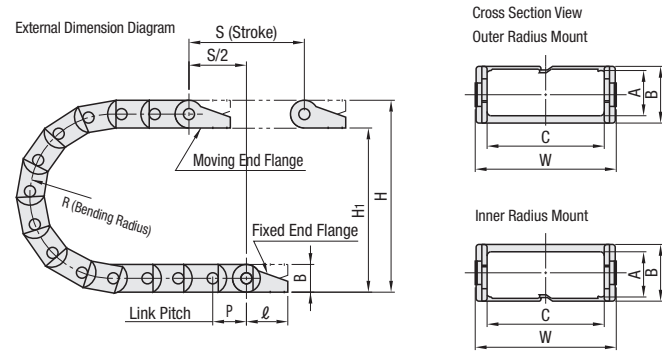

Cable link assembly is not required. **RoHS10**

Material : Special Plastic Operating Temp: -30°C ~ 100°C Flammability Standard UL94-V2

### Flange Dimension Diagram

#### SE045F, SZ045F

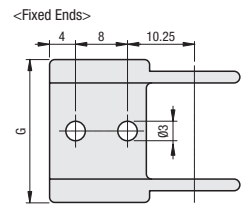
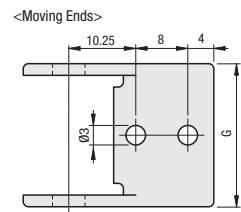

#### SE16F, SZ16F

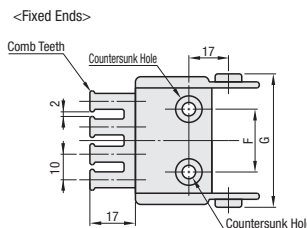
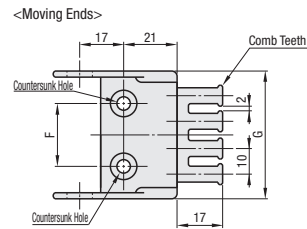

#### SE08F, SZ08F

\* The only bracket type available for SE08F/SZ08F-16 and SE08F/SZ08F-20 is the type with two center holes.

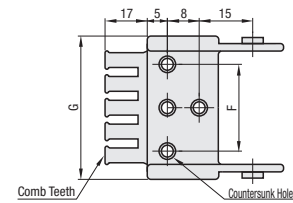
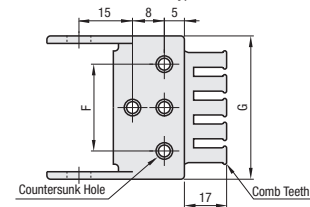

#### SE14F, SZ14F

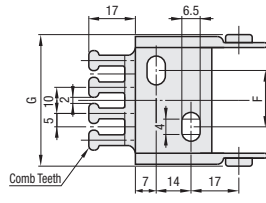
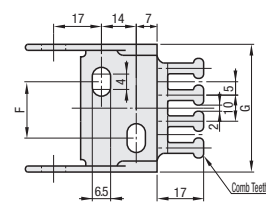

### Detail of Countersunk Hole

• For SE08, SZ08

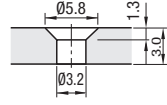

• For SE16, SZ16

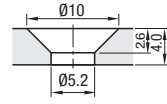

### Inserting Cables



### Removing Cables



The cable can be removed by just pulling out.

Part Number Type	No.	Bending Radius Selection	Number of Links	H (Mounting Height)	H1	HF (Required Physical Height)	K (Arc + Margin)	P	B	ℓ
SE045F SZ045F	16	018	1~27	48.5	36	58.5	85	13	12.5	22.3
		028	1~29	68.5	56	78.5	115			
		038	1~31	88.5	76	98.5	150			
SE08F SZ08F	16 20 30 40 50	028	1~37	75	55	90	130	20	19.3	28
		038	1~38	95	75	110	160			
		048	1~40	115	95	130	195			
		028	1~30	81	56	91	150			
		038	1~30	101	76	111	185			
SE14F SZ14F	1 2 3 4	048	1~30	121	96	131	215	30.5	25	38
		075	1~30	175	150	185	300			
		100	1~33	225	200	235	380			
		060	1~30	159	120	174	250			
SE16F SZ16F	2 3 4	075	1~30	189	150	204	300	30.5	39	38
		100	1~33	239	200	254	380			

Part Number Type	No.	Bending Radius Selection	A	B	C	D	E	W	F	G	Number of Comb Teeth	Weight per Link (g)	Unit Price (One Link Unit Price x Number of Links) + Flange Price (2 pcs.)
SE045F SZ045F	16	018 028 038	9.4	12.5	16	-	-	23	-	22	-	1.4	
		20			-	-	24.2	-	24.2	2	4.8		
		30			-	-	28.2	-	28.2	2	5.0		
SE08F SZ08F	16 20 30 40 50	028 038 048	14.6	19.3	30	-	-	38.2	22	38.2	3	5.6	
					40	-	-	48.2	32	48.2	4	6.2	
					50	-	-	58.2	42	58.2	5	7.4	
					1	-	-	27	-	26.3	2	9.3	
					2	-	-	37	10	36.3	3	9.6	
SE14F SZ14F	1 2 3 4	028 038 048 075 100	19	25	38	-	-	50	23	49.3	4	12	
					50	-	-	62	35	61.3	5	13	
					2	-	-	37.5	12	35.5	3	15.5	
					3	-	-	50.5	25	48.5	4	17.3	
SE16F SZ16F	2 3 4	060 075 100	32	39	48	-	-	62.5	37	60.5	5	18.8	

### Flange and Cable Securing Methods

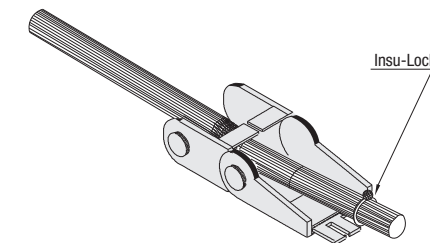

### Mounting Direction

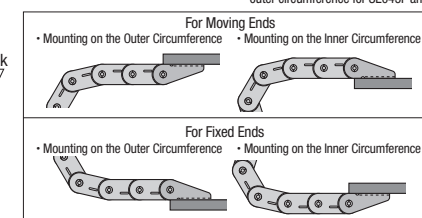

Common to Mounting on the Outer and Inner Circumferences; however, can not be mounted on the outer circumference for SE045F and SZ045F.

ⓘ In the case of new designs, there may be a possibility that carrier links run short. It is recommended that links are selected longer by one or two links, and are adjusted (removed) at the time of installing (removing) device.

Cables are inserted in from the outer and inner circumference, and its end comb teeth are fixed in place with cable ties.

Ordering Example: Part Number - Bending Radius - Number of Links  
SE14F-3 - 048 - 20