

Ordering Example Part Number (Type-No.)
C-MGCE2

Magnetic Catches

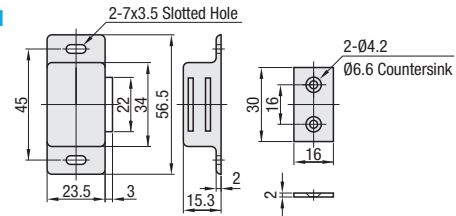

C-MGCE1



C-MGCE2

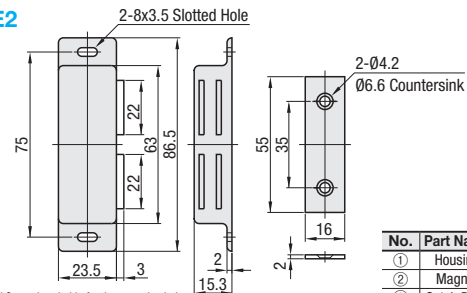

No.	Part Name	Material	Surface Treatment
①	Housing	Stainless Steel	Tumble Polish
②	Magnet	Ferrite	-
③	Catch Plate	SPCC	Nickel Plating

The M3 Flat Head Screw is suitable for the mounting hole.

Part Number	Retention Force (kgf)	Mass (g)
C-MGCE		
Type	No.	
	1	5.5
	2	9
		41
		89

Ordering Example Part Number (Type-No.)
C-MGCB2

Magnetic Catches

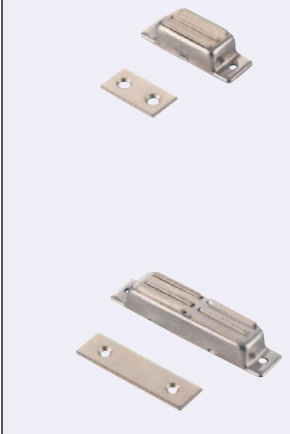

C-MGCB1

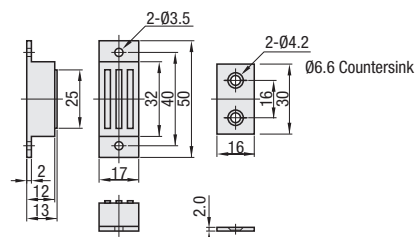

C-MGCB2

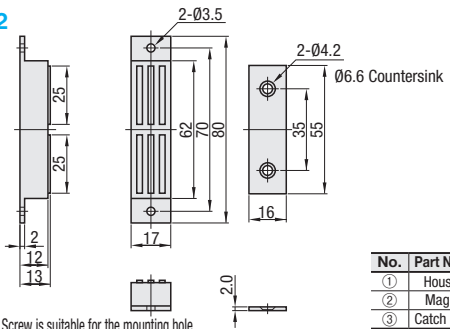

No.	Part Name	Material	Surface Treatment
①	Housing	Stainless Steel	Tumble Polish
②	Magnet	Ferrite	-
③	Catch Plate	SPCC	Nickel Plating

The M3 Flat Head Screw is suitable for the mounting hole.

Part Number	Retention Force (kgf)	Mass (g)
C-MGCB		
Type	No.	
	1	7
	2	10
		34
		68

Ordering Example Part Number (Type-A)
C-BCAS50

Ball Catches



C-BCAS

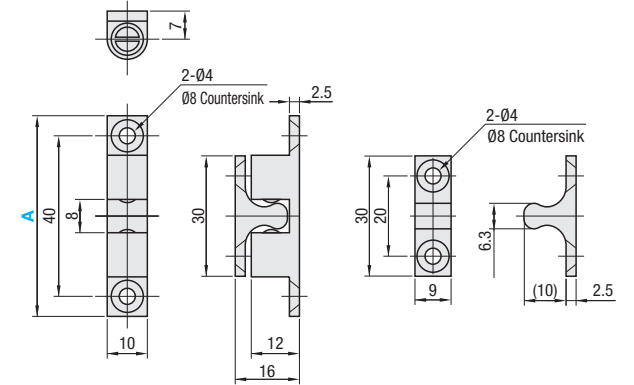

Material	Surface Treatment
Zinc Alloy	Chrome Plating

Part Number	Mass (g)
Type	A
C-BCAS	50
	26

Ordering Example Part Number (Type-No.)
C-PKBS2

Draw Latches



C-PKBS1

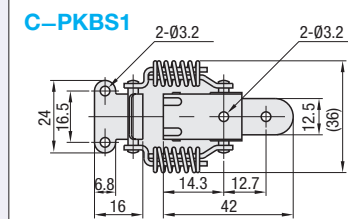

C-PKBS2

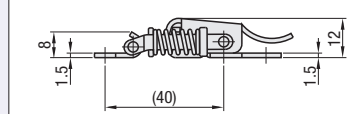
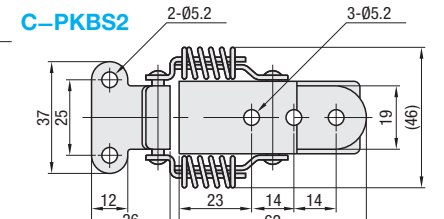

<Recommended Mounting Hole Pitch>

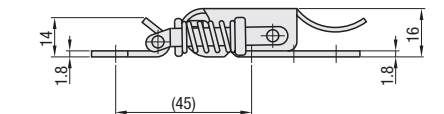
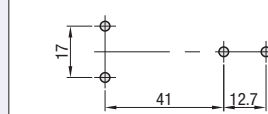

<Recommended Mounting Hole Pitch>

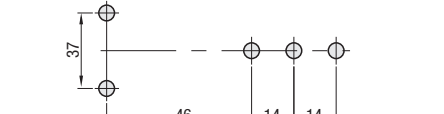

* Mounting dimensions can be adjusted optionally according to the tightening force.

Material	Surface Treatment
Stainless Steel	Tumble Polish

Part Number	Mass (g)
Type	No.
C-PKBS	1
	2
	34
	79