

## Three Phase Induction Motor Characteristic Curve

Hitachi Industrial Technology(Thailand),Ltd

Power (HP)	7.5
Pole	6
Type-Form	TFO-KK, VTFO-KK
Voltage (V)	380
Frequency (Hz)	50
Protection	IP44, IP55

Load (%)	0	25	50	75	100	125
Current (A)	5.64	6.19	7.61	9.69	12.31	15.61
Efficiency (%)	0	82.8	87.8	88.0	86.5	84.9
Power factor (%)	6.4	40.8	62.5	73.6	78.5	79.9
Slip (%)	0	0.9	1.9	3.0	4.3	6.0

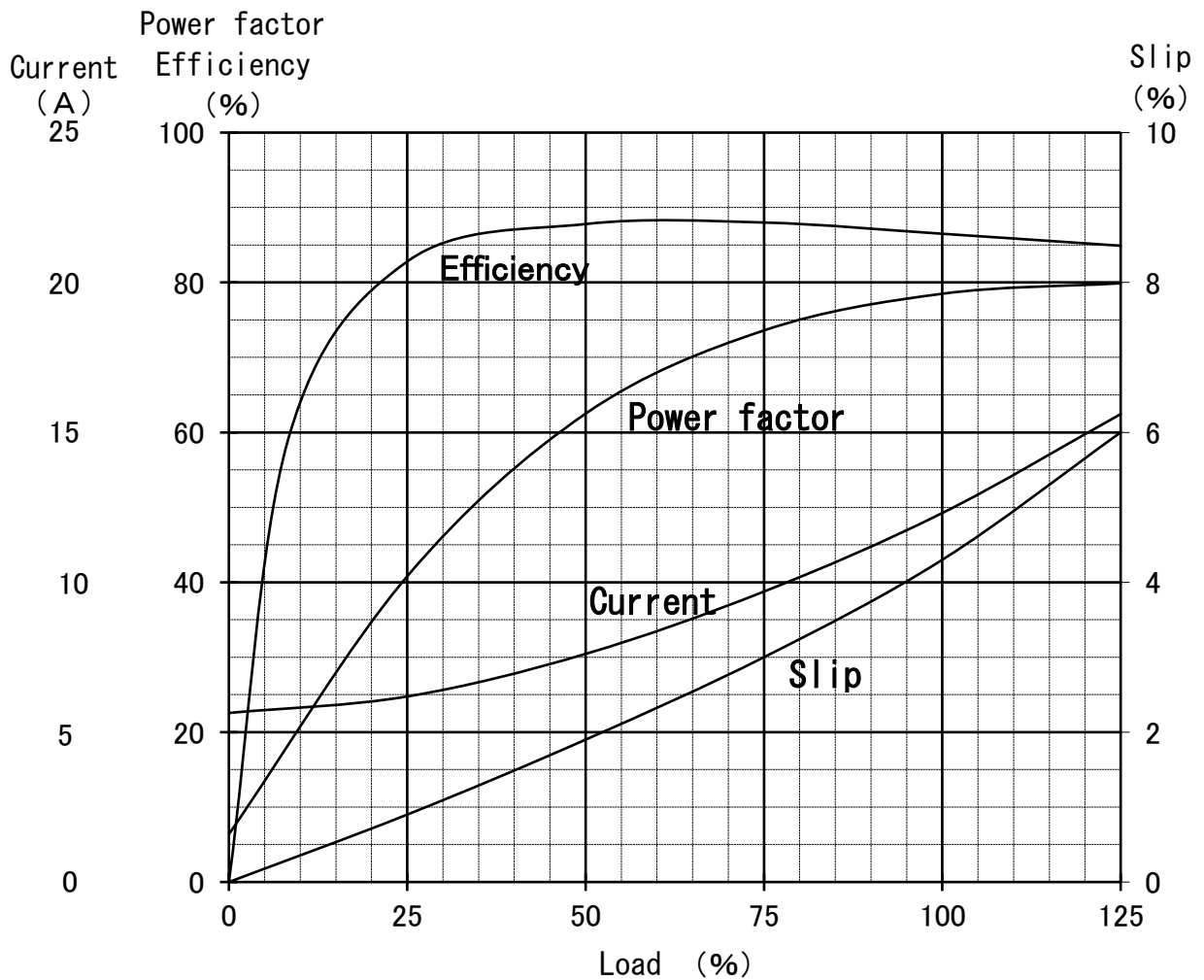

# Speed-Torque, Current Curve

7.5HP (V) TF0-KK 6P  
380/415V 50Hz  
IP44/IP55

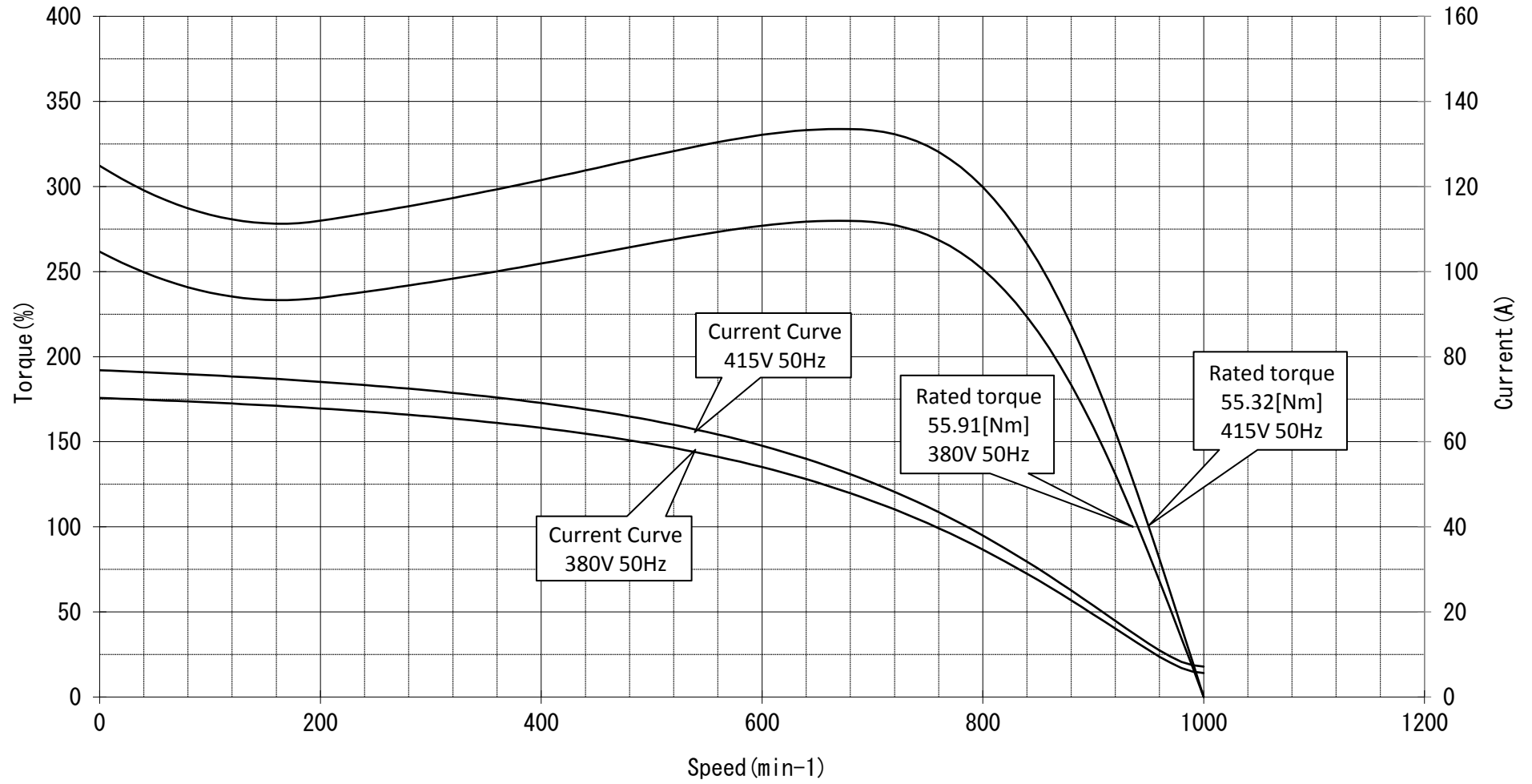

# HITACHI

## MANUFACTURER'S TEST REPORT OF INDUCTION MOTOR

MESSRS		ORDER No	
--------	--	----------	--

### SPECIFICATION FOR MOTOR

OUT PUT(HP)	7.5	POLES	6	TYPE-FORM	TFO-KK
FREQUENCY(HZ)	50/50	VOLTAGE(V)	380/415	CURRENT(A)	12.7/12.6
PHASES	3	RATING	S1	INSULATION	F
STANDARD	JEC-2137-2000	SECONDARY VOLTAGE(V)	—	SECONDARY CURRENT(A)	—
COOLING	IC411	PROTECTION	IP55	SPEED(min <sup>-1</sup> )	940/950

MFG No	FREQUENCY (HZ)	(1)NO-LOAD TEST			(2)LOCKED ROTOR TEST		
		VOLTAGE(V)	CURRENT(A)	INPUT(W)	VOLTAGE(V)	CURRENT(A)	INPUT(W)
	50	380	5.64	237.0	92.8	10.0	568.0
	50	415	7.15	337.0	92.8	10.0	568.0

(3)WINDINGS RESISTANCE (BETWEEN LINES) STATOR 115°C 1.98778 (Ω)

#### (4)LOAD CHARACTERISTICS

LOAD(%)	CURRENT(A)	EFFICIENCY(%)	POWER FACTOR(%)	SLIP(%)
25	6.19/7.53	82.8/77.8	40.8/32.6	0.9/0.8
50	7.61/8.58	87.8/85.2	62.5/52.3	1.9/1.6
75	9.69/10.19	88.0/86.8	73.6/64.9	3.0/2.6
100	12.31/12.27	86.5/86.4	78.5/72.2	4.3/3.6
125	15.61/14.84	84.9/86.4	79.9/76.0	6.0/4.9

(5)MAXIMUM OUT PUT(%) STARTING CURRENT(A) STARTING TORQUE(%)

193/225 70.3/76.8 264/314

(6)TEMPERATURE RISE TEST (R)-RESISTANCE METHOD

STATOR WINDINGS(K)	FRAME(K)	ROTOR WINDINGS(K)
79.0/78.0 (R)	55.0/54.5	—

(7)INSULATION RESISTANCE BY 500V MEGGER

100MΩ

(8)WITHSTAND STATOR WINDINGS TO CORE

1900V 1MIN WITHSTOOD

VOLTAGE TEST ROTOR WINDINGS TO CORE

— V 1MIN WITHSTOOD

(9)CONSTRUCTION, DIMENSION, PAINTING, OTHER PARTS

SATISFACTORY

HITACHI INDUSTRIAL TECHNOLOGY (THAILAND) LTD.	CHECKED BY	T.SHIMOZONO
	DATE	08-JUNE-2015

REP.No.RP30042

# THREE-PHASE INDUCTION MOTOR

OUTPUT	TYPE	FORM	RATING	VOLTAGE (V)	FREQ. (Hz)	SYNC. SPEED (min <sup>-1</sup> )	POLES	INS. CLASS	MASS (kg)
10HP	TFO	KK	S1	380/415V	50	1500	4	F	48
7.5HP	TFO	KK	S1	380/415V	50	1000	6	F	53

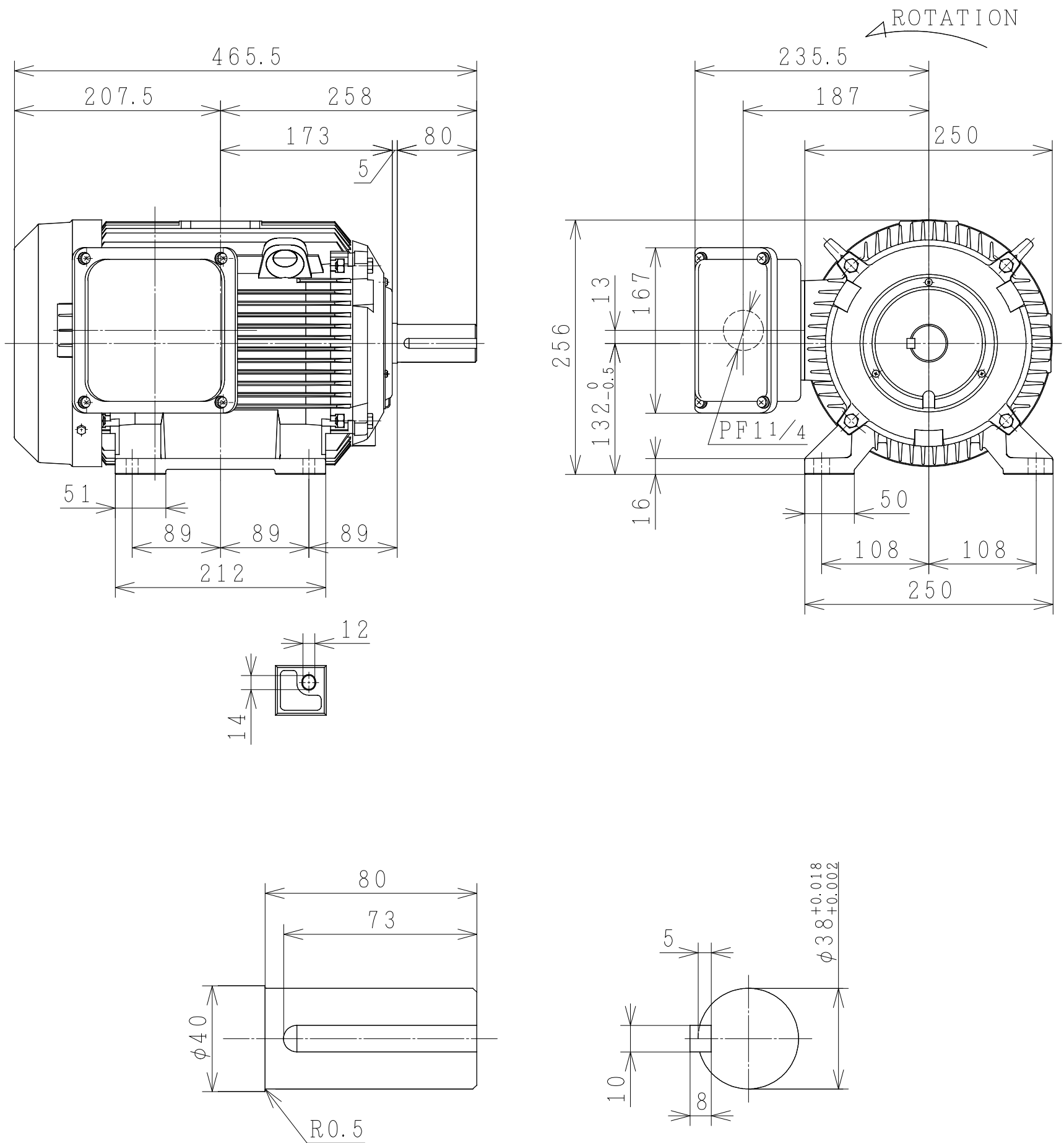

PROTECTION: IP55

PROJECTION

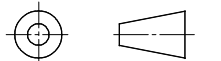

CUSTOMER			QTY.	ORDER No.	WORK No.	REV.
DWN.	P. Tianchai	24-JUNE-2015	<div style="display: flex; align-items: center; justify-content: center;"> <div style="font-size: 2em; margin-right: 10px;">S</div> <div style="font-size: 2em; font-weight: bold; margin-right: 10px;">DIMENSIONS</div> <div style="text-align: center;">   <b>HITACHI</b>  <small>Hitachi Industrial Technology (Thailand), Ltd.</small> </div> <div style="font-size: 1.5em; margin-left: 10px;">4HTD02232</div> </div>			SH.
CHKD.	N. WICHARN					HITT WORKS DWG. No.
APPD.	M. HIGASHIHARA					
FRAME SIZE TFOAF-132M (TMLR)						

# THREE-PHASE INDUCTION MOTOR

OUTPUT	TYPE	FORM	RATING	VOLTAGE (V)	FREQ. (Hz)	SYNC. SPEED (min <sup>-1</sup> )	POLES	TH. CLASS	MASS (kg)
10HP	TF0	KK	S1	380/415	50	1500	4	B	52
7.5HP	TF0	KK	S1	380/415	50	1000	6	B	57

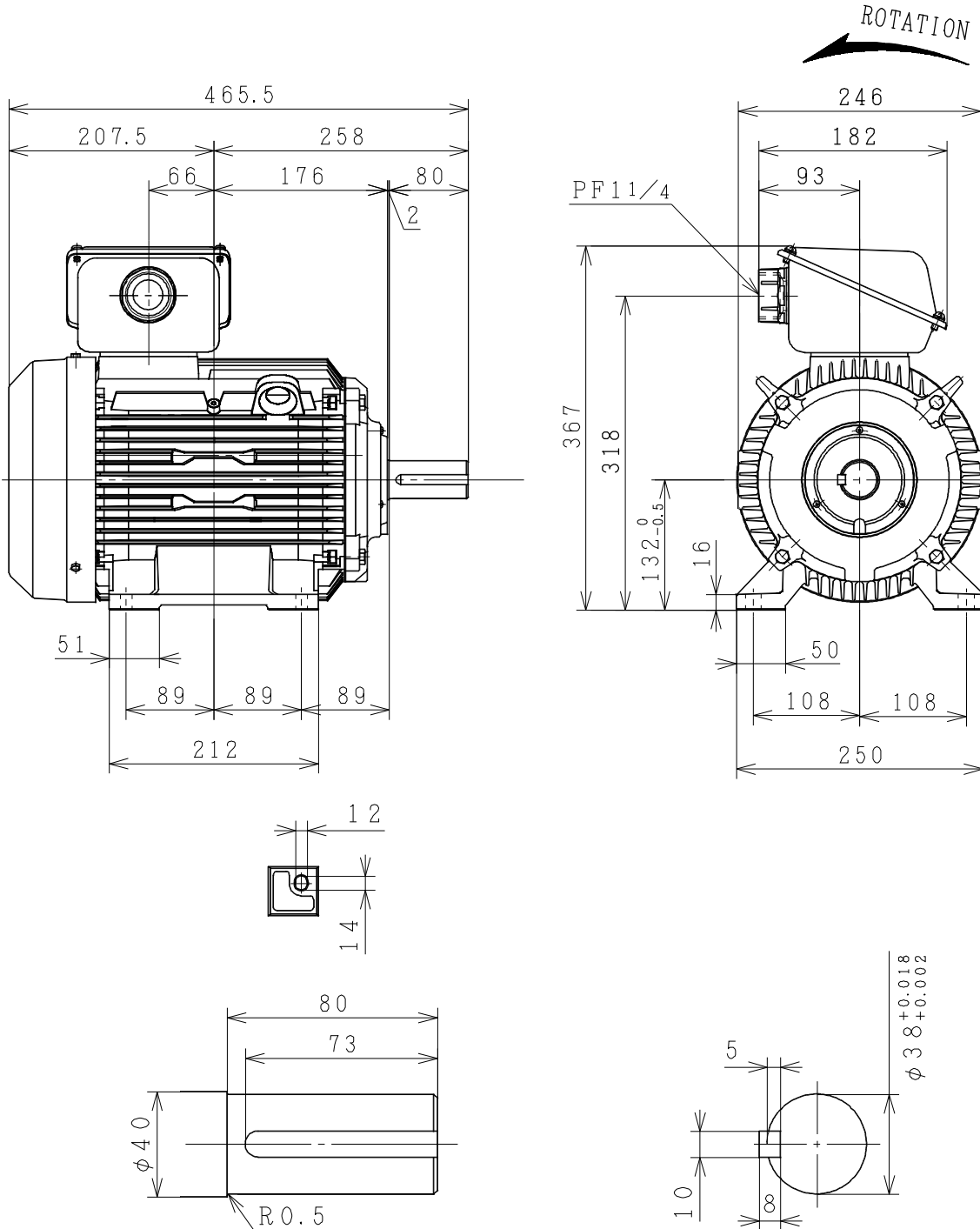

PROTECTION : IP55

PROJECTION

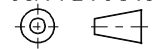

CUSTOMER	QTY.	ORDER No.	WORK No.	REV.
DIMENSIONS	<b>HITACHI</b> Hitachi Industrial Technology (Thailand), Ltd.		HITT WORKS DWG. No. 4HTD03368	SH.

FRAME SIZE TF0D-132M (TMHD)