

CAPACITOR START CAPACITOR RUN SINGLE PHASE INDUCTION MOTOR

OUTPUT	TYPE	FORM	RATING	VOLTAGE (V)	FREQ. (Hz)	SYNC. SPEED (min ⁻¹)	POLES	INS. CLASS	MASS (kg)
2HP	EFOUP	KQ	S1	220	50	1500	4	B	

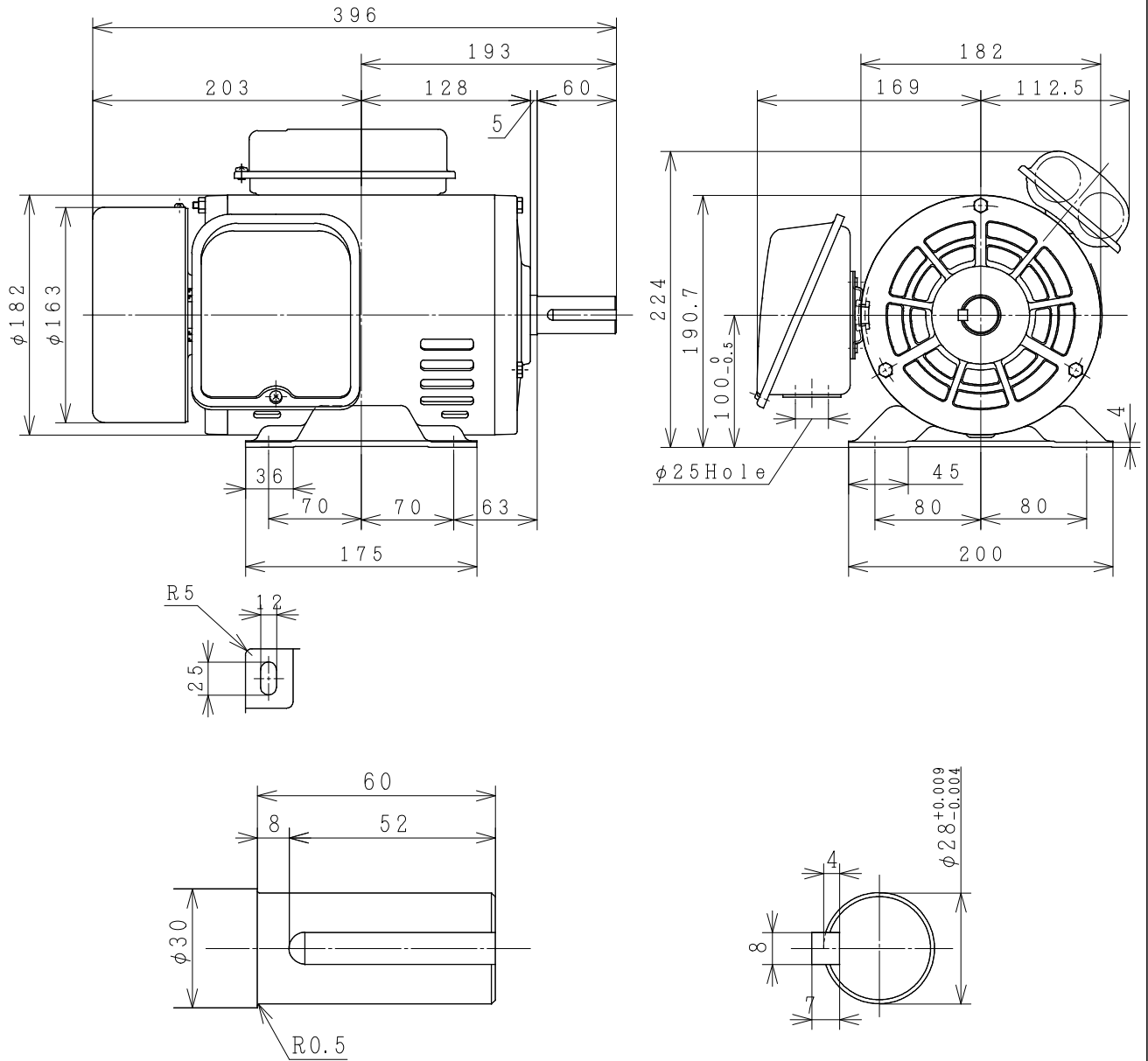

PROJECTION

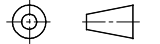

CUSTOMER			QTY.	ORDER No.	WORK No.	REV.	
DWN.	W.KANCHIT	11-07-13	<div style="display: flex; align-items: center; justify-content: center;"> <div style="text-align: center;"> <h2 style="margin: 0;">DIMENSIONS</h2> <p style="font-size: 8px; margin: 0;">Hitachi Industrial Technology (Thailand), Ltd.</p> </div> </div>			SH.	
CHKD.	W.Thawat					HITT WORKS DWG. No.	
APPD.	T.Shimozono					4HTD02620	
FRAME SIZE			EFOUP-KQ (100)				

Single Phase Induction Motor Characteristic Curve

Hitachi Industrial Technology(Thailand),Ltd

Power (HP)	2
Pole	4
Type-Form	EFOUP-KQ
Voltage (V)	220
Frequency (Hz)	50

Load (%)	0	25	50	75	100	125
Current (A)	8.10	8.38	9.26	10.48	12.03	14.22
Efficiency (%)	0	46.9	61.4	68.5	71.5	71.0
Power factor (%)	21.1	43.4	59.9	71.3	79.3	84.5
Slip (%)	0	0.8	1.6	2.4	3.1	4.2

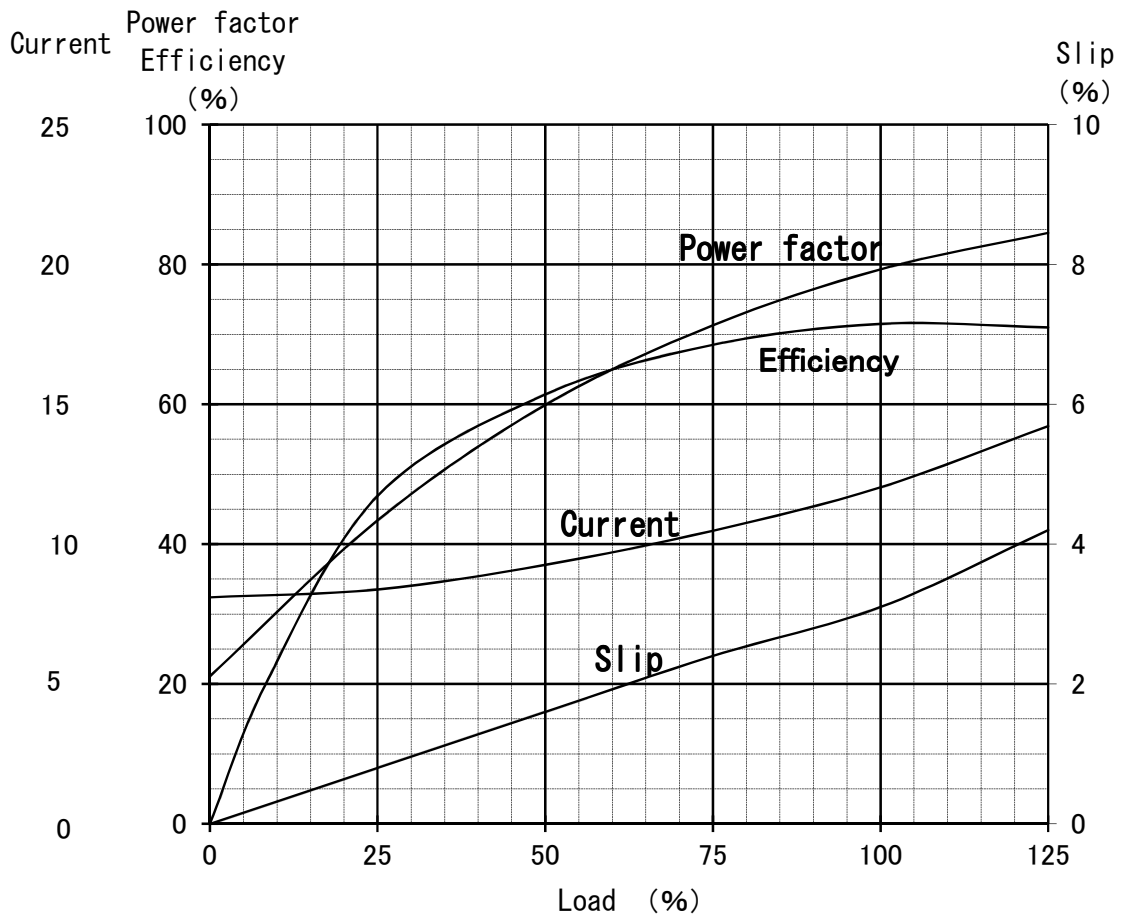

Speed-Torque, Current Curve

2HP EFOUP-KQ 4P
220V 50Hz

