

CAMRISE Series Compact Cam for Pierce/Trim/Flange - Long Stroke - CB-L72

Outline drawing/Product specifications

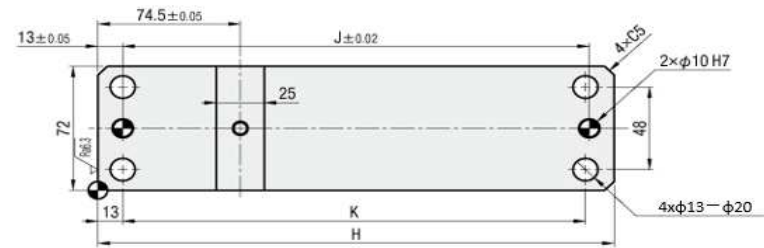

■ Rear Extraction Space

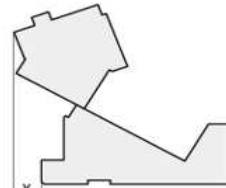

⊕ When installing in the mold, ensure sufficient rear extraction space.

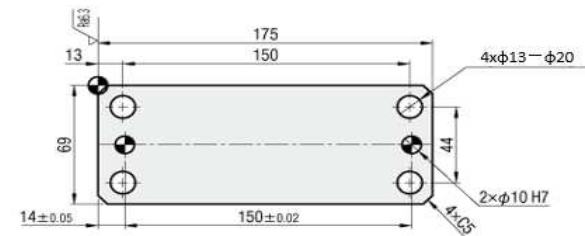
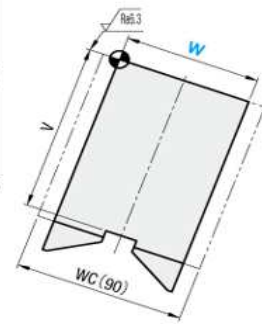
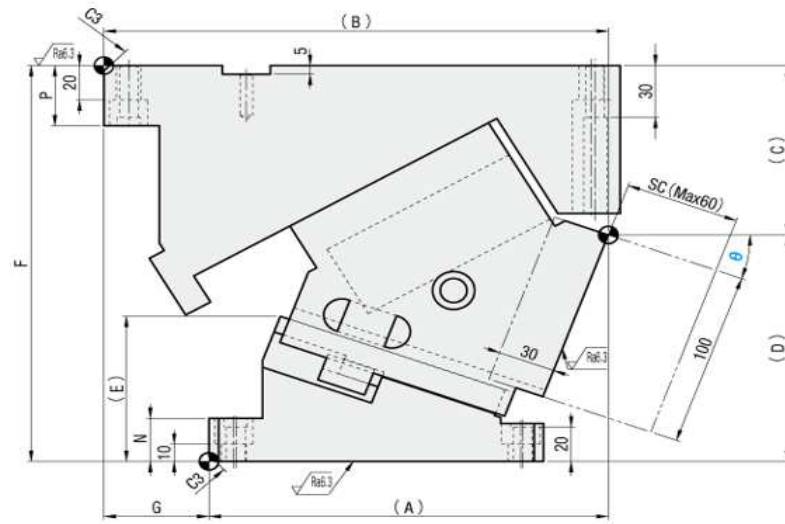

W	θ	(A)	(B)	(C)	(D)	(E)	F	G	H	J	K	P	N	V	X (ISO)	X (GK)
72	00	172.00	251.00	72.00	158.00	54.9	230	79	250	224	222	45	20	96	1.6	0.0
	05	182.43	255.43	78.86	151.14	61.2		73	255	229	227	40	25		10.6	7.4
	10	191.54	259.54	85.57	144.43	68.1		68	260	234	232	35			18.0	14.5
	15	201.33	262.33	92.10	137.90	75.8		61	265	239	237				24.5	20.8
	20	208.81	263.81	98.43	131.57	84.3		55	270	244	242				35.9	32.0
	25	217.02	262.02	104.52	125.48	93.3		45	275	249	247				48.5	44.4
	30	224.97	262.97	110.36	119.64	102.9		38				30	55.9		51.7	
	35	231.68	259.68	115.92	114.08	112.8		28					65.2		60.8	
	40	238.19	254.19	122.18	107.82	122.0		16					74.2		69.7	
	45	243.51	246.51	126.13	103.87	133.5		3					80.9		76.4	
50	248.67	234.67	141.76	93.24	138.0	235	-14	265	239	237	33	88.2	83.7			

Stroke S	Working Force kN (tonf)			Coil Spring		Gas Spring		Total weight Kg	Cam slider weight Kg	Tool mounting weight Kg	Model	W	θ
	Standard (1Million times)	Conditional (1Million times)	Max. (300,000 times)	Initial load N (kgf)	Final load N (kgf)	Final load N (kgf)	Model						
35.4	45.1 (4.6)	67.7 (6.9)	90.2 (9.2)	358 (36.6)	2822 (288)	6836 (698)	GSV500-63	19.4	6.9	4.4	CB-L	72	00
39.0													05
42.8													10
46.6													15
50.7													20
55.0													25
59.7													30
64.9													35
70.7													40
74.7													45
77.8	50												

Alteration	Code	Spec.
	K	Addition of positioning key (1 Hexagon socket head bolt M8x15 included) Attached key
	SC	Forward movement of mount surface 1 ≤ SC ≤ 60 Increment 1 mm
	WC	Change the width of mounting surface W=72 => W=90 When together using SC, the specified range of SC is 1 to 55
	GK	Spring type change Coil Spring / Gas Spring
	NGK	Without gas spring
	NF	No gas spring filled with nitrogen gas ⊕ Applicable to only spring type GK