

SCRAP RETENTION BUTTON DIES, CONFIGURABLE FULL LENGTH TYPE

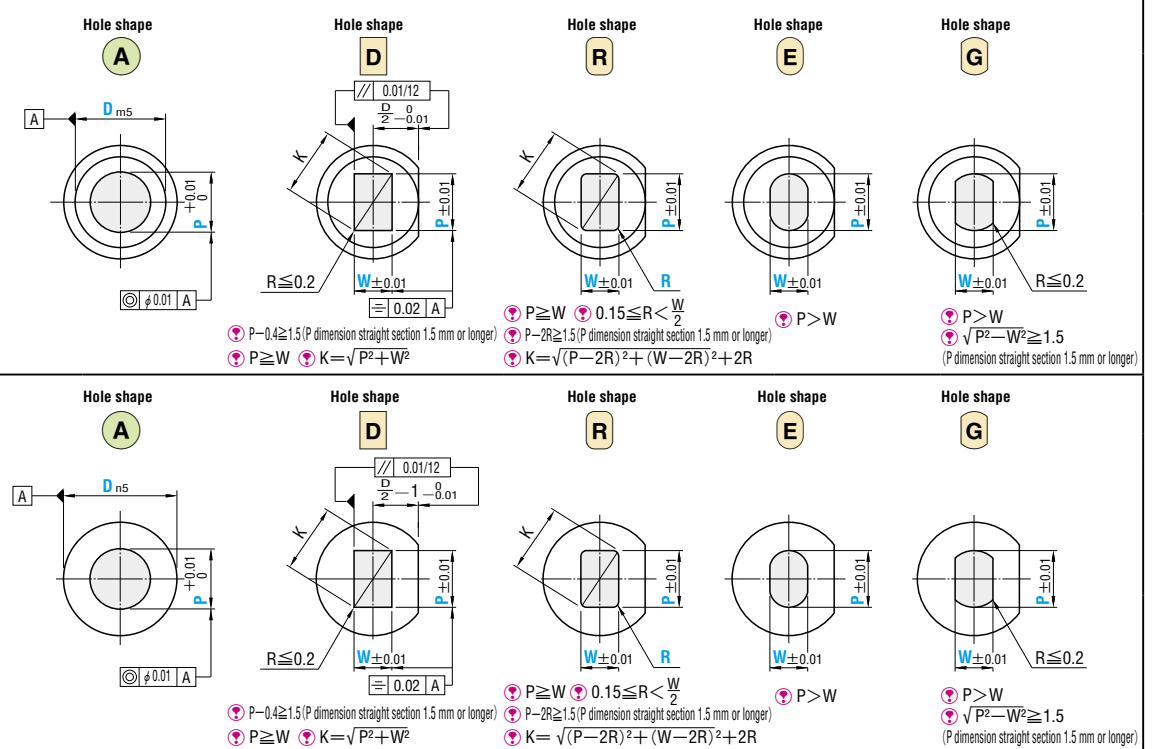

—Headed type—		RoHS	M H	D	Catalog No.
	Equivalent to SKD11 60~63 HRC		M H	D6~56	A SRS—MHD D SRS—HDD F SRS—HDR E SRS—HDE G SRS—HDG
				D10~56	A SRS—MHDS D SRS—HDDS F SRS—HDRS E SRS—HDES G SRS—HDGS

—Straight type—		RoHS	M H	D	Catalog No.
	Equivalent to SKD11 60~63 HRC		M H	D6~56	A SRS—MSD
				D8~56	D SRS—SDD F SRS—SDR E SRS—SDE G SRS—SDG
				D10~56	A SRS—MSDS D SRS—SDDS F SRS—SDRS E SRS—SDES G SRS—SDGS

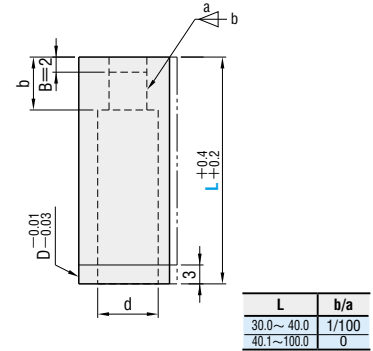
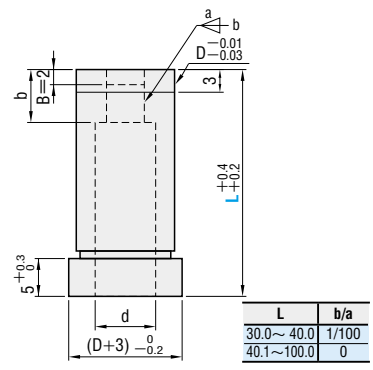

D tolerance		Catalog No.		0.1 mm increments		0.01mm increments				0.005mm increments		b	d
D	m5	n5	Type	D	L	A	D	R	E	G	R	C	
6	+0.009	+0.013	Headed type (Dm5) Straight type (Dns)	(6)	30.0~40.0	1.00~3.00	3.00	1.00				3	3.4
8	+0.012	+0.016		8		1.00~4.00	4.00	1.00					4
10	+0.006	+0.010	10	2.00~6.00		6.00	1.20					6	6.4
13	+0.015	+0.020	13	3.00~8.00		8.00	1.50					8	8.4
16	+0.007	+0.012	16	5.00~10.00		10.00	2.00					10	10.6
20	+0.017	+0.024	20	7.00~12.00		12.00	3.00					12	12.6
25	+0.008	+0.015	25	10.00~16.00		16.00	3.00					16	16.6
32			32	15.00~20.00		20.00	4.00					20	20.6
38	+0.020	+0.028	38	19.00~26.00		26.00	5.00					26	26.6
45	+0.009	+0.017	45	25.00~35.00		35.00	6.00					36	36.0
50			50	33.00~40.00	40.00	7.00					41	41.0	
56	+0.024	+0.033	56	38.00~45.00	45.00	8.00					46	46.0	
10	+0.018	+0.026	Headed type (Dm5) Straight type (Dns)	10	40.1~80.0 (40.01)	2.00~6.00	6.00	1.20				6	6.4
13	+0.015	+0.020		13		3.00~8.00	8.00	1.50					8
16	+0.007	+0.012	16	5.00~10.00		10.00	2.00					10	10.6
20	+0.017	+0.024	20	7.00~12.00		12.00	3.00					12	12.6
25	+0.008	+0.015	25	10.00~16.00		16.00	3.00					16	16.6
32			32	15.00~20.00		20.00	4.00					20	20.6
38	+0.020	+0.028	38	19.00~26.00		26.00	5.00					26	26.6
45	+0.009	+0.017	45	25.00~35.00		35.00	6.00					36	36.0
50			50	33.00~40.00		40.00	7.00					41	41.0
56	+0.024	+0.033	56	38.00~45.00		45.00	8.00					46	46.0

(D) (6) → The D=6 straight type is a specification available for shape (A) (round) only. It is not available for shapes (D, R, E, G).
 (L) (40.01) → When LKC·LKZ is selected, select an L dimension of 40.01 or larger.
 Effective depth of scrap retention grooves (table below). Perform shaped hole regrinding within the range of (Groove effective depth—1 mm).
 Can be used only for workpiece materials with tensile strengths up to 1177 N/mm² (120 kgf/mm²).
 MT (workpiece material thickness) and C (clearance) are used as data for machining the scrap retention grooves. Specify the shaped hole dimensions (P·W·R) when selecting the button die finishing dimensions.

Order	Catalog No.	L	P	W	R (R only)	MT	C
	SRS—MHD 10	35.1	P5.00			MT1.5	C0.105
	SRS—HDRS 20	65	P8.00	W8.00	R0.40	MT1.5	C0.105

Alteration	Code	A	D	R	E	G	1Code
Alterations to shaped hole	PC	Shaped hole diameter change min. $P \cdot W \cdot PC \geq \frac{P \cdot W \cdot min.}{2} \geq 1.00$ 0.01mm increments For (A) only, if PC is 1.00~1.99, b=4. max. $P \cdot W \cdot PC \leq P \cdot Kmax. + 0.2$ 0.01mm increments					
	WC	Shaped hole depth change $1.00 \sim 1.99$ 3 $2.00 \sim 3.99$ 5 $4.00 \sim$ 6					
	BC	Shaped hole diameter tolerance change $P \cdot W \pm 0.01 \rightarrow +0.01$ $0 \rightarrow +0.005$ 0					
Full length	LKC	Full length tolerance change $L \pm 0.4 \rightarrow +0.05$					
	LKZ	Full length tolerance change $L \pm 0.4 \rightarrow +0.01$					
Head	KC	Addition of single key flat to head					
		Addition of single key flat					

BUTTON DIES