

# HYDRAULIC CYLINDER - COMPACT

— Compact (Double Rod Type) LA 70 • 140kgf/cm<sup>2</sup> Transaxial Foot Type —



K-HCW-LA70 / K-HCW-LA140

[IS]

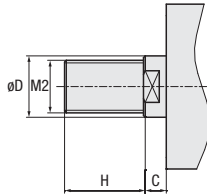

[IN]

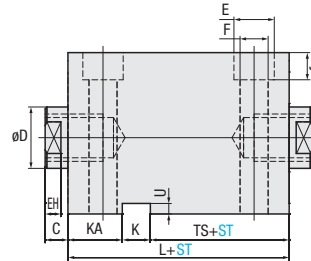
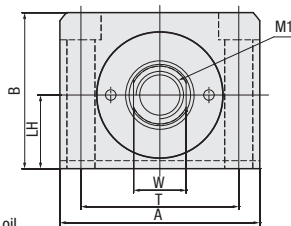
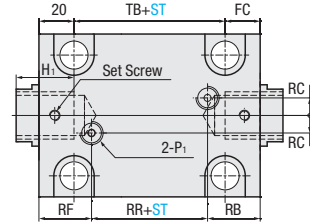

Body (tube) : S45C  
 Rod : S45C+Cr plating  
 Piston : AL7075  
 Rod End Cap : AL7075  
 Applicable operating fluid : General mineral hydraulic oil  
 Operating pressure range : 3~70(140)kgf/cm<sup>2</sup>  
 Operating speed range : 8~100mm/sec  
 Operating temperature range : -10~80°C

Component : 2 lock nuts (IS Type Only)  
 1 Fixed Key

Internal Diameter	Rod B Type				A	T	W	B	LH	U	L	KA	K	TS	H <sub>1</sub>	C	EH	E	F	J	RR	RF	RB	RC	TB	FC	P <sub>1</sub>
	D	H	M1	M2																							
32	18	25	M12×P1.75	M16×P1.5	70	56	14	56	25	5	72	28	12	32	15	10	7	14	9	8.6	16	28	28	10	32	20	PT1/4
40	22	30	M16×P2	M20×P1.5	80	62	19	64	29	5	72	28	12	32	20	10	7	17.5	11	10.8	18	27	27	10	32	20	PT1/4
50	28	35	M20×P2.5	M24×P1.5	94	74	24	74	34	5.5	75	29	14	32	24	11	8	20	14	13	19	28	28	10	35	20	PT1/4
63	35	45	M27×P3	M30×P1.5	114	90	30	89	42	6	82	31	16	35	33	13	9	23	16	15.2	22	30	30	10	42	20	PT1/4
80	45	60	M30×P3.5	M39×P1.5	142	115	41	109	52	6	95	36	16	43	36	17	14	26	18	17.5	25	35	35	15	55	20	PT3/8

Part Number		Internal Diameter	1mm increments	Rod End	
TYPE	No.			ST	M
					Female Screw
K-HCW (Double Rod Type)	LA70 LA140	32	5 ≤ ST ≤ 200	IN	IS
		40			
		50			
		63			
		80			



Order



Part Number — Internal Diameter — ST — M  
 K-HCW-LA70 — 40 — 80 — IN  
 K-HCW-LA140 — 50 — 100 — IS

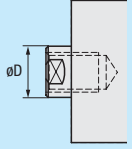
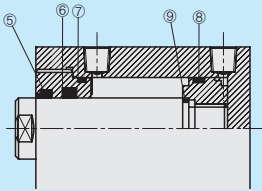

Days to Ship

**Quotation**

Alterations	Code	Spec.																																			
	CRD	<p>CRD = Rod C series</p> <table border="1"> <thead> <tr> <th rowspan="2">Internal Diameter</th> <th colspan="5">Rod C Type</th> </tr> <tr> <th>D</th> <th>H</th> <th>M1</th> <th>M2</th> <th>W</th> </tr> </thead> <tbody> <tr> <td>40</td> <td>18</td> <td>25</td> <td>M12×P1.75</td> <td>M16×P1.5</td> <td>14</td> </tr> <tr> <td>50</td> <td>22</td> <td>30</td> <td>M16×P2</td> <td>M20×P1.5</td> <td>19</td> </tr> <tr> <td>63</td> <td>28</td> <td>35</td> <td>M20×P2.5</td> <td>M24×P1.5</td> <td>24</td> </tr> <tr> <td>80</td> <td>35</td> <td>45</td> <td>M27×P3</td> <td>M30×P1.5</td> <td>30</td> </tr> </tbody> </table> <p>⊗ Internal diameter 32 is not available</p>	Internal Diameter	Rod C Type					D	H	M1	M2	W	40	18	25	M12×P1.75	M16×P1.5	14	50	22	30	M16×P2	M20×P1.5	19	63	28	35	M20×P2.5	M24×P1.5	24	80	35	45	M27×P3	M30×P1.5	30
Internal Diameter	Rod C Type																																				
	D	H	M1	M2	W																																
40	18	25	M12×P1.75	M16×P1.5	14																																
50	22	30	M16×P2	M20×P1.5	19																																
63	28	35	M20×P2.5	M24×P1.5	24																																
80	35	45	M27×P3	M30×P1.5	30																																
	VIT	<p>VIT = Fluorine rubber seal change for high temperature              ⚠ Destruction temperature is 120°C</p>																																			

 Alterations  **Part Number** — **Internal Diameter** — **ST** — **M** — (CRD-VIT...etc)  
 K-HCW-LA70 — 40 — 80 — IN — CRD  
 K-HCW-LA140 — 50 — 100 — IS — CRD — VIT

 Days to Ship **Quotation**

### ■ Mounting method

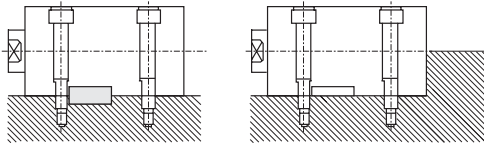

Fix using key

If the key is difficult to fix, you will need to determine where the force is distributed.

### ■ Fix key dimension table

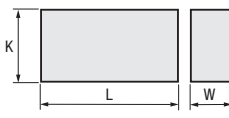
Drawing	Spec.			
	Internal Diameter	K	W	L
	32	12	8	63
	40	12	8	70
	50	14	9	80
	63	16	10	100
	80	16	10	100

### ■ Terms & Conditions:

- ⚠ Warranty period: 1 year (based on the date of MISUMI shipment)  
 ※ Check the warranty policy for details.
- ⚠ If the internal part of the cylinder is damaged due to the use of contaminated oil (mixing iron, chips, etc.), repair cost will be charged regardless of the warranty period.
- ⚠ For the buckling load, please check reference data.
- ⚠ At the time of mounting, please align the centre of the rod's axis with the direction of load's motion accurately. If the centre is shifted, it may cause malfunction, leakage, packing damage and cylinder damage.
- ⚠ When using extreme cold, extreme high temperature, extreme low pressure, and extreme high pressure, please contact us before ordering. Packing and seal changes are required depending on the environment.
- ⚠ If a problem occurs during use, send the hydraulic cylinder without disassembling it for easy identification.