

# HYDRAULIC CYLINDER - COMPACT

— Compact (Switch Mounted Single Rod Type) FA 70 • 140kgf/cm<sup>2</sup> Rod Side Flange Type —



K-HCMG-FA70 / K-HCMG-FA140

[IS]

[IN]

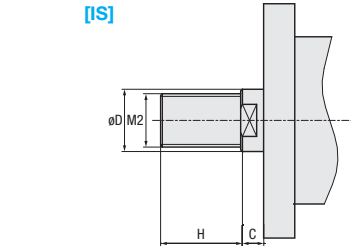

ⓘ When ST101 or more is set, see the page on the right side for changing the fastening method of FA mounting and cylinder.

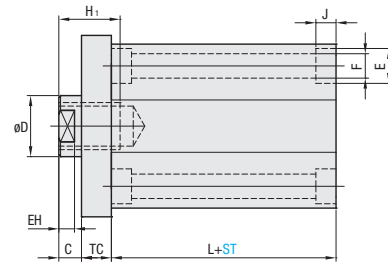
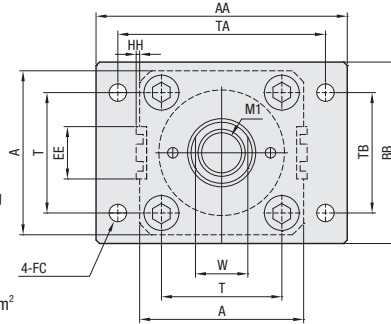
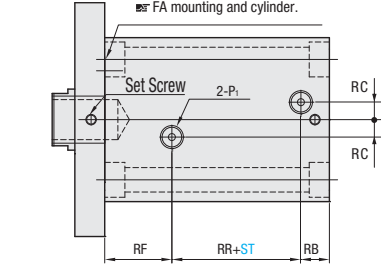

Body (tube) : SUS303  
 Rod : S45C+Cr plating  
 Piston : AL7075  
 Rod End Cap : AL7075  
 Applicable operating fluid : General mineral hydraulic oil  
 Operating pressure range : 3~70(140)kgf/cm<sup>2</sup>  
 Operating speed range : 8~100mm/sec  
 Operating temperature range : -10~80°C

ⓐ Component : 1 lock nut (IS Type Only)  
 2 Auto Switches

Internal Diameter	Rod B Type				A	T	W	BB	TB	AA	TA	(*) L	H <sub>1</sub>	C	TC	EH	E	F	J	(*) RR	RF	(*) RB	RC	P <sub>1</sub>	FC	HH	EE
	D	H	M1	M2																							
32	18	25	M12×P1.75	M16×P1.5	62	47	14	69	46	118	95	69	15	10	13	7	11	6.6	6.5	29	28	12	10	PT1/4	11	2	23
40	22	30	M16×P2	M20×P1.5	70	52	19	72	46	118	95	70	20	10	13	7	14	9	8.6	31	27	12	10	PT1/4	11	2	26
50	28	35	M20×P2.5	M24×P1.5	80	58	24	85	58	145	115	75	24	11	16	8	17.5	11	10.8	34	28	13	10	PT1/4	14	2	30
63	35	45	M27×P3	M30×P1.5	94	69	30	98	65	165	132	82	33	13	18	9	20	14	13	39	30	13	10	PT1/4	18	2	30
80	45	60	M30×P3.5	M39×P1.5	114	86	41	118	87	190	155	93	36	17	21	14	23	16	15.2	40	35	18	15	PT3/8	18	2	30
100	55	75	M39×P4	M48×P1.5	140	105	50	150	109	230	190	125	45	20	24	14	26	18	17.5	50	50	25	18	PT1/2	22	1	30
125	70	95	M48×P5	M64×P2.0	170	130	65	175	130	272	224	155	50	25	28	18	32	22	21.5	47	70	38	23	PT3/4	26	1	30

ⓘ When ST101 or more is set, see the page on the right side for changing the fastening method of FA mounting and cylinder.

ⓘ When the internal diameter is set at 32 • 40 & ST101 or more, then dimensions marked with (\*) in the above table will change as shown in the table below.

Part Number		Internal Diameter	1mm increments		Rod End	
TYPE	No.		ST		M	
					Female Screw	Male Screw
K-HCMG (Switch Mounted Single Rod Type)	FA70 FA140	32	5 ≤ ST ≤ 100 (*) 101 ≤ ST ≤ 200		IN	IS
		40	ⓘ When the internal diameter is set at 32 • 40 & ST101 or more, then dimensions marked with (*) in the above table will change as shown in the table below.			
		50				
		63				
		80				
		100				
		125	5 ≤ ST ≤ 200			

\* The K-HCMG type has two default auto switches mounted on the right. If you want to change the quantity of the auto switch, please contact us.



Order

Part Number	Internal Diameter	ST	M
K-HCMG-FA70	40	80	IN
K-HCMG-FA140	50	100	IS

ⓐ (\*) Table of dimensions changed from Internal Diameter 32 • 40 & ST101 or more.



Internal Diameter	L	RR	RB
32	87	31	28
40	87	33	27

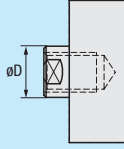
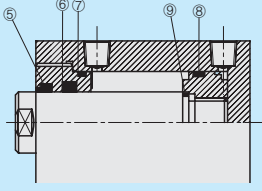

Days to Ship

Quotation

Alterations	Code	Spec.																																															
	<b>CRD</b>	<p>CRD = Rod C series</p> <table border="1"> <thead> <tr> <th rowspan="2">Internal Diameter</th> <th colspan="5">Rod C Type</th> </tr> <tr> <th>D</th> <th>H</th> <th>M1</th> <th>M2</th> <th>W</th> </tr> </thead> <tbody> <tr> <td>40</td> <td>18</td> <td>25</td> <td>M12×P1.75</td> <td>M16×P1.5</td> <td>14</td> </tr> <tr> <td>50</td> <td>22</td> <td>30</td> <td>M16×P2</td> <td>M20×P1.5</td> <td>19</td> </tr> <tr> <td>63</td> <td>28</td> <td>35</td> <td>M20×P2.5</td> <td>M24×P1.5</td> <td>24</td> </tr> <tr> <td>80</td> <td>35</td> <td>45</td> <td>M27×P3</td> <td>M30×P1.5</td> <td>30</td> </tr> <tr> <td>100</td> <td>45</td> <td>60</td> <td>M30×P3.5</td> <td>M39×P1.5</td> <td>41</td> </tr> <tr> <td>125</td> <td>55</td> <td>75</td> <td>M39×P4</td> <td>M48×P1.5</td> <td>50</td> </tr> </tbody> </table> <p>⊗ Internal diameter 32 is not available</p>	Internal Diameter	Rod C Type					D	H	M1	M2	W	40	18	25	M12×P1.75	M16×P1.5	14	50	22	30	M16×P2	M20×P1.5	19	63	28	35	M20×P2.5	M24×P1.5	24	80	35	45	M27×P3	M30×P1.5	30	100	45	60	M30×P3.5	M39×P1.5	41	125	55	75	M39×P4	M48×P1.5	50
Internal Diameter	Rod C Type																																																
	D	H	M1	M2	W																																												
40	18	25	M12×P1.75	M16×P1.5	14																																												
50	22	30	M16×P2	M20×P1.5	19																																												
63	28	35	M20×P2.5	M24×P1.5	24																																												
80	35	45	M27×P3	M30×P1.5	30																																												
100	45	60	M30×P3.5	M39×P1.5	41																																												
125	55	75	M39×P4	M48×P1.5	50																																												
	<b>VIT</b>	<p>VIT = Fluorine rubber seal change for high temperature            † Destruction temperature is 120°C</p>																																															

 Alterations  **Part Number** — **Internal Diameter** — **ST** — **M** — (CRD-VIT...etc)  
 K-HCMG-FA70 — 40 — 80 — IN — CRD  
 K-HCMG-FA140 — 50 — 100 — IS — CRD — VIT

 Days to Ship **Quotation**

<Specifications of auto switch>

**W13H**

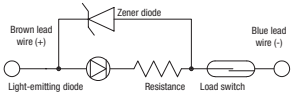

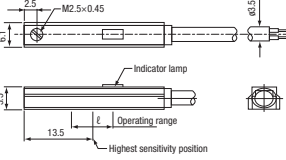

Usage	Relay, PLC	
Load voltage	DC 24V	AC 110V
Load current	5-40mA	5-20mA
Internal voltage drop	3V or less	
Indicator lamp	On when red LED turns on	
Lead wire length	1m	

- \* The default packaging quantity is 1. Please purchase two switches when purchase of 1 hydraulic cylinder.
- \* Short strokes such as ST5~30 are replaced with low sensitivity switch.
- \* Please contact us while changing the lead wire length.

■ **Mounting method**

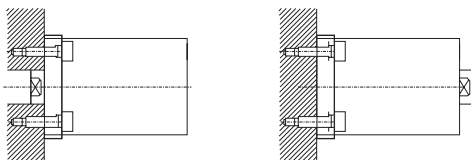

■ **Tightening method of FA mounting and cylinder when ST101 or more is set**

<Basic fastening method>

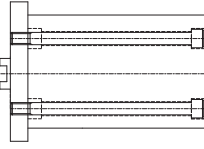

- Insert the bolts from the back of the cylinder and secure it to the FA mounting.

<Fastening method in case of ST101 or more is set>

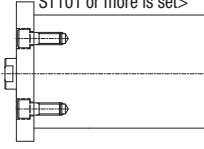

- Fasten the bolt from the front of the FA plate to the cylinder side. (Existing mounting hole is removed.)

 Order **Part Number**  
**W13H**

 Days to Ship **Quotation**

■ **Terms & Conditions:**

- ⊕ Warranty period: 1 year (based on the date of MISUMI shipment)
- ※ Check the warranty policy for details.
- ⊕ If the internal part of the cylinder is damaged due to the use of contaminated oil (mixing iron, chips, etc.), repair cost will be charged regardless of the warranty period.
- ⊕ For the buckling load, please check reference data.
- ⊕ At the time of mounting, please align the centre of the rod's axis with the direction of load's motion accurately. If the centre is shifted, it may cause malfunction, leakage, packing damage and cylinder damage.
- ⊕ When using extreme cold, extreme high temperature, extreme low pressure, and extreme high pressure, please contacts us before ordering. Packing and seal changes are required depending on the environment.
- ⊕ If a problem occurs during use, send the hydraulic cylinder without disassembling it for easy identification.