

# HYDRAULIC CYLINDER - COMPACT

— Compact (Single Rod Type) FA 70 • 140kgf/cm<sup>2</sup> Rod Side Flange Type —



## K-HC-FA70 / K-HC-FA140

[IS]

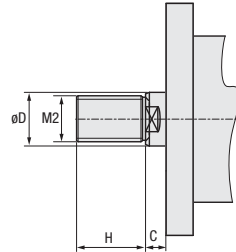

[IN]

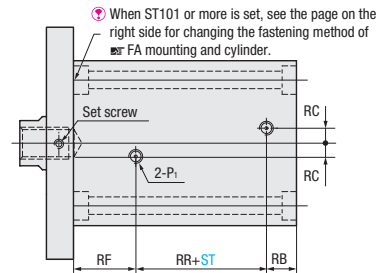

Body (tube) : S45C  
 Rod : S45C+Cr plating  
 Piston : AL7075  
 Rod End Cap : AL7075  
 Applicable operating fluid : General mineral hydraulic oil  
 Operating pressure range : 3~70(140)kgf/cm<sup>2</sup>  
 Operating speed range : 8~100mm/sec  
 Operating temperature range : -10~80°C

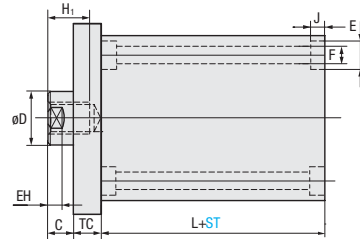
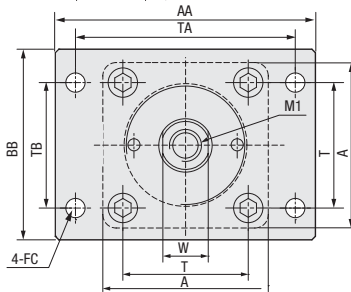

▲ Component : 1 lock nut (IS Type Only)

Internal Diameter	Rod B Type				A	T	W	BB	TB	AA	TA	(*) L	H <sub>1</sub>	C	TC	EH	E	F	J	(*) RR	RF	(*) RB	RC	P <sub>1</sub>	FC
	D	H	M1	M2																					
32	18	25	M12×P1.75	M16×P1.5	62	47	14	69	46	118	95	54	15	10	13	7	11	6.6	6.5	14	28	12	10	PT1/4	11
40	22	30	M16×P2	M20×P1.5	70	52	19	72	46	118	95	55	20	10	13	7	14	9	8.6	16	27	12	10	PT1/4	11
50	28	35	M20×P2.5	M24×P1.5	80	58	24	85	58	145	115	60	24	11	16	8	17.5	11	10.8	19	28	13	10	PT1/4	14
63	35	45	M27×P3	M30×P1.5	94	69	30	98	65	165	132	67	33	13	18	9	20	14	13	24	30	13	10	PT1/4	18
80	45	60	M30×P3.5	M39×P1.5	114	86	41	118	87	190	155	78	36	17	21	14	23	16	15.2	25	35	18	15	PT3/8	18
100	55	75	M39×P4	M48×P1.5	140	105	50	150	109	230	190	110	45	20	24	14	26	18	17.5	35	50	25	18	PT1/2	22
125	70	95	M48×P5	M64×P2.0	170	130	65	175	130	272	224	155	50	25	28	18	32	22	21.5	47	70	38	23	PT3/4	26

ⓘ When ST101 or more is set, see the page on the right side for changing the fastening method of FA mounting and cylinder.

ⓘ When the internal diameter is set at 32 • 40 & ST101 or more, then dimensions marked with (\*) in the above table will change as shown in the table below.

Part Number		Internal Diameter	1mm increments		Rod End	
TYPE	No.		ST		M	
					Female Screw	Male Screw
K-HC (Single Rod Type)	FA70 FA140	32	5 ≤ ST ≤ 100 (*) 101 ≤ ST ≤ 200		IN	IS
		40	ⓘ When the internal diameter is set at 32 • 40 & ST101 or more, then dimensions marked with (*) in the above table will change as shown in the table below.			
		50				
		63				
		80				
		100				
		125	5 ≤ ST ≤ 200			



Order

Part Number	Internal Diameter	ST	M
K-HC-FA70	40	80	IN
K-HC-FA140	50	100	IS

■ (\*) Table of dimensions changed from Internal Diameter 32 • 40 & ST101 or more.



Internal Diameter	L	RR	RB
32	72	16	28
40	72	18	27

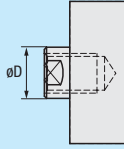
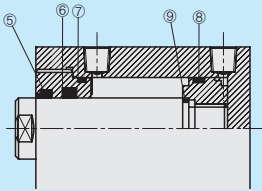

Days to Ship

**Quotation**

Alterations	Code	Spec.																																															
	CRD	<p>CRD = Rod C series</p> <table border="1"> <thead> <tr> <th rowspan="2">Internal Diameter</th> <th colspan="5">Rod C Type</th> </tr> <tr> <th>D</th> <th>H</th> <th>M1</th> <th>M2</th> <th>W</th> </tr> </thead> <tbody> <tr> <td>40</td> <td>18</td> <td>25</td> <td>M12×P1.75</td> <td>M16×P1.5</td> <td>14</td> </tr> <tr> <td>50</td> <td>22</td> <td>30</td> <td>M16×P2</td> <td>M20×P1.5</td> <td>19</td> </tr> <tr> <td>63</td> <td>28</td> <td>35</td> <td>M20×P2.5</td> <td>M24×P1.5</td> <td>24</td> </tr> <tr> <td>80</td> <td>35</td> <td>45</td> <td>M27×P3</td> <td>M30×P1.5</td> <td>30</td> </tr> <tr> <td>100</td> <td>45</td> <td>60</td> <td>M30×P3.5</td> <td>M39×P1.5</td> <td>41</td> </tr> <tr> <td>125</td> <td>55</td> <td>75</td> <td>M39×P4</td> <td>M48×P1.5</td> <td>50</td> </tr> </tbody> </table> <p>⊗ Internal diameter 32 is not available</p>	Internal Diameter	Rod C Type					D	H	M1	M2	W	40	18	25	M12×P1.75	M16×P1.5	14	50	22	30	M16×P2	M20×P1.5	19	63	28	35	M20×P2.5	M24×P1.5	24	80	35	45	M27×P3	M30×P1.5	30	100	45	60	M30×P3.5	M39×P1.5	41	125	55	75	M39×P4	M48×P1.5	50
Internal Diameter	Rod C Type																																																
	D	H	M1	M2	W																																												
40	18	25	M12×P1.75	M16×P1.5	14																																												
50	22	30	M16×P2	M20×P1.5	19																																												
63	28	35	M20×P2.5	M24×P1.5	24																																												
80	35	45	M27×P3	M30×P1.5	30																																												
100	45	60	M30×P3.5	M39×P1.5	41																																												
125	55	75	M39×P4	M48×P1.5	50																																												
	VIT	<p>VIT = Fluorine rubber seal change for high temperature            ⚠ Destruction temperature is 120°C</p>																																															

 Alterations  **Part Number** — **Internal Diameter** — **ST** — **M** — **(CRD-VIT...etc)**  
 K-HC-FA70 — 40 — 80 — IN — CRD  
 K-HC-FA140 — 50 — 100 — IS — CRD — VIT

 Days to Ship **Quotation**

### ■ Mounting method

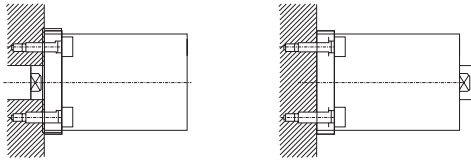

### ■ Tightening method of FA mounting and cylinder when ST101 or more is set

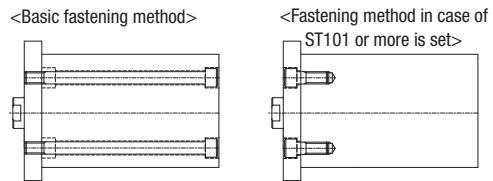

• Insert the bolts from the back of the cylinder and secure it to the FA mounting.

• Fasten the bolt from the front of the FA plate to the cylinder side. (Existing mounting hole is removed.)

### ■ Terms & Conditions:

- ⚠ Warranty period: 1 year (based on the date of MISUMI shipment)  
 ※ Check the warranty policy for details.
- ⚠ If the internal part of the cylinder is damaged due to the use of contaminated oil (mixing iron, chips, etc.), repair cost will be charged regardless of the warranty period.
- ⚠ For the buckling load, please check reference data.
- ⚠ At the time of mounting, please align the centre of the rod's axis with the direction of load's motion accurately. If the centre is shifted, it may cause malfunction, leakage, packing damage and cylinder damage.
- ⚠ When using extreme cold, extreme high temperature, extreme low pressure, and extreme high pressure, please contact us before ordering. Packing and seal changes are required depending on the environment.
- ⚠ If a problem occurs during use, send the hydraulic cylinder without disassembling it for easy identification.