

VACUUM LINE MAGNET

■ Application Installed on resin transport lines and used for removing metallic foreign matter.

■ Vacuum Line Magnet

M-VLMT
M-VLMM

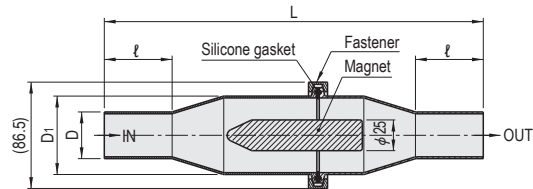

Material Magnet : Neodymium*
Surface : Stainless steel
Gasket : Silicone
Magnetic force: 9,000 Gauss

M-VLMTK

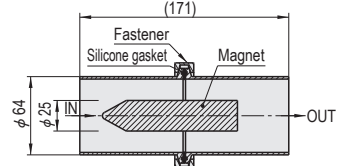

Material Magnet : Neodymium*
Surface : Stainless steel
Gasket : Silicone
Magnetic force: 9,000 Gauss

| Dimensions | | | | Part Number | | Unit price |
|------------|--------|--------|--------|--------------------------|------------------------------------|------------|
| D (φ) | D1 (φ) | L (mm) | l (mm) | Type | Maximum operating temperature (°C) | 1~3 pcs |
| 38 | 64 | 310 | 55 | M-VLMT (Small diameter) | 80 | Quotation |
| 51 | | 256 | 65 | M-VLMM (Medium diameter) | 80 | |
| — | — | — | — | M-VLMTK (Large diameter) | 80 | |
| | | | | | 140 | |
| | | | | | 140 | |
| | | | | | 140 | |

*The 140° type is excellent in heat resistance as it contains dysprosium and cobalt in the neodymium magnet.



Order

| Part Number | |
|-------------|-------------------------------|
| Type | Maximum operating temperature |
| M-VLMT | 80 |
| M-VLMM | 80 |
| M-VLMTK | 80 |



Days to Ship

Quotation



Example

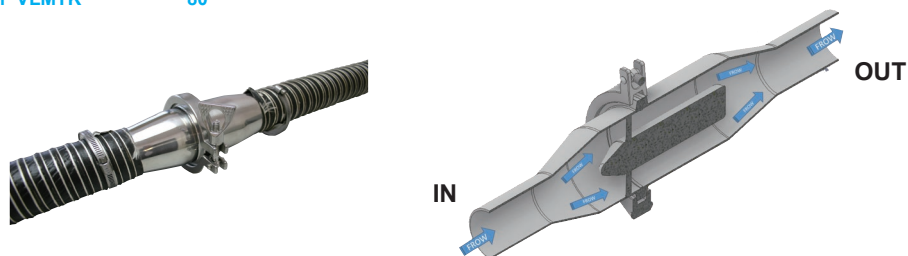

■ How to use

- Use the product by connecting between transport hoses from the material tank to the hopper.
- Metallic foreign matter contaminating raw materials can be removed with the magnet.
- As it is necessary to periodically clean out the recovered metallic foreign matter, be sure to install it in a location that maintenance can be done easily.
- Be sure to connect correctly so that the raw material enters from the IN side and is discharged from the OUT side. Connecting in the reverse direction may cause clogging, etc.

MAGNET FOR HOPPER LOADER

■ Application Installed on hopper and used for removing metallic foreign matter.

■ Magnet for Hopper Loader



M-HRM

No.1~4

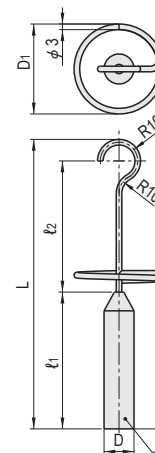

No.5

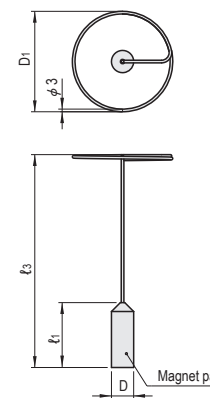

Material Surface : SUS304
Magnet : Neodymium
Operating temperature: 200°C or less
Magnetic force: 6,000 Gauss

| Dimensions | | | | | | Part Number | | Unit price |
|------------|---------|---------|---------|-------|--------|-------------|----|------------|
| L (mm) | l1 (mm) | l2 (mm) | l3 (mm) | D (φ) | D1 (φ) | Type | No | 1~5 pcs |
| 155 | 73 | 70 | 83 | 16 | 48 | M-HRM | 1 | Quotation |
| 155 | | 60 | 130 | | 68 | | 2 | |
| 200 | 120 | 70 | 130 | 25 | 48 | | 3 | |
| 200 | | 60 | | 68 | 4 | | | |
| — | 73 | — | 240 | 25 | 113 | | 5 | |



Order

| Part Number |
|-------------|
| M-HRM |



Days to Ship

Quotation



Example

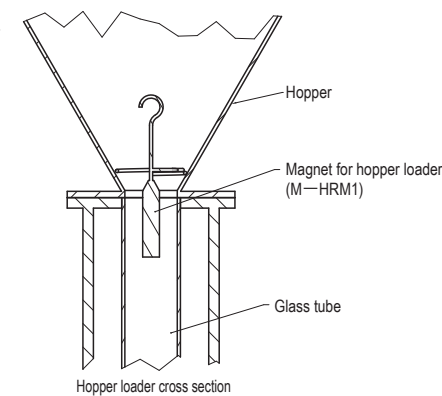

■ How to use

- Use this product for hopper loaders with glass tubes.
- Set it so that it hangs from the outlet of the hopper as shown on the left.
- Metallic foreign matter contained in the material can be removed during material transport.
- Regularly clean out the collected metallic foreign matter. (It can be easily removed by lifting it with a string or the like to the hook of the magnet for hopper loader)