

# BLADES FOR ROUND TYPE / SQUARE TYPE AIR NIPPERS

shows in red

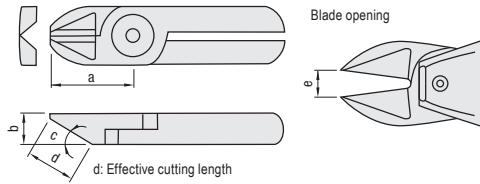

MN□



How to read part number No. **MN5 A S**

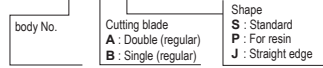

**■ Shape**

**S: Standard**

Suitable for cutting steel wires such as copper wire and iron wire

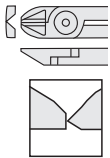

**JL, J141, J163, B39: Straight long blades for plastic**

Suitable when there is distance between the nippers and the gate cut portion of the workpiece.

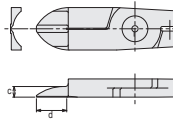

**P: For resin**

Standard blade used for cutting resin

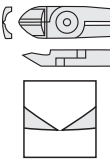

**H: Crank blades for plastic**

Effective when there are obstructions or the gate is narrow.

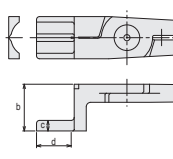

**BJ: Straight blades for metals**

This is a set of vertical blades with an unbeveled cutting edge for metal.

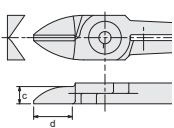

**ML□□□□, MR□□□□: Laterally facing blades for plastic**

Useful when it is hard for the nipper to get into, for example, in cramped spaces.

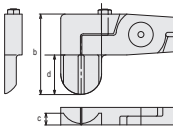

**J, JB: Straight blades for plastic**

Vertical blades with an unbeveled cutting edge for plastic.

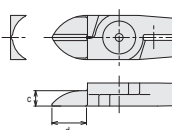

**L525: L blades for S**

For direct gate cut.

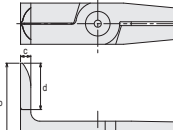

**E: Nipping blades for plastic**

Used for plastic gates such as ride gates and discard gates.

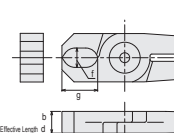

**E1205: Nipping blades for plastic**

Used for plastic gates such as ride gates and discard gates.

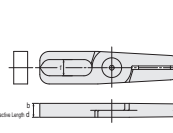

Applicable models	Cutting capacity φ (mm)				a	b	c	d	e	Weight (g)	Part Number		Unit Price	
	Soft resin	Hard resin	Copper wire	Iron wire							Body No.	Cutting edge Shape		1-9 pcs
MGT-NS3 MGT-NR3	-	-	1	0.5	24	7	25	12	4	35	MN3	A	S	
	2	-	-	-	24	7	15	11.5	4	35		A	P	
	2	-	-	-	20	7	f6 g 11	7	3.5	35		A	E	
	-	-	1	0.5	24	7	5.8	13	5	35		B	J	
MGT-NS5 MGT-NR5	-	-	1	0.5	24	7	25	12	4	40	MN5	A	S	
	2	-	-	-	24	7	15	11.5	4	40		A	P	
	2	-	-	-	20	7	f6 g 6.6	7	3.5	40		A	E	
	-	-	1	0.5	24	7	5.8	13	4	40		B	J	
MGT-NS7 MGT-NR7	3	2	-	-	27	9	30	11.5	4	80	MN7	A	P	
	3	2	-	-	26	9	f8 g 14.8	9	4	85		A	E	
MGT-NS10L MGT-NR10L	-	-	1.8	1.2	35	12	30	20	5	120	MN10L	A	S	
	4	2.6	-	-	35	12	15	16	5	120		A	P	
	3.5	2	-	-	61	12	7	34	10	165		A	J141	
MGT-NS20 MGT-NR20	-	-	2.6	2	35	12	30	20	9	140	MN20	A	S	Quotation
	7	5	-	-	35	12	15	16	11	125		A	P	
	7	5	-	-	28	12	f10 g 15.5	12	8	135		A	E	
	7	5	-	-	35	12	8	18	11	125		A	J	
	6	4	-	-	65	12	7	20	16	230		A	JL	
	10×1.5	8×1	-	-	55	55	8	26	9.5	270		A	ML1498	
	10×1.5	8×1	-	-	55	55	8	26	9.5	270		A	MR1499	
	-	5	-	-	35	12	8	18	11	125		A	JB	
	5.5	3.5	-	-	62	12	f14 g 45	12	16.5	202		A	E1205	
	6	-	-	-	60	31	7	23	16	240		A	H	
6.5	4.5	-	-	61	12	7	36	14	185	A	B39			
MGT-NS30 MGT-NR30	-	-	3.3	2.8	43	17	30	25	9	370	MN30	A	S	
	10	6.5	-	-	66	17	15	38	16	380		A	P	
	10	6.5	-	-	45	17	f13 g 28	17	12	395		A	E	
	10	6.5	-	-	52	17	8	28	11	370		A	J	
	8	5	-	-	75	17	8	25	19	470		A	JL	
	15×2	10×1.5	-	-	55	68	10	35	13	520		A	ML1435	
	15×2	10×1.5	-	-	55	68	10	35	13	520		A	MR1395	
	8	5	-	-	65	17	7	41	17.5	355		A	J163	
	7	4.5	-	-	60	62	8	36	16	520		A	L525	

• The capacity is a reference guideline. It depends on the usage conditions.  
• The weight includes the blade spring.

☞ For quantities not displayed here, refer to our MISUMI website for more information.



Order

Part Number

MN3AS  
MN3AP



Days to Ship

Quotation



Price

Quotation