

# EJECTOR PINS WITH Z GROOVE PROCESSED

— L DIMENSION DESIGNATION TYPE —

L dimension designation type

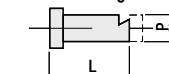

Ⓢ Non JIS material definition is listed on P.1351 - 1352

RoHS



Select a tip shape

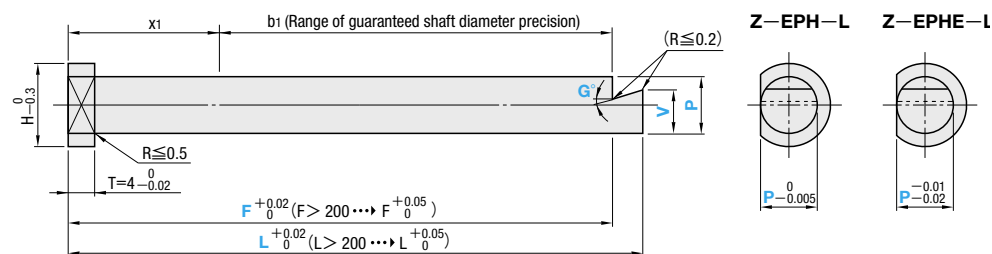

$$\textcircled{V} - (L - F) \tan G \geq 1$$

Range of guaranteed shaft diameter precision (Details [P.1301](#))  
T4 → x1 max.30

SKH51 equivalent  
58~60HRC  
Range of guaranteed base material hardness (Details [P.1303](#))

Ⓢ To determine the shape position, key flat cutting is made at the standard 0°

| Part Number | Head thickness | P              | G    | V     |
|-------------|----------------|----------------|------|-------|
| Z-EPH-L     | 4mm(T4)        | 0<br>-0.005    | ±30° | ±0.05 |
| Z-EPHE-L    |                | -0.01<br>-0.02 |      |       |

| H  | T | Part Number Type    | 0.01mm increments |              | 0.5mm increments | 1° increments | 0.01mm increments |  |
|----|---|---------------------|-------------------|--------------|------------------|---------------|-------------------|--|
|    |   |                     | P                 | L            | V                | G             | F                 |  |
| 4  | 4 | Z-EPH-L<br>Z-EPHE-L | 2                 | 50.00~300.00 | 1.5 ≤ V < P      | 0~45          | L - F ≤ 10        |  |
| 5  |   |                     |                   |              |                  |               |                   |  |
| 6  |   |                     |                   |              |                  |               |                   |  |
| 7  |   |                     |                   |              |                  |               |                   |  |
| 8  |   |                     |                   |              |                  |               |                   |  |
| 9  |   |                     |                   |              |                  |               |                   |  |
| 10 |   |                     |                   |              |                  |               |                   |  |
| 11 |   |                     |                   |              |                  |               |                   |  |
|    |   |                     |                   | 2.5          | 50.00~350.00     |               |                   |  |
|    |   |                     |                   |              |                  |               |                   |  |
|    |   |                     |                   |              |                  |               |                   |  |

$$\textcircled{V} - (L - F) \tan G \geq 1$$

Order **Part Number**  
Type P - L - V - G - F  
Z-EPH-L 5 - 150.00 - V2.0 - G5 - F145.00

Days to Ship **Quotation**

Price **Quotation**

Alterations **Part Number** - L - V - G - F - (AKC · AWC...etc.)  
Z-EPH-L5 - 150.00 - V2.0 - G5 - F145.00 - TC2  
**Quotation**

| Alterations | Code | Spec.   | 1Code            | Alterations | Code       | Spec.   | 1Code            |
|-------------|------|---|------------------|-------------|------------|---|------------------|
|             | AKC  | AKC=1° increments<br>Ⓢ 0 < AKC < 360<br>Ⓢ No need to designate AKCO |                  |             | KAC<br>KBC | Varied width parallel flats cutting<br>P/2 ≤ KAC < H/2<br>KBC = 0.1mm increments only<br>KAC < KBC < H/2<br>Ⓢ Combination with other key flat cutting not available |                  |
|             | AWC  | AWC=1° increments<br>Ⓢ 0 ≤ AWC < 360                                |                  |             | HC         | HC=0.1mm increments<br>Ⓢ P+1 ≤ HC < H   |                  |
|             | ARC  | ARC=1° increments<br>Ⓢ 0 ≤ ARC < 360                                | <b>Quotation</b> |             | HCC        | HCC=0.1mm increments<br>Ⓢ P+1 ≤ HCC < H-0.3   | <b>Quotation</b> |
|             | ADC  | ADC=1° increments<br>Ⓢ 0 ≤ ADC < 360                                |                  |             | TC         | TC=0.1mm increments<br>Ⓢ 2 ≤ TC < 4<br>(Dimensions L and F remain unchanged)<br>Ⓢ 4 - TC ≤ Lmax. - L  | <b>Quotation</b> |
|             | KGA  | KGA=1° increments<br>Ⓢ 0 < KGA < 360                                |                  |             | NHC        | Numbering on the head<br>How to order <a href="#">P.54</a>  |                  |
|             | KGB  | KGB=1° increments<br>Ⓢ 0 < KGB < 360                                |                  |             | NHH        | Automatic sequential numbering on the head<br>How to order <a href="#">P.54</a>   |                  |



Example

### Characteristics

Z groove ejector pins have the function of sprue lock by undercutting of the tip groove.

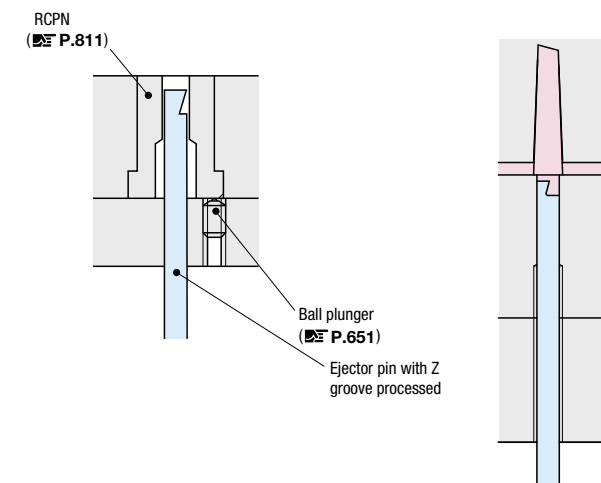

### Ejector Pins with Tip Processed

**5A (Z groove)**

- 0° ≤ G ≤ 45°
- 1.5 ≤ V < P
- L - F ≤ 10
- V - (L - F) tan G ≥ 1
- ⊗ R designation not available

SKH51 equivalent L dimension designation type [P.97](#)

SKH51 equivalent L · P dimension designation type [P.99](#)

Straight Ejector Pins  
High Speed Steel SKH51 equivalent