

Note that, for some of the types shown here, order might be unable to be received by the MISUMI Malaysia, Indonesia and/or India offices.

# Pre-Assembly Insertion Nuts for Aluminum Extrusions - Others

## For 8-45 Series (Slot Width 10mm)

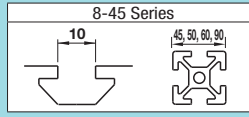

# Post-Assembly Insertion Nuts / Stoppers for Aluminum Extrusions - Standard

## For 8-45 Series (Slot Width 10mm)

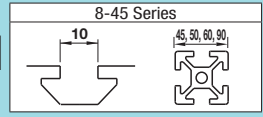

### Pre-Assembly Insertion Lock Nut

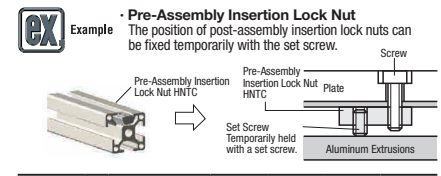
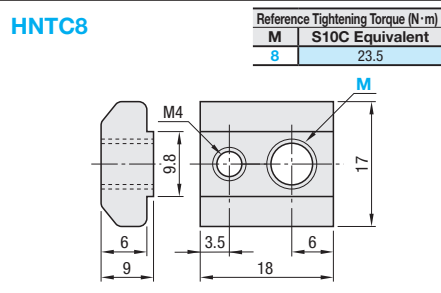

Part Number	M	Accessory	Unit Price	Volume Discount Rate
			1 - 499 pc(s)	500-749   750-999   1000-1500
HNTC8	8	M4x8 Set Screw for Locking 1 pc.		

\* Overall length is shorter than Pre-Assembly Insertion Nuts HNTT. Suitable for installing sensors or other components closely together.  
\* Stopper is not included.

### Pre-Assembly Insertion Short Nuts

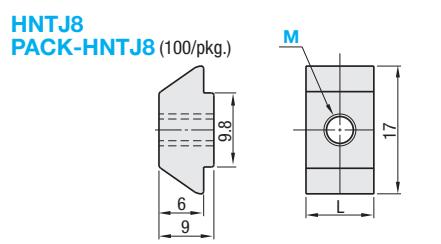

**Ordering Example**

Part Number	M
HNTJ8	8
PACK-HNTJ8	8

Part Number	M	L	HNTJ8			PACK-HNTJ8			
			Unit Price	Volume Discount Rate		Unit Price	Volume Discount Rate		
			1 - 499 pc(s)	500-749	750-999	1000-1500	1 - 9 pkg(s)	10-19	20-30
HNTJ8	3	8							
PACK-HNTJ8	4	8							
	8	12							

100 pcs. per package

### Pre-Assembly Insertion Offset Nuts

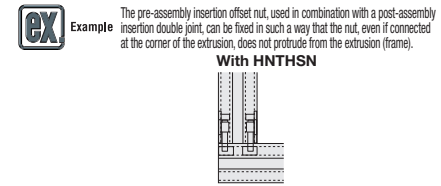
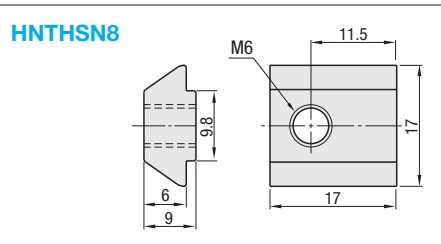

Part Number	Unit Price
HNTHS8	1 - 150 pc(s)

### Pre-Assembly Insertion Square Nuts

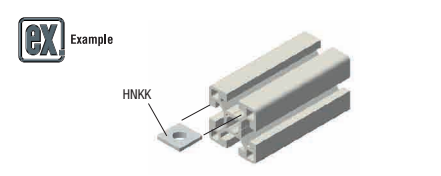
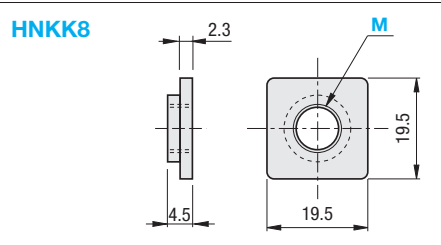

Part Number	M	Unit Price	Volume Discount Rate
HNKK8	4 5 6 8	1 - 9 pkg(s)	10-19   20-30

### Metal Stoppers for Pre-Assembly Insertion Square Nuts

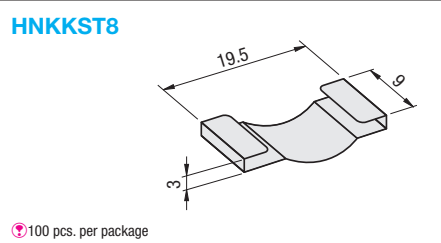

Part Number	Applicable Pre-Assembly Insertion Nut	Unit Price	Volume Discount Rate
HNKKST8	HNKK8	1 - 9 pkg(s)	10-19   20-30

**Applicable Extrusions and Brackets**

Applicable to extrusions and brackets with the same part number.

Part Number	Extrusion	Bracket
HNTHS8	<input type="checkbox"/>	<input type="checkbox"/>
HNKK8	<input type="checkbox"/>	<input type="checkbox"/>
HNKKST8	<input type="checkbox"/>	<input type="checkbox"/>
HNTT8	<input type="checkbox"/>	<input type="checkbox"/>
HNST8	<input type="checkbox"/>	<input type="checkbox"/>
HFS8	<input type="checkbox"/>	<input type="checkbox"/>
HBLFS8	<input type="checkbox"/>	<input type="checkbox"/>

### Post-Assembly Insertion Stopper Nuts

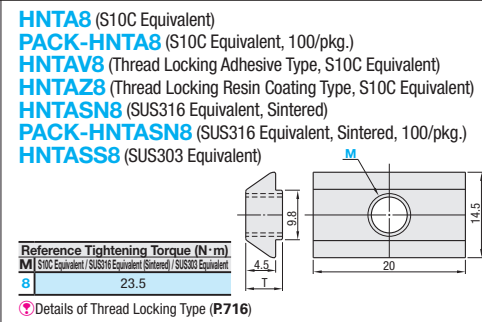
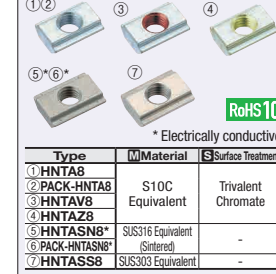

Part Number	M	T	Unit Price	Volume Discount Rate		
			1 - 499 pc(s)	500-749	750-999	1000-1500
HNTA8 (S10C Equivalent)	4 5 6	6.5				
HNTAV8 (Thread Locking, S10C Equivalent)	8					
HNTAZ8 (Thread Locking, S10C Equivalent)	8					
HNTAS8 (SUS316 Equivalent, Sintered)	4 5 6 8	6.0				
HNTASS8 (SUS303 Equivalent)	8	6.5				

Bulk Packages 100 pcs. per package

Part Number	M	T	Unit Price (1 - 10 packages)	
			Package Price	Price per Pkg.
PACK-HNTA8 (S10C Equivalent)	4 5 6	6.5		
PACK-HNTAS8 (SUS316 Equivalent, Sintered)	4 5 6 8	6		

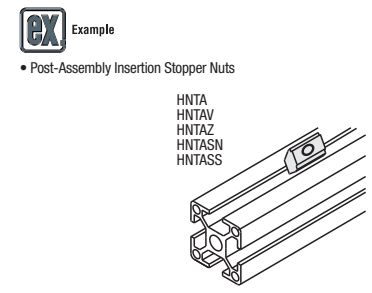

### Post-Assembly Insertion Stoppers

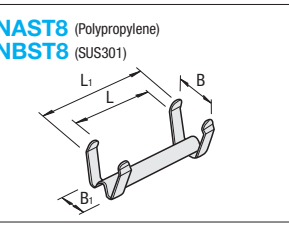
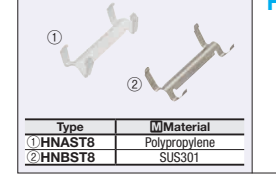

Part Number	Applicable Stopper Nut	Color	L	B	L1	B1	Unit Price	Volume Discount Rate	
							1 - 499 pc(s)	500-999	1000-1500
HNAST8	HNTA8 HNTAV8 HNTAZ8 HNTAS8 HNTASS8	White	21	11.1	26	9.8			
HNBST8			23	12.5	28	8			

### Post-Assembly Insertion Nut and Stopper Set

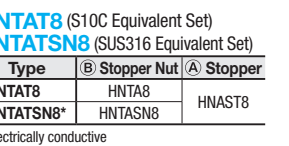

Part Number	M	Unit Price	Volume Discount Rate		
		1 - 499 pc(s)	500-749	750-999	1000-1500
HNTAT8	4 5 6				
HNTATS8	4 5 6 8				

### Post-Assembly Insertion Nut and Metal Stopper Set

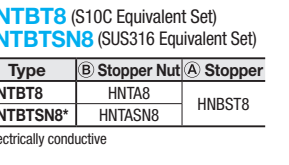
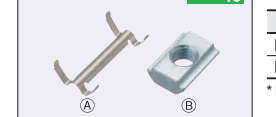

Part Number	M	Unit Price	Volume Discount Rate		
		1 - 499 pc(s)	500-749	750-999	1000-1500
HNTBT8	4 5 6				
HNTBTS8	4 5 6 8				

### Post-Assembly Insertion Nuts

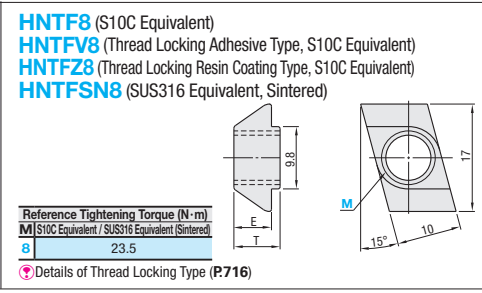
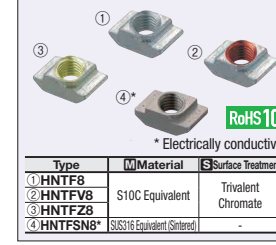

Part Number	M	E	T	Unit Price	Volume Discount Rate		
				1 - 499 pc(s)	500-749	750-999	1000-1500
HNTF8 (S10C Equivalent)	4 5 6 8						
HNTFV8 (Thread Locking, S10C Equivalent)	8		6.0				
HNTFZ8 (Thread Locking, S10C Equivalent)	8						
HNTFS8 (SUS316 Equivalent, Sintered)	4 5 6 8	6.4	8.9				

