

# Blind Joint Components

Single Joint Kits for 8 Series (Slot Width 10mm) Aluminum Extrusions

For details of fastening method, see P.609.  
Alterations necessary to use this component

Wrench Hole P.759 D Type Hole Alterations P.764

# Blind Joint Components

Center Joint Kits for 8 Series (Slot Width 10mm) Aluminum Extrusions

For details of fastening method, see P.605.  
Alterations necessary to use this component

M Type Hole Alterations P.766

Features: D holes added on the extrusions do not penetrate to the flat surface. Blind Joints with very good appearance.

## Single Joint Kits Standard Type



## Single Joint Kits Narrow Type

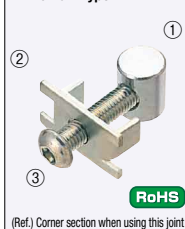

Type	Components					
	① Joint Nut		② Plate		③ Screw	
	M Material	S Surface Treatment	M Material	S Surface Treatment	M Material	S Surface Treatment
HSJ	SS400	Trivalent Chromate	SPCC	Trivalent Chromate	SCM435	Trivalent Chromate
HSJS	SUS316 Equivalent SUS304	-	SUS304	-	SUS304	-

Single Joint Kits - Standard  
Use it when edges of two extrusions are connected perpendicularly, after a hole is drilled in each extrusion.

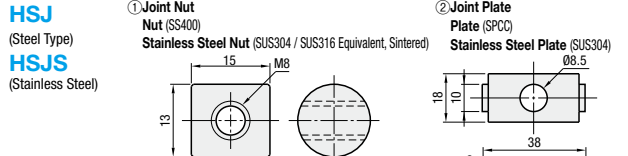

Single Joint Kits - Narrow  
Shape of Narrow Type has altered so that its joint section does not collide with the panel when the panel is inserted into the extrusion slot.

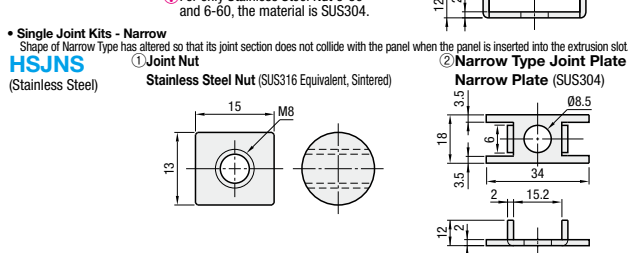

## Extrusions Applicable to Single Joint

(Not applicable to extrusions not listed in the table.)

Features	Extrusion		
	Type	No.	Applicable Single Joint
Four-Side Slots	HFS8	4040	HSJ8 / HSJS8 / HSJNS8
	GFS8	4080	HSJ8 / HSJS8 / HSJNS8
	CAFS8	40120	HSJ8 / HSJS8 / HSJNS8
	NEFS8	40160	HSJ8 / HSJS8 / HSJNS8
	HFS8	4040	HSJ8 / HSJS8 / HSJNS8
3-Side Slot 1-Side Flat	HFS8	4040	HSJ8 / HSJS8 / HSJNS8
	GFS8	4040	HSJ8 / HSJS8 / HSJNS8
Two-Side Slots Two Flats	HFS8	4040	HSJ8 / HSJS8 / HSJNS8
	GFS8	4040	HSJ8 / HSJS8 / HSJNS8
Two Slots on Opposite Sides	HFS8	4040	HSJ8 / HSJS8 / HSJNS8
	GFS8	4040	HSJ8 / HSJS8 / HSJNS8
One-Side Slot Three Flats	HFS8	4040	HSJ8 / HSJS8 / HSJNS8
	GFS8	4040	HSJ8 / HSJS8 / HSJNS8
Light Type	HFSL8	4040	HSJ8 / HSJS8 / HSJNS8
	HFSB8	4040	HSJ8 / HSJS8 / HSJNS8
	EF8	4080	HSJ8 / HSJS8 / HSJNS8
	HFSB8	4080	HSJ8 / HSJS8 / HSJNS8
Black Anodize	HFS8	4040	HSJ8 / HSJS8 / HSJNS8
	HFSL8	4080	HSJ8 / HSJS8 / HSJNS8

Type	Part Number	Extrusion (Type)	① Joint Nut (1 pc.)		② Joint Plate		③ Hex Socket Button Head Cap Screw		Steel Type	Stainless Steel Type				
			SS400	SUS304/SUS316 Equivalent	SPCC	SUS304	SCM435	SUS304	Unit Price	Unit Price				
Standard Type	HSJ HSJS (Stainless Steel)	8	Nut 8	Stainless Steel Nut 8	Plate 8	1	Stainless Steel Plate 8	1	Button Head Cap Screw M8-35	1	1-99 pc(s)	100-120	1-99 pc(s)	100-120
Narrow Type	HSJNS (Stainless Steel)	8	-	Stainless Steel Nut 8	-	-	Narrow Plate 8	1	Button Head Cap Screw Stainless Steel M8-35	1	-	-	-	-

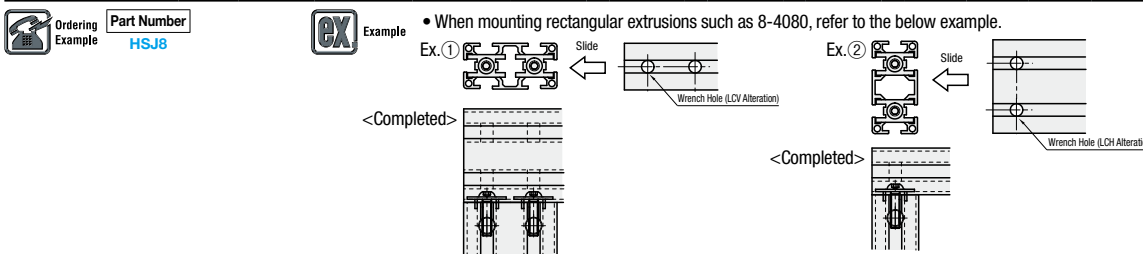

Features: Single joint installable without alterations. (Wrench holes are necessary on the mating extrusion.)

## Aluminum Extrusions with Built-in Single Joints

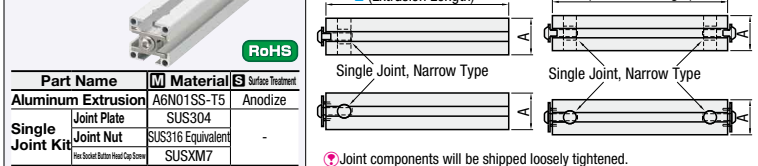

Part Number	Joint Component	L (0.5mm Increment)	Extrusion	Built-in Joint Component Single Joints Quantity	A	Required Wrench for Tightening	Extrusion Unit Price	Joints, Others
JFSS 8-4040	L (Left End Face only) W (Double End Faces)	100-4000	HFS8-4040 (P631)	1 2	40	For M8		

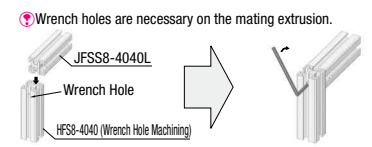

Alterations	Code	Spec.		Alterations	Code	Spec.	
		Extrusion	Depth			Extrusion	Hole Dia.
Right End Face Tapping	RTP	8-4040	M12 36	Right End Face Wrench Hole	RCH	8-4040	20 8
					RCV		

Features: Requires only one screw for tightening. Work efficiency enhancing anti-rotation type is added.

## Center Joint Kits Pre-Assembly Insertion Type



## Center Joint Kits Post-Assembly Insertion Type

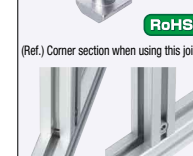

Type	Components (1 pc. each)					
	Joint Guide		Center Post		Set Screw	
	Type	M Material	Type	M Material	Size	M Material
HMJ	Standard	SUS304	Pre-Assembly Insertion Standard Direction	SCS13	NO.8:M6x16 (Surface Treatment: Black Oxide Film)	SCM435
HMJR	Standard	SUS304	Pre-Assembly Insertion 90-Degree Rotated	SCS13		
HAMJ	With Rotation Stopper	SUS304	Pre-Assembly Insertion Standard Direction	SCS13		
HZJ	With Rotation Stopper	SUS304	Pre-Assembly Insertion Standard Direction	SCS13		

## Joint-Guide (Standard)

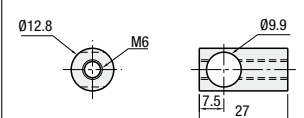

## Pre-Assembly Insertion Center Post Standard Direction

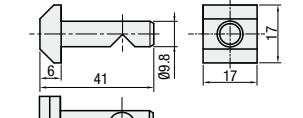

## Joint-Guide (with Rotation Stopper)

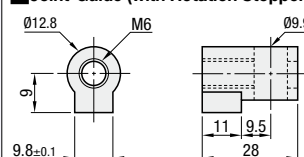

## Post-Assembly Insertion Center Post

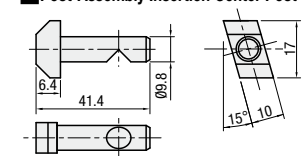

Applicable Extrusion No.	[Exception] Extrusion Not Available
8-4040*1 8-4080 8-40120 8-40160*2	*1 Curved HFS8-4040 cannot be used, because Wrench Hole Machining is not allowed. *2 Cannot be used in the long side direction because standard hole machining is not allowed.

Part Number	Type	No.	Center Post	Accessory			HMJ HMJR HAMJ HZJ HAZJ					
				Quantity	Joint Guide	Quantity	Set Screw	Quantity	Unit Price	Volume Discount Rate	Unit Price	Volume Discount Rate
HMJ HZJ	Pre-Assembly Insertion Standard Direction Type	8	Pre-Assembly Insertion Center Post 8	1	Joint Guide 8	1	M6x16	1	1-99 pc(s)	100-120	1-99 pc(s)	100-120
HMJR	Pre-Assembly Insertion 90-Degree Reversal Type	8	Pre-Assembly Insertion Center Post 8 Rotated	1	Joint Guide 8	1	M6x16	1	-	-	-	-
HAMJ HAZJ	Post-Assembly Insertion Type	8	Post-Assembly Insertion Center Post 8	1	Joint Guide 8	1	M6x16	1	-	-	-	-

## Aluminum Extrusions with Built-in Center Joints

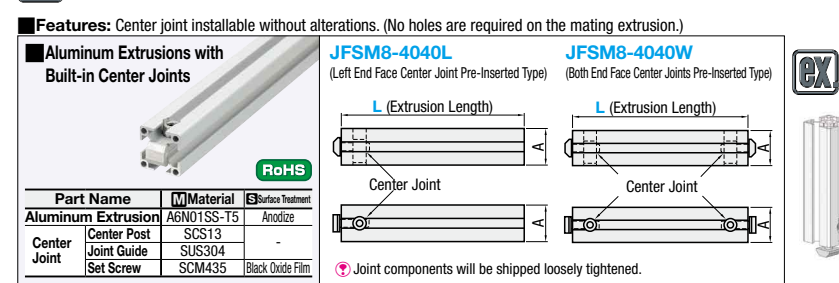

Part Number	Joint Component	L (0.5mm Increment)	Extrusion	Built-in Joint Component Center Joint Quantity	A	Required Wrench for Tightening	Extrusion Unit Price	Joints, Others
JFSM 8-4040	L (Left End Face only) W (Double End Faces)	100-4000	HFS8-4040 (P631)	1 2	40	For M6		



Alterations	Code	Spec.		Alterations	Code	Spec.	
		Extrusion	Depth			Extrusion	Hole Dia.
Right End Face Tapping	RTP	8-4040	M12 36	Right End Face Wrench Hole	RCH	8-4040	20 8
					RCV		