

Slit Steel Pipe Nozzles / Nozzles for Pipe Washing

Steel Hollows for Air Nozzles / Terminals for Nozzles

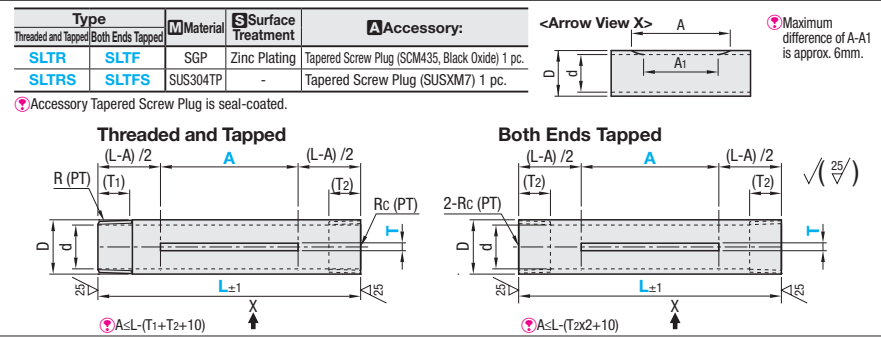

Part Number Type	No.	L 1mm Increment	A 1mm Increment	T 0.5mm Increment	R (PT)	T1	T2	D	d	SLTR, SLTF Unit Price			SLTRS, SLTFS Unit Price		
										Min. L ~ 250	L251~500	L501~700	Min. L ~ 250	L251~500	L501~700
Threaded and Tapped	6A	90~700	50~500	0.5~2.0	1/8	10	11	10.5	-	5.7	-	-	-	-	-
	8A	15				13	13.8	9.2	7.8	-	-	-	-	-	
SLTR SLTRS	10A	100~700	50~500	0.5~2.0	3/8	17	16	17.3	12.7	10.9	-	-	-	-	-
	15A	20				18	21.7	16.1	16.1	-	-	-	-	-	
Both Ends Tapped	20A	110~700	50~500	0.5~2.0	1/2	23	20	27.2	21.6	21.4	-	-	-	-	-
	25A					1	25	22	34	27.6	27.2	-	-	-	-

Ordering Example: Part Number - L - A - T
SLTR8A - 300 - A200 - T1.0

There is no surface treatment on threaded part and slitting and its peripheral part. * Marks may be left on the surface when tightening screws.
Excessive tightening may deform the female thread portion. Wrap with sealing tape for air tightness and after manual tightening, tighten it up further by giving one rotation or so.

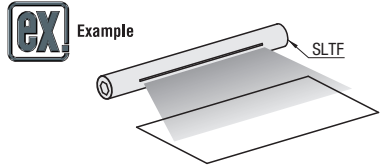

Features: Simple nozzles with a slit in a pipe. Suitable when the distance to the object is short.

Precaution for Use: Actual spray width and colliding force vary. And the slit width may increase depending on air pressure. When more even blows are required, use Air Nozzles (P.1455) and Steel Hollows for Air Nozzles (P.1474).

The drawing of the app. example is a reference image.

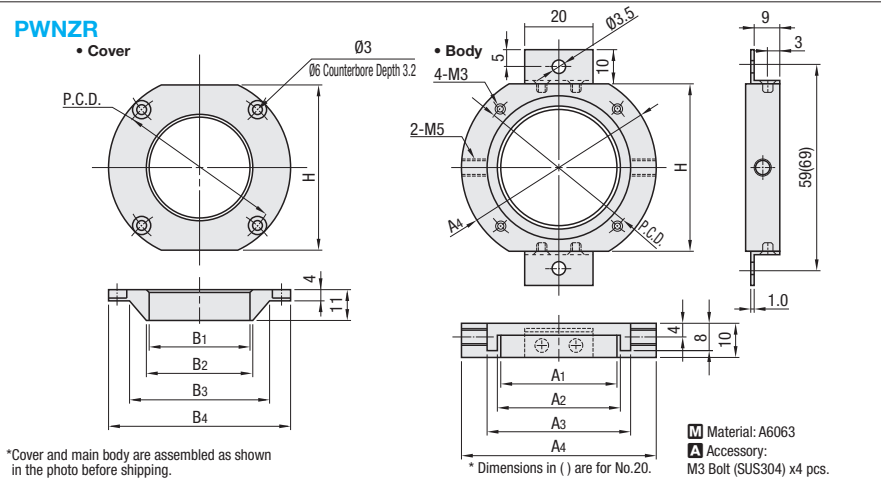

Part Number Type	No.	H	Cover Dimension				Body Dimension				P.C.D.	Applicable Max. Pipe O.D.	Unit Price
			B1	B2	B3	B4	A1	A2	A3	A4			
PWNZR	10	49	26	28	40	57	34	36	42	57	49	Ø20	
	20	59	36	38	50	67	44	46	52	67	59	Ø30	

Ordering Example: Part Number PWNZR10

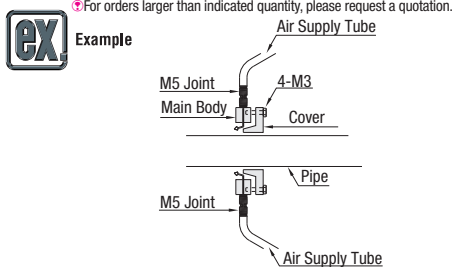

Structure Diagram

Step 1: Insert the pipe into the nozzle to clean it.
Step 2: Apply the air pressure from both sides by an air compressor, and air will out-flow evenly from internal clearance (0.3mm).

Specifications
Nozzle Air Pressure MPa (kg/cm²) when service air pressure is 0.69MPa (7kg/cm²).
- No.10 0.15(1.54)
- No.20 0.11(1.19)

Use for blowing around cylindrical workpiece (pipe, etc.).

Features: Can be used as air curtains when combined with Flat Type Air Nozzle on P.1455.

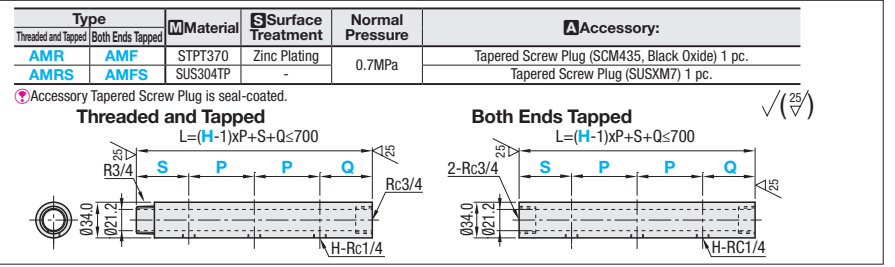

Part Number Type	No.	Number of Side Tapped Holes H	Pitch P 1mm Increment	S, Q 1mm Increment	AMR, AMF Unit Price					AMRS, AMFS Unit Price										
					H1, 2	H3, 4	H5, 6	H7, 8	H9, 10	H1, 2	H3, 4	H5, 6	H7, 8	H9, 10						
Threaded and Tapped Both Ends Tapped	AMR	AMRS	20A	1~10	60~80	35~80														

When H (the number of side tapped holes) is 1, specifying Pitch P is not necessary.

Part Number	H (Number of Holes)	P	S	Q
AMR20A	1	-	S40	Q50
AMF20A	8	P70	S35	Q35

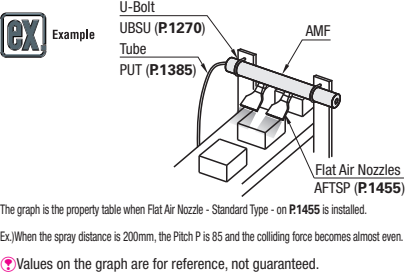
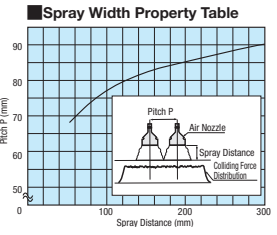

Terminals for Nozzles Clamp Type

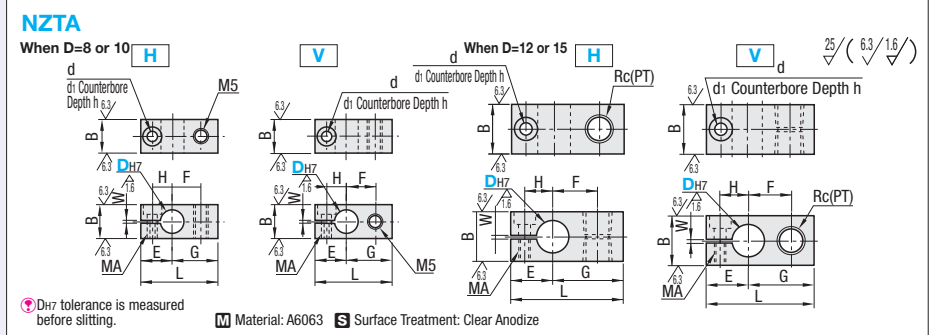

Part Number Type	D	No.	Rc(PT)	B	L	E	G	H	F	MA	d	d1	h	W	Included Bolt	Unit Price
10	H	16	30	13.5	16.5	8.5	10	M4	4.5	8	4.5	1.5	SCB4-10			
12	H	18	40	15	25	10	16	M4	4.5	8	4.5	1.5	SCB4-10			
15	H	22	52	19	33	13	22	M5	5.5	9.5	5.5	1.5	SCB5-15			

Terminals for Nozzles Block Type

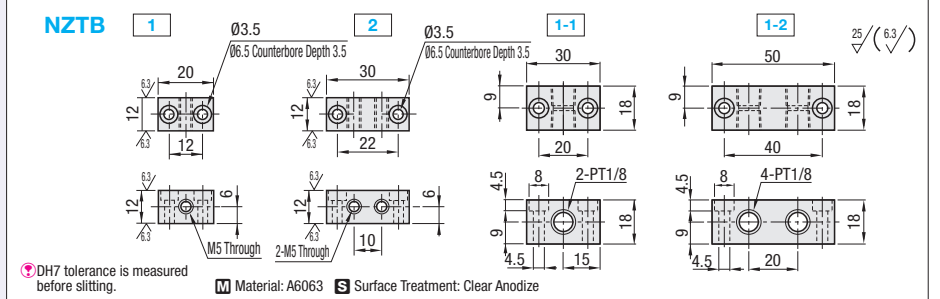

Part Number Type	No.	Unit Price
NZTB	1	
	2	
	1-1	
	1-2	

