

# Lead Screw

## One End Stepped / One End Double Stepped

Lead screws that are easy to combine with MISUMI Support Units in P.791~792.



Type				Material	Surface Treatment
Right-Hand Thread	Left-Hand Thread	Right and Left-Hand Thread	Precision Right and Left-Hand Thread		
MTSRK	MTSLK	MTSWKA/B	MTSYKA/B	S45C	Black Oxide
MTSBRK	MTSBLK	MTSBWKA/B	MTSBYKA/B		
RMTSRK	RMTSLK	RMTSWKA/B	-		
MTSTRK	MTSTLK	-	-	SUS303	-

Single Pitch Error ... ±0.02mm · Accumulated Pitch Error ... ±0.15/300mm  
 Type A or B are available for Right and Left-Hand Thread and Precision Right and Left-Hand Thread.

### Right-Hand Thread / Left-Hand Thread

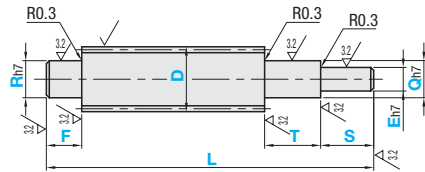

### Incomplete Threaded Portion of Right and Left-Hand Thread Type

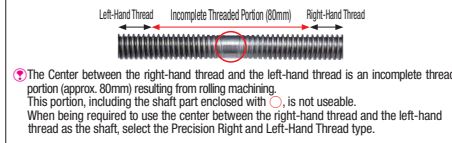

### Right and Left-Hand Thread

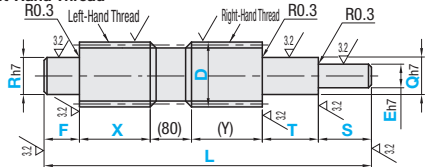

MTSWKB  
MTSBWKB  
RMTSWKB

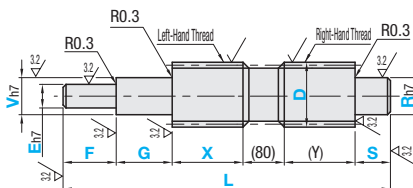

Incomplete threaded portion near the center (80mm) is not useable.

### Precision Right and Left-Hand Thread

MTSYKA  
MTSBYKA

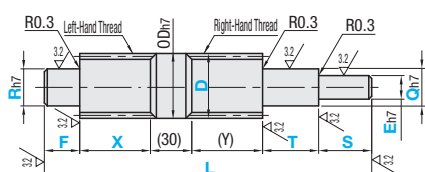

MTSYKB  
MTSBYKB

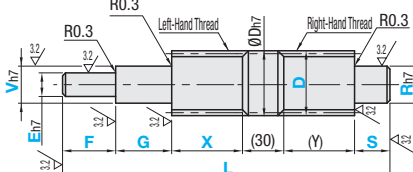

ØDh7-30mm part includes incomplete thread portion by about 1.5 pitches at both ends (in total about 3 pitches).

Part Number	D	1mm Increment		V / Q / R	E	Right and Left-Hand Thread / Precision Right and Left-Hand Thread		D	Pitch P
		L	F, G, T, S			X 1mm Increment	1mm Increment		
(Right-Hand Thread) MTSRK MTSBRK RMTSRK MTSTRK (Stainless Steel)	12 14 16 18	80-1000 100-1200		7 8 9 8 9 10 9 10 12				12 14 16 18	2 3 4
(Left-Hand Thread) MTSLK MTSBLK RMTSLK MTSTLK (Stainless Steel)	20 22 25	150-1200	2<F<E·Rx7 2<G<Vx7 2<S<E·Rx7 2<T<Qx7	10 12 14 15 10 12 14 15	Q/2<E<Q-1 V/2<E<V-1			20 22 25	4 5
(Right and Left-Hand Thread) MTSWKA/B MTSBWKA/B RMTSWKA/B (Precision Right and Left-Hand Thread) MTSYKA/B MTSBYKA/B	28 32 36 40 50	200-1200	When Q, V, R, and E<9 F, G, T, S will be 5x or less of Q, V, R, E.	14 15 16 17 20 14 15 16 17 20 25 17 20 25		When D=12, 14 50<X<460<485-F-G (Y)=L-80<30>-F-G-S-T-X (Y)≤500-S-T-40<15>  When D=16 ~ 50 50<X<560<585-F-G (Y)=L-80<30>-F-G-S-T-X (Y)≤600-S-T-40<15>		28 32 36 40 50	6 8

For Precision Right and Left-Hand Thread, D dimension 14, 16, 20, 25, 28 and 32 are available. When combined with the position indicators, Q and V standard dimensions will be 8 ~ 20. P.811, 812  
 D dimension 22, 36, 40 and 50 are not applicable to Stainless Steel. D dimension 25, 28 and 32 are applicable to Right-Hand Thread only.



Example

### Slide Base Transfer Unit

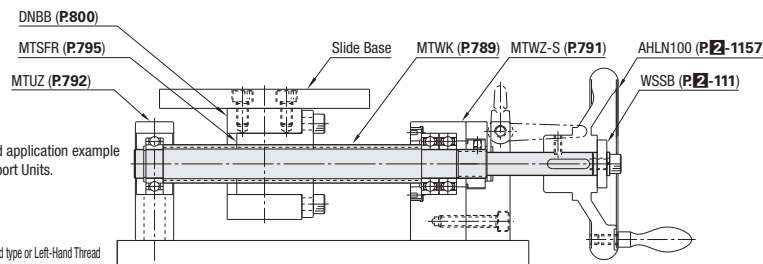

MTUZ	Lead Screw Support Unit - Support Side
MTSFR	Lead Screw Nut - Flanged
DNBB	Nut Bracket for Lead Screw
MTWK	Lead Screw - For Support Units
MTWZ-S	Lead Screw Support Units Stop Plate Set
AHLN100	Five Spoked Handwheel
WSSB	Metal Washer

When considering adopting support units in combination either with Right-Hand Thread type or Left-Hand Thread type lead screws, ordering of Lead Screws - For Lead Screw Support Unit Type in P.789 is recommended.



Part Number	-	L	-	F	-	R	-	T	-	Q	-	S	-	E	-	X	
Ordering Example	MTSRK16	-	456	-	F37	-	R10	-	T20	-	Q12	-	S10	-	E9	-	X10
Part Number	-	L	-	F	-	R	-	T	-	Q	-	S	-	E	-	X	
Ordering Example	MTSWKA16	-	456	-	F37	-	R10	-	T20	-	Q12	-	S10	-	E9	-	X10
Part Number	-	L	-	F	-	R	-	T	-	Q	-	S	-	E	-	X	
Ordering Example	MTSBWKB20	-	582	-	F10	-	E10	-	G15	-	V12	-	S25	-	R15	-	X200

Unit price for the product is price in the table multiplied by price multiplier.  
 Price in the table x Price Multiplier = Unit Price

### Right-Hand Thread / Left-Hand Thread

Part Number	D	Unit Price					
		Min. L - 200	L201-400	L401-600	L601-800	L801-1000	L1001-1200
MTSRK	12						
	14						
	16						
	18						
MTSBRK	20						
	22						
	25						
MTSLK	28						
	32						
MTSBLK	36						
	40						
	50						

### Right and Left-Hand Thread

Part Number	D	Unit Price					
		Min. L - 200	L201-400	L401-600	L601-800	L801-1000	L1001-1200
MTSWKA/B	12						
	14						
	16						
	18						
	20						
	22						
	25						
MTSBWKA/B	28						
	32						
	36						
	40						
	50						

### Right-Hand Thread / Left-Hand Thread, Stainless Steel

Part Number	D	Unit Price					
		Min. L - 200	L201-400	L401-600	L601-800	L801-1000	L1001-1200
MTSTRK	12						
	14						
	16						
	18						
MTSTLK	20						
	22						
	25						
MTSTRK	28						
	32						

### Low Temperature Black Chrome Plated Products - Right-Hand Thread / Left-Hand Thread

Part Number	D	Unit Price					
		Min. L - 200	L201-400	L401-600	L601-800	L801-1000	L1001-1200
RMTSRK	12						
	14						
	16						
	18						
RMTSLK	20						
	22						
	25						
RMTSWKA/B	28						
	32						

For low temperature black chrome plated products, add the price of low temperature black chrome plating shown above to the non-plated product prices.

### Precision Right and Left-Hand Thread

Part Number	D	Unit Price					
		Min. L - 200	L201-400	L401-600	L601-800	L801-1000	L1001-1200
MTSYKA/B	14						
	16						
	20						
	25						
MTSBYKA/B	28						
	32						



Alterations	Part Number	-	L	-	F	-	R	-	T	-	Q	-	S	-	E	-	X
	MTSTRK16	-	456	-	F37	-	R10	-	T20	-	Q12	-	S10	-	E9	-	MR4

Alterations	Code	Spec.	Flat Machining	Retaining Ring Groove	Wrench Flats	Coarse Tapping	Threaded	Square Chamfering	Keyway							
										FE (E part)	FR (R part)	AR (R part)	AE (E part)	SE (E part)	SR (R part)	MR (R part)

Specify an alteration position to be 2mm or more away from the stepped part. (For details, see P.787)  
 Do not specify multiple alterations in such a way that they overlap with each other in the rotating direction on the same shaft. (For details, see P.787)  
 When flat machining, wrench flats, square chamfering and keyway alterations are combined with each other, their orientations will be random. (For details, see P.787)  
 When adding multiple alterations, there must be 2mm or more clearance between each feature. (For details, see P.787)