

Note that, for some of the types shown here, order might be unable to be received by the MISUMI Thailand, Singapore, Indonesia, and/or India offices.

# Fiber Sensor (Amplifier)

## Ultrahigh-speed Digital Type, Potentiometer Type

The best quality products in the market are sold at the economical prices. Use in combination with Fiber Units on P2043-P2044. Two types are available: Ultrahigh-speed Digital Type to be linked up to 16 units, and economical Potentiometer Type manually adjustable by hand.

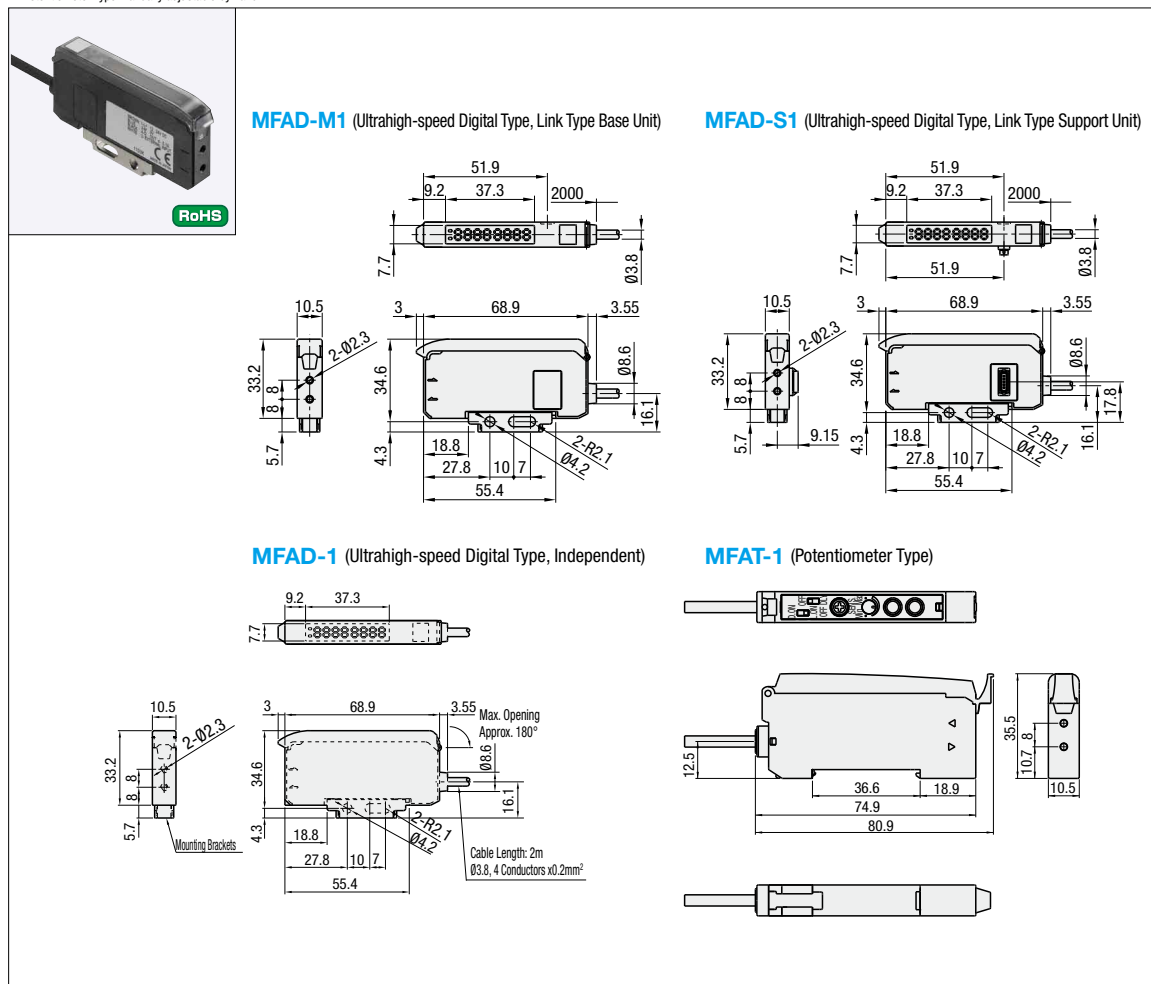

Part Number	Adjustment Method	Type	Number of Output	Output	Light Source	Unit Price 1 - 5 pc(s), 6 - 10 pcs., 11 - 30 pcs.	Volume Discount Rate
MFAD-M1	Digital Teaching Type	Link Type (Base Unit)	2 Output	NPN	Red 4 Element LED		
MFAD-S1		Link Type (Support Unit)			Red LED		
MFAD-1	Potentiometer	Independent	1 Output		Red LED		
MFAT-1							

For orders larger than indicated quantity, please check with WOS.



### Achieved Stable High Speed and Long Distance Detections

A problem of the existing single pulse emitting type is that it is sensitive to ambient light of the same pulse width and period. MFAD Series, however, is less influenced by ambient light as it emits light with two types of pulse width (long/short), which achieved both stable high speed and long distance detections. Combination with the high-powered LED and a high efficiency collection lens offers the detection distance equal to or more than the equivalent products from competitors.

### Performance Comparison with Products from Competitors

Detection Method	Fiber Unit Types	MFAD Series (7-EL Mode, 8ms)	Products from Competitors	Comparison
Through Beam Type	MFUSM-T1	4000mm	3600mm	x 1.1
Retrospective Type	MFUCD-T1	3600mm	3600mm	x 1
	MFUSM-D6	180mm	130mm	x 1.4
	MFUSM-D5	300mm	300mm	x 1

### Schematics

MFAD-1, MFAD-M1, MFAD-S1

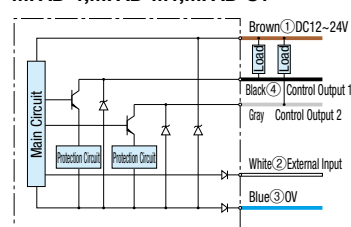

MFAT-1

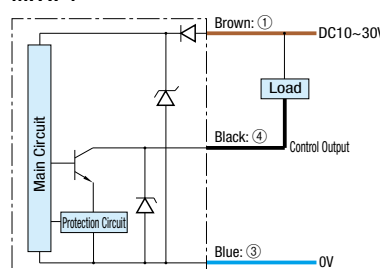

### About Connections

When external input is not in use, disconnect lead wires and cover them with the insulating tape to avoid contact with other terminals.

### Cautions

Connect Frame Ground Terminal to the ground when using Switching Regulator for power. Separate the sensor wiring and high voltage circuits or power lines to avoid malfunction and breakage due to noise. Avoid using during the power-on transitional state (approx. 300ms).

### Specifications

Part Number	MFAD-1	MFAD-M1 (Link Type Base Unit)	MFAD-S1 (Link Type Support Unit)	MFAT-1
<b>Light Source</b>	Red 4 Element LED (Wavelength: 632nm)			Red LED
<b>Number of Output</b>	1 Output	2 Output		1 Output
<b>Response Time (*1)</b>	1-HS Mode	16µs	16µs (Single Use) / 22µs (Linked)	250µs
	2-FS Mode	70µs	70µs (Single Use) / 85µs (Linked)	
	3-ST Mode	250µs		
	4-LG Mode	500µs		
	5-PL Mode	1ms		
	6-UL Mode	2ms		
	7-EL Mode	8ms		
<b>Sensitivity Adjustment</b>	Teachings and Manual Adjustment			10-turn Potentiometer
<b>Indicator Light</b>	1 Output Type: Output Indicator (Orange), 2 Output Type: Output Indicator (Orange) x2			Output Indicator: Orange LED Stability Indicator: Green LED
<b>Digital Indicator</b>	7 Segments 8-digit Indication (Red: 4 Digits, Green: 4 Digits)			-
<b>Control Output (*2)</b>	NPN Open Collector Load Current: 100mA or Less (*3), Applied Voltage: 30V DC or Less, Residual Voltage: 1.8V or Less			NPN Open Collector Max. 100mA / DC30V
<b>External Input</b>	Teaching (*4), Light Emission Stop, Synchronization, Counter Reset (*5)			-
<b>Timer Function</b>	No Delay, ON Delay, OFF Delay, One shot, ON Delay + OFF Delay, ON Delay + One Shot Available Setting Range: 0.1 ~ 9999ms			OFF Delay 40ms Fixed (Cancel Available)
<b>Output Mode</b>	Light ON / Dark ON Switchable in Function			Light ON / Dark ON Switchable with Switch
<b>Number of Linked Sensors (Including Base Unit)</b>	Link Not Available	Up to 16 pcs.		Link Not Available
<b>Number of sensors to avoid interference (*6)</b>	1-HS Mode	2 pcs. (Eco Mode (*7): OFF, for diSP), 4 pcs. (Eco Mode: rESP, for ALL)		-
	2-FS Mode	4 pcs. (Eco Mode: OFF, for diSP), 8 pcs. (Eco Mode: rESP, for ALL)		
	3-ST Mode	8 pcs. (Eco Mode: OFF, for diSP), 16 pcs. (Eco Mode: rESP, for ALL)		
	4-LG Mode	12 pcs. (Eco Mode: OFF, for diSP), 16 pcs. (Eco Mode: rESP, for ALL)		
	5-PL Mode			
	6-UL Mode			
	7-EL Mode			
<b>Connecting Type</b>	Cable Length: 2m, Ø3.8mm			Cable Length: 2m, Ø3.8mm
<b>Dielectric Strength</b>	20MΩ or More (at DC500V)			20MΩ or More (at DC500V)
<b>Rating</b>	<b>Power Supply Voltage</b>	DC 12 ~ 24V±10% Ripple 10% Included		DC 10 ~ 30V Ripple 10% Included
	<b>Power Consumption (Normal State)</b>	1 Output Type: 864mW (36mA or less for 24V) 2 Output Type: 936mW (39mA or less for 24V)		Current Consumption: 25mA or Less (at DC12V)
	<b>Power Consumption (Eco All)</b>	1 Output Type: 600mW (25mA or less for 24V) 2 Output Type: 672mW (28mA or less for 24V)		-
<b>Noise Resistant</b>	<b>IEC Standard</b>	CE Compliance		CE Compliance
<b>Environmental Protection</b>	<b>Service Ambient Temperature / Humidity</b>	-25 ~ 55°C (*8) / 35 ~ 85%RH (No Freezing / Condensation)		-25 ~ 55°C 35 ~ 85%RH (No Freezing / Condensation)
	<b>Service Environment Luminosity</b>	Sun Light: 10,000lx or Less, Incandescent Light 3,000lx or Less		
	<b>Vibration Resistance</b>	10 ~ 55Hz, Full Wave Amplitude 1.5mm in Respective X, Y, Z Direction 2 hours		
	<b>Shock Resistance</b>	Approx. 50G (500m/s <sup>2</sup> ) in Respective X, Y, Z Direction 3 times		
	<b>Protection Structure</b>	IEC Standard: IP50		IEC Standard: IP66
<b>Material</b>	Case: PPE, Cover: Polycarbonate			Case: PBT, Cover: Polycarbonate
<b>Mass</b>	Approx. 71g			Approx. 20g
<b>Accessory</b>	Mounting Brackets			

\*1 When Eco Mode is rESP or ALL, the response becomes 2 times longer. The mode with shorter response time has shorter detection distance; the longer the response time is, the longer the detection distance becomes.

\*2 The control output of 2 Output Type is Output 1 and Output 2, and the individual settings for threshold value adjustment, timer setting and light ON / dark ON are available. For ASC, only Control Output 1 is effective.

\*3 For single use, or 2 to 3 units are linked including a base unit. Use under 50mA or less when 4 to 8 units are linked, 20mA or less when 9 to 16 units are linked.

\*4 Teaching by external output is conducted in the mode which was previously operated in the main unit (Default: 2-Point Teaching).

\*5 Counter function is equipped for 2 Output Type only, thus 1 Output Type has no Counter Reset Input.

\*6 Number of sensors to avoid interference may become less than indicated above when linked with different response time settings.

\*7 For Eco Mode, display on the sub-monitor is off and the display on the main monitor is darker to save power.

\*8 When the single unit or total 2 to 3 units are linked including a base unit. Use between -25 and +50°C when the total 4 to 8 units are linked, -25 and +45°C when the total 9 to 16 units are linked.

\* Independent 1 Output Type does not have Control Output 2.