

MISUMI C-VALUE Casters

- Heavy Load - Wheel Material: Urethane

Comparing points of Similar Products | RoHS: Non-compliant. Running Test Criteria: Company internal standards based on GB (Run distance 1.5km). (Refer to P.2029 for details)

When ordering, select Part Number and Values from Selection Steps 1-3.

Ordering Example: **Part Number** 1 Type · 2 D - 3 Wheel Material
C-CTIJ100 - **U**

Swivel Type



CAD 2D 3D

Type	Main Body		Wheel	Bearing	
	M Material	S Surface Treatment	M Material (Color)	Swiveling Part	Wheel
C-CTIJ	SPCC	Zinc Plating	Urethane (Red)	Incorporated	Incorporated

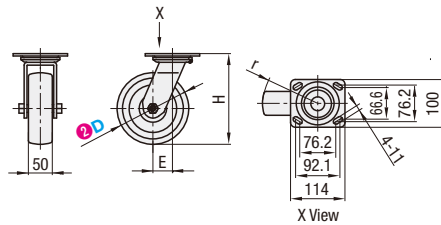

Part Number		Wheel Material	H	E	r	Allowable Load (N)	Mass (g)
1 Type	2 D						
C-CTIJ	100	U (Urethane)	142	32	82	4000	2880
	125		165	36	98.5	4500	3100
	150		190	41	116	5000	3540

Fixed Type



CAD 2D 3D

Type	Main Body		Wheel	Bearing	
	M Material	S Surface Treatment	M Material (Color)	Swiveling Part	Wheel
C-CTIK	SPCC	Zinc Plating	Urethane (Red)	None	Incorporated

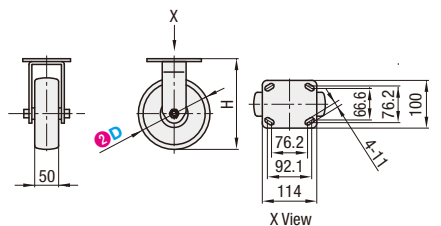

Part Number		Wheel Material	H	Allowable Load (N)	Mass (g)
1 Type	2 D				
C-CTIK	100	U (Urethane)	142	4000	2460
	125		165	4500	2780
	150		190	5000	2970

Swivel Type + Stopper



CAD 2D 3D

Type	Main Body		Wheel	Bearing	
	M Material	S Surface Treatment	M Material (Color)	Swiveling Part	Wheel
C-CTIS	SPCC	Zinc Plating	Urethane (Red)	Incorporated	Incorporated

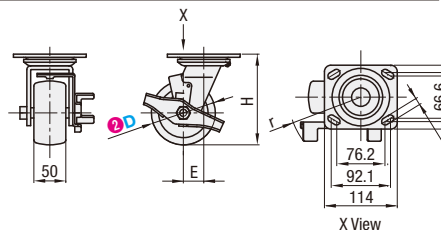

Part Number		Wheel Material	H	E	r	Allowable Load (N)	Mass (g)
1 Type	2 D						
C-CTIS	100	U (Urethane)	142	32	97	4000	3100
	125		165	36	100.5	4500	3400
	150		190	41	116	5000	3960

MISUMI C-VALUE Casters

- Heavy Load - Wheel Material: Nylon

Comparing points of Similar Products | RoHS: Non-compliant. Running Test Criteria: Company internal standards based on GB (Run distance 1.5km). (Refer to P.2029 for details)

When ordering, select Part Number and Values from Selection Steps 1-3.

Ordering Example: **Part Number** 1 Type · 2 D - 3 Wheel Material
C-CTJJ100 - **N**

Swivel Type



CAD 2D 3D

Type	Main Body		Wheel	Bearing	
	M Material	S Surface Treatment	M Material (Color)	Swiveling Part	Wheel
C-CTJJ	SPCC	Zinc Plating	Nylon (White)	Incorporated	Incorporated

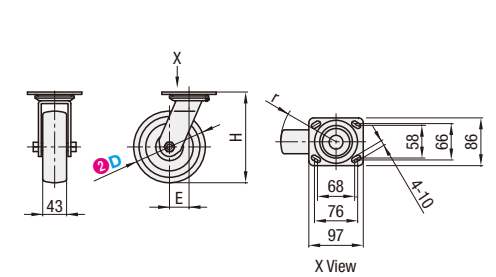

Part Number		Wheel Material	H	E	r	Allowable Load (N)	Mass (g)
1 Type	2 D						
C-CTJJ	100	N (Nylon)	135	25	75	2500	1093
	125		159	29.5	92	3000	1272
	150		185	35	110	4000	1840

Fixed Type



CAD 2D 3D

Type	Main Body		Wheel	Bearing	
	M Material	S Surface Treatment	M Material (Color)	Swiveling Part	Wheel
C-CTJK	SPCC	Zinc Plating	Nylon (White)	None	Incorporated

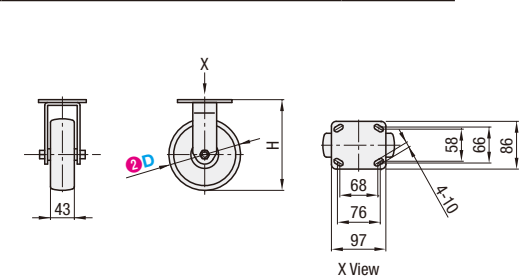

Part Number		Wheel Material	H	Allowable Load (N)	Mass (g)
1 Type	2 D				
C-CTJK	100	N (Nylon)	135	2500	897
	125		159	3000	1080
	150		185	4000	1520