

MISUMI C-VALUE Casters

- Medium Load - Wheel Material: Nylon

Comparing points of Similar Products | RoHS: Non-compliant. Running Test Criteria: Company internal standards based on GB (Run distance 1.5km). (Refer to P.2029 for details)

When ordering, select Part Number and Values from Selection Steps 1~3.

Ordering Example: Part Number (1) Type (2) D (3) Wheel Material
C-CTEJ80 - N

Swivel Type



CAD 2D 3D

Type	Main Body		Wheel	Bearing	
	M Material	S Surface Treatment	M Material (Color)	Swiveling Part	Wheel
C-CTEJ	SPCC	Zinc Plating	Nylon (White)	Incorporated	None

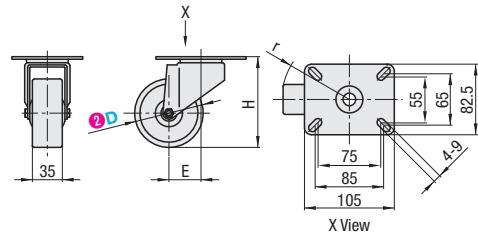

Part Number		Wheel Material	H	E	r	Allowable Load (N)	Mass (g)
1 Type	2 D						
C-CTEJ	80	N (Nylon)	106	37.5	77.5	1000	637
	100		128	40	90	1200	760
	125		153	47	109.5	1600	900

Fixed Type



CAD 2D 3D

Type	Main Body		Wheel	Bearing	
	M Material	S Surface Treatment	M Material (Color)	Swiveling Part	Wheel
C-CTEK	SPCC	Zinc Plating	Nylon (White)	None	None

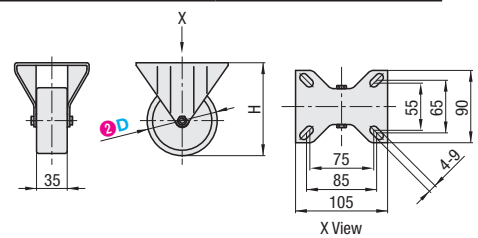

Part Number		Wheel Material	H	Allowable Load (N)	Mass (g)
1 Type	2 D				
C-CTEK	80	N (Nylon)	106	1000	397
	100		128	1200	600
	125		153	1600	680

Swivel Type + Stopper



CAD 2D 3D

Type	Main Body		Wheel	Bearing	
	M Material	S Surface Treatment	M Material (Color)	Swiveling Part	Wheel
C-CTES	SPCC	Zinc Plating	Nylon (White)	Incorporated	None

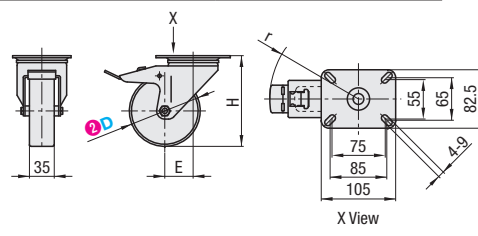

Part Number		Wheel Material	H	E	r	Allowable Load (N)	Mass (g)
1 Type	2 D						
C-CTES	80	N (Nylon)	106	37.5	125	1000	790
	100		128	40	1200	850	
	125		153	47	127	1600	1000

MISUMI C-VALUE Casters

- Medium Load - Wheel Material: Polypropylene

Comparing points of Similar Products | RoHS: Non-compliant. Running Test Criteria: Company internal standards based on GB (Run distance 1.5km). (Refer to P.2029 for details)

When ordering, select Part Number and Values from Selection Steps 1~3.

Ordering Example: Part Number (1) Type (2) D (3) Wheel Material
C-CTFJ80 - P

Swivel Type



CAD 2D 3D

Type	Main Body		Wheel	Bearing	
	M Material	S Surface Treatment	M Material (Color)	Swiveling Part	Wheel
C-CTFJ	SPCC	Zinc Plating	Polypropylene (White)	Incorporated	None

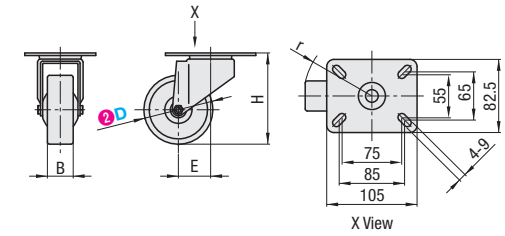

Part Number		Wheel Material	H	B	E	r	Allowable Load (N)	Mass (g)
1 Type	2 D							
C-CTFJ	80	P (Polypropylene)	106	35	37.5	77.5	600	608
	100		40		90	700	727	
	125		47		109.5	900	861	

Fixed Type



CAD 2D 3D

Type	Main Body		Wheel	Bearing	
	M Material	S Surface Treatment	M Material (Color)	Swiveling Part	Wheel
C-CTFK	SPCC	Zinc Plating	Polypropylene (White)	None	None

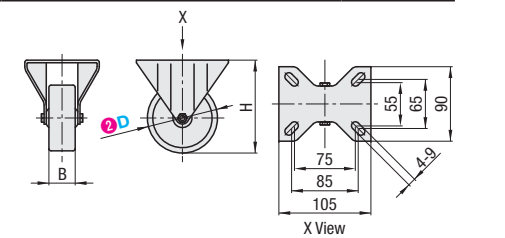

Part Number		Wheel Material	H	B	Allowable Load (N)	Mass (g)
1 Type	2 D					
C-CTFK	80	P (Polypropylene)	106	35	600	373
	100		700		574	
	125		900		647	

Swivel Type + Stopper



CAD 2D 3D

Type	Main Body		Wheel	Bearing	
	M Material	S Surface Treatment	M Material (Color)	Swiveling Part	Wheel
C-CTFS	SPCC	Zinc Plating	Polypropylene (White)	Incorporated	None

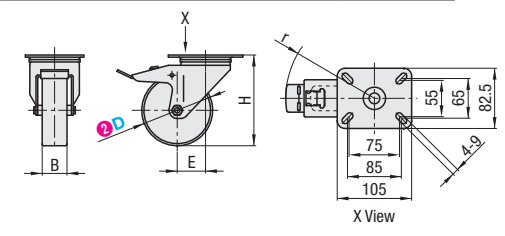

Part Number		Wheel Material	H	B	E	r	Allowable Load (N)	Mass (g)
1 Type	2 D							
C-CTFS	80	P (Polypropylene)	106	35	37.5	125	600	770
	100		40		700	828		
	125		47		127	900	976	