

## 13 Posts / Strut Clamps / Angle Plates

### Posts

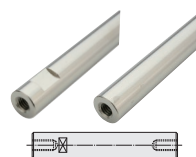

Round Posts  
Both Ends Tapped  
P.615



Round Posts One End  
Threaded, One End Tapped  
P.616

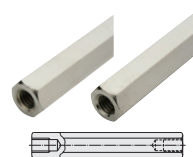

Hexagonal Posts Both Ends  
Tapped  
P.617

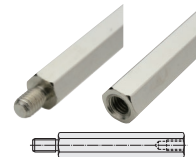

Hexagonal Posts One End  
Threaded, One End Tapped  
P.618

**P.613**

### Strut Clamps



One-Touch Strut Clamps  
P.620

**P.619**

### Angle Plates



Angle Plates Lightweight,  
High Rigidity Type  
P.622

**P.621**

## Simple Transmission Guide Device

Application Industries: **Medical** **Packing** **Logistics**

This figure shows a guide device installed on the automatic conveyor line for transmission, commonly used on conveyors and roller strips to shorten the production interval. It is widely used in packaging, medical devices and logistics industries.



Reference price

### 01 Strut Clamp ×4 P.620



Equal Dia. Type  
Hole Dia. 12mm

**104**  
THB/pcs

### 02 Urethane Molded Roller ×40 P.431



Urethane Hardness Shore 90 (Green)  
O.D. 30mm  
Length 50mm

**474**  
THB/pcs

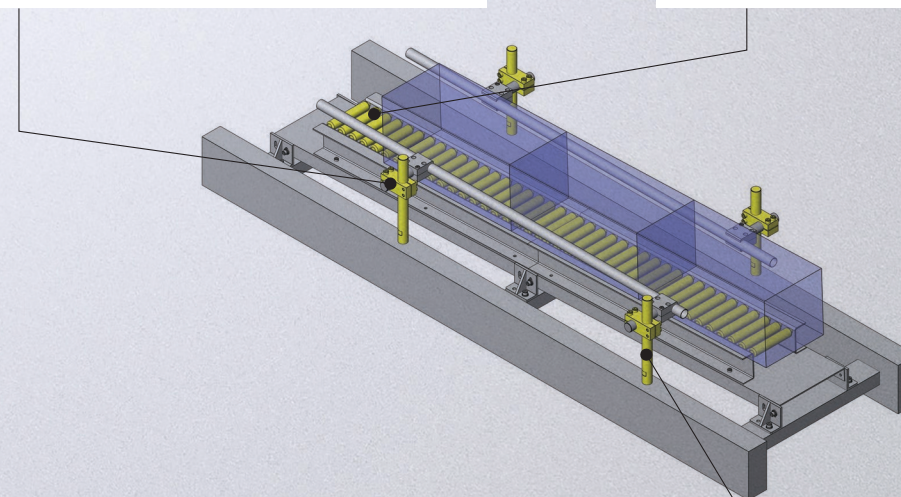

### 03 Round Post ×4 P.615



O.D. (φ) 12mm  
Length 40mm

**47**  
THB/pcs



# Economy series Round Posts / Hex Posts

Easy installation

Excellent anti-rust performance

vs Standard Type

Saving  
Up to  
**82%**

Specification difference between MISUMI standard product and Economy series

	MISUMI standard product	MISUMI Economy series
Material	SS400, SUS304	General Structural Steel or SUM23
Surface Treatment	Electroless Nickel Plating, Ferroferric Oxide Protective Film	Electroplated Nickel Plating or Electroless Nickel Plating
Length L	8≤L≤ 300	±0.2
Tolerance	300<L≤ 600 600<L≤1000	
	Tolerance ± 0.1 Tolerance ± 0.3 Tolerance ± 0.4	
O.D./Width across flats (mm)	5~50	6~15
Length L	5~1000	5~200
Dimension (mm)	Length can be specified	
Function	Supporting and mounting accessories	Supporting
Example of Use	<div><p>MISUMI standard post</p></div> <div><p>Economy series post</p></div>	

Example of Use

Equipment Name: Pull-in Conveyor

Function Description: Pull-in conveyor is a space-saving type of non-driven conveyor.

Function of hexagonal post in mechanism:

① The hexagonal post is used as a fastening connector in the mechanism to support the weight of all upper workpieces and increase the stability of the mechanism.

② Because the mechanism is often used in narrow space, the fastening method of hexagonal post is very simple and convenient for equipment installation and maintenance.

Salt Spray Test Report (Corrosion resistance:  
Economy series is equivalent to MISUMI standard product)

**MISUMI Economy series**  
Material: General Structural Steel or SUM Material  
Surface Treatment: Electroplated Nickel Plating or Electroless Nickel Plating  
Test Result: No Obvious Rust

**MISUMI standard product**  
Material: SS400  
Surface Treatment: Electroless Nickel Plating  
Test Result: No Obvious Rust

**Generic products in the market ①\***  
Material: S45C  
Surface Treatment: Electroless Nickel Plating  
Test Result: Large Area of Corrosion

**Generic products in the market ②\***  
Material: SUM23  
Surface Treatment: Electroplated Nickel Plating  
Test Result: Completely Rusty

· Test Method: Corrosion test according to standard ASTM B117 test method

· Test Conditions: ① Salt water spray test (5%NaCL35°C)  
② Volume of salt solution 1.0~2.0ml/hr  
③ Salt solution PH value 6.5~7.2

Corrosion resistance: MISUMI Economy series is equivalent to MISUMI standard product

Product use and relief groove reference value

· Feature: The wrench can be used for the hexagonal post in more places than the round post, and the wrench can be used even near the workpiece, and the wrench can be changed every 60°. When using the round post, make sure that there is room for turning the wrench.

When using a wrench on the hexagonal post

When using a wrench on the round post

· Post Dimensions of male thread relief groove (reference value)

M	MC	g
3	2.3	1
4	3	1.2
5	3.9	1.5
6	4.3	2
8	6.2	2.5



Round Posts Both Ends Tapped



ดูเพิ่ม > [คลิกที่นี่](#)

O.D. D 6mm, Length L 50mm

Saving Up to 78%  
vs Standard Type

Shipping from 6 days

29 THB



CAD 2D 3D

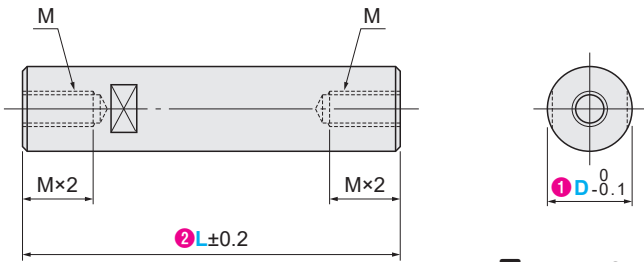

**M**Material: General Structural Steel or SUM Material  
**S**Surface Treatment: Electroplated Nickel Plating or Electroless Nickel Plating

How to create a model	1 O.D. D	2 Length L (Fixed Size Selection)								M (Coarse Thread)
		20	30	40	50	60	80	100	150	
<div>MISUMI Thailand WEB</div> <div>round post</div> <div>Input the keyword and search on the website</div> <div><input type="checkbox"/> MISUMI <input checked="" type="checkbox"/> economy</div>	6									3
	8		30	40	50	60	80			4
	10		30	40	50	60	80	100	150	5
	12		40	50	60	80	100	150	200	6

① L≤M×4 female thread is the through hole.  
② When L≤M×6, the bottom hole of the female thread may be penetrated.  
③ L≥M×2+N×2

How to create a model

Step 1 Search on MISUMI official website

Step 2 Select MISUMI economy series brand

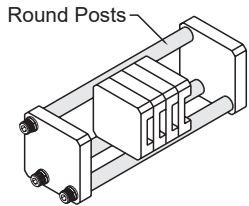
Intended Use	Support and Fixation
Usage Method Diagram	
Feature	· It can bear large load in vertical direction

MISUMI contact

MISUMI WEB "Chat"

Install MISUMI APP

Round Posts One End Threaded, One End Tapped



ดูเพิ่ม > [คลิกที่นี่](#)

O.D. D 6mm, Length L 50mm

Saving Up to 82%  
vs Standard Type

Shipping from 6 days

29 THB



CAD 2D 3D

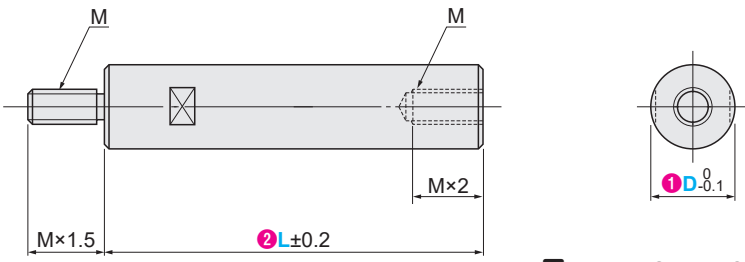

**M**Material: General Structural Steel or SUM Material  
**S**Surface Treatment: Electroplated Nickel Plating or Electroless Nickel Plating

How to create a model	1 O.D. D	2 Length L (Fixed Size Selection)								M (Coarse Thread)
		20	30	40	50	60	80	100	120	
<div>MISUMI Thailand WEB</div> <div>round post</div> <div>Input the keyword and search on the website</div> <div><input type="checkbox"/> MISUMI <input checked="" type="checkbox"/> economy</div>	6									3
	8		20	30	40	50	60	80		4
	10		20	30	40	50	60	80	100	5
	12		30	40	50	60	80	100	120	6
	15		40	50	60	80	100	120	150	8

How to create a model

Step 1 Search on MISUMI official website

Step 2 Select MISUMI economy series brand

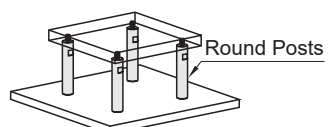
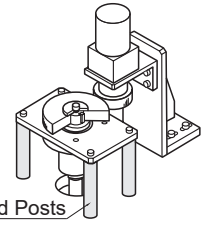
Intended Use	Fastening and Connection	Separation
Usage Method Diagram		
Feature	· Simple and aesthetic connection	· Connected to the baffle, effectively blocking the running mechanism, and anti-interference · Easy to fasten, and can be installed even in narrow spaces

MISUMI contact

MISUMI WEB "Chat"

Install MISUMI APP



Hexagonal Posts Both Ends Tapped



MISUMI economy

ดูเพิ่ม > คลิกที่นี่

Width across flats B 10mm, Length L 30mm

Saving Up to 71% vs Standard Type

Shipping from 6 days

36 THB

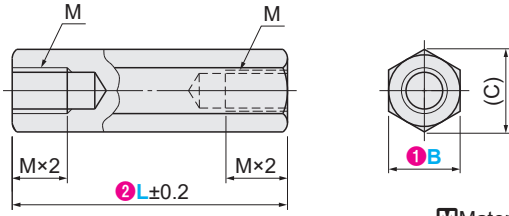

M Material: General Structural Steel or SUM Material  
S Surface Treatment: Electroplated Nickel Plating or Electroless Nickel Plating

How to create a model	①Width across flats B	②Length L (Fixed Size Selection)	M (Coarse Thread)	(C)
<div>MISUMI Thailand WEB</div> <div>hex post</div> <div>Input the keyword and search on the website</div> <div><input type="checkbox"/> MISUMI <input checked="" type="checkbox"/> economy</div>	6	15 20 30 40	3	6.9
	7	20 30 40 60 80	4	8.1
	8	30 40 60 80	5	9.2
	10	30 40 60 80 100	6	11.5
	12	30 40 60 80 100 150 200		13.9
	14	40 60 80 100 150 200		16.2

- ①L≤M×4 female thread is the through hole.
- ②When L≤M×6, the bottom hole of the female thread may be penetrated.
- ③L≥M×2+N×2

How to create a model

Step 1 Search on MISUMI official website

hex post

Input the keyword and search on the website

Step 2 Select MISUMI economy series brand

☐ MISUMI ☒ MISUMI economy

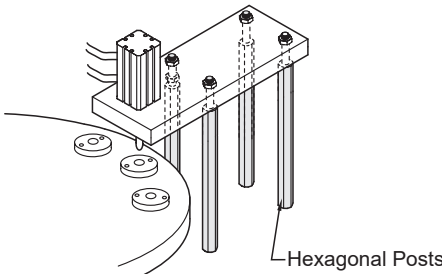
Intended Use	Support and Fixation
Usage Method Diagram	
Feature	· It can bear large load in vertical direction

MISUMI contact

Tel: 038-959200 or 1382

Email: cs@misumi.co.th

MISUMI WEB "Chat"

MISUMI APP

Install MISUMI APP

Hexagonal Posts One End Threaded, One End Tapped



MISUMI economy

ดูเพิ่ม > คลิกที่นี่

Width across flats B 10mm, Length L 30mm

Saving Up to 76% vs Standard Type

Shipping from 6 days

36 THB

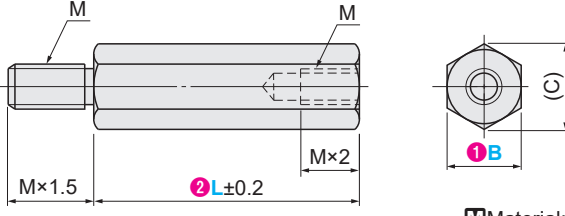

M Material: General Structural Steel or SUM Material  
S Surface Treatment: Electroplated Nickel Plating or Electroless Nickel Plating

How to create a model	①Width across flats B	②Length L (Fixed Size Selection)	M (Coarse Thread)	(C)
<div>MISUMI Thailand WEB</div> <div>hex post</div> <div>Input the keyword and search on the website</div> <div><input type="checkbox"/> MISUMI <input checked="" type="checkbox"/> economy</div>	6	15 20 30 40 50	3	6.9
	7	20 30 40 50 60 80 100	4	8.1
	8	20 30 40 50 60 80 100 150	5	9.2
	10	30 40 50 60 80 100 150	6	11.5
	12	30 40 50 60 80 100 150 200		13.9
	14	40 50 60 80 100 150 200		16.2

How to create a model

Step 1 Search on MISUMI official website

hex post

Input the keyword and search on the website

Step 2 Select MISUMI economy series brand

☐ MISUMI ☒ MISUMI economy

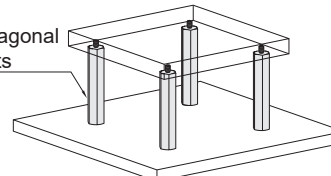
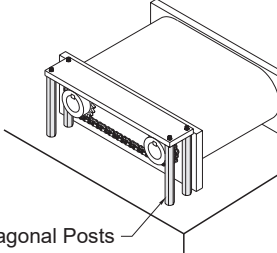
Intended Use	Fastening and Connection	Separation
Usage Method Diagram		
Feature	· Simple and aesthetic connection	· Connected to the baffle, effectively blocking the running mechanism, and anti-interference · Easy to fasten, and can be installed even in narrow spaces

MISUMI contact

Tel: 038-959200 or 1382

Email: cs@misumi.co.th

MISUMI WEB "Chat"

MISUMI APP

Install MISUMI APP



# Economy series Strut Clamps

Equal Dia. / Unequal Dia.



One-Touch

Clamping Force

Low price

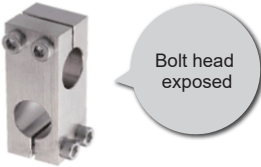

## Appearance improvement & specification changed for medium precision and medium load fixed applications

	MISUMI standard product	MISUMI Economy series
Appearance	 Bolt head exposed	 Use the counterbored hole to conceal the bolt head in the main body
I.D. Tolerance/2 Hole Straight Angle	H7/0.05	0~+0.05/General Tolerance
Material	Iron/Aluminum/Stainless Steel	Aluminum
Number of Fastening Bolts	φ12 or less: 1 pcs φ15 or more: 2 pcs	1 in full size... <b>Reduce assembly time!</b>

## Additional Overcut Process: Stronger Clamping Force

### Clamping Force Test

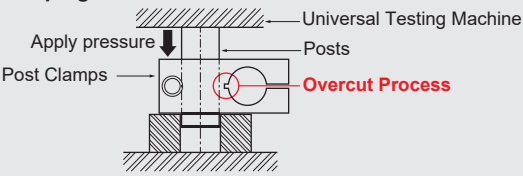

\* Test Method: Test method: Clamp with the specified torque and apply vertical downward pressure to the shaft. The maximum holding force is the axial load recorded when the shaft is displaced.

\* Test Conditions: ① I.D. of measured object: 20mm ② Clamping torque: 7.54N·m

### Test Result

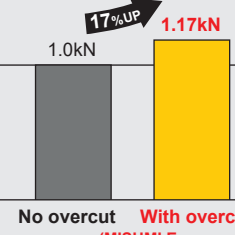

Although there is only 1 bolt, the clamping force can still reach **1.17kN** (Reference Value of Shaft Dia. 20mm)

**No overcut** **With overcut (MISUMI Economy series)**

## Example of Use for Strut Clamp

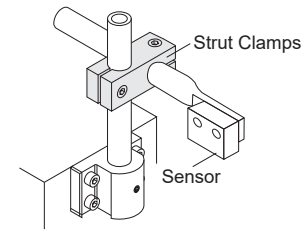

Purpose of supporting sensors/cameras, etc.



Customer

Commonly used in mounting brackets for sensors

The strut clamp is used to fix the sensor, and **the clamping force is more important than the accuracy**. However, the economy series strut clamp only uses **one bolt but ensures sufficient clamping force**, which can be safely used.

# One-Touch Strut Clamps



ดูเพิ่ม > คลิกที่นี่

Equal Dia. Type, Hole Dia. D 8mm, Surface Treatment Clear Anodized

**Saving Up to 84%**  
vs Standard Type

**104 THB**

**Shipping from 6 days**

CAD 2D 3D

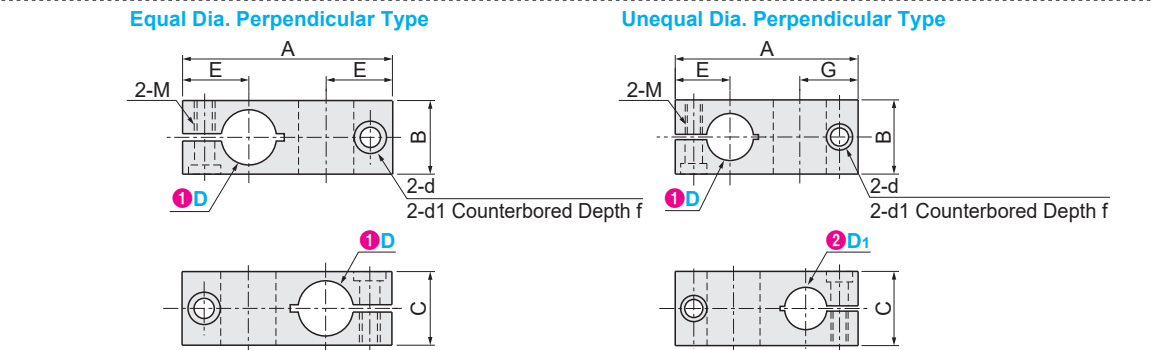

- ① Dimension where not marked, the tolerance of φ20 or less (including 20) is ±0.3. The tolerance of φ25 or more is ±0.5.
- ② Since the slit part is machined after the mounting hole D is machined with a tolerance of 0 to +0.05, the hole tolerance will change.
- M** Material: Aluminum Alloy
- S** Surface Treatment: Black Anodized Clear Anodized
- A** Accessories: Hexagon Socket Head Bolt

### Equal Dia. Perpendicular Type

How to create a model	①Hole Dia. D	A	B	C	E	d	d <sub>1</sub>	f	Supplied Bolt (Coarse Thread · Stainless Steel) M
<div>MISUMI Thailand WEB</div> <div><div>strut clamp</div><div>Input the keyword and search on the website</div><div><input type="checkbox"/> MISUMI<input checked="" type="checkbox"/> economy</div></div>	8	41	15	15	14	8	4.5	4.2	M4
	10	45	16	16	15				
	12	49			16				
	15	57	20	20	18	9	5.5	5.2	M5
	16		22	22					
	20	69	25	25	22	11	6.5	6.2	M6
	25	86	35	35	26	14	8.5	8.2	M8
	30	95	40	40	29				

### Unequal Dia. Perpendicular Type

How to create a model	①Hole Dia. D	②Hole Dia. D <sub>1</sub>	A	B	C	E	G	d	d <sub>1</sub>	f	Supplied Bolt (Coarse Thread · Stainless Steel) M
<div>MISUMI Thailand WEB</div> <div>strut clamp</div> <div>Input the keyword and search on the website</div> <div><input type="checkbox"/> MISUMI <input checked="" type="checkbox"/> economy</div>	10	8	45	20	20	15	15	8	4.5	4.2	M4
	12	10	49			16	16	9	5.5	5.2	M5
	15		57			18	18				
	20	15	69	25	25	22	22	11	6.5	6.2	M6
		16									
	25	15									
30	20	95	40	30	29	29					

How to create a model

Step 1

Search on MISUMI official website

strut clamp

Input the keyword and search on the website

Step 2

Select MISUMI economy series brand

☐ MISUMI ☒ economy

MISUMI contact

Tel: 038-959200 or 1382

Email: cs@misumi.co.th

MISUMI WEB "Chat"



Install MISUMI APP





# Economy series Angle Plates

Suitable for mechanism part holder

Lightweight High rigidity Low price

MISUMI Economy series Angle Plates

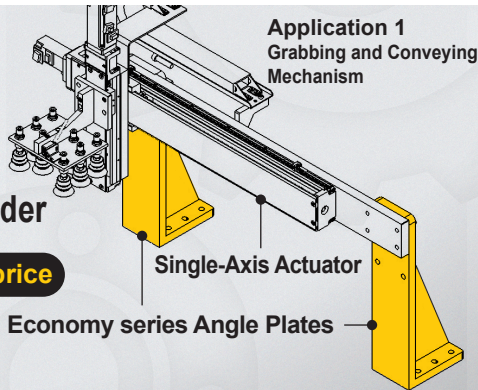

## Adopt Chinese aluminum casting to realize lightweight and ensure low price

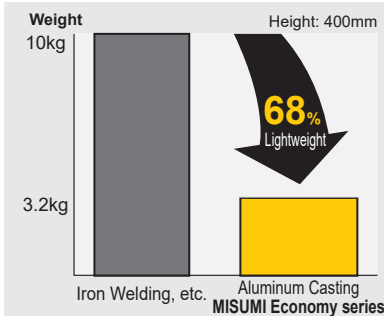

- Height 400mm, allowing pickup with one hand
- Mass production of standard specifications, and domestic casting process to achieve low prices

### Replacing the current iron welded angle plates outsourced

It is used to fix the Single-Axis Actuator and other mechanisms, and the load-bearing capacity is about 20kg. It is enough to use aluminum angle plate. However, aluminum casting has requirements for the minimum order quantity, so iron welded angle plate will be used. If there are cheap aluminum products, it is more in line with the lightweight design trend.



## Reinforcement to ensure high rigidity

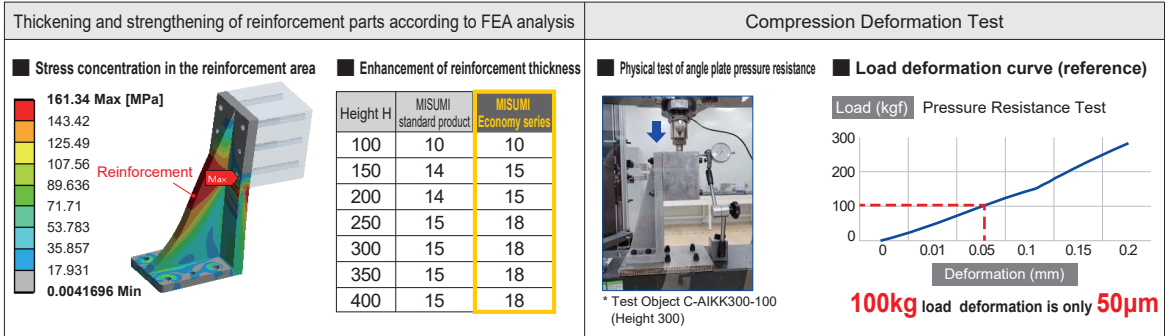

## Guaranteed perpendicularity tolerance 0.05mm, with wide range of applications

	perpendicularity tolerance	Recommended Applications
MISUMI standard product	0.02/100	Automotive Welding/ Inspection Fixture
MISUMI Economy series	0.05/100	FA Industry Equipment

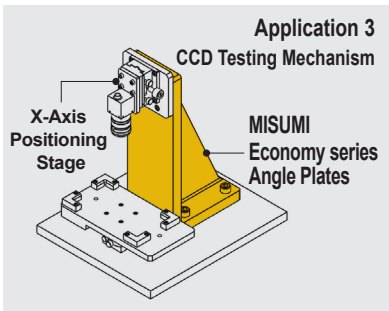
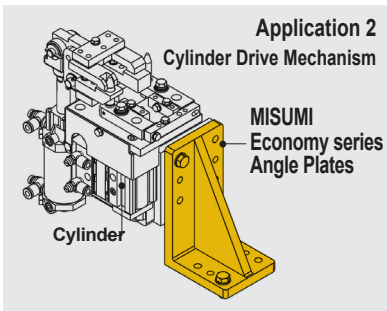

# Angle Plates Lightweight, High Rigidity Type



ดูเพิ่ม > คลิกที่นี่

Height H 200mm, A Dimension 100mm



CAD 2D 3D

1,728 THB



### Lightweight, High Rigidity Type

When A = 60, 70

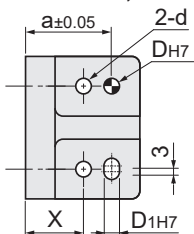



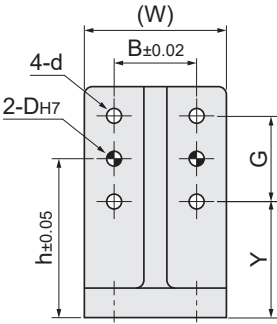
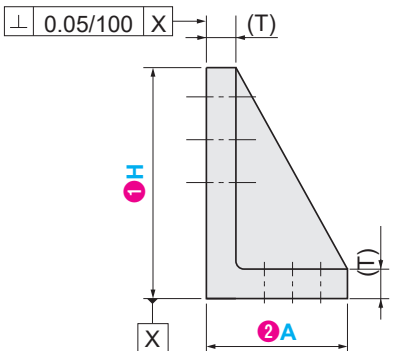
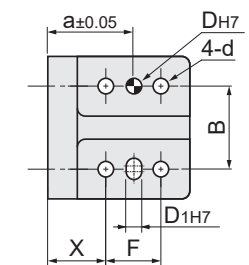

When A = 100 or more



- Tolerances are not guaranteed where dimensional and geometric tolerances are not marked.
- The dimension with ( ) is for reference only.
- The appearance of the product will have casting marks as it is a casting product, which does not affect normal use.

Material: Cast aluminum

How to create a model	 Height H	 A Dimension	Angle Plate Body		Through Hole						Positioning Hole			
			(W)	(T)	d	B	X	F	Y	G	DH7	D1H7	a	h
<div>MISUMI Thailand WEB</div> <div>angle plate </div> <div>Input the keyword and search on the website</div> <div><input type="checkbox"/> MISUMI  </div>	100	60	60	10	6.5	35	30	-	40	40	6	6	45	60
	150	70	100	15	11	70	40	-	75	60	10	10	55	105
	200	100		45			40	110	70	65			145	
	250							130	100				180	
	300							180					230	
	350	150		40			90	230	85	280				
400	260		120		320									

Dimensions with ( ) are for reference only and not in accordance with general tolerances.

How to create a model

Step 1 Search on MISUMI official website  
angle plate  
Input the keyword and search on the website

Step 2 Select MISUMI economy series brand  
MISUMI economy