

Economy Type Post-Assembly Insertion Screws / Pre-Assembly Insertion Screws for Aluminum Extrusions

For 8 Series (Slot Width 10mm)

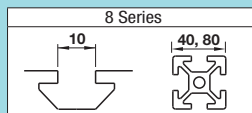

Economy Type of Post-Assembly Insertion Screw is offered. (This type is priced approx. 40% lower than HATLSN8-8 of Post-Assembly Insertion Screw.) **Tightening Torque** **P552**

Economy Type Post-Assembly Insertion Screw

HATL8-8

Effective Length of Economy Type Post-Assembly Insertion Screws



Material SWRCH35K
(Carbon Steel Wire Rod)

* Electrically conductive **Surface Treatment:** Trivalent Chromate **RoHS10**

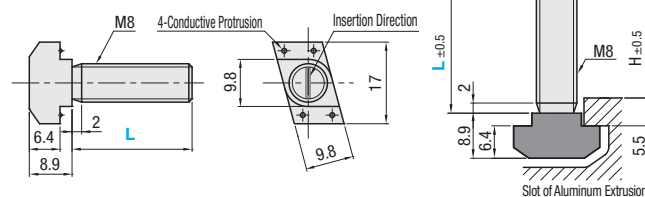

Part Number	L	H	Applicable Extrusion (Series)	Reference Tightening Torque (N·m)	Unit Price	Volume Discount Rate	
					1-29 pc(s).	30-149	150-600
HATL8-8	20	17.0	8 Series 8-45 Series	23.5			
	25	22.0					

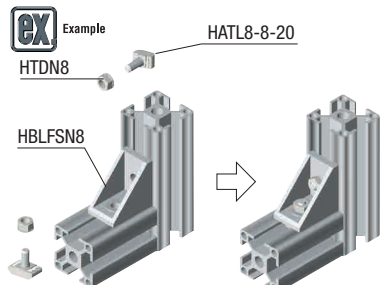

Ordering Example **Part Number** - **L**
Example HATL8-8 - 20

Post-Assembly Insertion Screw

HATLSN8-8

Effective Length of Post-Assembly Insertion Screws



* Electrically conductive **Material** Nut Screw SUS316 Equivalent (Sintered) SUS304 **RoHS10**

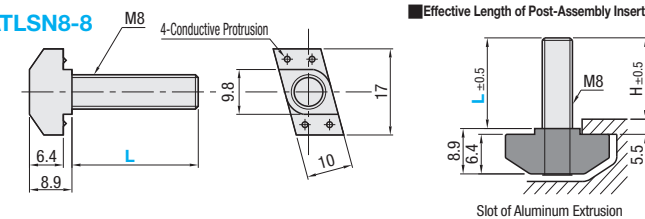

Part Number	L	H	Applicable Extrusion (Series)	Reference Tightening Torque (N·m)	Unit Price	Volume Discount Rate	
					1-29 pc(s).	30-149	150-600
HATLSN8-8	20	17.0	8 Series 8-45 Series	23.5			
	25	22.0					

Ordering Example **Part Number** - **L**
Example HATLSN8-8 - 20

Pre-Assembly Insertion Screw

HNTLSN8-8

Effective Length of Pre-Assembly Insertion Screws



* Electrically conductive **Material** Nut Screw SUS316 Equivalent (Sintered) SUS304 **RoHS10**

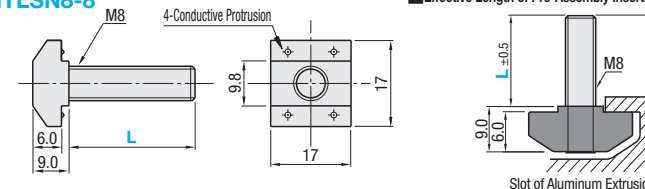

Part Number	L	H	Applicable Extrusion (Series)	Reference Tightening Torque (N·m)	Unit Price	Volume Discount Rate	
					1-29 pc(s).	30-149	150-600
HNTLSN8-8	20	17.5	8 Series 8-45 Series	23.5			
	25	22.5					

Ordering Example **Part Number** - **L**
Example HNTLSN8-8 - 20

Flanged Nuts

HTDN



Material: SUS304 **RoHS10**

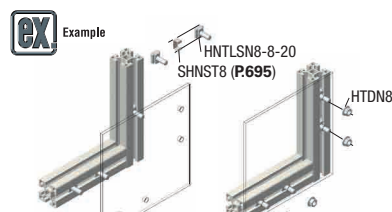
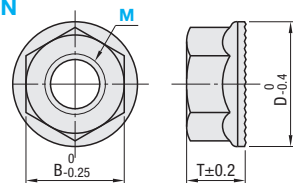

Part Number	Type	M	B	T	D	Unit Price	Volume Discount Rate	
						1-499 pc(s).	500-999	1000-1500
HTDN (Stainless Steel)	4	7	4.2	10				
	5	8	5.5	12				
	6	10	6.0	13				
	8	12	7.5	17				

Ordering Example **Part Number**
Example HTDN6