

Oil Free Slide Plates

Copper Alloy Configurable Type

Features: Dimensions are configurable by 1mm unit. Best suitable for slide portion with 5mm plate thickness and small space.
 For material characteristic values, refer to P.380. Initial greasing is recommended for effective use.

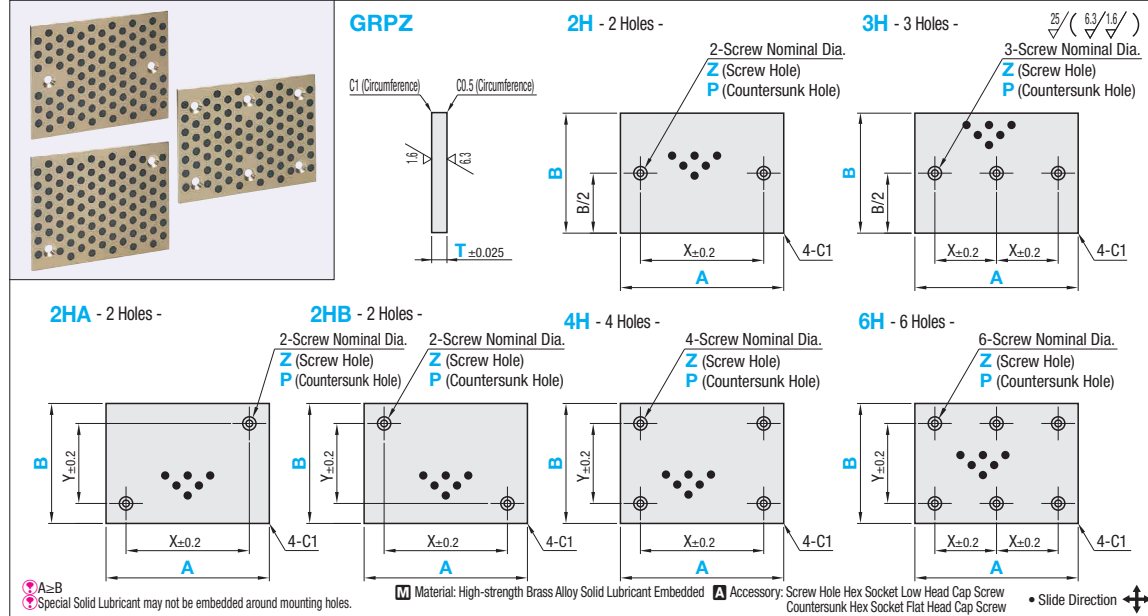

Part Number	1mm Increment		T Selection	Screw Nominal Dia.		X	Y
	Type	Nominal		A	B		
GRPZ	2H	-	5	P5	P6 Z6	30	-
						40	
						60	
						80	
						100	
						100	
	3H	-	10	P6	P6 Z8	65x2	-
						80x2	
						100	
						100	
						100	
						100	
2HA 2HB	-	5	P5	P6 Z6	30(B≤80)	-	
					40		
					60		
					80		
					100		
					100		
4H	-	10	P5	P6 Z6	30(B≤80)	-	
					60(B≤100)		
					80(B≤120)		
					100		
					100		
					100		
6H	-	10	P6	P6 Z8	65x2	-	
					80x2		
					100		
					100		
					100		
					100		

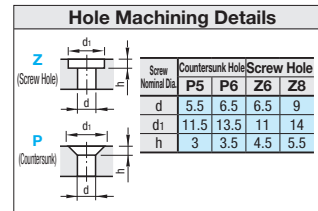

Z specification of Z (screw holes) is the same as that of Hex Socket Head Cap Screw on P.194.

Included Screw Size

Screw Nominal Dia.	Mxℓ		
	P5	P6, Z6	Z8
T=5	M5x16	M6x16	-
T=10	-	M6x20	M8x20

Part Number	Type	Nominal	T	A	Unit Price				
					28~40	41~60	61~80	81~100	101~120
GRPZ	2H	-	5	50~60	-	-	-	-	-
				61~80	-	-	-	-	-
				81~100	-	-	-	-	-
				101~120	-	-	-	-	-
				121~140	-	-	-	-	-
				141~160	-	-	-	-	-
	3H	-	10	61~80	-	-	-	-	-
				81~100	-	-	-	-	-
				101~120	-	-	-	-	-
				121~140	-	-	-	-	-
				141~160	-	-	-	-	-
				161~180	-	-	-	-	-
2HA 2HB	-	5	50~60	-	-	-	-	-	
			61~80	-	-	-	-	-	
			81~100	-	-	-	-	-	
			101~120	-	-	-	-	-	
			121~140	-	-	-	-	-	
			141~160	-	-	-	-	-	
4H	-	10	61~80	-	-	-	-	-	
			81~100	-	-	-	-	-	
			101~120	-	-	-	-	-	
			121~140	-	-	-	-	-	
			141~160	-	-	-	-	-	
			161~180	-	-	-	-	-	
6H	-	10	61~80	-	-	-	-	-	
			81~100	-	-	-	-	-	
			101~120	-	-	-	-	-	
			121~140	-	-	-	-	-	
			141~160	-	-	-	-	-	
			161~180	-	-	-	-	-	

Ordering Example: Part Number - A - B - T - Screw Nominal Dia.
 GRPZ4H - 150 - 100 - 10 - Z6

Oil Free Slide Plates

Copper Alloy

Features: With thread locking treatment screw to prevent falling-off due to looseness (UTW type only). For material characteristic values, refer to P.380. Initial greasing is recommended for effective use.

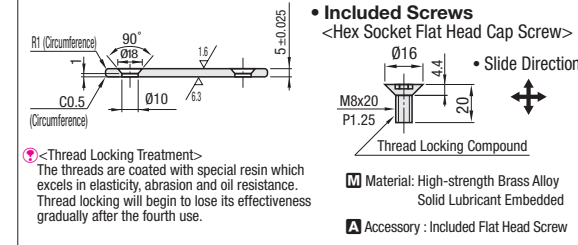
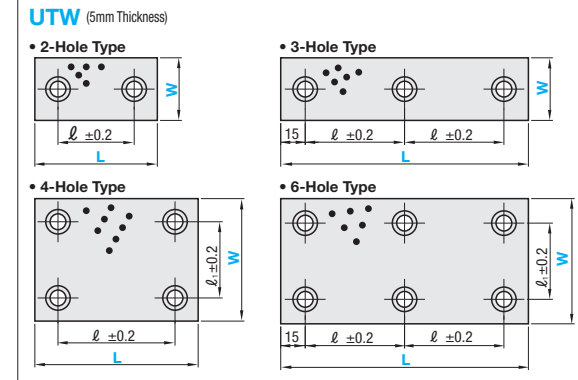
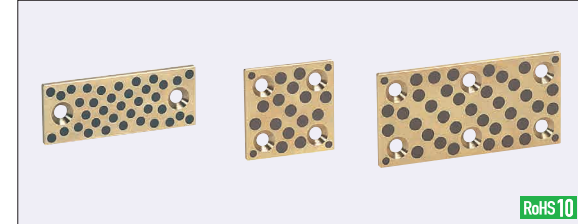

Part Number	W	L	Mounting Hole Type	ℓ	ℓ1	Unit Price
UTW	28	-	2 Holes	20	-	
				45		
				70		
			3 Holes	60		
				70		
				70		
	38	-	2 Holes	20	-	
				45		
				70		
			3 Holes	60		
				70		
				70		
48	-	2 Holes	20	-		
			45			
			70			
		3 Holes	60			
			70			
			70			
75	-	4 Holes	45	45		
			70			
			95			
		6 Holes	60			
			70			
			70			
100	-	4 Holes	45	70		
			70			
			95			
		6 Holes	60			
			70			
			70			

Ordering Example: Part Number W - L
 UTW 75 - 100

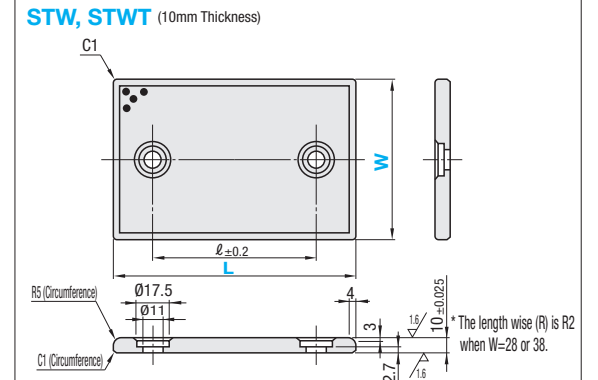
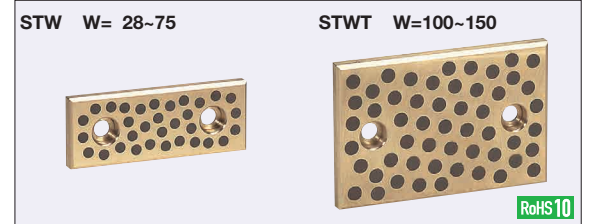

Slide Direction: For W=28 and 38, only long side (L) direction is available.

Part Number	W	L	ℓ	Unit Price		
STW	28	-	75	45		
			100	50		
			125	75		
			150	100		
			38	-	75	45
					100	50
	125	75				
	150	100				
	48	-			75	45
					100	50
			125	75		
			150	100		
75			-	75	25	
				100	50	
	125	75				
	150	100				
	100	-		100	50	
				125	75	
150			100			
200			150			
125			-	150	100	
				200	150	
	250	200				
	150	-		150	100	
				200	150	
				250	200	