

Extrusion End Caps

-For HFS6 Series Aluminum Frames 30, 50, 60, 100 Square-

Price Reduction
25%

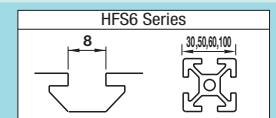

Features: Standard caps for protecting frame end faces. Alterations are not required. When the cap is inserted, tap with a wooden or plastic hammer.

RoHS
STOCK ITEM
PRINTED IN NAVY

Some products are not required to specify colors, since there was no color configuration in the former catalogs. In that case, color is black.

The pin's shape and numbers of extrusion end caps may be changed to prevent caps from easily falling off.

Type	Material
HFC	Polyamide
HFCL	Low Density Polyethylene

HFC6-3030
HFCL6-3030

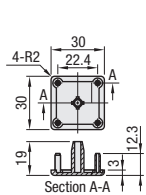

HFC6-3060
HFCL6-3060

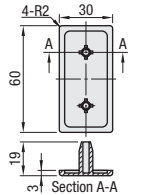

HFC6-3090

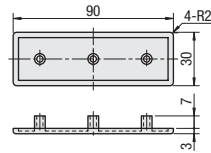

HFC6-606030

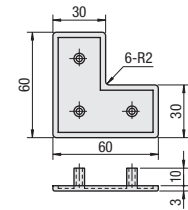

HFC6-6060

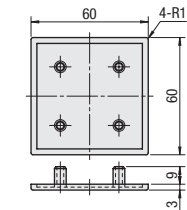

HFC6-6090

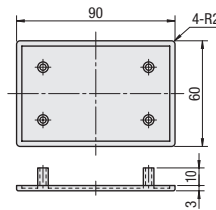

HFC6-60120

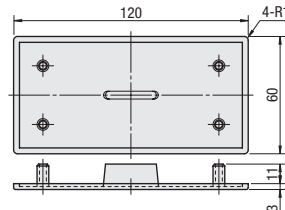

HFC30A6

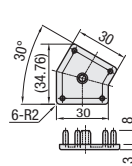

HFC45A6

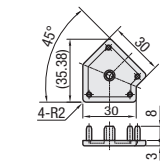

HFC60A6

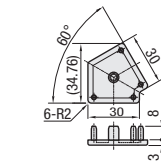

HFCL6-3030

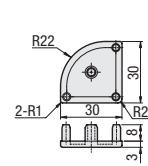

HFC6-5050

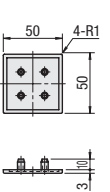

HFC6-50100

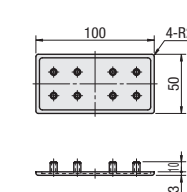

HFC6-100100

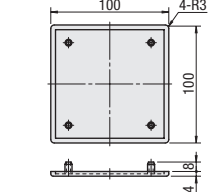

The shapes are changed to be less likely to fall off.
HFC: A tool is required to remove.
HFCL: Removable by hand.

Order Example: Part Number - Color
HFC30A6 - B

Delivery: 1 Day P.87
5 Days

Example

When using Aluminum Extrusion HFS6-30120, please use 2 pieces of HFC6-3060.



Features: Three-Sided Frame Caps for protecting 3 corners. Alterations are not required.

Three-Sided Caps for Corners **RoHS** **HFC6K-3030**

The shape and the number of extrusion end cap pin may be changed to prevent caps from easily falling off.

Material: Polyamide

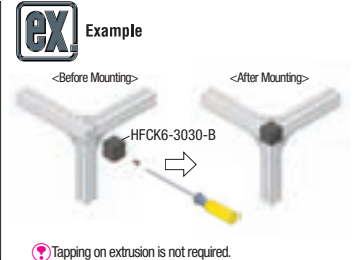

Part Number	Color	Accessories	Applicable Extrusion*	Unit Price 1-14 pcs.	Volume Discount Rate 15-19	20~
HFC6K-3030	B(Black)	HFMB4-12	HFS6-3030	99	82	65

* For Aluminum Extrusion EFS Series, the same frame caps as of HFS Series can be used.

Order Example: Part Number - Color **HFC6K-3030 - B**
Delivery: 5 Days P.87

Features: Frame End Caps, Screw Mounting Type. Excels in safety, prevent caps from falling off without alterations.

Screw Mounted **RoHS** **HFCB6-3030** (Screw Fixing Type) **HFCB6-3060** (Screw Fixing Type)

Material: Polyamide (Black, Light Gray, Yellow)

Part Number	Type	No.	Color	Unit Price 1-14 pcs.	Volume Discount Rate 15-19	20~	Applicable Extrusions*
HFCB6		3030	B(Black) S(Light Gray) Y(Yellow)	79	55	33	HFS6-3030
		3060	Yellow Type is only available for 3030.	89	62	38	HFS6-3060

* For Aluminum Extrusion EFS Series, the same frame caps as of HFS Series can be used.

For Screw Retained Type, flat head screws are included. (Black: HFMB4 - 12, Light Gray, Yellow: SHFBS4 - 12)

Order Example: Part Number - Color **HFCB6-3030 - B**
Delivery: 5 Days P.87

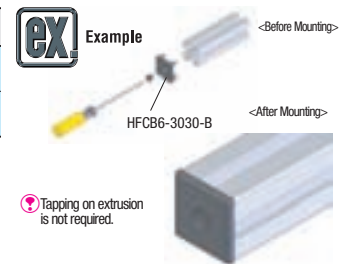

Features: End plates for HFCR6-606030. Alterations are required on the extrusions.

End Plates **RoHS** **HFCR6-606030**

Material: SUS304

End plates mounting for HFSR6-606030

Alterations Code	Hole Machining for End Plate Mounting		
	LTS	RTS	TSW
Spec.	The standard extrusion position is shown below. LTS: Machined on the left end RTS: Machined on the right end TSW: Machined on both ends Ex. LTS		
Applicable Extrusions	HFSR6-606030	Applicable Screw	SHFBS8-12
	260	260	519

Part Number	Applicable Screw (Not included)	Unit Price 1-14 pcs.	Volume Discount Rate 15-19	20~	Applicable Extrusions
HFCR6-606030	SHFBS8-12	219	207	198	HFSR6-606030

* For HFCR6-606030, alteration on the extrusion section and applicable screws are required for mounting. (Screws are not attached.)

Features: Frame Caps only for High Rigidity Aluminum Frames GFS6-3030 and GFS6-3060.

Plates for High Rigidity Type **RoHS** **HFCD6-3030** **HFCD6-3060**

Material: SUS304

Order Example: Part Number **HFCD6-3030**
Delivery: 9 Days

Part Number	Type	No.	Applicable Screw (Not included)	Applicable Extrusion	Unit Price 1-9 pcs.	Volume Discount Rate 10~
HFCD6		3030	SHFBS8-15	GFS6-3030	266	253
		3060		GFS6-3060	318	301

* Special alteration is required on cross sections of extrusions to mount frame caps. (Refer to P.658)

Part Number	Type	No.	Color	Unit Price			Applicable Extrusions*
				1-14 pcs.	15-19	20~	
HFC6	B (Black)	3030	55	40	23	HFS6-3030	
		3060	62	45	26	HFS6-3060	
		3090	69	48	28	HFS6-3090	
		606030	103	72	41	HFS6-606030	
		6060	65	47	28	HFS6-6060	
		6090	103	72	41	HFS6-6090	
		60120	137	96	55	HFS6-60120	
HFCL6	S (Light Gray)	3030	55	40	23	HFS6-3030	
		3060	62	45	26	HFS6-3060	
HFC30A6			62	45	26	HFS30A6-30	
HFC45A6			62	45	26	HFS45A6-30	
HFC60A6			69	48	28	HFS60A6-30	
HFCR6-3030			69	48	28	HFSR6-3030	
HFC6	B (Black)	5050	62	45	26	HFS6-5050	
		50100	106	76	43	HFS6-50100	
		100100	164	116	67	HFS6-100100	

* For Aluminum Extrusion EFS Series, the same frame caps as of HFS Series can be used.