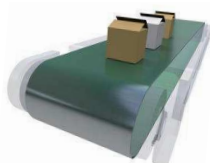
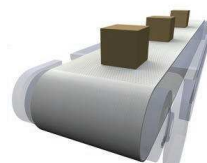
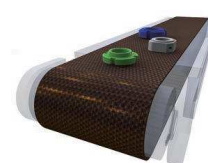
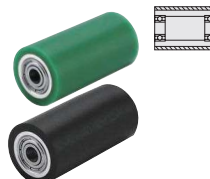
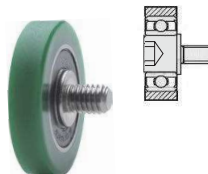

Flat Belt
Pulleys /
Idlers+ New
Specs+ New
Specs**P.699**Flat Belt Pulleys Short Length
P.701Flat Belt Idlers Short Length
P.702Flat Belt Pulleys Medium Length
P.703Flat Belt Idlers Medium Length
P.704

Flat Belt

For General Use
P.707For Electronic Parts Transfer
P.708For Sliding
P.709For Transferring Bulk Materials
P.710**P.705**Urethane
Molded
RollersWith Bearing
P.713With Set Screw Hole
P.714**P.711**Urethane
Molded
BearingsStandard
P.715With Screw Rod
P.716**P.715**

Ball Rollers

Milled, Threaded Stud
P.719Milled, Flange Mounting Type
P.720Round, Stainless Steel, Screw Type
P.720Nut Fixed, Stainless Steel, Flange Mounting Type
P.721**P.717**Hexagonal, Stainless Steel, Screw Type
P.722Press Fit Type, Stainless Steel
P.723Compact, Press Fit Type
P.724

**Cam
Followers**

P.725



Straight Slot, Crown
P.727



Straight Slot, Flat
P.728



Crown, Hex Socket
P.729



Flat, Hex Socket
P.730



Stainless Steel, Flat, Hex Socket
P.731



Stainless Steel, Crown, Hex Socket
P.731



Miniature Cam Followers
P.732



Urethane Coated Cam Followers
P.733

**+ New
Specs**



Nylon Coated Cam Followers
P.734

**Roller
Followers**

P.735



Bearing Separable
P.735



Non Separate
P.736

**Silicon Coated
Bearings / Bearings
With Screw Rod**

P.737

**New
Products**



Silicon Coated Bearings
P.738

**New
Products**



Silicon Coated With Screw Rod
P.738

**New
Products**

Standard



Bearings With Screw Rod
P.740

**New
Products**

Long



Bearings With Long Screw Rod
P.740

Flat Belt Transfer Mechanism

Application Industries:

Packing

Electronic & Electrical

This figure shows a flat belt transfer mechanism, which is a typical conveyor mechanism for conveyor line type equipment. It is commonly used in transferring equipment of light-weight parts such as bulk materials.



Reference price

01 Flat Belt × 2 P.707



Surface Material Urethane
Belt Width 60mm
Circumference Length 2m Thickness 0.9mm
Surface Cover Green Glossy
CFBUG-60-2

2,475
THB/pcs

Quantity	Unit price	Total price
2	2,475	4,950
6	1,684	10,104

02 Linear Guide × 1 P.313

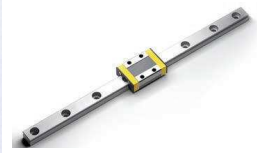

Nominal Model 12
Length 196mm
E-GMLG12-196

1,000
THB/pcs

Quantity	Unit price	Total price
1	1,000	1,000
5	800	4,000

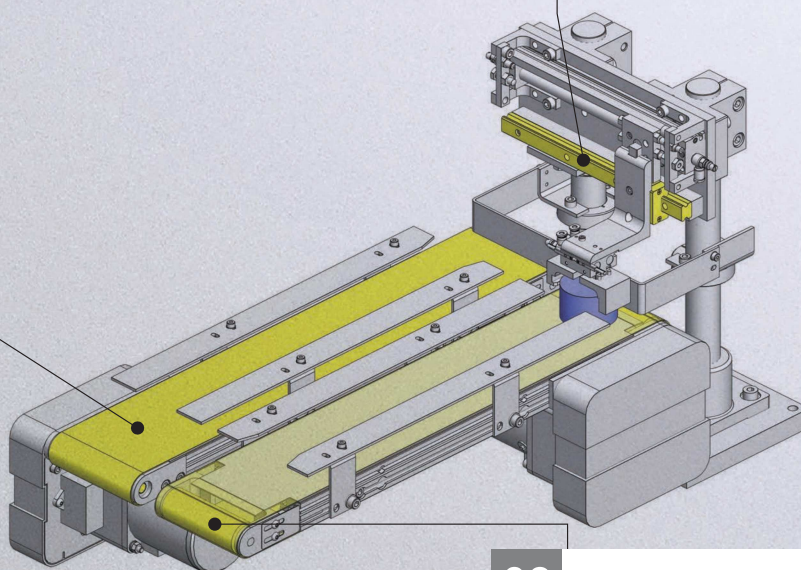

03 Flat Belt Pulley·Idler × 2 P.704



Shape Straight type (Without flange)
O.D. 30mm
Shaft Dia. 8mm
Width 60mm
C-ROFAN30-8-L60

569
THB/pcs

Quantity	Unit price	Total price
1	569	569
4	483	1,932

Roller Transfer Mechanism

Application Industries: **Automotive part**

Packing

This figure shows a roller transfer structure, which is a typical transmission mechanism for conveyor line type equipment. It is commonly used in logistics transportation equipment.



Reference price

01 Cam Follower × 4 P.733



Urethane Coated Type
Material Urethane Shore A90
Roller O.D. 40mm
C-CFFRUA18-40

1,146
THB/pcs

Quantity	Unit price	Total price
1	1,146	1,146
4	974	3,896

02 Aluminum Frame × 2 P.1191



Frame Standard Type
Extrusion Size 3030
Total Length 1500mm
NEFS6-3030-1500

270
THB/pcs

Quantity	Unit price	Total price
1	270	270
10	257	2,570

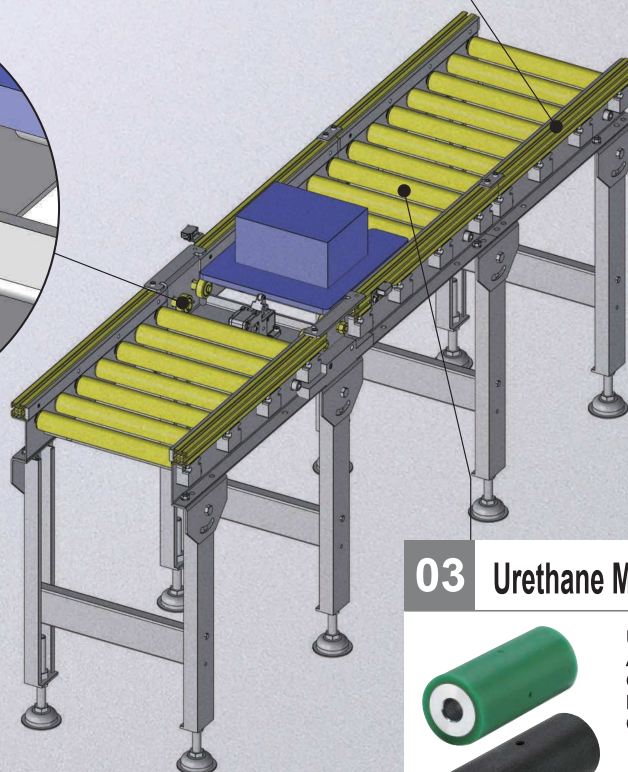
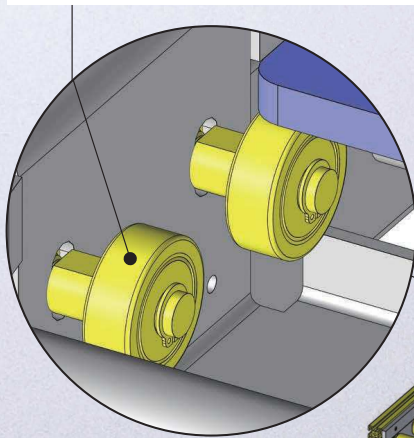

03 Urethane Molded Roller × 21 P.714



Urethane Hardness Shore 90 (Green)
Aluminum Alloy
O.D. 40mm I.D. 8mm
Length 100mm
C-ROUAN40-10-100

851
THB/pcs

Quantity	Unit price	Total price
1	851	851
4	724	2,896

Economy Series Flat Belt Pulleys / Idlers

Knurling is added to acquire non-slip performance.







Less belt vibration

Higher tightening torque

vs Standard Type
Saving
up to

66%

Specification

MISUMI Economy series Flat Belt Pulleys		MISUMI Economy series Flat Belt Idlers		
Flanged Type	Crown Type	Flanged Type	Straight Type	Crown Type
Non Knurled 				
Knurled 				

Example of Use

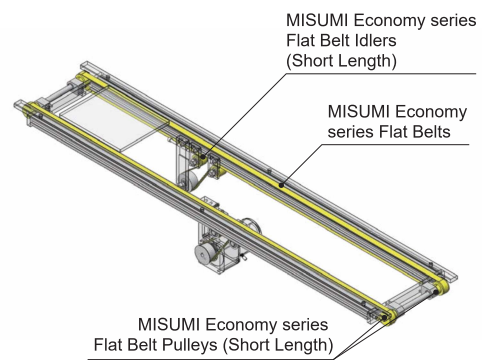
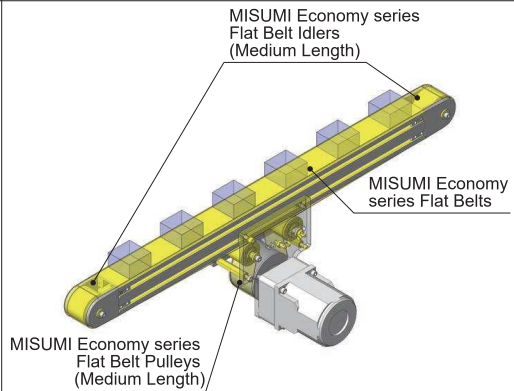
Example Name	Double row pallet transfer example	Single row workpiece transfer example
Design Illustration		
Introduction to Use	<ul style="list-style-type: none"> The Double Row Conveyor is a pallet transfer mechanism that combines a short length flat belt pulley, idlers and flat belts. For long-distance transportation It is recommended to choose short length crown type pulleys, idlers to prevent meandering. When selecting flange type pulleys / idlers Attention to be paid not to interfere with the height of the flange and the pallet being transported. 	<ul style="list-style-type: none"> The work piece can be transported directly by using the flat belt pulley idler and flat belt. Single Row Conveyor Depending on the width of the workpiece, a medium flat belt pulleys / idlers and flat belts of appropriate width needs to be selected. For long-distance transportation Medium length crowned pulleys / idlers with high meandering prevention is recommend.

Economy series flat belt pulleys have knurled surfaces, increasing anti-slip capacity by 4.7 times

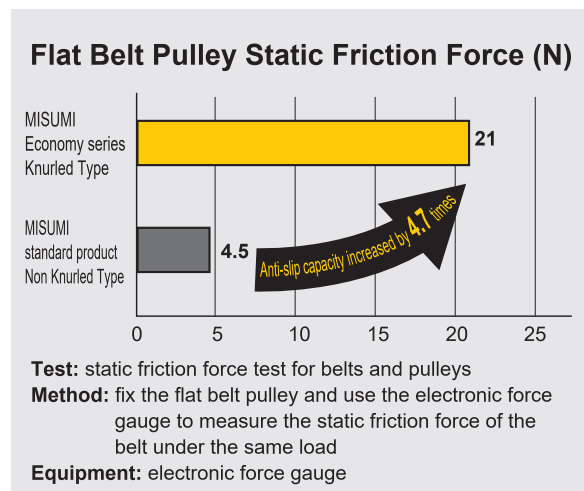

MISUMI standard product	MISUMI Economy series
Non Knurled Surface	Knurled Surface
* Under normal use, there is no obvious difference in belt wear compared with non-knurled pulleys	

Guaranteed coaxiality of no more than 0.05, effectively reducing the belt vibration when running.

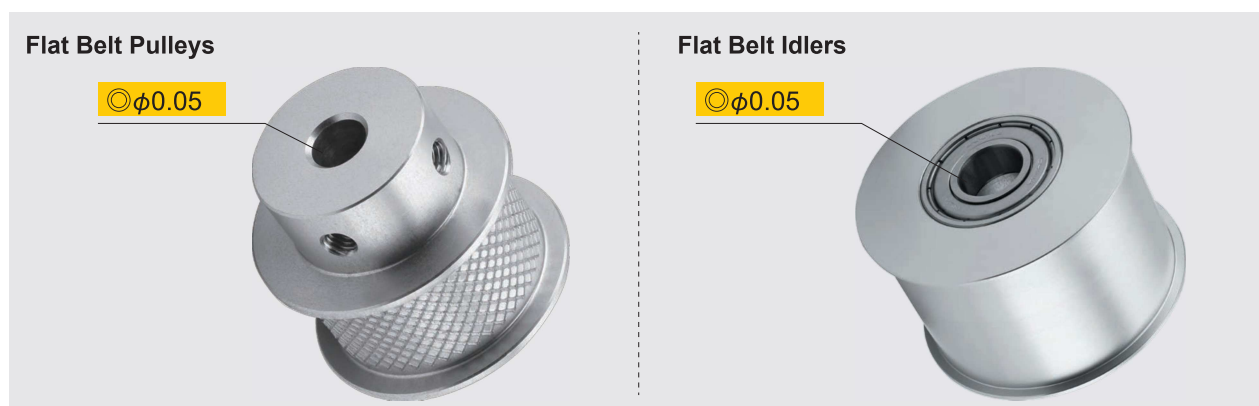

Tightening torque is increased by 11.8%, with set screw holes changed to 120°.

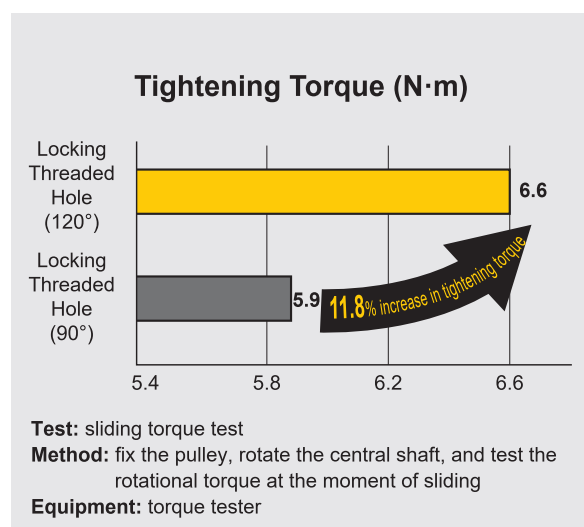

MISUMI standard product	MISUMI Economy series
Set Screw Holes (90°)	Set Screw Holes (120°)
<p>d Shaft Bore Specs Round Hole + Tapped</p> <p>P</p> <p>New JIS Keyway + Tapped</p> <p>N·NK</p>	<p>d Shaft Bore Specs Round Hole + Tapped</p> <p>P</p> <p>New JIS Keyway + Tapped</p> <p>N</p>

8	Flat Belts / Rollers /
	Cam Followers
	Flat Belt Pulleys
P.699	
	Flat Belt
P.705	
	Urethane Molded Rollers
P.711	
	Ball Rollers
P.717	
	Cam Followers
P.725	
	Roller Followers
P.735	
	Silicon Bearings Threaded Bearings
P.737	

Representative model: C-HBPA20-P8-6

Save Up to **66%**
vs Standard Type

169

THB

Shipping
from
1 day



Volume Discount

Quantity	1~9	10~14	15~
Discount	Unit Price	15%	30%



Shipping days may differ by Quantity.

Quantity of volume discount above is for representative Part No. It may differ by the Part.

Keyway Size

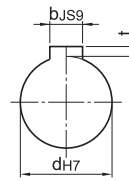
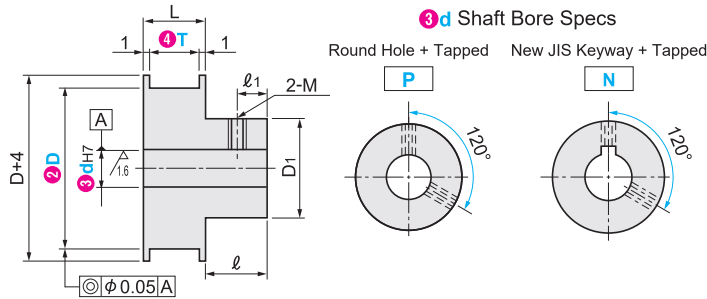

N: New JIS (B1301) Keyway Dimensions

Nominal Model	dH7	bJS9	t Tolerance
N8	8 +0.015/0	3 ±0.0125	1.4
N10	10 +0.018/0	4 ±0.0150	1.8
N12	12 +0.018/0	5 ±0.0150	2.3
N15	15 +0.021/0	6 ±0.0180	2.8
N20	20 +0.025/0	8 ±0.0215	3.3
N30	30 +0.025/0	12 ±0.0215	3.3
N40	40 +0.025/0	12 ±0.0215	3.3

Coaxiality is not guaranteed for the knurled specification

Set Screw is not provided

Material : Aluminum Alloy

Surface treatment: Clear Anodized

Non Knurled

Part Number	Shaft Bore Specs	Shaft Bore dH7	Width T	D1	l	l1	M (Coarse Thread)	L
①Type	②O.D. D	③P Hole / N Hole	④					
C-HBPA	20	P (Round Hole + Tapped)	P5	6	16	8	4	3
			P8	11				
			P6	6				
			P10	11				
			P12	16				
			P10	6				
	30	N (New JIS Keyway + Tapped)	N8	21				
			N10	11				
			N12	21				
			N12	16				
			N12	11				
			N12	16				
	40			32	30	12	6	5

Knurled Surface

Part Number	Shaft Bore Specs	Shaft Bore dH7	Width T	D1	l	l1	M (Coarse Thread)	L
①Type	②O.D. D	③P Hole / N Hole	④					
C-HBPAH	20	P (Round Hole + Tapped)	P5	6	16	8	4	3
			P8	11				
			P6	6				
			P10	11				
			P12	16				
			P10	6				
	30	N (New JIS Keyway + Tapped)	N8	21				
			N10	11				
			N12	21				
			N12	16				
			N12	11				
			N12	16				
	40			32	30	12	6	5

Detailed dimensions are available on the official website

Please order after selecting part number and parameters according to the selection steps ① to ④.

Ordering Example: Part Number (①Type · ②D) - ③d - ④T
C-HBPA20 - P8 - 6



By Type
Search on MISUMI official website
C-HBPA

By Keyword
Search on MISUMI official website
flat belt

Step 1 Search on MISUMI official website Step 2 Select MISUMI economy series brand



+ New Specs



Representative model: C-HBGA15-16

Save Up to **66%** vs Standard Type

221

THB

Shipping from **1 day**

Volume Discount

Quantity	1~9	10~14	15~
Discount	Unit Price	15%	30%



Shipping days may differ by Quantity.

Quantity of volume discount above is for representative Part No. It may differ by the Part.

Material	Surface treatment
Aluminum Alloy	Clear Anodized

* Bearing Accuracy GB 307 P0
JIS B1514 Class 0

Straight Type (With Flange)

C-HBGA

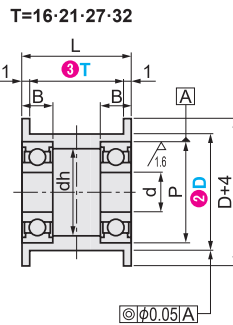
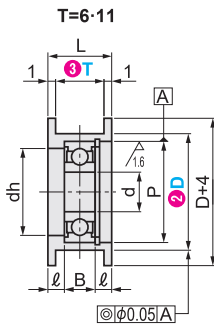

Crown Type

C-HBGCA

6.3 / 1.6

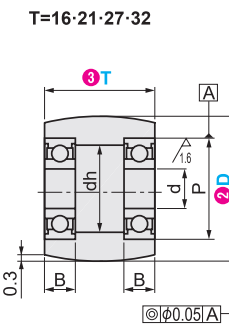
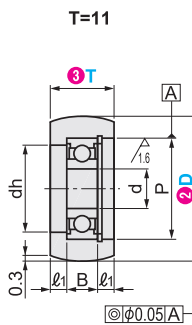

- Double bearings are pressed fit. Double bearings cannot be removed.
- The tolerance accuracy of T is $\pm 0.2\text{mm}$. Please select the idler model after confirming the width tolerance of the flat belt.
- MISUMI does not guarantee the bearing brands.

■ Straight Type (With Flange)

Part Number	Type	O.D. D	Width T	Shaft Bore d	P	dh	ℓ	L	B
C-HBGA	15	6	11	4	11	9	2	8	4
	20			5	16	13	1.5	8	5
	25			6	19	16	4	13	6
	30	11	16	8	19	17	3.5	18	6
	15			5	11	9		18	5
	20			6	16	13		18	6
	25	16	21	8	19	16		18	6
	30			10	19	17		18	8
	35			10	26	23		23	8
	40	21	27	12	28	25		23	8
	50			5	11	9		23	5
	15			8	16	14		23	6
	20	27	32	8	19	17		29	6
	25			10	26	23		29	8
	30			12	28	25		29	8
	40	32	37	10	26	23		34	6
	50			12	28	25		34	8

Detailed dimensions are available on the official website

■ Crown Type

Part Number	Type	O.D. D	Width T	Shaft Bore d	P	dh	ℓ	B
C-HBGCA	20	11	16	5	16	13	4	5
	25			6	19	16	3.5	6
	30			8	19	17		6
	15	16	21	5	11	9		5
	20			6	16	13		6
	25			8	19	16		6
	30	21	27	10	22	17		6
	35			10	22	17		6
	40			10	26	23		8
	15	27	32	5	11	9		5
	20			8	16	14		6
	25			8	19	17		6
	30	32	37	10	26	23		8
	35			12	28	25		8
	40			12	28	25		8

Ordering Example

Please order after selecting part number and parameters according to the selection steps ① to ④.

Part Number (①Type · ②D) - ③T
C-HBGA15 - **16**

How to search on website



By Type

Search on MISUMI official website

C-HBGA



By Keyword

Step 1 Search on MISUMI official website

flat belt

Step 2 Select MISUMI economy series brand

☐ MISUMI ☒ MISUMI economy



MISUMI contact

Tel: 038-959200 or 1382
Email: cs@misumi.co.th

MISUMI WEB "Chat"



Install MISUMI APP



8 Flat Belts / Rollers / Cam Followers / Flat Belt Pulleys P.699

Flat Belt P.705
Urethane Molded Rollers P.711

Ball Rollers P.717

Cam Followers P.725

Roller Followers P.735

Silicon Bearings Threaded Bearings P.737

Representative model: C-ROBAC15-N8-25

Save Up to **66%**
vs Standard Type

256

THB

Shipping
from
1 day



Volume Discount

Quantity	1~9	10~14	15~
Discount	Unit Price	15%	30%



Shipping days may differ by Quantity.

Quantity of volume discount above is for representative Part No. It may differ by the Part.

Material	Surface treatment
Aluminum Alloy	Clear Anodized

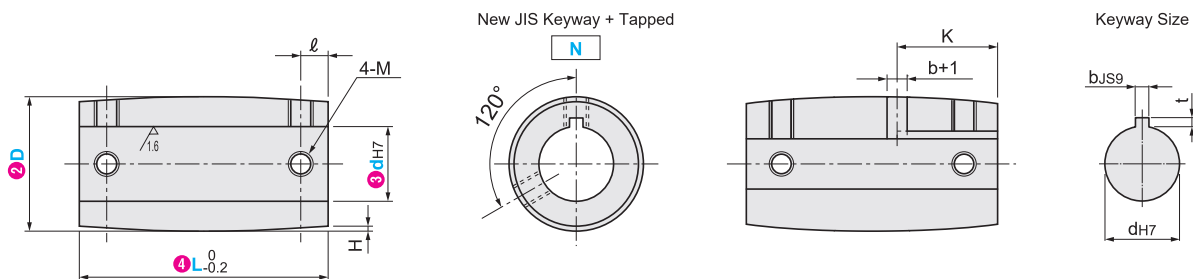

Set Screw is not provided

Part Number		③ Shaft Bore $\phi H7$	④ Width L				H	Key Length	M	ℓ	
① Type	② O.D. D	Keyway Hole + Tapped						K			
C-ROBAC	15	N8	25	30	40	50	0.8	25	M3	3.5	
	20		25	30	40	50					
	30	N12	30	40	50	60		30			
	40		30	40	50	60					
	50	N20	50	60		M5		4			

Nominal Model	Shaft Hole $\phi H7$		bJS9		t Tolerance	
N8	8	$+0.015$ 0	3	± 0.0125	1.4	$+0.1$ 0
N12	12	$+0.018$ 0	4	± 0.0150	1.8	
N20	20	$+0.021$ 0	6		2.8	

Detailed dimensions are available on the official website

Ordering Example

Please order after selecting part number and parameters according to the selection steps 1 to 4.

Part Number (1 Type · 2 D) - 3 ϕd - 4 L
C-ROBAC15 - N8 - 25

How to search on website



By Type

Search on MISUMI official website

C-ROBAC

By Keyword

Step 1 Search on MISUMI official website

flat belt

Step 2 Select MISUMI economy series brand

☐ MiSUMI



MISUMI contact

Tel: 038-959200 or 1382
Email: cs@misumi.co.th

MISUMI WEB "Chat"



Install MISUMI APP



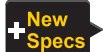

Representative model: C-ROFAC40-10-L30-H0.8

Save Up to **62%**
vs Standard Type

588

THB



Volume Discount

Quantity	2~3	4~5	6~
Discount	Unit Price	15%	30%



Shipping days may differ by Quantity.

Quantity of volume discount above is for representative Part No. It may differ by the Part.

* Bearing Accuracy GB 307 P0
JIS B1514 Class 0

Material	Surface treatment
Aluminum Alloy	Clear Anodized

Straight Type (Without Flange)

C-ROFAN

Crown Type

C-ROFAC

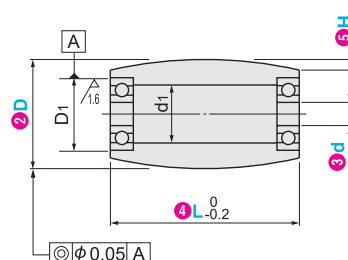
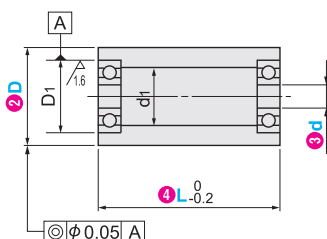

- Double bearings are pressed fit.
- Double bearings cannot be removed.

Straight Type

Part Number		3 Shaft Bore Dia. d	4 Width L	d1	D1	B
1 Type	2 O.D. D					
C-ROFAN	15	5	25 30	7	8	2.5
		6	25 40 50	9	10	3
	20	8	25 30 35 50 60	10	13	5
		6	25 40		12	3.5
	25	8	50 60		15	5
		6	25 40		16	5
	30	10	50 60 70	15	19	6
		12	25 30 40		22	6
	40	10	40		24	6
		15	25		26	8
	50	20	30 50	17	28	7
					27	9

Crown Type

Part Number		3 Shaft Bore Dia. d	4 Width L	5 H	d1	D1	B
1 Type	2 O.D. D						
C-ROFAC	15	6	25 50	0.8	9	10	3
	20	8	25 30 40 50		10	12	3.5
	30	12	30 40 50 60		15	24	6
	40	10	30 40 60		17	26	8
	50	15	50 60		27	28	7

Detailed dimensions are available on the official website



Please order after selecting part number and parameters according to the selection steps 1 to 5.

Part Number (1 Type · 2 D) - 3 d - 4 L - 5 H
C-ROFAC40 - 10 - L30 - H0.8

How to search on website



By Type

Search on MISUMI official website

C-ROFAN

By Keyword

Step 1 Search on MISUMI official website

flat belt

Step 2 Select MISUMI economy series brand



MISUMI contact

Tel: 038-959200 or 1382
Email: cs@misumi.co.th

MISUMI WEB "Chat"



Install MISUMI APP



8

Flat Belts / Rollers /
Cam Followers

Flat Belt
Pulleys

P.699

Flat Belt

P.705

Urethane
Molded Rollers

P.711

Ball Rollers

P.717

Cam
Followers

P.725

Roller
Followers

P.735

Silicon Bearings
Threaded Bearings

P.737

Economy Series Flat Belts

4 most common types for
conveyor lines are available.

For General Use

For Electronic Parts

For Sliding

**For Transferring
Bulk Materials**

vs Standard Type

**Saving
up to**

58%

Usage difference between MISUMI Economy series and MISUMI standard product

- The difference between MISUMI Economy series and MISUMI standard product is noise performance.
- The noise performance is affected by the ambient sound of the surrounding equipment, and the impact is small in actual use.

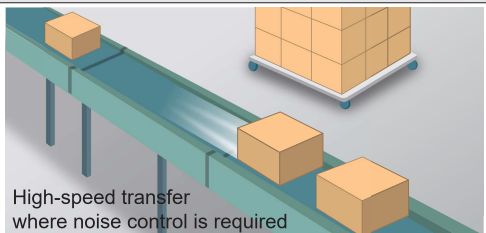
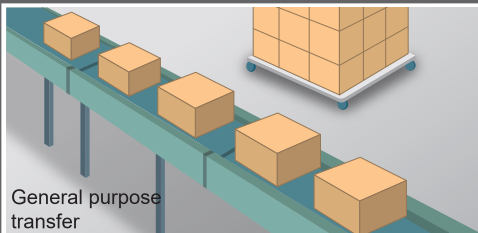
	MISUMI standard product	MISUMI Economy series
Example of Use	 High-speed transfer where noise control is required	 General purpose transfer
Noise performance*	Excellent (56dB)	Normal (61dB)

* The difference in fricative noise of the iron plate that supports the conveyor belt etc. is about 5 dB. The reference value of friction noise is the result of the actual installation test of MISUMI conveyor, for reference only.

Example of Customer Use

Electronic parts pallet conveyor line

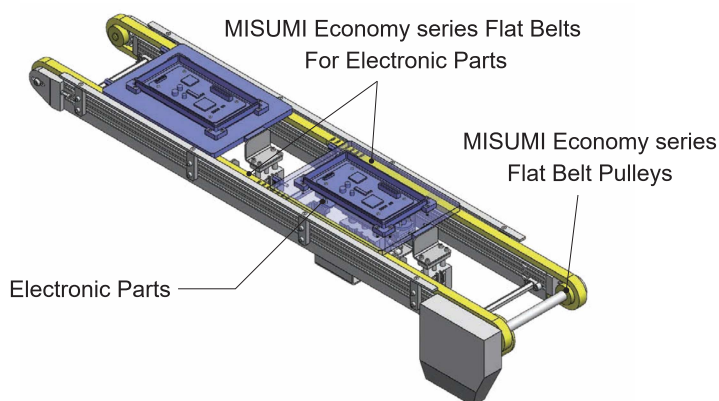

Customer Voice

Generally speaking, 10^6 to $10^8\Omega$ can meet the transmission requirements of common electronic parts. It would be better if the parameters required for the design could be provided at an affordable price.



Shanghai XXX
Technology
Co., Ltd.
Mr. Hao

Save time by providing the technical parameters needed to design a conveyor line

The technical parameters required in the design of the conveyor line are the actual measured values of MISUMI.

Application	Surface Material	Number of Layers	Minimum Pulley Diameter φmm	Allowable Tension N/mm	Friction Coefficient (Reference value for ground steel)	
					Surface	Rear
For General Use	Urethane	1	10	4	0.4	0.1
	Urethane	2	30	6	0.4	0.1
	Polyvinyl Chloride	1	10	4	0.5	0.2
	Polyvinyl Chloride	2	30	6	0.5	0.2
For Electronic Parts *Surface Resistance Value: 10 ⁶ ~10 ⁹ Ω	Urethane	1	15	4	0.4	0.1
	Urethane	2	30	6	0.4	0.1
For Sliding	Urethane Impregnated	1	10	4	0.2	0.1
	Urethane Impregnated	2	20	6	0.2	0.1
For Transferring Bulk Materials	Urethane	1	20	4	0.4	0.2

For relevant technical parameters of flat belts, please refer to MISUMI official website.

* The surface resistance value is the value measured only with the belt under the following test conditions. It changes due to the influence of the environment and peripheral devices. This is a reference value, not guaranteed value.
Test Conditions: Temperature 23±2°C, Humidity 50±5%.

Prevents "work displacement" that is common when transporting lightweight workpieces

MISUMI Economy series flat belt uses a durable fabric on the back side to effectively prevent warping on both sides of the belt and prevent displacement during transportation of lightweight workpieces



* Generic products on the market are similar products randomly purchased by our company from online or offline markets

Quality Assurance of Joint for Smooth Transfer

The joint seam of MISUMI Economy series flat belt is flat, which can avoid the transfer failure caused by belt runout and uneven joint seam.

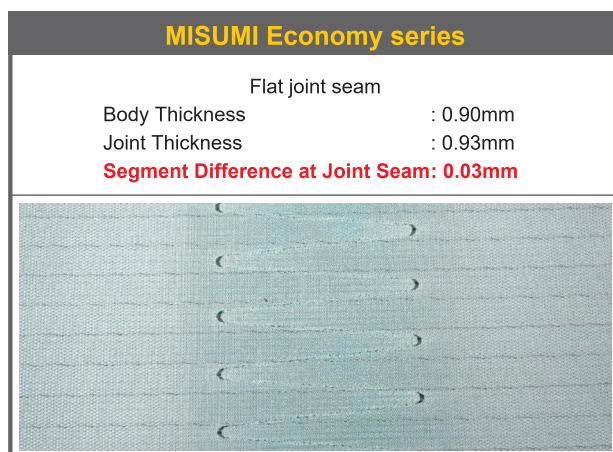
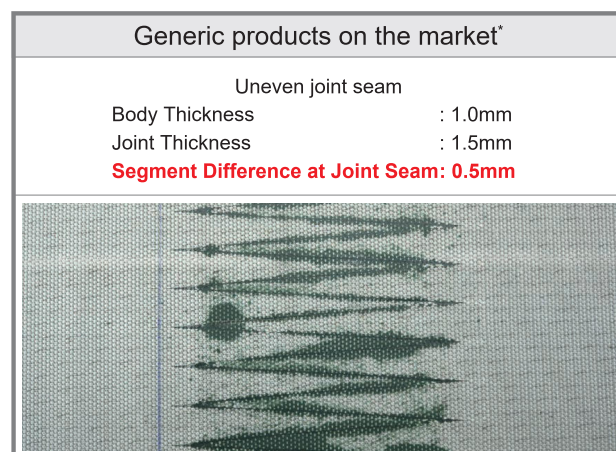

* Generic products on the market are similar products randomly purchased by our company from online or offline markets

* The above values are obtained through random sampling by our company for reference only.

8

Flat Belts / Rollers /
Cam Followers

Flat Belt
Pulleys

P.699

Flat Belt

P.705

Urethane
Molded Rollers

P.711

Ball Rollers

P.717

Cam
Followers

P.725

Roller
Followers

P.735

Silicon Bearings
Threaded Bearings

P.737

Representative model: CFBUG-20-0.8

Save Up to **58%**
vs Standard Type

Shipping
from
8 days

423

THB

Volume Discount

Quantity	2~5	6~
Discount	Unit Price	25%



① Shipping days may differ by Quantity.
② Quantity of volume discount above is for representative Part No. It may differ by the Part.

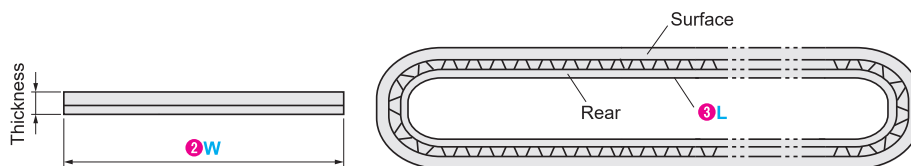
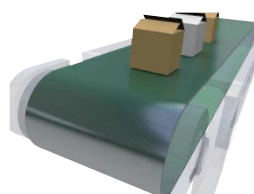

① Type	Belt Width ② W(mm) 1mm increments	Circumference Length ③ L(m) 0.01m increments	Thickness (mm)
CFBUG	10~500	0.70~20.00	0.9
CFBUM			
CFBUW			
CFBUWH			1.1
CFBUGD			1.5
CFBUBD			
CFBVG			1
CFBVW			
CFBVGD			2
CFBVWD			

Type	Material		Surface Cover Color	Surface Cover Shape	Number of Layers	Thickness mm	Min. Pulley Dia. r φ mm	Allowable Tension N/mm	Unit Mass kg/m²	Coefficient of Friction (Ref. Value with Polished Steel)		Rib	Continuous Operating Temperature °C
	Surface	Rear								Surface	Rear		
CFBUG	Urethane	Polyester Canvas	Green	Glossy Surface	1	0.9	10	4	0.9	0.4	0.1	R4	-20~80
CFBUM			White	Matt Surface		1.1			1.2				
CFBUW			Green		2	1.5	30	6	1.7			-	
CFBUWH			Black										
CFBUBD													
CFBVG	Polyvinyl Chloride	Polyester Canvas	Green	Glossy Surface	1	1	10	4	1.1	0.5	0.2	R5	-5~80
CFBVW			White		2	2	30	6	2.3				
CFBVGD			Green									-	
CFBVWD			White	Matt Surface									

① Flat belt are weld-jointed before shipping. ② The permanent stretch rate of the belt is 1% relative to the total length (reference value).
③ Set the inner diameter as the circumference length. ④ Please select the pulley model after confirming the width tolerance between the pulley and the idler.

Ordering Example

Please order after selecting part number and parameters according to the selection steps ① to ③.
① Type - ② Belt Width W(mm) - ③ Circumference Length L(m)
CFBUG - 20 - 0.8



By Type Search on MISUMI official website
CFBUG

By Keyword Step 1 Search on MISUMI official website
flat belt

Step 2 Select MISUMI economy series brand
☐ MISUMI ☒ MISUMI economy

MISUMI contact

Tel: 038-959200 or 1382
Email: cs@misumi.co.th

MISUMI WEB "Chat"



Install MISUMI APP





Representative model: CFBEB-20-0.8

Save Up to **37%** vs Standard Type

635

THB

Shipping from 8 days

Volume Discount

Quantity	2~5	6~
Discount	Unit Price	28%



① Shipping days may differ by Quantity.

② Quantity of volume discount above is for representative Part No. It may differ by the Part.

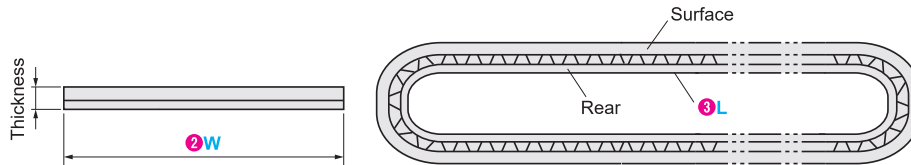

① Type	Belt Width ② W(mm) 1mm increments	Circumference Length ③ L(m) 0.01m increments	Thickness (mm)
CFBEB	10~500	0.70~20.00	0.8
CFBEBD			1.5

Type	Material		Surface Cover Color	Surface Cover Shape	Number of Layers	Thickness mm	Min. Pulley Dia. r φmm	Allowable Tension N/mm	Unit Mass kg/m ²	Coefficient of Friction (Ref. Value with Polished Steel)		Rib	Continuous Operating Temperature °C
	Surface	Rear								Surface	Rear		
CFBEB	Conductive Urethane	Polyester Canvas	Black	Matt Surface	1	0.8	15	4	0.9	0.4	0.1	R4	-20~80
CFBEBD					2	1.5	30	6	1.7			-	

① Flat belt are weld-jointed before shipping.

② The permanent stretch rate of the belt is 1% relative to the total length (reference value).

③ Set the inner diameter as the circumference length.

④ Please select the pulley model after confirming the width tolerance between the pulley and the idler.

⑤ Due to its anti-static specifications, it is suitable for electronic parts that do not like the generation of static electricity. Surface Resistance Value *10⁶~10⁸Ω.

* The surface resistance value is the value measured only with the belt under the following test conditions. It changes due to the influence of the environment and peripheral devices. This is a reference value, not guaranteed value.

⑥ Test Conditions: Temperature 23±2°C, Humidity 50±5%.

Ordering Example

Please order after selecting part number and parameters according to the selection steps ① to ③.

① Type - ② Belt Width W(mm) - ③ Circumference Length L(m)
CFBEB - 20 - 0.8

How to search on website



By Type
Search on MISUMI official website
CFBEB

By Keyword
Step 1 ▶ Search on MISUMI official website
flat belt

Step 2 ▶ Select MISUMI economy series brand

☐ MiSUMI ☒

MISUMI contact

Tel: 038-959200 or 1382
Email: cs@misumi.co.th

MISUMI WEB “Chat”



Install MISUMI APP



8 Flat Belts / Rollers / Cam Followers

Flat Belt Pulleys

P.699

Flat Belt

P.705

Urethane Molded Rollers

P.711

Ball Rollers

P.717

Cam Followers

P.725

Roller Followers

P.735

Silicon Bearings Threaded Bearings

P.737

Representative model: CFBSG-100-1.3

Save Up to **30%**
vs Standard Type

1,838 THB

Shipping
from
8 days

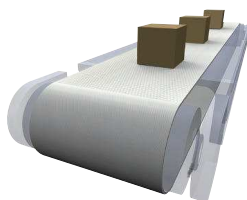

Volume Discount

Quantity	2~5	6~
Discount	Unit Price	20%



① Shipping days may differ by Quantity.

② Quantity of volume discount above is for representative Part No. It may differ by the Part.

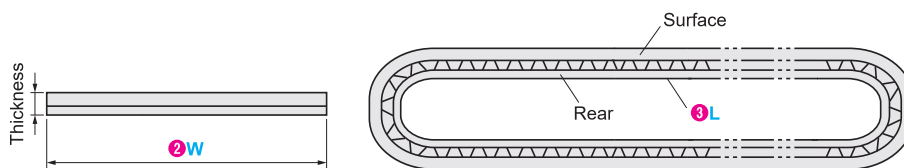

① Type	Belt Width ② W(mm) 1mm increments	Circumference Length ③ L(m) 0.01m increments	Thickness (mm)
CFBSG	10~500	0.70~20.00	0.5
CFBSWD			1.2

Type	Material		Surface Cover Color	Surface Cover Shape	Number of Layers	Thickness mm	Min. Pulley Dia. r φmm	Allowable Tension N/mm	Unit Mass kg/m ²	Coefficient of Friction (Ref. Value with Polished Steel)		Rib	Continuous Operating Temperature °C
	Surface	Rear								Surface	Rear		
CFBSG	Urethane Impregnated	Polyester Canvas	Green	Plane	1	0.5	10	4	0.3	0.2	0.1	R4	-20~80
CFBSWD			White		2	1.2	20	6	1.2			R5	

① Flat belt are weld-jointed before shipping.

② The permanent stretch rate of the belt is 1% relative to the total length (reference value).

③ Set the inner diameter as the circumference length.

④ Please select the pulley model after confirming the width tolerance between the pulley and the idler.

Ordering Example

Please order after selecting part number and parameters according to the selection steps ① to ③.

① Type - ② Belt Width W(mm) - ③ Circumference Length L(m)
CFBSG - 100 - 1.3

How to search on website



By Type
Search on MISUMI official website
CFBSG

By Keyword
Step 1 ▶ Search on MISUMI official website
flat belt

Step 2 ▶ Select MISUMI economy series brand
☐ MISUMI ☒ MISUMI economy

MISUMI contact

Tel: 038-959200 or 1382
Email: cs@misumi.co.th

MISUMI WEB “Chat”



Install MISUMI APP



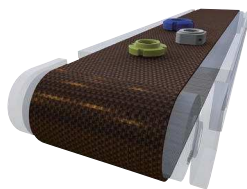

Representative model: CFBGG-110-1.1

Save Up to **30%**
vs Standard Type

1,460 THB

Shipping from 8 days

Volume Discount

Quantity	2~5	6~
Discount	Unit Price	20%



① Shipping days may differ by Quantity.

② Quantity of volume discount above is for representative Part No. It may differ by the Part.

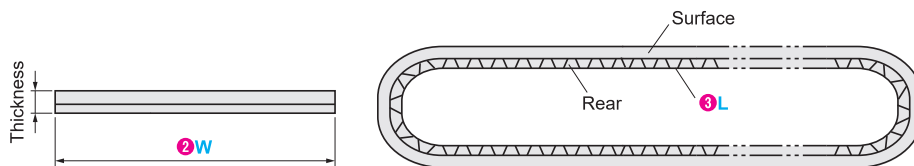

① Type	Belt Width ② W(mm) 1mm increments	Circumference Length ③ L(m) 0.01m increments	Thickness (mm)
CFBGG CFBGB	10~500	0.70~20.00	1.2

Type	Material		Surface Cover Color	Surface Cover Shape	Number of Layers	Thickness mm	Min. Pulley Dia. r φ mm	Allowable Tension N/mm	Unit Mass kg/m ²	Coefficient of Friction (Ref. Value with Polished Steel)		Rib	Continuous Operating Temperature °C
	Surface	Rear								Surface	Rear		
CFBGG	Urethane	Impregnated Polyester Canvas	Green	Texture (Fine)	1	1.2	20	4	1.2	0.4	0.2	R4	-20~80
CFBGB			Brown										

① Flat belt are weld-jointed before shipping.

② The permanent stretch rate of the belt is 1% relative to the total length (reference value).

③ Set the inner diameter as the circumference length.

④ Please select the pulley model after confirming the width tolerance between the pulley and the idler.

Ordering Example

Please order after selecting part number and parameters according to the selection steps ① to ③.

① Type - ② Belt Width W(mm) - ③ Circumference Length L(m)
CFBGG - 110 - 1.1

How to search on website



By Type

Search on MISUMI official website

CFBGG

By Keyword

Step 1 ▶ Search on MISUMI official website

flat belt

Step 2 ▶ Select MISUMI economy series brand

☐ MiSUMI ☒



MISUMI contact

Tel: 038-959200 or 1382
Email: cs@misumi.co.th

MISUMI WEB “Chat”

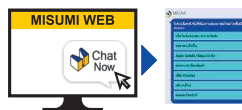

Install MISUMI APP



8

Flat Belts / Rollers /
Cam Followers

Flat Belt
Pulleys

P.699

Flat Belt

P.705

Urethane
Molded Rollers

P.711

Ball Rollers

P.717

Cam
Followers

P.725

Roller
Followers

P.735

Silicon Bearings
Threaded Bearings

P.737

Economy series Urethane Molded Rollers

Suitable for low to medium load and
low to medium speed conveying of
vulnerable workpieces

Wear-resistant adhesive layer

Smooth rotation



Not prone to discoloration



vs Standard Type
Saving
up to

61 %

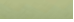
Product Features

Item	MISUMI standard product	MISUMI Economy series	
		Set Screw Type	With Bearing
Application	High precision (Radial Runout suppression is highly required)	Medium Precision Without Radial Runout Requirements	
Inner Hole Precision *Hole Precision for With Bearing Type	H7	+0.05 0	+0.025 0
Used Bearing	Japanese Brands (Radial Runout 3~13μm)*1	-	MISUMI Economy series Bearings (Radial Runout 6~23μm)*1
Color	Natural Color 	Shore A90*2→Green  Shore A70*2→Black 	

*1 Radial runout is a reference value, not guaranteed value. *2 Hardness actual tactile reference: Shore A90→Golf ball, Shore A70→Car tire

To solve your troubles in the purchase of urethane molded roller

Generic products
on the market



Worn



Stuck



Discolored

Economy series High-quality raw materials are selected, **and the wear resistance is equivalent to the standard products.**

MISUMI Economy series bearing is used to ensure **smooth rotation.**

Add color glue to **alleviate batch color difference.**

* Generic products on the market are similar products randomly purchased by our company from online or offline markets

Example of Use

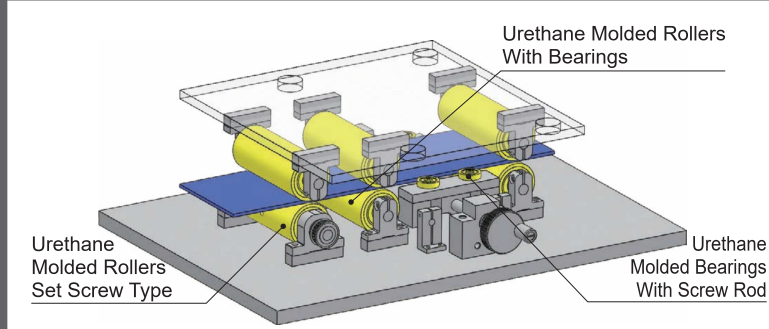

Urethane Molded Rollers With Bearings

Urethane Molded Rollers Set Screw Type

Urethane Molded Bearings With Screw Rod

Mechanism:
Thin plate feeding

Application:
Clamp the thin plate and convey it to the next process. Width and height can be adjusted to adapt to different sizes of thin plates.

Economy series Urethane Molded Bearings

Suitable for conveying and guiding
fragile workpieces without radial
runout requirements

Firmly urethane molded

Smooth rotation

Not prone to discoloration



Product Features

Item	MISUMI standard product	MISUMI Economy series
Requirements	High precision (Radial Runout suppression is highly required)	Medium precision Without radial runout requirements
Bearing Inner Hole Precision	Class P0	+0.005 -0.015
Used Bearing	Japanese Brands (Radial Runout 3~13μm)*	Customized Chinese Bearings (Radial Runout 8~23μm)*

* Radial runout is a reference value, not guaranteed value.

To solve your troubles in the purchase of urethane molded bearing

Generic products
on the market

Unglued

Lack of oil

Discolored

Economy series

Based on effective quality management, the gluing is uniform and **the adhesive layer is firm.**

The customized rubber end cap bearing is used to ensure **effective grease residue.**

Add color glue to **alleviate batch color difference.**

* Generic products on the market are similar products randomly purchased by our company from online or offline markets

Example of Use

Mechanism:
Thin plate conveying

Application:
The round belts at both ends provide power for the thin plate workpiece, and in order to prevent the middle of the thin plate workpiece from sagging and collapsing, urethane molded bearings are used for follow-up support.

Mechanism:
Packing box conveying

Application:
Use the powerless roller and the dynamic potential energy to make the packing box slide freely. The two sides are supplemented by urethane molded bearings to prevent the packing box from falling sideways.

8	Fiat Belts / Rollers / Cam Followers
	Fiat Belt Pulleys
P.699	
	Fiat Belt
P.705	
	Urethane Molded Rollers
P.711	
	Ball Rollers
P.717	
	Cam Followers
P.725	
	Roller Followers
P.735	
	Silicon Bearings
P.737	

Representative model: C-RORUA25-30

Save Up to **61%**
vs Standard Type

339

THB

Shipping
from
1 day

Volume Discount

Quantity	1~3	4~5	6~
Discount	Unit Price	15%	30%



Shipping days may differ by Quantity.

Quantity of volume discount above is for representative Part No. It may differ by the Part.

Type	Bushing			Core Material		Bearing Material
	Material	Hardness	Color	Material	Surface treatment	
C-RORUS	Ether Polyurethane	Shore A90	Green	Stainless Steel	Not Provided	SUJ2
C-RORUA				Aluminum Alloy		
C-RORGS		Shore A70	Black	Stainless Steel		
C-RORGA				Aluminum Alloy		

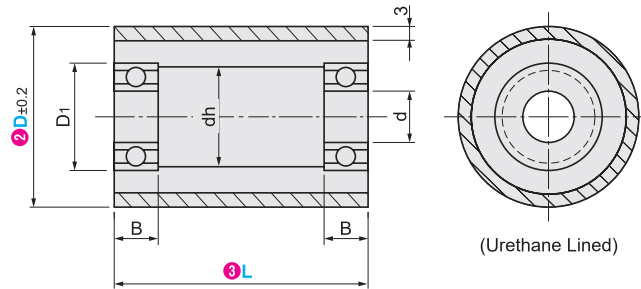

- No particular brand is specified for the bearings in use.
- Urethane and core material are molded in one piece.

Part Number		Length L Selection					d	D1	(dh)	B	Bearing	Number of Bearings
①Type	②O.D. D											
C-RORUS C-RORUA C-RORGS C-RORGA	25	20	30	40	50		6	15	10	5	696ZZ	2
	30	20	30	40	50		8	19	15	6	698ZZ	
	35		30	40	50		10	22	18	8	6900ZZ	
	40		30	40	50	100	12	28	24	9	6001ZZ	
	50		30	40	50	100	15	32	28		6002ZZ	

(dh) dimensions are not processed because the core material is an extruded pipe. The dimensions are for reference only.

Please order after selecting part number and parameters according to the selection steps ① to ③.

Ordering Example: Part Number (①Type · ②O.D. D) - ③Length L
C-RORUA25 - 30

Difference between MISUMI Economy series and MISUMI standard product

Item	MISUMI standard product	MISUMI Economy series	
		Set Screw Type	With Bearing
Application	High precision (Radial Runout suppression is highly required)	Medium Precision Without Radial Runout Requirements	
Inner Hole Precision * Hole Precision for With Bearing Type	H7	+0.05 0	+0.025 0
Used Bearing	Japanese Brands (Radial Runout 3~13μm)*1	-	MISUMI Economy series Bearings (Radial Runout 6~23μm)*1
Color	Natural Color	Shore A90*2→Green Shore A70*2→Black	



Example

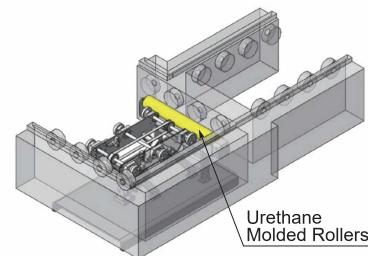

Urethane Molded Rollers

*1 Radial runout is a reference value, not guaranteed value. *2 Hardness actual tactile reference: Shore A90→Golf ball, Shore A70→Car tire

How to search on website

By Type:

By Keyword:

Step 1 Search on MISUMI official website

Step 2 Select MISUMI economy series brand

☐ MISUMI ☒ MISUMI economy

MISUMI contact

Tel: 038-959200 or 1382
Email: cs@misumi.co.th

MISUMI WEB "Chat"



Install MISUMI APP



Representative model: C-ROUAN25-8-30



Save Up to **54%**
vs Standard Type

267

THB

Shipping
from
1 day

Volume Discount

Quantity	1~9	10~14	15~
Discount	Unit Price	15%	30%

① Shipping days may differ by Quantity.

② Quantity of volume discount above is for representative Part No. It may differ by the Part.



Type	Bushing			Core Material	
	Material	Hardness	Color	Material	Surface treatment
C-ROUSN C-ROUAN C-ROGSN C-ROGAN	Ether Polyurethane	Shore A90	Green	Stainless Steel Aluminum Alloy	Not
		Shore A70	Black	Stainless Steel Aluminum Alloy	Provided

① Set screws are not provided with this product. Please pay attention when using it.

② Material color is subject to the actual product.

③ When $L \leq d \times 3$, d hole is machined from one side.

④ When $L > d \times 3$, d hole is machined from both sides.

Sometimes there may be no relief processing.

⑤ Urethane and core material are molded in one piece.

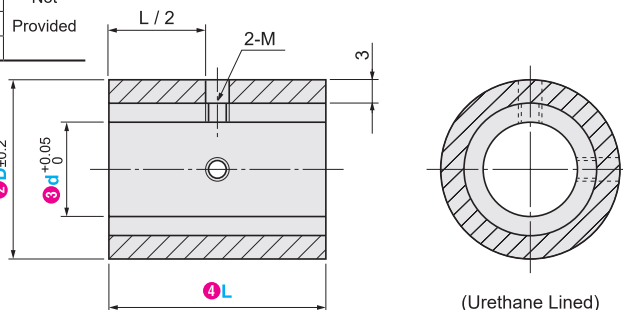

Part Number		③ I.D. d	④ Length L Selection				M
① Type	② O.D. D		20	30	40	50	
C-ROUSN C-ROUAN C-ROGSN C-ROGAN	20	8	20	30	40	50	M3
	25		20	30	40	50	
	30	10	20	30	40	50	M4
	40		20	30	40	50	
	50	15	30	40	50	100	M5

Ordering Example

Please order after selecting part number and parameters according to the selection steps ① to ④.

Part Number (① Type · ② O.D. D) - ③ I.D. d - ④ Length L
C-ROUAN25 - 8 - 30

Difference between MISUMI Economy series and MISUMI standard product

Item	MISUMI standard product	MISUMI Economy series	
		Set Screw Type	With Bearing
Application	High precision(Radial Runout suppression is highly required)	Medium Precision Without Radial Runout Requirements	
Inner Hole Precision *Hole Precision for With Bearing Type	H7	+0.05 0	+0.025 0
Used Bearing	Japanese Brands (Radial Runout 3~13μm)*1	-	MISUMI Economy series Bearings (Radial Runout 6~23μm)*1
Color	Natural Color	Shore A90*2→Green Shore A70*2→Black	

*1 Radial runout is a reference value, not guaranteed value.

*2 Hardness actual tactile reference: Shore A90→Golf ball, Shore A70→Car tire

About machining conditions of round hole type and set screw type

Straight Type

■ ℓ Dimension

d	Total Length L Dimension						
	15	20	25	30	40	50	100
8	No relief machining			8	16	16	-
10	No relief machining			10	10	20	-
12	No relief machining			12	24	24	-
15	No relief machining			15	30	30	-
20	No relief machining			20	40	40	-
25	No relief machining			25	25	25	-
30	No relief machining			30	30	30	-

① When $L < d \times 3$, straight type (no relief groove machining).
When $L \geq d \times 3$, the effective length of both ends is $d \times 1$ (ℓ), and others require relief machining.
When $L > d \times 4$, the effective length of both ends is $d \times 2$ (ℓ), and others require relief machining.
* Sometimes there may be no relief machining.

How to search on website



By Type

Search on MISUMI official website

C-ROUSN



By Keyword

Step 1▶ Search on MISUMI official website

urethane roller



Step 2▶ Select MISUMI economy series brand

MISUMI



MISUMI economy

Representative model: C-TMBB6-20

Save Up to **74%**
vs Standard Type

55

THB

Shipping
from
1 day

Volume Discount

Quantity	1~29	30~49	50~
Discount	Unit Price	15%	30%



Shipping days may differ by Quantity.

Quantity of volume discount above is for representative Part No. It may differ by the Part.

Urethane Hardness	Bearing Material
Shore A90 (Green)	Bearing Steel

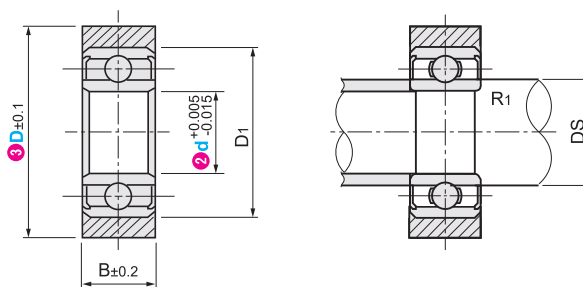

- Urethane material and bearing are molded in one piece.
- Depending on the model, the edge of the molded layer may be curved.
- Urethane is thermoplastic urethane.
- No particular brand is specified for the bearings in use.

Part Number		O.D. D	Allowable Load N (kgf)	B	D1	Mounting Dimensions		Bearing
Type	I.D. d					Ds (min.)	R1 (max.)	
C-TMBB	3	12	34(3.5)	3	7	3.9	4.1	0.1
	4	13	44(4.5)	4	9	5	5.2	0.1
	5	16	59(6)	5	13	5.6	6.2	0.2
	6	20	78(8)	6	16	6.6	6.9	0.2
	8	28	157(16)	7	15	7	7.6	0.2
	10	30	176(18)	8	19	7.6	7.8	0.2
	15	40	274(28)	9	22	8	9.5	0.3
					26	10	12.2	0.3
					30	12	13.5	0.3
					32	14	16	0.6
						17	19	0.3

Please order after selecting part number and parameters according to the selection steps ① to ③.

Part Number (①Type · ②I.D. d) - ③O.D. D
C-TMBB6 - 20

Difference between MISUMI Economy series and MISUMI standard product

Item	MISUMI standard product	MISUMI Economy series
Requirements	High precision (Radial Runout suppression is highly required)	Medium Precision Without Radial Runout Requirements
Bearing Inner Hole Precision	Class P0	+0.005 -0.015
Used Bearing	Japanese Brands (Radial Runout 3~13μm)*	Customized Chinese Bearings (Radial Runout 8~23μm)*

* Radial runout is a reference value, not guaranteed value.



Example Wire crimping mechanism of winding machine

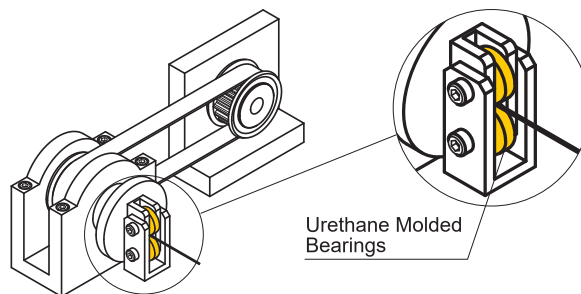

How to search on website



By Type

Search on MISUMI official website

C-TMBB

By Keyword

Step 1 Search on MISUMI official website

urethane bearing

Step 2 Select MISUMI economy series brand

☐ MISUMI ☒ MISUMI economy



MISUMI contact

Tel: 038-959200 or 1382
Email: cs@misumi.co.th

MISUMI WEB "Chat"



Install MISUMI APP



Representative model: C-TMBH6-20

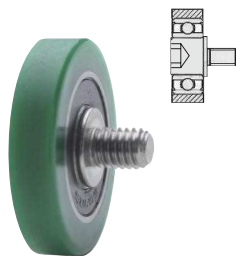

Save Up to **79%**
vs Standard Type

75

THB

Shipping
from
1 day

Volume Discount

Quantity	1~29	30~49	50~
Discount	Unit Price	15%	30%



Shipping days may differ by Quantity.

Quantity of volume discount above is for representative Part No. It may differ by the Part.

Urethane Hardness	Bearing Material	Screw Rod Material
Shore A90 (Green)	Bearing Steel	Stainless Steel

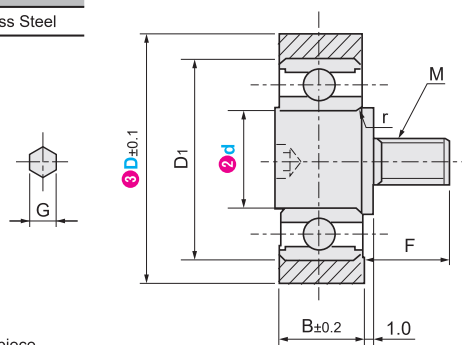

- Urethane material and bearing are molded in one piece.
- Depending on the model, the edge of the molded layer may be curved.
- Urethane is thermoplastic urethane.
- No particular brand is specified for the bearings in use.

Part Number		③ O.D. D	Thread Nominal Diameter M	F	Allowable Load N (kgf)	B	D1	r (min.)	G	Bearing
① Type	② I.D. d									
C-TMBH	3	12	M3	4	34(3.5)	3	7	0.1	1.5	683ZZ
	4	13	M4	5	44(4.5)	4	9	0.15	2	684ZZ
	5	16			59(6)	5	13	0.2	2.5	624ZZ
	6	20			78(8)		16	0.3		685RS
	8	28	M6	8	157(16)	6	19	0.2	3	625RS
	10	30			176(18)	7	22	0.3	4	696RS
	15	40			274(28)	8	26	0.6	5	626RS
						9	30	0.3	8	608RS
							32	0.3		6000RS
										6200RS
			M10	12						6002RS

Ordering Example

Please order after selecting part number and parameters according to the selection steps ① to ③.

Part Number (①Type · ②I.D. d) - ③O.D. D
C-TMBH6 - 20

Difference between MISUMI Economy series and MISUMI standard product

Item	MISUMI standard product	MISUMI Economy series
Requirements	High precision (Radial Runout suppression is highly required)	Medium Precision Without Radial Runout Requirements
Bearing Inner Hole Precision	Class P0	+0.005 -0.015
Used Bearing	Japanese Brands (Radial Runout 3~13μm)*	Customized Chinese Bearings (Radial Runout 8~23μm)*

*Radial runout is a reference value, not guaranteed value.



Example Workpiece transfer assistance

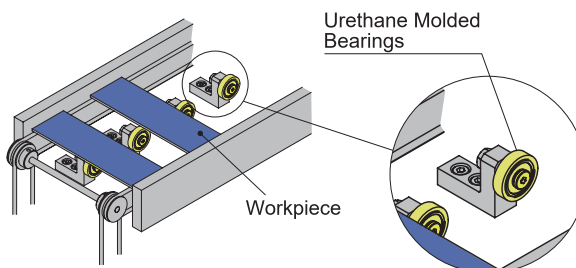

How to search on website



By Type

Search on MISUMI official website

C-TMBH

By Keyword

Step 1 Search on MISUMI official website

urethane bearing

Step 2 Select MISUMI economy series brand

☐ MISUMI ☒ **MISUMI economy**

MISUMI contact

Tel: 038-959200 or 1382
Email: cs@misumi.co.th

MISUMI WEB "Chat"

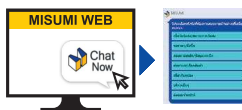

Install MISUMI APP



Economy Series Ball Rollers

MISUMI best-selling Economy series products, with cost performance greatly improved

Mountable in all directions

Stainless steel with excellent anti-rust performance

vs Standard Type
Saving
up to

54%



· A total of 7 series and 34 specifications of new products have been introduced.

Product Difference

Product Name	Item	MISUMI standard product	MISUMI Economy series	Generic products on the market*
Ball Rollers	Case Material	SUS304	SUS304	SUS420
	Steel Ball Material	SUS440C	SUJ2&SUS304	Gcr15
	Load KG(N)	55(5.6)~539(55)	44(4.8)~470.4(48)	33(3.36)~352.8(36)

· Compared with similar steel ball roller products, the load of this MISUMI economy series product is much higher than products circulating on the market, reaching more than **1.2** times.

· High quality stainless steel shell process is used for MISUMI Economy series steel ball roller, and its corrosion resistance life is more than **2.6** times higher than generic products on the market*.

As the steel ball roller is mostly used in the conveying process, it has high requirements for the corrosion resistance, wear resistance and load of the material surface.

· According to the statistics, the probability that the products can not be used normally due to rust has reached about 40% when customers buy generic products on the market*. Analyze the above problems.
· The following is the comparison of 72 hour salt spray test between MISUMI Economy series products and generic products on the market*, and the difference is obvious.

Generic products on the market*

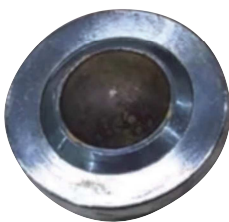

100% corrosion area of steel balls for generic products on the market

Economy series products

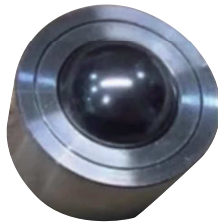

MISUMI Economy series uses high quality stainless steel without any problem

* Generic products on the market are similar products randomly purchased by our company from online or offline markets

* The test data are obtained through testing by our company, which are for reference only

Ball rollers appear in various types, allowing installation and fixation in multiple ways, and there are multi-functional products that can be used up and down.

Specifications can be selected according to different installation dimensions, directions, loads and materials.

			
C-BCBE	C-BCHN	C-BCHM	C-BCHL
Milled, Threaded Stud	Flange Mounting Type	Round, Screw Type	Hexagonal, Screw Type

				
C-BCF	C-BCHF	C-BCHA	C-SSPF*	C-SSPN*
Milled, Flange Mounting Type	Nut Fixed Type	Press Fit Type	Compact, Press Fit Type (Flanged Type)	Compact, Press Fit Type (Normal Type)

*1 Series (8 specifications) Not generic products on the market

MISUMI Economy series products undergo rigorous testing before mass production and sales.



Product Usage Example:

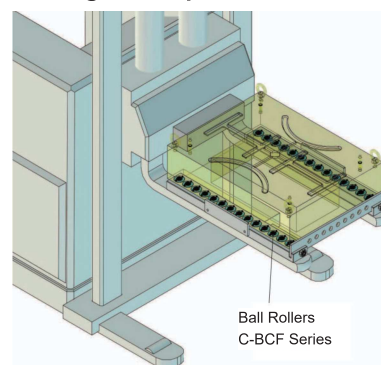

Example of using ball rollers on loading trolleys for changing molds. The ball roller can rotate in all directions, so it is suitable for the purpose of changing the conveying direction and rotating the work table. When using ball rollers, take measures to prevent the conveyed objects from falling. MISUMI products can be used for a variety of purposes according to the customer's creativity.

MISUMI Economy series new product compact type - reduces the installation height, and the load is relatively close to the standard product.

- As the sheet metal cost increases year by year, it can save more than 30% of the sheet metal cost for customers.
- The sales price of the compact press fit type is reduced by more than 30% compared with the normal press fit type (C-BCHA).



The specifications of the new compact product are as follows:

Part Number		D(mm)
Type	d(mm)	
C-SSPF (Stainless Steel Ball)	12	18
	15	24
	19	30
	22	36

Part Number		D(mm)
Type	d(mm)	
C-SSPN (Stainless Steel Ball)	8	15
	10	16
	12	22
	15	24

8

Flat Belts / Rollers /
Cam Followers

Flat Belt
Pulleys

P.699

Flat Belt

P.705

Urethane
Molded Rollers

P.711

Ball Rollers

P.717

Cam
Followers

P.725

Roller
Followers

P.735

Silicon Bearings
Threaded Bearings

P.737

Representative model: C-BCBE20

Save Up to **30%**
vs Standard Type

Shipping
from
1 day

272

THB

Volume Discount

Quantity	1~3	4~5	6~
Discount	Unit Price	15%	30%



Shipping days may differ by Quantity.

Quantity of volume discount above is for representative Part No. It may differ by the Part.

C-BCBE10
C-BCBE20

C-BCBE50
C-BCBE120

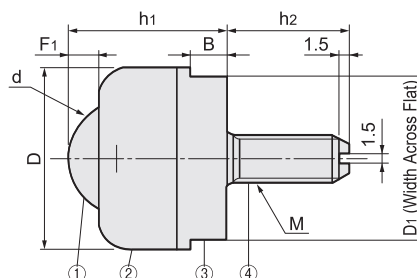
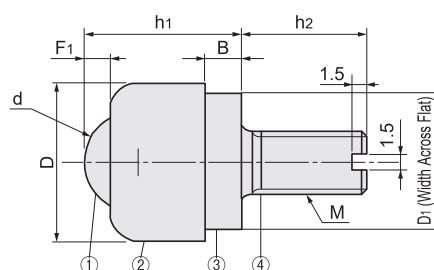

Material: ① Main Ball : SUJ2
② Shell : S20C
③ Main Body : S45C
④ Threaded Part : S45C
SubBall : SUJ2

Part Number		Nominal Thread M	O.D. D	D1	d	B	h1	h2	F1	Mounting Direction	Debris Discharge Hole	Load Capacity N (kgf)
① Type	② No.											
C-BCBE	10	M6	15	13	9.525	3.5	15	12	2.5	All Directions	Not Provided	117.6(12)
	20		24	21	15.875	4.5	20.5		4			274.4(28)
	50	M8	30	27	19.05	6	26	20	5			470.4(48)
	120	M10	42	36	25.4	8	36		6.5			1176(120)

Ordering Example

Please order after selecting part number and parameters according to the selection steps ① to ②.

Part Number (①Type · ②No.)

C-BCBE20

How to search on website



By Type

Search on MISUMI official website

C-BCBE



By Keyword

Step 1 Search on MISUMI official website

ball roller



Step 2 Select MISUMI economy series brand

☐ MISUMI



MISUMI
economy

MISUMI contact

Tel: 038-959200 or 1382
Email: cs@misumi.co.th

MISUMI WEB "Chat"

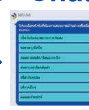

Install MISUMI APP



Ball Rollers Milled, Flange Mounting Type

Representative model: C-BCF120

Save Up to **54%**
vs Standard Type

Shipping
from
1 day



1,166 THB

Volume Discount

Quantity	1~3	4~5	6~
Discount	Unit Price	15%	30%



Shipping days may differ by Quantity.

Quantity of volume discount above is for representative Part No. It may differ by the Part.

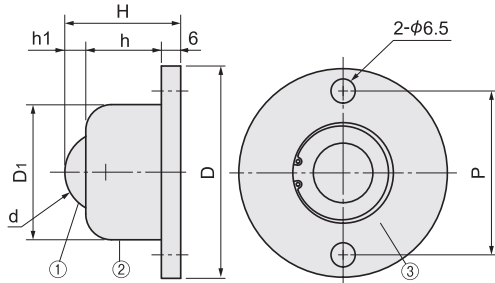

Material: ①Main Ball : SUJ2
②Shell : S45C
③Main Body : S45C
Sub Ball : SUJ2

Can be used in both up / down directions and horizontally.

Ordering Example

Please order after selecting part number and parameters according to the selection steps ① to ④.

Part Number (①Type · ②No.)
C-BCF120

Part Number	①Type	②No.	O.D. D	D1	d	H	h	h1	P	Mounting Direction	Debris Discharge Hole	Load Capacity N (kgf)
C-BCF		50	56	30	19.05	26	15	5	44	All Directions	Not Provided	470.4(48)
		120	66	42	25.4	36	23.5	6.5	54			1176(120)

Ball Rollers Round, Stainless Steel, Screw Type

Representative model: C-BCHM16

Save Up to **30%**
vs Standard Type

Shipping
from
1 day



328 THB

Volume Discount

Quantity	1~3	4~5	6~
Discount	Unit Price	15%	30%



Shipping days may differ by Quantity.

Quantity of volume discount above is for representative Part No. It may differ by the Part.

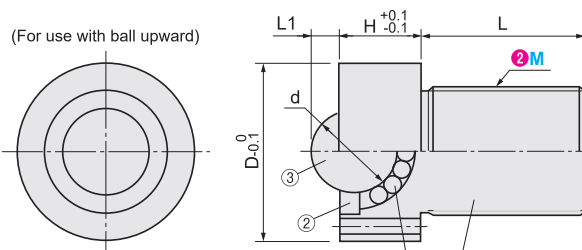

Material: ①Main Body : SUS304
②Shell : SUS304
③Main Ball : SUS304
④Sub Ball : SUS304

Ordering Example

Please order after selecting part number and parameters according to the selection steps ① to ④.

Part Number (①Type · ②Nominal Thread M)
C-BCHM16

Part Number	①Type	②Nominal Thread M	O.D. D	L	L1	H	d	Load Capacity N (kgf)
C-BCHM		10	18.5	12	2.5	10	8.73	44(4.5)
		12	22	15	3.5	11	10.32	49.6(5)
		16	27	20	5.3	15	15.87	274(28)
		20	33	25	6.3	18	19.05	330(34)

How to search on website



By Type

Search on MISUMI official website

C-BCF

By Keyword

Step 1 Search on MISUMI official website

ball roller

Step 2 Select MISUMI economy series brand

☐ MISUMI



MISUMI
economy

MISUMI contact

Tel: 038-959200 or 1382
Email: cs@misumi.co.th

MISUMI WEB "Chat"

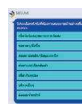

Install MISUMI APP



8
Flat Belts / Rollers /
Cam Followers

Flat Belt
Pulleys
P.699

Flat Belt
P.705

Urethane
Molded Rollers
P.711

Ball Rollers
P.717

Cam
Followers
P.725

Roller
Followers
P.735

Silicon Bearings
Threaded Bearings
P.737

Representative model: C-BCHN16

Save Up to **30%**
vs Standard Type

316

THB

Shipping
from
1 day



Volume Discount

Quantity	1~3	4~5	6~
Discount	Unit Price	15%	30%

Shipping days may differ by Quantity.

Quantity of volume discount above is for representative Part No. It may differ by the Part.



C-BCHN

(For use with ball upward)

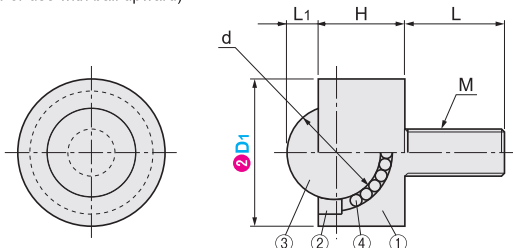

C-BCHF

(For use with ball upward)

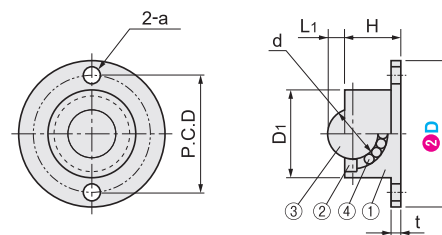

Nut Size

M	B1	(e)	T
M6	10	11.5	5
M8	13	15	6.5
M10	17	19.6	8

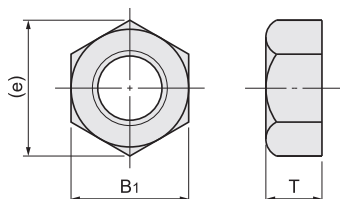

For use with ball upward.

Material: ① Main Body : SUS304
② Adjusting Ring : SUS304
③ Main Ball : SUS304
④ Sub Ball : SUS304

Nut Fixed Type

Part Number		L1	H	M	L	d	Load Capacity N (kgf)
① Type	② O.D. D1						
C-BCHN	16	2.5	9.5	6	15	8.73	44(4.5)
	19	3.5	11.5	8	20	10.32	49.6(5)
	25	5.3	14.7			15.87	274(28)
	31	6.3	18.7	10	25	19.05	330(34)

Flange Mounting Type

Part Number		D1	L1	H	t	P.C.D	a	d	Load Capacity N (kgf)
① Type	② O.D. D								
C-BCHF	27	15	2.5	9.5	2	21	3.5	8.73	44(4.5)
	30	18	3.5	11.5		24		10.32	49.6(5)
	39	24	5.3	14.7	3	31.5	4.5	15.87	274(28)
	48	30	6.3	18.7	4	39	5.5	19.05	330(34)

Ordering Example

Please order after selecting part number and parameters according to the selection steps ① to ②.

Part Number (① Type · ② O.D. D1)

C-BCHN16

How to search on website



By Type

Search on MISUMI official website

C-BCHN



By Keyword

Step 1 Search on MISUMI official website

ball roller



Step 2 Select MISUMI economy series brand

☐ MISUMI ☒



MISUMI contact

Tel: 038-959200 or 1382
Email: cs@misumi.co.th

MISUMI WEB "Chat"



Install MISUMI APP





Representative model: C-BCHL12

Save Up to **30%**
vs Standard Type

242

THB

Shipping
from
1 day

Volume Discount

Quantity	1~9	10~14	15~
Discount	Unit Price	15%	30%



Shipping days may differ by Quantity.

Quantity of volume discount above is for representative Part No. It may differ by the Part.

(For use with ball upward)

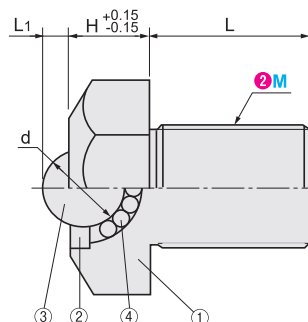
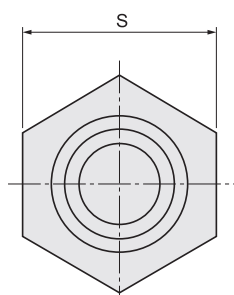

Material: ① Main Body : SUS304
② Adjusting Ring : SUS304
③ Main Ball : SUS304
④ Sub Ball : SUS304

Part Number		L	L1	H	d	s	Load Capacity N (kgf)
① Type	② Nominal Thread M						
C-BCHL	10	12	2.5	10	8.73	17	44(4.5)
	12	15	3.5	11	10.32	19	49.6(5)
	16	20	5.3	15	15.87	24	274(28)
	20	25	6.3	18	19.05	30	330(34)

Ordering
Example

Please order after selecting part number and parameters according to the selection steps ① to ②.

Part Number (① Type · ② Nominal Thread M)

C-BCHL12

How to search
on website



By
Type

Search on MISUMI official website

C-BCHL



By
Keyword

Step 1 ▶ Search on MISUMI official website

ball roller



Step 2 ▶ Select MISUMI economy series brand

☐ MISUMI ☒ MISUMI economy



MISUMI contact

Tel: 038-959200 or 1382
Email: cs@misumi.co.th

MISUMI WEB "Chat"



Install MISUMI APP



Representative model: C-BCHA15

Save Up to **32%**
vs Standard Type

Shipping
from
1 day



219

THB

Volume Discount

Quantity	1~9	10~14	15~
Discount	Unit Price	15%	30%



① Shipping days may differ by Quantity.

② Quantity of volume discount above is for representative Part No. It may differ by the Part.

(For use with ball upward)

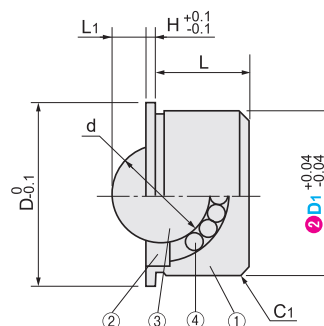
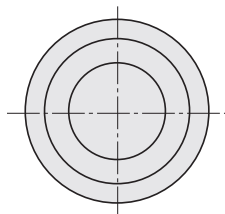

Material: ① Main Body : SUS304
② Adjusting Ring : SUS304
③ Main Ball : SUS304
④ Sub Ball : SUS304

Part Number		O.D. D	L	H	L1	d	Load Capacity N (kgf)
① Type	② Shaft Dia. D1						
C-BCHA	11	13	6	1	1.5	5.56	33(3.4)
	15	17	9		2.5	8.73	44(4.5)
	18	20	10		3.5	10.32	49.6(5)
	24	26	14	1.5	5.3	15.87	274(28)
	30	32	17	2	6.3	19.05	330(34)

① It is recommended that H7 tolerance is used for the press-fit type mounting holes.

Ordering Example

Please order after selecting part number and parameters according to the selection steps ① to ②.

Part Number (① Type · ② Shaft Dia. D1)

C-BCHA15

How to search on website



By Type

Search on MISUMI official website

C-BCHA



By Keyword

Step 1 ▶ Search on MISUMI official website

ball roller



Step 2 ▶ Select MISUMI economy series brand

☐ MISUMI ☒



MISUMI contact

Tel: 038-959200 or 1382
Email: cs@misumi.co.th

MISUMI WEB “Chat”



Install MISUMI APP



Representative model: C-SSPN15

Save Up to **54%**
vs Standard Type

Shipping
from
1 day



141

THB

Volume Discount

Quantity	1~9	10~14	15~
Discount	Unit Price	15%	30%



Shipping days may differ by Quantity.

Quantity of volume discount above is for representative Part No. It may differ by the Part.

C-SSPF
d=15

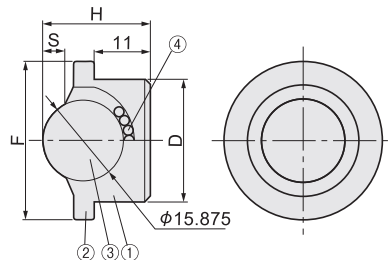

d=12
d=19
d=22

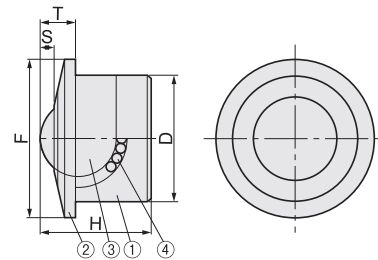

C-SSPN

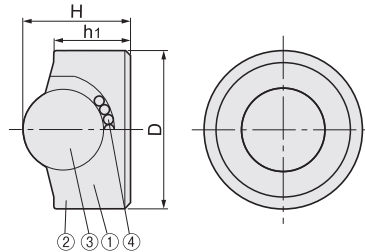

Material: ①Main Body : S45C
②Adjusting Ring : S20C
③Main Ball : SUJ2
④Sub Ball : SUJ2

Compact, Press Fit Flanged

Part Number		O.D. D	F	S	H	T	Load Capacity N (kgf)
①Type	②d						
C-SSPF	12	18	23	2.5	15.5	7.3	44(4.5)
	15	24	31	4.5	21	10	49.6(5)
	19	30	37		26		274(28)
	22	36	44.6	4	31	9.8	330(34)

It is recommended that H7 tolerance is used for the press-fit type mounting holes.

Compact, Press Fit Standard

Part Number		O.D. D	h1	H	Load Capacity N (kgf)
①Type	②d				
C-SSPN	8	15	10.9	13.6	44(4.5)
	10	16	8.5	12.5	49.6(5)
	12	22	13.5	17	274(28)
	15	24	14	20	330(34)

It is recommended that H7 tolerance is used for the press-fit type mounting holes.

Ordering
Example

Please order after selecting part number and parameters according to the selection steps ① to ②.

Part Number (①Type · ②d)

C-SSPN15

How to search
on website



By
Type

Search on MISUMI official website

C-SSPF

By
Keyword

Step 1 Search on MISUMI official website

ball roller

Step 2 Select MISUMI economy series brand

☐ MISUMI



MISUMI
economy

MISUMI contact

Tel: 038-959200 or 1382
Email: cs@misumi.co.th

MISUMI WEB "Chat"



Install MISUMI APP



8
Flat Belts / Rollers /
Cam Followers

Flat Belt
Pulleys

P.699

Flat Belt

P.705

Urethane
Molded Rollers

P.711

Ball Rollers

P.717

Cam
Followers

P.725

Roller
Followers

P.735

Silicon Bearings
Threaded Bearings

P.737

8

Flat Belts / Rollers /
Cam Followers

Flat Belt
Pulleys

P.699

Flat Belt

P.705

Urethane
Molded Rollers

P.711

Ball Rollers

P.717

Cam
Followers

P.725

Roller
Followers

P.735

Silicon Bearings
Threaded Bearings

P.737

Economy series Cam Followers

Resin outer ring, no longer
easy to fall off

***Newly added body stainless steel series**

Rubber coated stainless steel cam followers are expected to be available for sale after July 2022. Refer to the product page on our official website for the specific release date.

Nylon
Coated Type

vs Standard Type
Saving
up to

30 %

Urethane
Coated Type

Product Series Description

Nylon Coated Type



Nylon Coated Cam Follower is the product which nylon sleeve is press-fitted into the "grooved outer ring", then wrapping cured to prevent the resin part from falling off. It has excellent strength, wear resistance, damping, and sliding performance.

Urethane Coated Type



Urethane Coated Cam Follower is the product which urethane sleeve is press-fitted into the "grooved outer ring", then wrapping cured to prevent the resin part from falling off. It has excellent characteristics of low particle noise generation, greater elasticity, vibration absorption, good buffer effect.

Process Improvement

Trouble on site



Ordinary Press Fitting Process
The outer ring tends to fall off when used under conditions such as high speeds, declinations, and high loads.

Improved process and greatly enhanced performance

MISUMI original embedded "Grooving" cam follower machining technology
Improved machining process solved the problem of the outer ring falling off under the conditions of high speed, heavy load, and eccentric load.

*Patent No.: ZL 2020 2 1742764.5

Walking Testing Equipment

The performance is significantly improved compared with the existing MISUMI equivalent products as a result of Multi-angle driving simulation.

*Test by MISUMI self-developed testing equipment

Test Method *Patented

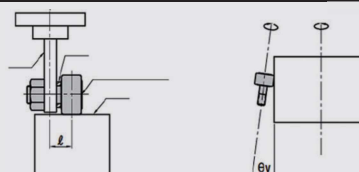

!
Please try to make
the inclination of
the resin cam
follower zero.

* Generic products on the market are similar products randomly purchased by our company from online or offline markets

* The test data are obtained through testing by our company, which are for reference only



Economy series Cam Followers Miniature Stainless Steel Standard Steel Type

- Miniature specification: the hardness of the shaft rod improved, not easy for the shaft rod to break
- Launched new stainless steel products



Product Specifications

- The cam follower is a bearing with needle shaped rollers installed in the thick walled outer ring and rod end, which features small friction coefficient and excellent rotation, and is suitable for use under high load conditions.
- The designed radial clearance of the cam follower is smaller than that of the general needle roller bearing, which can effectively reduce the impact load and obtain a stable long life, and is most suitable for the shaft bearing of the transmission guide rail.

	Standard	Small	Miniature
Appearance	 90mm MAX	 19mm MAX	 4.5mm Min
O.D.	22~90mm	12~19mm	4.5~10mm

Miniature	Stainless Steel	Standard
		
With excellent corrosion resistance, stainless steel cam followers are suitable for liquid splashing environment and dust-free clean rooms.	Suitable for small fixtures with narrow mounting space, and can be used for positioning, conveying and other purposes	Built-in cage and sealing ring, and suitable for low and medium speed and high load-bearing applications

Product Features

The problem that the shaft rod of the miniature cam follower is easy to break		Stainless steel material salt spray test result (48H)	
Generic products on the market*	MISUMI Economy series	Generic products on the market*	MISUMI Economy series
 Shaft rod is extremely easy to break.	 Shaft rod strength is greatly improved Shaft rod is not easy to break.	 Rust area exceeds 95%.	 Rust area is within 3%.

* Generic products on the market are similar products randomly purchased by our company from online or offline markets
* The test data are obtained through testing by our company, which are for reference only

Representative model: C-CFUR8-19

Save Up to **45%**
vs Standard Type

226

THB

Shipping
from
1 day



Volume Discount

Quantity	1~9	10~14	15~
Discount	Unit Price	15%	30%



Shipping days may differ by Quantity.

Quantity of volume discount above is for representative Part No. It may differ by the Part.

C-CFUR (With Seal)

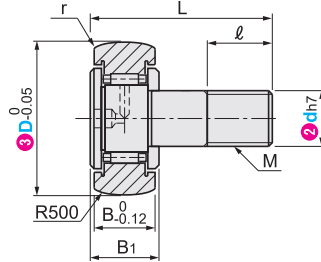

C-CFU (No Seal)

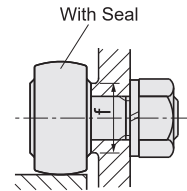
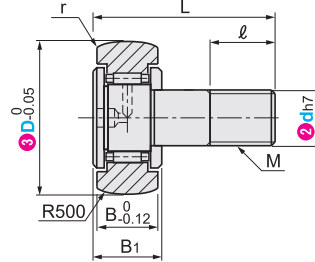

Material : SUJ2
Accessories: 1 Hexagonal Nut (S45C: Ferroferric Oxide Protective Film)

Grease replenishing hole is machined on the head only.
Operating environment temperature is below 80°C (Reference)

Part Number			3 Roller O.D. D	M × Thread Pitch	Roller Width B	B1	L	ℓ	r	f	Basic Rated Load			
1Type	2d Tolerance h7										Normal · Low Particle		Heavy Load	
											C (Dynamic) kN	Cor (Static) kN	C (Dynamic) kN	Cor (Static) kN
C-CFU (No Seal)	5	0	13	5×0.8	9	10	23	7.5	0.15	9.7	2.51	2.22	4.5	5.3
	6	-0.012	16	6×1.0	11	12.2	28	8		11	3.15	3.3	4.9	6.5
	8	0	19	8×1.25			32	10		13	3.5	3.9	5.4	7.9
	10	-0.015	22	10×1.0	12	13.2	36	12	0.3	15	4.5	5.2	6.2	9.1
		26												
C-CFUR (With Seal)	12	0	30	12×1.5	14	15.2	40	13	0.6	20	6.8	8.4	9.5	14.6
			32											
	16	-0.018	35	16×1.5	18	19.6	52	17		24	9.8	14.1	12.8	23
	18		40	18×1.5	20	21.6	58	19		26	10.9	15.5	14.8	26.5
	20	0 -0.021	52	20×1.5	24	25.6	66	21	1	36	16.7	29	22.6	48

3 D	Maximum Allowable Load (kN)		Rail Load Capacity (kN)		Rotational Speed Limit (rpm)			Weight (g)
	Normal · Low Particle	Heavy Load	Normal · Low Particle	Heavy Load	Normal · Low Particle		Heavy Load	Normal · Low Particle
					With Seal	No Seal	With Seal	
13	1.14	1.64	0.42	0.8	16240	23200	15000	10.5
16	1.69	2.11	0.86	1.08	14000	14000	3800	18.5
19	3.78	4.73	1.1	1.37	11000	11000	3100	28.5
22	4.65	5.81	1.34	1.67	8000	8000	2600	45
26			1.83	2.06				60
30	7.5	9.37	1.96	2.62	5500	5500	2100	95
32			2.19	2.86				105
35	13.84	17.3	2.51	3.2	3600	3600	1600	170
40	20.88	26.1	2.98	3.85	2900	2900	1400	250
52	25.68	32.1	6.58	7.65	2400	2400	2300	460

Ordering Example

Please order after selecting part number and parameters according to the selection steps 1 to 3.

Part Number (1Type · 2d) - 3D
C-CFUR8 - 19



By Type

Search on MISUMI official website

C-CFU

By Keyword

Step 1 Search on MISUMI official website

cam follower

Step 2 Select MISUMI economy series brand

☐ MISUMI ☒ MISUMI economy



MISUMI contact

Tel: 038-959200 or 1382
Email: cs@misumi.co.th

MISUMI WEB "Chat"



Install MISUMI APP



Representative model: C-CFFR6-16



Save Up to **31%**
vs Standard Type

225

THB

Shipping
from
1 day

Volume Discount

Quantity	1~9	10~14	15~
Discount	Unit Price	15%	30%



Shipping days may differ by Quantity.

Quantity of volume discount above is for representative Part No. It may differ by the Part.

C-CFFR (With Seal)

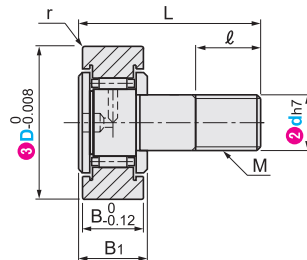

C-CFR (No Seal)

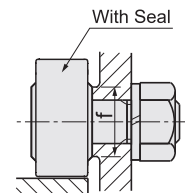
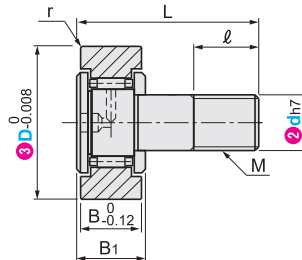

Grease replenishing hole is machined on the head only.

Operating environment temperature is below 80°C (Reference)

Material : SUJ2

Accessories: 1 Hexagonal Nut

(S45C: Ferroferric Oxide Protective Film)

Part Number		3 Roller O.D. D	M × Thread Pitch	Roller Width B	B1 (max.)	L	l	r (min.)	f	Basic Rated Load		Maximum Allowable Load (kN)	Rail Load Capacity (kN)	Rotational Speed Limit (rpm)		Weight (g)
1 Type	2 Tolerance h7									C (Dynamic) kN	Cor (Static) kN			With Seal	No Seal	
C-CFR (No Seal)	5 0 -0.012	13	5×0.8	9	10	23	7.5	0.15	9.7	2.51	2.22	1.14	0.42	16240	23200	10.5
	6	16	6×1.0	11	12.2	28	8		11	3.15	3.3	1.69	0.86	14000	14000	18.5
	8	19	8×1.25	12	13.2	36	12	0.3	13	3.5	3.9	3.78	1.1	11000	11000	28.5
	10 0 -0.015	22 26	10×1.0	14	15.2	40	13		15	4.5	5.2	4.65	1.34 1.65	8000	8000	45 60
C-CFFR (With Seal)	12 0 -0.018	30 32	12×1.5	14	15.2	40	13	0.6	20	6.8	8.4	9.37	1.96 2.19	5500	5500	95 105
	16	35	16×1.5	18	19.6	52	17		24	9.8	14.1	13.84	2.51	3600	3600	170
	18	40	18×1.5	20	21.6	58	19	1	26	10.9	15.5	20.88	2.98	2900	2900	250
	20 0 -0.021	52	20×1.5	24	25.6	66	21		36	16.7	29	25.68	6.58	2400	2400	460

kgf=N×0.101972

Ordering
Example

Please order after selecting part number and parameters according to the selection steps 1 to 3.

Part Number (1 Type · 2 d) - 3 D
C-CFFR6 - 16

How to search
on website



By
Type

Search on MISUMI official website

C-CFR



By
Keyword

Step 1 Search on MISUMI official website

cam follower



Step 2 Select MISUMI economy series brand

☐ MISUMI ☒ MISUMI economy



MISUMI contact

Tel: 038-959200 or 1382
Email: cs@misumi.co.th

MISUMI WEB "Chat"



Install MISUMI APP



8
Flat Belts / Rollers /
Cam Followers

Flat Belt
Pulleys
P.699

Flat Belt
P.705

Urethane
Molded Rollers
P.711

Ball Rollers
P.717

Cam
Followers
P.725

Roller
Followers
P.735

Silicon Bearings
Threaded Bearings
P.737

Representative model: C-CFUA8-19

Save Up to **50%**
vs Standard Type

224

THB

Shipping
from
1 day

Volume Discount

Quantity	1~9	10~14	15~
Discount	Unit Price	15%	30%



Shipping days may differ by Quantity.

Quantity of volume discount above is for representative Part No. It may differ by the Part.

Type	Seal	Material	Accessories
Standard	Heavy Load		
C-CUA	C-CUAG	No Seal	1 Hex Nut (S45C)
C-CFUA	C-CFUAG	With Seal	Ferroferric Oxide Protective Film)

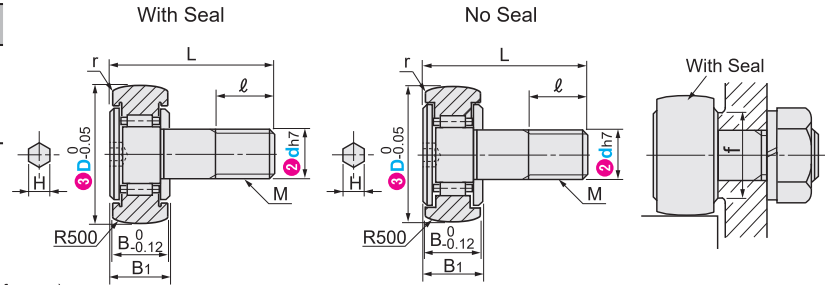

Grease replenishing hole is not provided.

Operating environment temperature is below 80°C (Reference)

Part Number		3 Roller O.D. D	M × Thread Pitch	Roller Width B	B ₁	L	ℓ	r	f	Basic Rated Load				
1 Type	2 d Tolerance h7									Normal		Heavy Load		
										C (Dynamic) kN	Cor (Static) kN	Cr (Dynamic) kN	Cor (Static) kN	
Standard C-CUA (No Seal) C-CFUA (With Seal) Heavy Load C-CUAG (No Seal) C-CFUAG (With Seal)	3	0 -0.01	10	3×0.5	7	8	17	5	0.3	6.8	1.18	0.94	2.5	2.61
	4	0 -0.012	12	4×0.7	8	9	20	6		8.6	1.65	1.64	3.5	3.8
	5		13	5×0.8	9	10	23	7.5		9.7	2.51	2.22	4.5	5.3
	6		16	6×1.0	11	12.2	28	8	11	3.15	3.3	4.9	6.5	
	8	19	8×1.25	32			10	13	3.5	3.9	5.4	7.9		
	10	0 -0.015	22	10×1.0	12	13.2	36	12	0.3	15	4.5	5.2	6.2	9.1
	12	26	5.1							6.2	7.3	11.3		
	16	0 -0.018	30	12×1.5	14	15.2	40	13		0.6	20	6.8	8.4	9.5
	18		32						7.1		8.9	10	15.8	
	20		35						16×1.5		18	19.6	52	17
	24	0 -0.021	40	18×1.5	20	21.6	58	19	1	26	10.9	15.5	14.8	26.5
	28		52	20×1.5	24	25.6	66	21		36	16.7	29	22.6	48
	32		30×1.5	35	37	100	32	1.1		44	26	48	34	75
	36								28	53	36.5	85		
	40								39	77	49.5	117		
	44								41	83	52	123		
	48		50											
	52		54											
56		58												
60		62												
64		66												
68		70												
72		74												
76		78												
80		82												
84		86												
88		90												
92		92												
96		94												
100		96												
104		98												
108		100												
112		102												
116		104												
120		106												
124		108												
128		110												
132		112												
136		114												
140		116												
144		118												
148		120												
152		122												
156		124												
160		126												
164		128												
168		130												
172		132												
176		134												
180		136												
184		138												
188		140												
192		142												
196		144												
200		146												
204		148												
208		150												
212		152												
216		154												
220		156												
224		158												
228		160												
232		162												
236		164												
240		166												
244		168												
248		170												
252		172												
256		174												
260		176												
264		178												
268		180												
272		182												
276		184												
280		186												
284		188												
288		190												
292		192												
296		194												
300		196												
304		198												
308		200												
312		202												
316		204												
320		206												
324		208												
328		210												
332		212												
336		214												
340		216												
344		218												
348		220												
352		222												
356		224												
360		226												
364		228												
368		230												
372		232												
376		234												
380		236												
384		238												
388		240												
392		242												
396		244												
400		246												
404		248												
408		250												
412		252												
416		254												
420		256												
424		258												
428		260												
432		262												
436		264												
440		266												
444		268												
448		270												
452		272												
456		274												
460		276												
464		278												
468		280												
472		282												
476		284												
480		286												
484		288												
488		290												
492		292												
496		294												
500		296												
504		298												
508		300												
512		302												
516		304												
520		306												
524		308												
528		310												
532		312												
536		314												
540		316												
544		318												
548		320												
552		322												
556		324												
560		326												
564		328												
568		330												
572		332												
576		334												
580		336												
584		338												
588		340												
592		342												
596		344												
600		346												
604		348												
608		350												
612		352												
616		354												
620		356												
624		358												
628		360												
632		362												
636		364												
640		366												
644		368												
648		370												
652		372												
656		374												
660		376												
664		378												
668		380												
672		382											</	

Please refer to MISUMI official website for the models available for sale.

3 D	Maximum Allowable Load (kN)		Rail Load Capacity (kN)		Rotational Speed Limit (rpm)			Weight (g)
	Normal	Heavy Load	Normal	Heavy Load	With Seal	No Seal	Heavy Load	
10	0.29	0.5	0.3	0.56	26320	37600	25000	4.5
12	0.62	0.92	0.38	0.72	20720	29600	19000	7.5
13	1.14	1.64	0.42	0.8	16240	23200	15000	10.5
16	1.69	2.11	0.86	1.08	14000	14000	3800	18.5
19	3.78	4.73	1.1	1.37	11000	11000	3100	28.5
22	4.65	5.81	1.34	1.67	8000	8000	2600	45
26			1.83	2.06				60
30			1.96	2.62				95
32	7.5	9.37	2.19	2.86	5500	5500	2100	105
35	13.84	17.3	2.51	3.2	3600	3600	1600	170
40	20.88	26.1	2.98	3.85	2900	2900	1400	250
52	25.68	32.1	6.58	7.65	2400	2400	1300	460
62	61	98	8.4	9.66	1900	1900	1100	770
72	67	111	10.32	11.83				787
80	99	153	11.92	13.62				1608
85	104	162	12.88	14.52	1300	1300	850	1678
90	106	169	13.84	15.42				1975

kgf=N×0.101972

Ordering
Example

Please order after selecting part number and parameters according to the selection steps 1 to 3.

Part Number (1)Type · (2)d - (3)D
C-CFUA8 - 19



By Type
Search on MISUMI official website
C-CUA

By Keyword
Step 1 Search on MISUMI official website
cam follower

Step 2 Select MISUMI economy series brand
MiSUMI economy

MISUMI contact

Tel: 038-959200 or 1382
Email: cs@misumi.co.th

MISUMI WEB "Chat"



Install MISUMI APP



Representative model: C-CFFA6-16

Save Up to **42%**
vs Standard Type

Shipping
from
1 day



225

THB

Volume Discount

Quantity	1~9	10~14	15~
Discount	Unit Price	15%	30%



Shipping days may differ by Quantity.

Quantity of volume discount above is for representative Part No. It may differ by the Part.

Type	Seal	Material	Accessories
Standard	Heavy Load		
C-CFA	C-CFAG	No Seal	1 Hex Nut (S45C-Ferroferric Oxide Protective Film)
C-CFFA	C-CFFAG	With Seal	

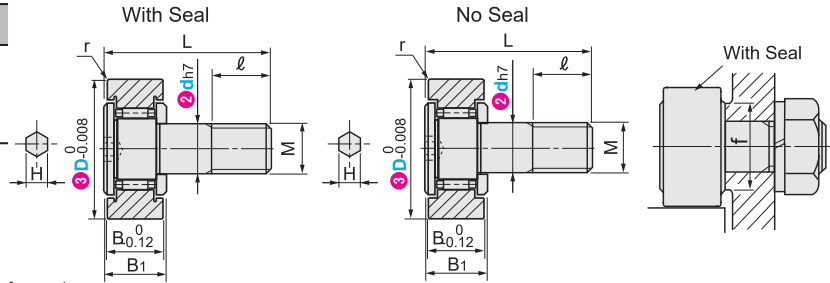

Grease replenishing hole is not provided.

Operating environment temperature is below 80°C (Reference)

Part Number		3 Roller O.D. D	M × Thread Pitch	Roller Width B	B ₁	L	ℓ	r	f	Basic Rated Load				
1Type	2d Tolerance h7									Normal		Heavy Load		
										C (Dynamic) kN	Cor (Static) kN	C (Dynamic) kN	Cor (Static) kN	
Standard C-CFA (No Seal) C-CFFA (With Seal) Heavy Load C-CFAG (No Seal) C-CFFAG (With Seal)	3	0 -0.01	10	3×0.5	7	8	17	5	0.3	6.8	1.18	0.94	2.5	2.61
	4	0	12	4×0.7	8	9	20	6		8.6	1.65	1.64	3.5	3.8
	5	0	13	5×0.8	9	10	23	7.5		9.7	2.51	2.22	4.5	5.3
	6	-0.012	16	6×1.0	11	12.2	28	8		11	3.15	3.3	4.9	6.5
	8	0	19	8×1.25	11	12.2	32	10	0.15	13	3.5	3.9	5.4	7.9
	10	-0.015	22	10×1.0	12	13.2	36	12		15	4.5	5.2	6.2	9.1
			26	12×1.5	14	15.2	40	13		17	6.8	8.4	9.5	14.6
	12	0	30	12×1.5	14	15.2	40	13		20	7.1	8.9	10	15.8
	16	-0.018	35	16×1.5	18	19.6	52	17	0.6	24	9.8	14.1	12.8	23
	18	0	40	18×1.5	20	21.6	58	19		26	10.9	15.5	14.8	26.5
	20	-0.021	52	20×1.5	24	25.6	66	21		36	16.7	29	22.6	48
	24	0	62	24×1.5	29	30.6	80	25		44	26	48	34	75
	30	-0.021	72	30×1.5	35	37	100	32	1.1	53	28	53	36.5	85
			80							49.5	117			
			85							51	123			
		90						52		129				

Please refer to MISUMI official website for the models available for sale.

D	Maximum Allowable Load (kN)		Rail Load Capacity (kN)		Rotational Speed Limit (rpm)			Weight (g)
	Normal	Heavy Load	Normal	Heavy Load	Normal		Heavy Load	Normal
					With Seal	No Seal	With Seal	
10	0.29	0.5	0.3	1.36	26320	37600	25000	4.5
12	0.62	0.92	0.38	1.79	20720	29600	19000	7.5
13	1.14	1.64	0.42	2.22	16240	23200	15000	10.5
16	1.69	2.11	0.86	3.4	14000	14000	3800	18.5
19	3.78	4.73	1.1	4.05	11000	11000	3100	28.5
22	4.65	5.81	1.34	5.15	8000	8000	2600	45
26			1.83	6.1				60
30	7.5	9.37	1.96	7.7	5500	5500	2100	95
32		9.37	2.19	8.2				105
35	13.84	17.3	2.51	11.9	3600	3600	1600	170
40	20.88	26.1	2.98	14.5	2900	2900	1400	250
52	25.68	32.1	6.58	23.3	2400	2400	1300	460
62	61	98	8.4	29.4	1900	1900	1100	770
72	67	111	10.32	34.62				787
80	99	153	11.92	38.72				1608
85	104	162	12.88	42.08	1300	1300	850	1678
90	106	169	13.84	45.24				1975

kgf=N×0.101972

Please order after selecting part number and parameters according to the selection steps 1 to 3.

Ordering Example: Part Number (1)Type · (2)d - (3)D
C-CFFA6 - 16

How to search on website

By Type: Search on MISUMI official website

By Keyword: Search on MISUMI official website

Step 1 Search on MISUMI official website

Step 2 Select MISUMI economy series brand

☐ MISUMI ☒ MISUMI economy

MISUMI contact

Tel: 038-959200 or 1382

Email: cs@misumi.co.th

MISUMI WEB "Chat"

MISUMI WEB Chat Now

Install MISUMI APP

MISUMI

8 Flat Belts / Rollers / Cam Followers

Flat Belt Pulleys P.699

Flat Belt P.705

Urethane Molded Rollers P.711

Ball Rollers P.717

Cam Followers P.725

Roller Followers P.735

Silicon Bearings Threaded Bearings P.737

Representative model: C-CFMS8-19

Flat, Hex Socket



Save Up to **30%**
vs Standard Type

496

THB

Shipping
from
1 day

Volume Discount

Quantity	1~3	4~5	6~
Discount	Unit Price	15%	30%



Shipping days may differ by Quantity.

Quantity of volume discount above is for representative Part No. It may differ by the Part.

Material	Accessories
Equivalent to SUS440	1 Hex Nut (SUS304)

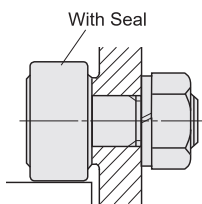
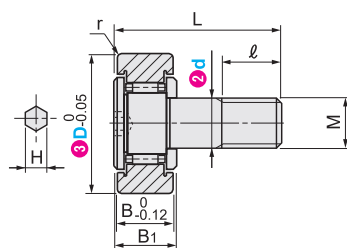

Part Number	1 Type	2 d	3 Roller O.D. D	M x Thread Pitch	Roller Width B	B1	L	l	H	Basic Rated Load Cr (Dynamic) N	Cor (Static) N	Max. Static Allowable Load (N)	Rotational Speed Limit (rpm)
C-CFMS8	3	10	3	3x0.5	7	8	17	5	1.5	1000	780	360	17200
	4	12	4	4x0.7	8	9	20	6	2	1230	920	683	15300
	5	13	5	5x0.8	9	10	23	7.5	2.5	1890	1620	890	11000
	6	16	6	6x1.0	11	12	28	9	3	2580	1910	1100	9200
	8	19	8	8x1.25	11	12	32	11	4	2910	2440	1779	8600
	10	22	10	10x1.25	12	13	36	13	5	3875	3279	1862	6200
	12	26	12	12x1.5	14	15	40	14	6	4300	3535	2218	4800
	16	30	16	16x1.5	18	19.5	52	18	6	4630	3753	2534	4300
	18	32	18	18x1.5	20	21.5	58	20	6	4800	3981	2931	4100
	16	35	16	16x1.5	18	19.5	52	18	6	5100	5010	3416	3700
	18	40	18	18x1.5	20	21.5	58	20	6	5400	5210	3760	3500

kgf=Nx0.101972

Ordering Example

Please order after selecting part number and parameters according to the selection steps 1 to 4.

Part Number (1 Type · 2 d) - (3 D)
C-CFMS8 - 19

Representative model: C-CFMRS10-26

Crown, Hex Socket



Save Up to **30%**
vs Standard Type

642

THB

Shipping
from
1 day

Volume Discount

Quantity	1~3	4~5	6~
Discount	Unit Price	15%	30%



Shipping days may differ by Quantity.

Quantity of volume discount above is for representative Part No. It may differ by the Part.

Material	Accessories
Equivalent to SUS440	1 Hex Nut (SUS304)

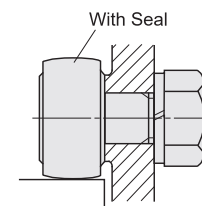
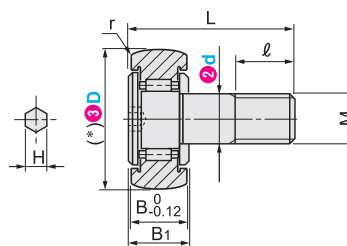

Part Number	1 Type	2 d	3 Roller O.D. D	M x Thread Pitch	Roller Width B	B1	L	l	H	Basic Rated Load Cr (Dynamic) N	Cor (Static) N	Max. Static Allowable Load (N)	Rotational Speed Limit (rpm)
C-CFMRS	3	10	3	3x0.5	7	8	17	5	1.5	1000	780	360	17200
	4	12	4	4x0.7	8	9	20	6	2	1230	920	683	15300
	5	13	5	5x0.8	9	10	23	7.5	2.5	1890	1620	890	11000
	6	16	6	6x1.0	11	12	28	9	3	2580	1910	1100	9200
	8	19	8	8x1.25	11	12	32	11	4	2910	2440	1779	8600
	10	22	10	10x1.25	12	13	36	13	5	3875	3279	1862	6200
	12	26	12	12x1.5	14	15	40	14	6	4300	3535	2218	4800
	16	30	16	16x1.5	18	19.5	52	18	6	4630	3753	2534	4300
	18	32	18	18x1.5	20	21.5	58	20	6	4800	3981	2931	4100
	16	35	16	16x1.5	18	19.5	52	18	6	5100	5010	3416	3700
	18	40	18	18x1.5	20	21.5	58	20	6	5400	5210	3760	3500

kgf=Nx0.101972

Ordering Example

Please order after selecting part number and parameters according to the selection steps 1 to 4.

Part Number (1 Type · 2 d) - (3 D)
C-CFMRS10 - 26

How to search on website



By Type Search on MISUMI official website

By Type

C-CFMS



By Keyword Step 1 Search on MISUMI official website

By Keyword

cam follower



Step 2 Select MISUMI economy series brand

MISUMI



MISUMI economy

MISUMI contact

Tel: 038-959200 or 1382
Email: cs@misumi.co.th

MISUMI WEB "Chat"

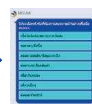

Install MISUMI APP



Representative model: C-CFS3-6

Save Up to **36%**
vs Standard Type

603

THB

Shipping
from
1 day



Volume Discount

Quantity	1~3	4~5	6~
Discount	Unit Price	15%	30%



Shipping days may differ by Quantity.

Quantity of volume discount above is for representative Part No. It may differ by the Part.

Type	Material	Accessories
C-CF	Equivalent to SUJ2 (Pillar Bolt Part: SCM415)	1 Hex Nut (S45C-Ferroferric Oxide Protective Film)
C-CFS	Equivalent to SUS440	1 Hex Nut (SUS304)

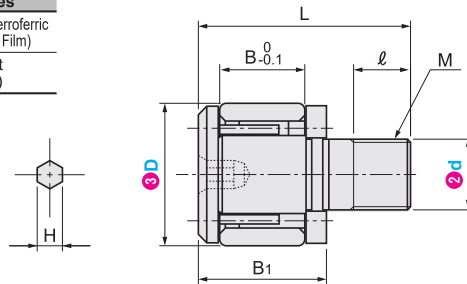

General-Purpose Model (Steel)

Part Number		Roller O.D. D	M × Thread Pitch	Roller Width B	B ₁	L	l	H	Basic Rated Load		Max. Static Allowable Load (N)	Rotational Speed Limit (rpm)	Max. Tightening Torque (N·cm)
Type	d								Cr (Dynamic) N	Cor (Static) N			
C-CF	2	4.5	2×0.4	2.5	4	8	2	0.9	188	132	118	1200	10.9
	2.5	5	2.5×0.45	3	4.5	9.5	2.5		254.2	207.7	176.7	1040	22.4
	3	6	3×0.5	4	5.5	11.5	3	1.3	390.6	378.2	325.5	910	40.2
	4	8	4×0.7	5	7	15	4	1.5	669.6	669.6	567.3	840	93.2
	5	10	5×0.8	6	8	18	5	2	973.4	1153.2	868	750	189.6
	6	12	6×1.0	7	9.5	21.5	6	2.5	1277.2	1339.2	1264.8	660	321.6

kgf=N×0.101972

General-Purpose Model (Stainless Steel)

Part Number		Roller O.D. D	M × Thread Pitch	Roller Width B	B ₁	L	l	H	Basic Rated Load		Max. Static Allowable Load (N)	Rotational Speed Limit (rpm)	Max. Tightening Torque (N·cm)
Type	d								Cr (Dynamic) N	Cor (Static) N			
C-CFS	2	4.5	2×0.4	2.5	4	8	2	0.9	168	113	101	1050	10.9
	2.5	5	2.5×0.45	3	4.5	9.5	2.5		217	176.7	176.7	970	22.4
	3	6	3×0.5	4	5.5	11.5	3	1.3	350.3	325.5	325.5	860	40.2
	4	8	4×0.7	5	7	15	4	1.5	567.3	567.3	567.3	750	93.2
	5	10	5×0.8	6	8	18	5	2	830.8	868	868	590	189.6
	6	12	6×1.0	7	9.5	21.5	6	2.5	1165.6	1264.8	1264.8	600	321.6

kgf=N×0.101972

Ordering Example

Please order after selecting part number and parameters according to the selection steps ① to ③.

Part Number (①Type · ②d) - ③D
C-CFS3 - 6



By Type
Search on MISUMI official website
C-CF

By Keyword
Step 1 Search on MISUMI official website
cam follower

Step 2 Select MISUMI economy series brand
☐ MISUMI ☒ MISUMI economy

MISUMI contact

Tel: 038-959200 or 1382
Email: cs@misumi.co.th

MISUMI WEB "Chat"



Install MISUMI APP



8

Fiat Belts / Rollers / Cam Followers

Fiat Belt Pulleys

P.699

Fiat Belt

P.705

Urethane Molded Rollers

P.711

Ball Rollers

P.717

Cam Followers

P.725

Roller Followers

P.735

Silicon Bearings Threaded Bearings

P.737

Representative model: C-CFFRUA6-16

Save Up to **30%**
vs Standard Type

712

THB

Shipping
from
1 day



Volume Discount

Quantity	1~3	4~5	6~
Discount	Unit Price	15%	30%

① Shipping days may differ by Quantity.

② Quantity of volume discount above is for representative Part No. It may differ by the Part.



Material	Accessories
Urethane Cam Follower	1 Hex Nut (S45C-Ferroferric Oxide Protective Film)
Shore A90 SUJ2 / SUS440	

Hexagon Socket on Head (d3~8)

Threaded Hexagon Socket on Head (d10~20)

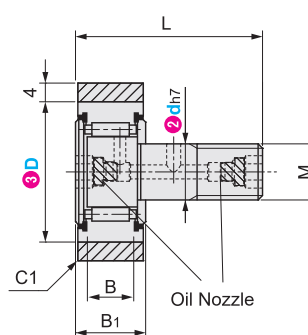
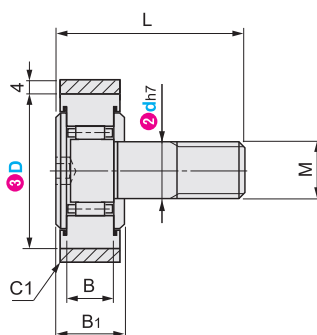

① Operating environment temperature is below 80°C (Reference) ② Grease replenishing hole is not provided for d16 or less.

Part Number	① Type	② dh7	③ Roller O.D. D Selection	M x Pitch	Roller Width B	B1	L	Allowable Load (N)	Allowable Rotational Speed (rpm)
C-CFFRUA		3	10	3×0.5	7	8	17	46	1560
		4	12	4×0.7	8	9	20	63	1520
		5	13	5×0.8	9	10	23	75	1500
		6	16	6×1.0	11	12	28	99	1300
		8	19	8×1.25			32	106	1180
		10	22	10×1.0	12	13	36	121	1060
			26					130	930
		12	30	12×1.5	14	15	40	162	830
			32					166	800
		16	35	16×1.5	18	19.5	52	222	740
		18	40	18×1.5	20	21.5	58	270	673
		20	52	20×1.5	24	25.5	66	312	524

① The allowable load is the value at speed = 10km/h.

② kgf=N×0.101972

Ordering
Example

Please order after selecting part number and parameters according to the selection steps ① to ③.

Part Number (① Type · ② dh7) - ③ D
C-CFFRUA6 - **16**

How to search
on website



By
Type

Search on MISUMI official website

C-CFFRUA

By
Keyword

Step 1 ▶ Search on MISUMI official website

urethane follower

Step 2 ▶ Select MISUMI economy series brand

☐ MISUMI



MISUMI
economy

MISUMI contact

Tel: 038-959200 or 1382
Email: cs@misumi.co.th

MISUMI WEB “Chat”



Install MISUMI APP



+ New Specs



Representative model: C-CFFRUCS8-19

Save Up to **30%**
vs Standard Type

681

THB

Shipping
from
1 day

Volume Discount

Quantity	1~3	4~5	6~
Discount	Unit Price	15%	30%



⚠ Shipping days may differ by Quantity.

⚠ Quantity of volume discount above is for representative Part No. It may differ by the Part.

Material	Accessories
Urethane Cam Follower	1 Hex Nut (S45C-Ferroferric Oxide Protective Film)
Nylon	SUJ2 / SUS440

Hex socket on head (d3-8)

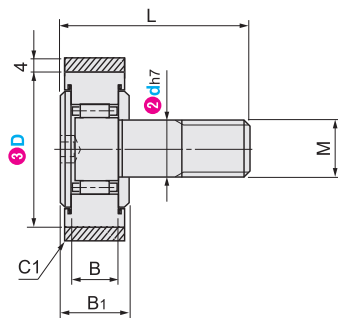

Hex Socket on Head Thread (d10-20)

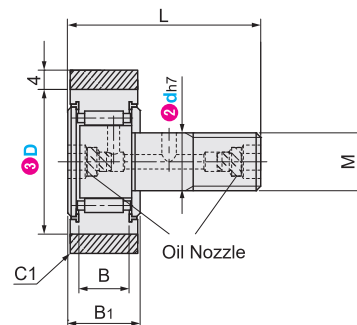

⚠ Operating environment temperature is below 80°C (Reference) ⚠ Grease replenishing hole is not provided for d16 or less.

Part Number	1 Type	2 dh7	3 Roller O.D. D Selection	M x Pitch	Roller Width B	B1	L	Allowable Load (N)	Allowable Rotational Speed (rpm)
C-CFFRUCS		3	10	3×0.5	7	8	17	238	3200
		4	12	4×0.7	8	9	20	350	2760
		5	13	5×0.8	9	10	23	406	2510
		6	16	6×1.0	11	12	28	460	2230
		8	19	8×1.25			32	504	1960
		10	22	10×1.0	12	13	36	555	1760
			26					592	1560
		12	30	12×1.5	14	15	40	728	1390
			32					779	1320
		16	35	16×1.5	18	19.5	52	840	1230
		18	40	18×1.5	20	21.5	58	886	1080
		20	52	20×1.5	24	25.5	66	1044	830

⚠ The allowable load is the value at speed = 10km/h.

⚠ kgf=N×0.101972

Ordering Example

Please order after selecting part number and parameters according to the selection steps 1 to 3.

Part Number (1 Type · 2 dh7) - 3 D
C-CFFRUCS8 - 19

How to search on website



By Type

Search on MISUMI official website

C-CFFRUCS

By Keyword

Step 1 ▶ Search on MISUMI official website

nylon follower

Step 2 ▶ Select MISUMI economy series brand

☐ MISUMI ☒

MISUMI economy

MISUMI contact

Tel: 038-959200 or 1382
Email: cs@misumi.co.th

MISUMI WEB "Chat"



Install MISUMI APP



8
Flat Belts / Rollers / Cam Followers

Flat Belt Pulleys

P.699

Flat Belt

P.705

Urethane Molded Rollers

P.711

Ball Rollers

P.717

Cam Followers

P.725

Roller Followers

P.735

Silicon Bearings Threaded Bearings

P.737

Representative model: C-NASTZ12

Save Up to **62%**
vs Standard Type

238

THB

Shipping
from
1 day



Volume Discount

Quantity	1~9	10~14	15~
Discount	Unit Price	15%	30%



Shipping days may differ by Quantity.

Quantity of volume discount above is for representative Part No. It may differ by the Part.

With Seal

C-NASTZ (Crowned Type)

C-NASTFZ (Cylindrical Type)

No Seal

C-NASTR (Crowned Type)

C-NASTF (Cylindrical Type)

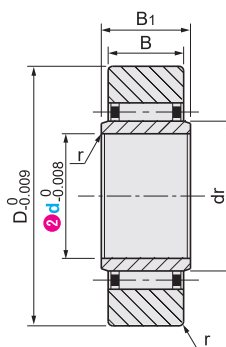
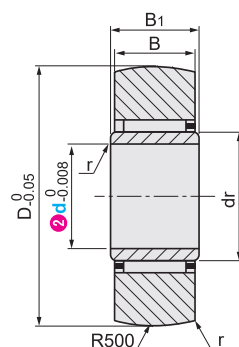
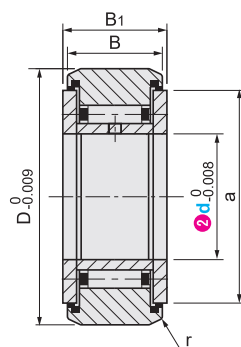
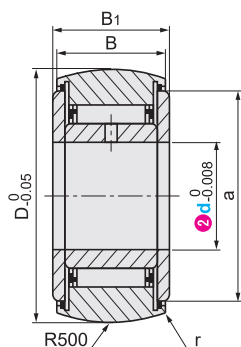

Material: Equivalent to SUJ2

■ With Seal

Part Number		Roller O.D. D	a	Roller Width B	B ₁	r	Basic Rated Load		Rail Load Capacity (kN)		Rotational Speed Limit (rpm)	mass (g)
① Type	② Roller I.D. d						C (Dynamic) kN	Cor (Static) kN	Crowned	Cylindrical		
C-NASTFZ (Cylindrical Type)	6	19	15	13.8	14	0.3	1.21	1.45	1.1	2.82	12000	24.5
	8	24	18				1.3	1.7	1.49	3.61	9900	39
	10	30	23				2.34	2.38	1.96	5.49	9400	65
	12	32	25	15.8	16		2.52	2.68	2.19	5.88	8100	75
	15	35	30				2.9	3.4		6.43	6300	83
	17	40	33				4.27	5.24	-	9.44	5600	135
C-NASTZ (Crowned Type)	20	47	37	19.8	20		4.5	5.7		11.04	4900	195

kgf=N×0.101972 Models C-NASTZ15, C-NASTZ17 and C-NASTZ20 are currently not available for sale.

■ No Seal

Part Number		Roller O.D. D	dr	Roller Width B	B ₁	r	Basic Rated Load		Rail Load Capacity (kN)		Rotational Speed Limit (rpm)	mass (g)
① Type	② Roller I.D. d						C (Dynamic) kN	Cor (Static) kN	Crowned	Cylindrical		
C-NASTF (Cylindrical Type)	6	19	10	9.8	10	0.3	3.75	4.57	1.1	2.82	10000	17.8
	8	24	12				4.2	5.4	1.49	3.22	8000	28
	10	30	14				8.4	9.2	1.96	4.47	5500	50
	12	32	16	11.8	12		9	10.1	2.19	4.78	4500	58
	15	35	20				9.1	10.7	2.51		3300	62
	17	40	22				14.2	17.7	2.98	-	2800	110
C-NASTR (Crowned Type)	20	47	25	15.8	16		16.2	21.5	3.69		2400	155

Please fully apply grease when using. Models C-NASTF15, C-NASTF17 and C-NASTF20 are currently not available for sale. kgf=N×0.101972

Ordering Example

Please order after selecting part number and parameters according to the selection steps ① to ②.

Part Number (① Type · ② Roller I.D. d)

C-NASTZ12

How to search on website



By Type

Search on MISUMI official website

C-NASTFZ

By Keyword

Step 1 Search on MISUMI official website

roller follower

Step 2 Select MISUMI economy series brand

☐ MISUMI



MISUMI economy

MISUMI contact

Tel: 038-959200 or 1382
Email: cs@misumi.co.th

MISUMI WEB "Chat"



Install MISUMI APP



Representative model: C-NARTU12



Save Up to **60%**
vs Standard Type

247

THB

Shipping
from
1 day

Volume Discount

Quantity	1~9	10~14	15~
Discount	Unit Price	15%	30%



Shipping days may differ by Quantity.

Quantity of volume discount above is for representative Part No. It may differ by the Part.

With Seal

C-NARTU (Crown Type)

C-NARTV (Heavy Load Crowned Type)

No Seal

C-NARTR (Crown Type)

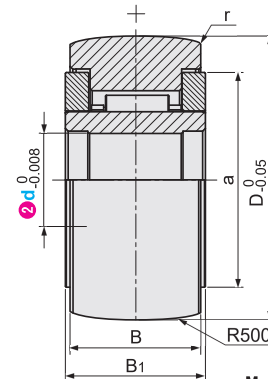
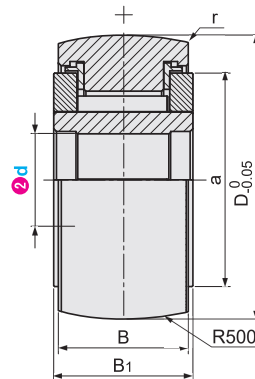
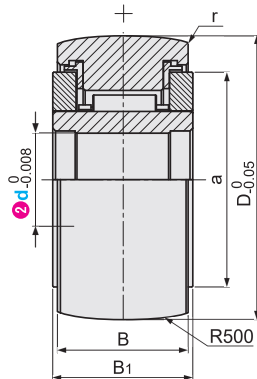

Material: Equivalent to SUJ2

■ With Seal

Part Number		Roller O.D. D	a	Roller Width B	B ₁	r	Basic Rated Load				Rail Load Capacity (kN)	Rotational Speed Limit (rpm)		mass (g)					
❶Type	❷Roller I.D. d						C (Dynamic) kN		Cor (Static) kN			Crowned	Heavy Load Crowned	Crowned	Heavy Load Crowned	Crowned	Heavy Load Crowned	Crowned	Heavy Load Crowned
							Crowned	Heavy Load Crowned	Crowned	Heavy Load Crowned									
C-NARTU (Crown Type)	5	16	12.5	11	12	0.15	3.15	4.9	3.3	6.5	0.86	14000	3800	14.5	15.1				
	6	19	15				3.5	5.4	3.9	7.9	1.1	11000	3100	20.5	21.5				
	8	24	19	14	15	0.3	5.5	7.8	6.4	11.4	1.49	7500	2500	41.5	42.5				
C-NARTV (Heavy Load Crowned Type)	10	30	23				6.8	9.5	8.4	14.6	1.96	5500	2100	64.5	66.5				
	12	32	25				6.9	9.7	8.8	15.4	2.19	4500	1800	71	73				
	15	35	27.6	18	19	9.8	12.8	14.1	23	2.51	3600	1600	102	106					
	17	40	31.5	20	21	1	10.9	14.8	15.5	26.5	2.98	2900	1400	149	155				
	20	47	36.5	24	25		15.5	20.6	25.5	42	5.72	3000	2400	250	255				

kgf=N×0.101972

■ No Seal

Part Number		Roller O.D. D	a	Roller Width B	B ₁	r	Basic Rated Load		Rail Load Capacity (kN)	Rotational Speed Limit (rpm)	mass (g)
❶Type	❷Roller I.D. d						C (Dynamic) kN	Cor (Static) kN			
C-NARTR	5	16	12.5	11	12	0.15	3.15	3.3	0.86	14000	15
	6	19	15				3.5	3.9	1.1	11000	21
	8	24	19	14	15	0.3	5.5	6.4	1.49	7500	42
	10	30	23				6.8	8.4	1.96	5500	66
	12	32	25				6.9	8.8	2.19	4500	73

kgf=N×0.101972

Ordering Example

Please order after selecting part number and parameters according to the selection steps 1 to 2.

Part Number (1 Type · 2 Roller I.D. d)

C-NARTV12

How to search on website



By Type

Search on MISUMI official website

C-NARTU

By Keyword

Step 1 Search on MISUMI official website

roller follower

Step 2 Select MISUMI economy series brand

☐ MISUMI ☒ MISUMI economy

MISUMI contact

Tel: 038-959200 or 1382
Email: cs@misumi.co.th

MISUMI WEB "Chat"



Install MISUMI APP



8
Flat Belts / Rollers /
Cam Followers

Flat Belt
Pulleys
P.699

Flat Belt
P.705

Urethane
Molded Rollers
P.711

Ball Rollers
P.717

Cam
Followers
P.725

Roller
Followers
P.735

Silicon Bearings
Threaded Bearings
P.737

Economy series Silicon Bearings

New
Products

Firmly urethane molded

Smooth rotation

Superior quality

vs Standard Type
Saving
up to

64 %

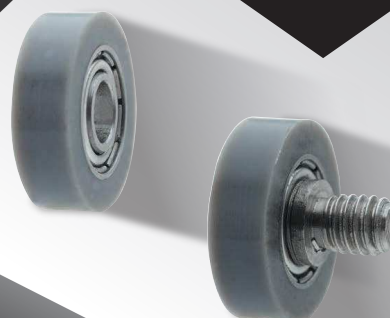

Product Features

Item	MISUMI standard product	MISUMI Economy series
Requirements	High precision (Radial runout suppression is highly required)	Medium precision Without Radial runout requirements
Bearing Inner Hole Precision	Class P0	+0.005 -0.015
Used Bearing	Japanese Brands (Radial Runout 3~13μm)*	Customized Chinese Bearings (Radial runout 8~23μm)*

* Radial runout is a reference value, not guaranteed value.

* MISUMI does not guarantee the bearing brands.

To solve your troubles in urethane molded bearing purchase

MISUMI Economy series	Based on effective quality management, the gluing is uniform and the adhesive layer is firm.	The precise shielded bearing is used to ensure effective grease residue.	Based on effective quality management, effective glue injection is ensured and there is no glue leakage.
------------------------------	---	---	---

Generic products on the market



Unglued



Lack of oil



Glue leakage

* Generic products on the market are similar products randomly purchased by our company from online or offline markets

Shield with glue residue

Example of Use

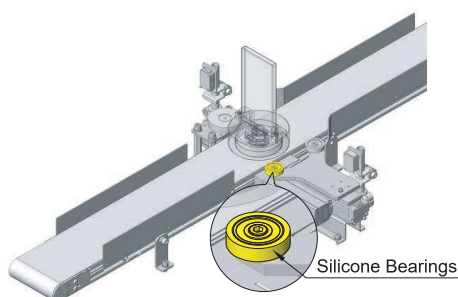

The urethane molded bearing is used for attachment to the drive roller for positioning. If there are special requirements such as temperature or weather resistance, silicone bearings can be selected to better suit the operation of the mechanism.

8

Flat Belts / Rollers /
Cam Followers

Flat Belt
Pulleys

P.699

Flat Belt

P.705

Urethane
Molded Rollers

P.711

Ball Rollers

P.717

Cam
Followers

P.725

Roller
Followers

P.735

Silicon Bearings
Threaded Bearings

P.737

New Products



Representative model: E-SUMBB4-13

Save Up to **74%**
vs Standard Type

76

THB

Shipping
from
1 day

Volume Discount

Quantity	10~29	30~49	50~
Discount	Unit Price	15%	30%



Shipping days may differ by Quantity.

Quantity of volume discount above is for representative Part No. It may differ by the Part.

Material	Hardness	Color	Bearing
Silicon	Shore A70	Light grey	SUJ2

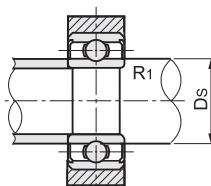
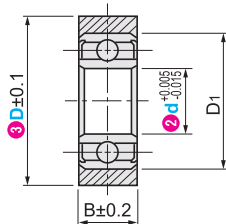

Part Number		d Tolerance	3D	Allowable Load N (kgf)	B	D1	Mounting Dimensions			Bearing
1Type	2d						Ds (min.)	(max.)	R1 (max.)	
E-SUMBB	4	+0.005 -0.015	13	44(4.5)	4	9	5	5.2	0.1	684ZZ
			16	59(6)	13	5.6	6.2	0.2	624ZZ	
	16		6.6			6.9	685RS			
	5		20	78(8)	5	16	7	7.6	0.3	625RS
			20			15	7.6	7.8	0.2	696RS
	6		28	157(16)	6	19	8	9.5	0.3	626RS

Ordering Example

Please order after selecting part number and parameters according to the selection steps 1 to 4.

Part Number (1)Type · (2)d - (3)D
E-SUMBB4 - 13

Depending on the model, the edge of the molded layer may be curved.

MISUMI does not guarantee the bearing brands.

New Products



Representative model: E-SUMBH4-13

Save Up to **79%**
vs Standard Type

95

THB

Shipping
from
1 day

Volume Discount

Quantity	10~29	30~49	50~
Discount	Unit Price	15%	30%



Shipping days may differ by Quantity.

Quantity of volume discount above is for representative Part No. It may differ by the Part.

Material	Hardness	Color	Bearing	Shaft Material
Silicon	Shore A70	Light grey	SUJ2	Stainless Steel

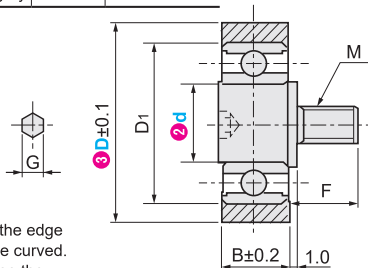

Part Number	Type	d	D	Thread Nominal Diameter	F	Allowable Load N (kgf)	B	D1	G	Bearing
E-SUMBH	4		13			44(4.5)	4	9	2	684ZZ
			16							624ZZ
	5		16	M4	5	59(6)		13		685RS
			20				5	16	2.5	625RS
			20			78(8)		15		696RS
	6		28	M6	8	157(16)	6	19	3	626RS

Ordering Example

Please order after selecting part number and parameters according to the selection steps 1 to 4.

Part Number (1)Type · (2)d - (3)D
E-SUMBH4 - 13

Depending on the model, the edge of the molded layer may be curved.

MISUMI does not guarantee the bearing brands.

How to search on website



By Type

Search on MISUMI official website

E-SUMBB

By Keyword

Step 1 Search on MISUMI official website

silicon bearing

Step 2 Select MISUMI economy series brand

☐ MISUMI



MISUMI contact

Tel: 038-959200 or 1382
Email: cs@misumi.co.th

MISUMI WEB "Chat"

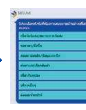

Install MISUMI APP



Economy series Bearings With Screw Rod

New
Products

Smooth rotation

Solid bolt

Not easy to rust

vs Standard Type
Saving
up to

79%



Product Features

Item	MISUMI standard product	MISUMI Economy series
Requirements	High precision (Radial runout suppression is highly required)	Medium precision Without Radial runout requirements
Bearing Inner Hole Precision	Class P0	+0.005 -0.015
Used Bearing	Japanese Brands (Radial Runout 3~13μm)*	Customized Chinese Bearings (Radial runout 8~23μm)*

* Radial runout is a reference value, not guaranteed value.

Third-party professional testing

●Riveting force test

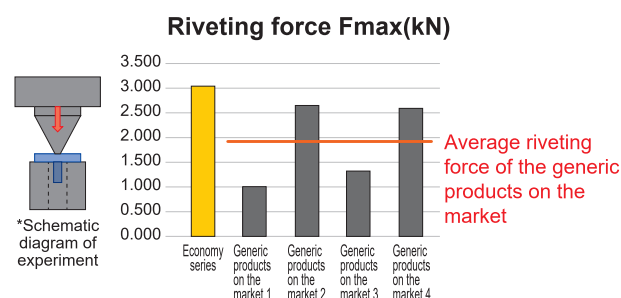

The riveting force of Economy series products is **37.8%** higher than the average value of the generic products on the market!

●Salt spray test (Stainless steel products)

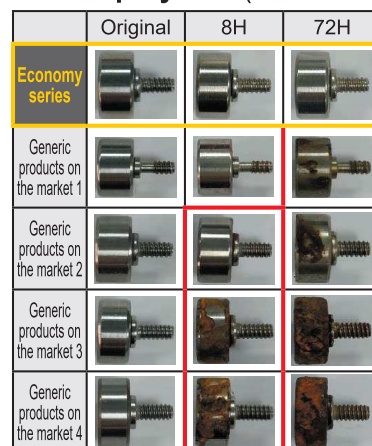

Economy series products are still bright after 72H salt spray test, showing excellent quality.

Anti-Rust
Capability
MISUMI
Economy
series

wins!

8H 72H
Rust spots appear Serious rust is formed

* Generic products on the market are similar products randomly purchased by our company from online or offline markets

Precautions

- ①MISUMI does not guarantee the bearing brands.
- ②The head of the threaded part may protrude beyond the bearing end face and the range of the protruding length cannot be guaranteed, so please pay attention to possible interference.
- ③The threaded part has incomplete threads, so please note this during installation.
- ④If rust protection is required, please select overall stainless steel products.

8

Flat Belts / Rollers /
Cam Followers

Flat Belt
Pulleys

P.699

Flat Belt

P.705

Urethane
Molded Rollers

P.711

Ball Rollers

P.717

Cam
Followers

P.725

Roller
Followers

P.735

Silicon Bearings
Threaded Bearings

P.737

New
Products



Representative model: E-NTSBG16-5

Save Up to **63%**
vs Standard Type

56

THB

Shipping
from
1 day

Volume Discount

Quantity	10~29	30~49	50~
Discount	Unit Price	15%	30%



Shipping days may differ by Quantity.

Quantity of volume discount above is for representative Part No. It may differ by the Part.

Type		Material	
Standard	Long	Bearing	Shaft
E-NTBG	E-NTBGT	Steel	Stainless Steel
E-NTSBG	E-NTSBGT	Stainless Steel	Stainless Steel

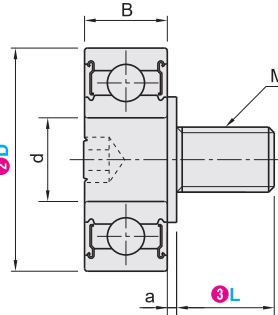

The head of the threaded part may protrude beyond the bearing end face.

Part Number		3 L		B	d	a	G	M (Coarse Thread)	Bearing
1 Type	2 D	Standard	Long						
Standard	7	4	6	3	3	1	1.5	M3	W683ZZ
	8	5	*8	2.5	5		2.5		675ZZ
	9	5	8	4	4		2	M4	W684A×50ZZ
	13	5	8	5	4		3.5		624ZZ
Long	16	5	8	5	5	2.5	3	M6	625ZZ
	19	8	12	6	6		4		626ZZ
	22	8	*12	7	8		5		608ZZ
	26	8	*12	8	10		5		6000ZZ
	30	8	*12	9	10		5		6200ZZ

Dimensions with * in the table above are not available for the long type.

Ordering
Example

Please order after selecting part number and parameters according to the selection steps 1 to 3.

Part Number (1 Type · 2 D) - 3 L
E-NTSBG16 - 5

How to search
on website



By
Type

Search on MISUMI official website

E-NTBG

By
Keyword

Step 1 Search on MISUMI official website

bearing with rod

Step 2 Select MISUMI economy series brand

☐ MISUMI ☒ MISUMI economy

Item	MISUMI standard product	MISUMI Economy series
Requirements	High precision (Radial runout suppression is highly required)	Medium precision Without Radial runout requirements
Bearing Inner Hole Precision	Class P0	+0.005 -0.015
Used Bearing	Japanese Brands (Radial Runout 3~13μm)*	Customized Chinese Brand (Radial runout 8~23μm)*

*Radial runout is a reference value, not guaranteed value.



Example

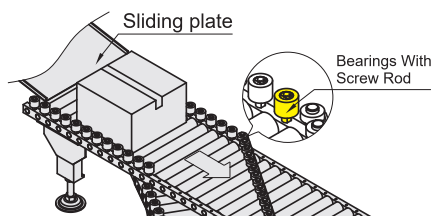

Mechanism Name: Auxiliary device for workpiece transfer

Mechanism Function:

Continuous transfer and transportation of workpieces through rollers and other transfer parts.

Application of Bearings With Screw Rod:

As an auxiliary transfer device, there is no need to purchase cantilever pins separately and its installation is simple.

MISUMI contact

Tel: 038-959200 or 1382
Email: cs@misumi.co.th

MISUMI WEB "Chat"



Install MISUMI APP



8
Flat Belts / Rollers /
Cam Followers

Flat Belt
Pulleys

P.699

Flat Belt

P.705

Urethane
Molded Rollers

P.711

Ball Rollers

P.717

Cam
Followers

P.725

Roller
Followers

P.735

Silicon Bearings
Threaded Bearings

P.737