

Chains /  
Sprockets

**P.621**

Pitch 6.35

Link Pitch 6.35



Nominal No. 25 / Joint Link  
P.623~P.624

Pitch 9.525

Link Pitch 9.525

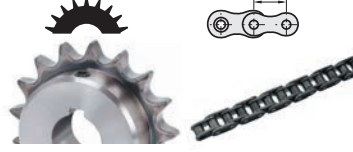

Nominal No. 35 / Joint Link  
P.625~P.626

Pitch 12.7

Link Pitch 12.7



Nominal No. 40 / Joint Link  
P.627~P.628

Pitch 25.4

Link Pitch 25.4

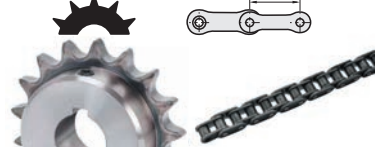

Nominal No. 80 / Joint Link  
P.629~P.630

Pitch 9.525

Link Pitch 9.525



Nominal No. 06B / Joint Link  
P.631~P.632

Pitch 12.7

Link Pitch 12.7

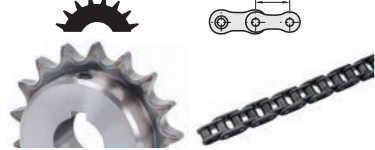

Nominal No. 08B / Joint Link  
P.633~P.634

Pitch 15.875

Link Pitch 15.875

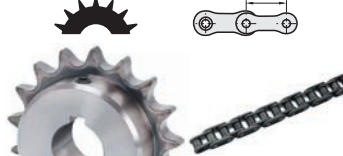

Nominal No. 10B / Joint Link  
P.635~P.636

Pitch 25.4

Link Pitch 25.4

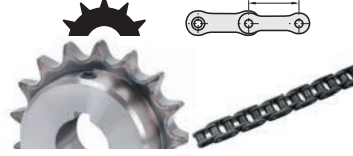

Nominal No. 16B / Joint Link  
P.637~P.638

Pitch 31.75

Link Pitch 31.75

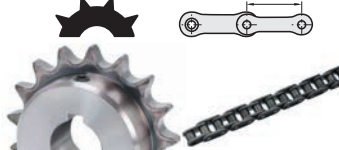

Nominal No. 20B / Joint Link  
P.639~P.640

**Chains With Attachments**

**Japanese Standard Type 40 / 50 / 60**

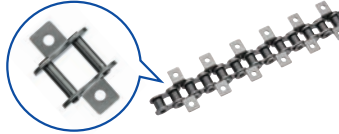

Japanese Standard Type / Joint Link  
P.641

**European Standard Type 06B / 08B / 10B**

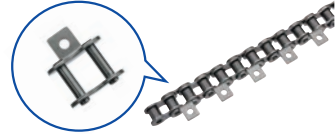

European Standard Type / Joint Link  
P.642

**P.641**

# Chain Conveyors

Application Industries: **Automotive part** **Electronic & Electrical**

This figure is a case of a chain conveying device using a combination of flat profiles and chain drives to achieve high versatility.

The classic chain drive unit is widely used in all types of conveyor & conveyor line equipment and can cope with harsh environmental conditions.

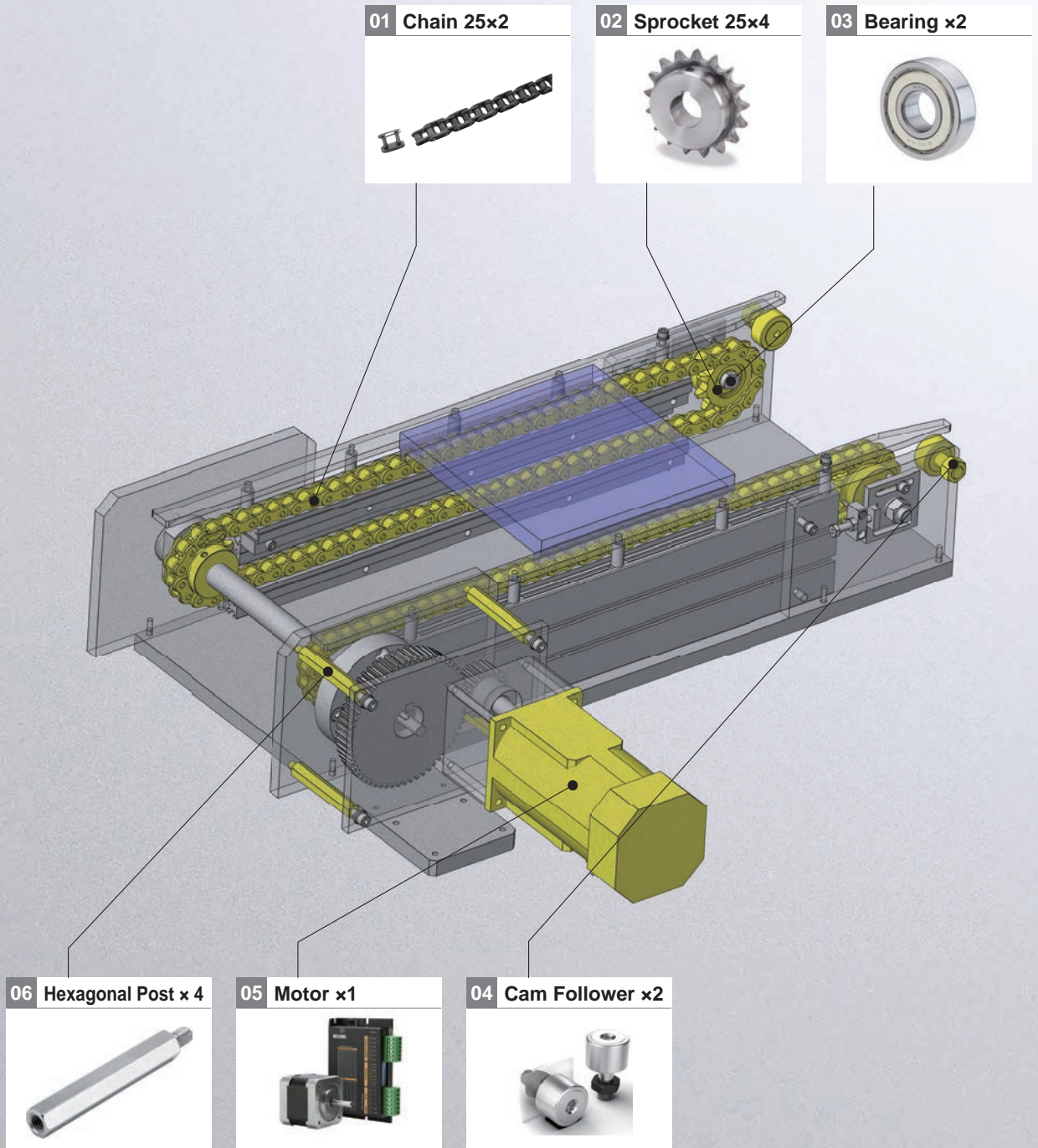



**01 Chain 25x2 P.624**



Fixed number of links  
Number of Links 240  
C-CHE25-240

**174**  
THB/pcs

Quantity	Unit price	Total price
1	174	174
<b>10</b>	<b>148</b>	<b>1,480</b>

**02 Sprocket 25x4 P.623**



Number of Teeth 17  
Shaft Dia. 9mm  
C-SPA25B17-S-9

**162**  
THB/pcs

Quantity	Unit price	Total price
2	162	324
<b>10</b>	<b>138</b>	<b>1,380</b>

**03 Bearing x2 P.650**



I.D. 8mm  
O.D. 16mm  
Width 5mm  
C-E688ZZ

**35**  
THB/pcs

Quantity	Unit price	Total price
1	35	35
<b>30</b>	<b>29</b>	<b>870</b>

**04 Cam Follower x2 P.729**



Outer Ring Shape Arc Type  
Hexagon Socket Mounting Type  
Roller O.D. D 32mm  
C-CUA12-32

**317**  
THB/pcs

Quantity	Unit price	Total price
1	317	317
<b>4</b>	<b>269</b>	<b>1,076</b>

**05 Motor x1 P.494**



Type Motor + Driver 20 Series  
Body Length 33mm  
Number of Leads 4  
Holding Torque 0.018N·m  
C-20STM01+DR42A

**2,086**  
THB/pcs

Quantity	Unit price	Total price
1	2,086	2,086
<b>4</b>	<b>1,773</b>	<b>7,092</b>

**06 Hexagonal Post x 4 P.940**



Opposite Distance 10mm  
Length 50mm  
C-PLSBWRK10-50

**45**  
THB/pcs

Quantity	Unit price	Total price
1	45	45
<b>30</b>	<b>38</b>	<b>1,140</b>

\* All products prices are without tax. The prices on the official website shall prevail.

## Economy Series Sprockets / Chains

vs Standard Type  
**Saving up to 91%**

- 12 categories of Japanese Standard Type and European Standard Type
- More assured with complete set purchase
- Joint links can be purchased separately for high flexibility

### Customer Voice



Customer

We purchased a set of 3/8" sprockets from company A and a set of 3/8" chains from company B, but the engineer said they could not be installed due to mismatch. Later it was found that the chain pins were too short and the width was less than 5.7, so the sprocket teeth failed to snap in. We had to go back to the market to find matchable products, and it took 3 days, which was very time-consuming and labor intensive.

Customer Service

At MISUMI, you can purchase complete sets of 06B sprockets/ chains, eliminating the mismatch problem, and you can use them directly upon arrival.



### MISUMI Economy series sprockets / chains with 9 categories of European standard type and Japanese standard type are available to meet your design needs

#### European standard type (5 series)

	Nominal Model	06B	08B	10B	16B	20B
<b>Sprocket</b>	Number of Teeth	10~30	10~30	10~25	11~25	9~20
<b>Chain</b>	Number of links	4 and more links are customizable				

#### Japanese standard type (4 series)

	Nominal Model	25	35	40	80
<b>Sprocket</b>	Number of Teeth	16~40	9~40	9~40	9~21
<b>Chain</b>	Number of links	4 and more links are customizable			

MISUMI Economy series sprockets and chains with the same nominal number can be used in combination.

### Difference in performance & specifications between Economy series and generic products on the market

	MISUMI standard product	MISUMI Economy series	Generic products on the market *
Sprocket Hardness	HRC45	HRC40	HRC20
Life Conversion of Sprocket	Over 3 years	Over 2 years	Over 1 years
Chain Roller Hardness	HRA75	HRA68	HRA42
Chain Tensile Strength (GB Reference 8.9KN)	12.5KN	9.3KN	7.4KN
Specification Model	Only Japanese standard type 25~100	Japanese Standard 25~80 European Standard 06B~20B	Only European standard type 06B~08B

\* Economy series product is different in strength compared to the standard product, and at the same time the price drops significantly

\* Products circulating on the market are similar products randomly purchased by our company from online or offline markets

\* The test data are obtained through testing by our company, which are for reference only

### Sprocket Strength Comparison



\* Generic products on the market, which make customers confused on usage



### Sprocket and chain fit comparison (Fit tolerance 0.03 to 0.08 means smooth fit)

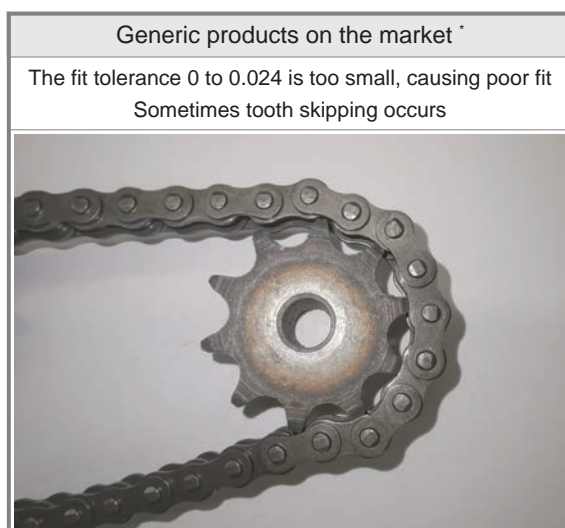

\* Cases of poor quality of products circulating on the market

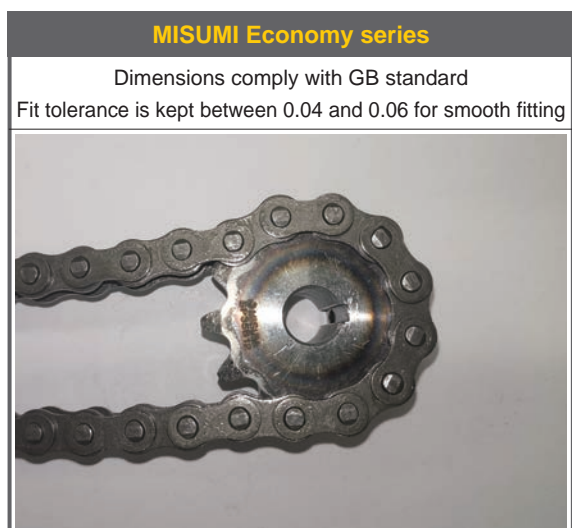

Representative model: C-SPA25B17-S-9

Save Up to **30%** vs Standard Type

Shipping from **1 day**



Link Pitch 6.35

# 162 THB

Volume Discount

Quantity	2~9	10~14	15~
Discount	Unit Price	15%	30%



Shipping days may differ by Quantity.  
Quantity of volume discount above is for representative Part No. It may differ by the Part.

Shaft Hole Machining Size Table

Shaft Hole Diameter D	Keyway b2x t2	Fixing Screw M
10	3x1.4	4
10K-12	4x1.8	5
15	5x2.3	6

This series is ISO Standard 04C sprocket  
 Process issue: There is no guarantee that the tooth tip of multiple products is consistent with each other  
 Offset between tooth top and keyway ±0.5mm  
 \* For keyway size, refer to GB/T 1095

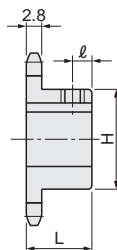
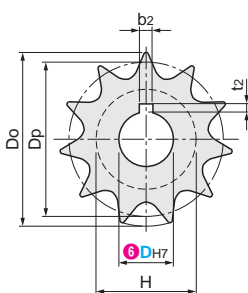

Shaft Hole Specifications **S** (Through Hole)

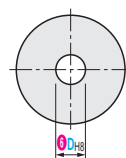

Shaft Hole Specifications **N** (New JIS key+Threaded Hole)

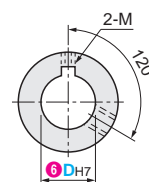

Material: S45C Equivalent  
 Attachments: Set Screw (Only Shaft Hole Specifications N)

Part Number				5 Hole Specifications	6 Shaft Hole Diameter (D)		Dp	Do	H	L	l		
1 Type	2 Nominal Model	3 Hub Type	4 Number of Teeth (T)		S Specifications (H8)	N Specifications (H7)							
C-SPA	25	B	16	S N	9	10K 12	32.55	36	25	15	6		
			17			10 12	34.56	38					
			18			12	36.57	40					
			19			12	38.58	42	28				
			20			10	40.59	44					
			21				42.61	46					
			22			15	44.62	48	30				
			25			12 15	50.66	54	35				
			32				64.78	68	40			20	8
			35			10	70.84	74					

Please visit MISUMI website for details of the models available for sale.

Ordering Example

Please order after selecting part number and parameters according to the selection steps 1 to 6.

Part Number (1 Type · 2 Nominal Model · 3 Hub Type · 4 Number of Teeth) - 6 Shaft Hole Diameter  
**C-SPA25B17** - **S** - **9**

How to search on website

By Type  
 Search on MISUMI official website

By Keyword  
 Step 1 Search on MISUMI official website

Step 2 Select MISUMI economy series brand  
 MISUMI  MISUMI economy

MISUMI contact

Tel: 038-959200 or 1382  
 Email: cs@misumi.co.th

MISUMI WEB "Chat"



Install MISUMI APP



Representative model: C-CHE25-240

Save Up to **77%**  
vs Standard Type

Shipping from **1 day**



Link Pitch 6.35

**174** THB

Volume Discount

Quantity	1~9	10~14	15~
Discount	Unit Price	15%	30%



Shipping days may differ by Quantity.  
 Quantity of volume discount above is for representative Part No. It may differ by the Part.

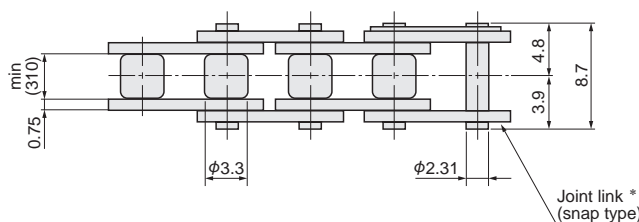
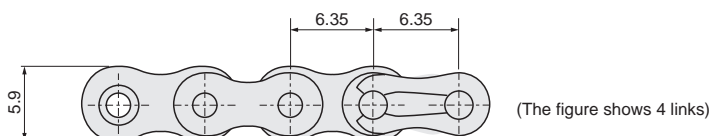

\* Joint links are provided and needed to be installed by yourself.  
\* Joints can also be purchased separately. Search "Joint Link" on the official website.

Material: Steel

### ■ Sprocket and Chain Selection

This series is ISO Standard 04C (ANSI25) roller chain, which can be used in combination with our 25B series sprocket. Do not use in combination with 04B series sprocket, which may cause the chain sprocket mechanism to fail to function properly! Please choose joint links nominal No. 25.

① Type	② Number of links		Allowable Maximum Tension (kN)
	Specified Type	Fixed Type	
C-CHE25	4~9998 (2-link increments)	240 links (circumference length 1,524mm)	0.64

Chains with specified number of links are not available for sale for the time being.

**Ordering Example** Please order after selecting part number and parameters according to the selection steps ① to ②.

Part Number (① Type) - ② Number of links  
C-CHE25 - 240

**How to search on website**

By Type: Search on MISUMI official website  
C-CHE25

By Keyword: Step 1 ▶ Search on MISUMI official website  
chain 25

Step 2 ▶ Select MISUMI economy series brand  
 MISUMI  MISUMI economy

**MISUMI contact**  
Tel: 038-959200 or 1382  
Email: cs@misumi.co.th

**MISUMI WEB "Chat"**

**Install MISUMI APP**



Representative model: C-SPA35B9-S-8



Link Pitch 9.525

Save Up to **30%** vs Standard Type

# 245

# THB



Volume Discount

Quantity	2~3	4~5	6~
Discount	Unit Price	15%	30%



Shipping days may differ by Quantity.  
Quantity of volume discount above is for representative Part No. It may differ by the Part.

Shaft Hole Machining Size Table

Shaft Hole Diameter D	Keyway b×t×2	Fixing Screw M
10	3×1.4	4
10K-12	4×1.8	5
14-17	5×2.3	6
18-22	6×2.8	6
24-30	8×3.3	8

This series is ISO Standard 06C sprocket, which cannot be used in combination with 06B chain.

Process issue: There is no guarantee that the tooth tip of multiple products is consistent with each other

Offset between tooth top and keyway ±0.5mm

\*For keyway size, refer to GB/T 1095

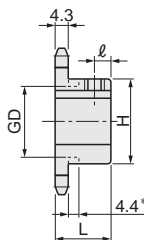
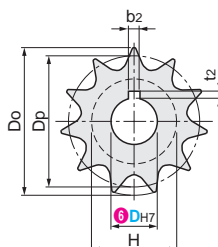

Shaft Hole Specifications **S** (Through Hole)

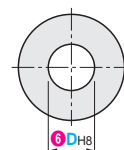

Shaft Hole Specifications **N** (New JIS key+Threaded Hole)

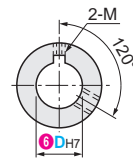

Material: S45C Equivalent (Teeth Tip: Induction hardening)  
Attachments: Set Screw (Only Shaft Hole Specifications N)

Part Number				5 Hole Specifications	6 Shaft Hole Diameter (D)		Dp	Do	H	GD	L	ℓ
1 Type	2 Nominal Model	3 Hub Type	4 Number of Teeth (T)		S Specifications (H8)	N Specifications (H7)						
C-SPA	35	B	9	S N	8	10	27.85	32	21.5	17	20	6
			10			10 12	30.82	34	24.5	20		
			11			12	33.81	38	27	23		
			12		10 12 14 15 16 17	36.8	41	30.5	26			
			13		12 15	39.8	44	32	29			
			14		12 14 15 17	42.81	47	35	20			
			15		10 12 14 15 16 17 18 19 20	45.81	51	35	20			
			16		12 15 18 20	48.82	54	37	20			
			17		15 20	51.84	57	41	20			
			18		15	54.85	60	44	20			
			20		12 15 16 20 25	60.89	66	50	20			
			21		28	63.91	69	53	20			
			22		12	66.93	72	56	20			
			24		15	72.97	78	53	22			
			32		15	97.18	102	53	8			

If 10K is selected, the shaft hole diameter is φ10 and the keyway width is 4mm (height 1.8mm).

Please visit MISUMI website for details of the models available for sale.

Ordering Example

Please order after selecting part number and parameters according to the selection steps 1 to 6.

Part Number (1)Type · (2)Nominal Model · (3)Hub Type · (4)Number of Teeth - (5)Hole Specifications - (6)Shaft Hole Diameter  
C-SPA35B9 - S - 8

How to search on website



By Type Search on MISUMI official website  
C-SPA

By Keyword Step 1 Search on MISUMI official website  
sprocket 35

Step 2 Select MISUMI economy series brand  
 MISUMI  MISUMI economy

MISUMI contact

Tel: 038-959200 or 1382  
Email: cs@misumi.co.th

MISUMI WEB "Chat"



Install MISUMI APP



Representative model: C-CHE35-160

Save Up to **58%**  
vs Standard Type

Shipping from **1 day**



Link Pitch 9.525

## 299

THB

Volume Discount

Quantity	1~3	4~5	6~
Discount	Unit Price	15%	30%



\* Shipping days may differ by Quantity.  
\* Quantity of volume discount above is for representative Part No. It may differ by the Part.

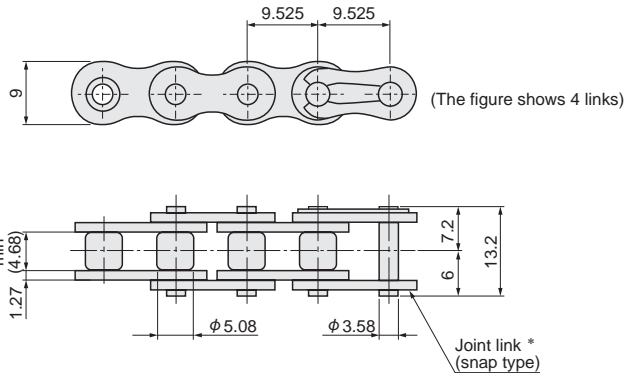

\* Joint links are provided and needed to be installed by yourself.  
\* Joints can also be purchased separately. Search "Joint Link" on the official website.

Material: Steel

### ■ Sprocket and Chain Selection

This series is ISO Standard 06C (ANSI 35) roller chain, and can be used in combination with our 35B series sprocket. Do not use in combination with 06B series sprocket, which may cause the chain sprocket mechanism to fail to function properly! Please choose joint links nominal No. 35.

① Type	② Number of links		Allowable Maximum Tension (kN)
	Specified Type	Fixed Type	
C-CHE35	4~9998 (2-link increments)	160 links (circumference length 1,524mm)	2.16

Please order after selecting part number and parameters according to the selection steps ① to ②.

**Ordering Example**  
Part Number (① Type) - ② Number of links  
C-CHE35 - 160

How to search on website

By Type  
Search on MISUMI official website  
C-CHE35

By Keyword  
Step 1 ▶ Search on MISUMI official website  
Step 2 ▶ Select MISUMI economy series brand  
chain 35

MISUMI  MISUMI economy

### MISUMI contact

Tel: 038-959200 or 1382  
Email: cs@misumi.co.th

### MISUMI WEB "Chat"



### Install MISUMI APP



Representative model: C-SPA40B9-S-9



Link Pitch 12.7

Save Up to **30%** vs Standard Type

# 231

# THB



Volume Discount

Quantity	2~3	4~5	6~
Discount	Unit Price	15%	30%



Shipping days may differ by Quantity.  
Quantity of volume discount above is for representative Part No. It may differ by the Part.

Shaft Hole Machining Size Table

Shaft Hole Diameter D	Keyway b2xt2	Fixing Screw M
10-12	4x1.8	5
14-17	5x2.3	6
18-22	6x2.8	6
24-30	8x3.3	8

This series is ISO Standard 08A sprocket, which cannot be used in combination with 08B chain.

Process issue: There is no guarantee that the tooth tip of multiple products is consistent with each other

Offset between tooth top and keyway ±0.5mm

\* For keyway size, refer to GB/T 1095

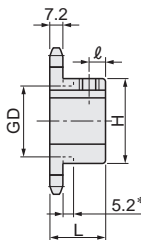
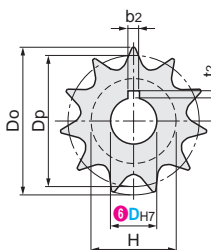

Shaft Hole Specifications **S** (Through Hole)

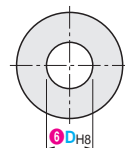

Shaft Hole Specifications **N** (New JIS key+Threaded Hole)

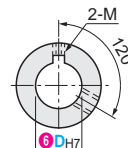

Material: S45C Equivalent (Teeth Tip: Induction hardening)  
Attachments: Set Screw (Only Shaft Hole Specifications N)

Part Number				5 Hole Specifications	6 Shaft Hole Diameter (D)		Dp	Do	H	GD	L	l
1 Type	2 Nominal Model	3 Hub Type	4 Number of Teeth (T)		S Specifications (H8)	N Specifications (H7)						
C-SPA	40	B	9	S N	9	12	37.13	42	28	23	-	-
			10			12 15 17	41.1	46	32	27		
			11		10	12 15 18 20	45.08	51	36	31		
			12			12 15 18 20 22	49.07	55	40	35		
			13		12	12 15 16 18 20 22	53.07	59	37	22		
			14			12 15 18 20 22 25	57.07	63	42			
			15		13	12 15 17 18 20 22 25 28	61.08	67	46	6		
			16			15 20 25 28	65.1	71	50			
			17		14	15 18 25 30	69.12	76	54	7		
			18			20 25	73.14	80	57			
			19		14	20 25	77.16	84	62	63		
			20			15 20 25 30	81.18	88	67			
			22		14	25	89.24	96	75	25		
			24			20	97.3	104	79			
			25		14	25	101.33	108	83	7		
			26			20	105.36	112	87			
			30		14	25 30	121.5	128	118	-		
			30			25 30	121.5	128	128			

Please visit MISUMI website for details of the models available for sale.

Ordering Example

Please order after selecting part number and parameters according to the selection steps 1 to 6.

Part Number (1 Type · 2 Nominal Model · 3 Hub Type · 4 Number of Teeth) - 5 Hole Specifications - 6 Shaft Hole Diameter  
C-SPA40B9 - S - 9

How to search on website



By Type

Search on MISUMI official website

C-SPA



By Keyword

Step 1 Search on MISUMI official website

sprocket 40



Step 2 Select MISUMI economy series brand

MISUMI



MISUMI economy

MISUMI contact

Tel: 038-959200 or 1382  
Email: cs@misumi.co.th

MISUMI WEB "Chat"



Install MISUMI APP



Representative model: C-CHE40-120

Save Up to **52%**  
vs Standard Type

Shipping from **1 day**



Link Pitch 12.7

**310 THB**

Volume Discount

Quantity	1~3	4~5	6~
Discount	Unit Price	15%	30%



Shipping days may differ by Quantity.  
 Quantity of volume discount above is for representative Part No. It may differ by the Part.

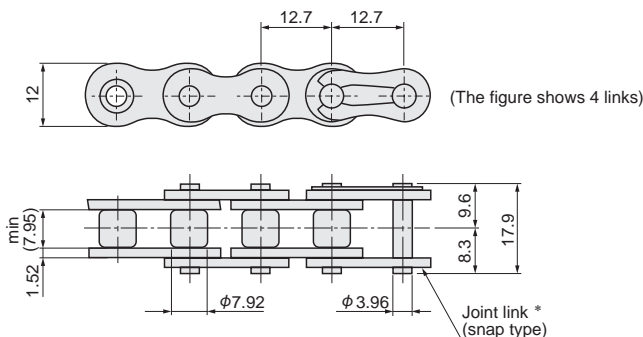

\* Joint links are provided and needed to be installed by yourself.

\* Joints can also be purchased separately. Search "Joint Link" on the official website.

Material: Steel

### ■ Sprocket and Chain Selection

This series is ISO Standard 08A (ANSI 40) roller chain, and can be used in combination with our 40B series sprocket.

Do not use in combination with 08B series sprocket, which may cause the chain sprocket mechanism to fail to function properly!

Please choose joint links nominal No. 40.

① Type	② Number of links		Allowable Maximum Tension (kN)
	Specified Type	Fixed Type	
C-CHE40	4~9998 (2-link increments)	120 links (circumference length 1,524mm)	3.63

**Ordering Example** Please order after selecting part number and parameters according to the selection steps ① to ②.

Part Number (① Type) - ② Number of links  
C-CHE40 - 120

How to search on website



By Type

Search on MISUMI official website

C-CHE40



By Keyword

Step 1 ▶ Search on MISUMI official website

chain 40



Step 2 ▶ Select MISUMI economy series brand

MISUMI



### MISUMI contact

Tel: 038-959200 or 1382  
Email: cs@misumi.co.th

### MISUMI WEB "Chat"



### Install MISUMI APP





Representative model: C-SPA80B12-S-15



Link Pitch 25.4

Save Up to **30%** vs Standard Type

**1,176 THB**

Shipping from **1 day**

Volume Discount

Quantity	1~3	4~5	6~
Discount	Unit Price	15%	30%



Shipping days may differ by Quantity.  
Quantity of volume discount above is for representative Part No. It may differ by the Part.

Shaft Hole Machining Size Table

Shaft Hole Diameter D	Keyway bxt2	Fixing Screw M
25~30	8x3.3	8
32~38	10x3.3	8
40~42	12x3.3	8
45~50	14x3.8	10

This series is ISO Standard 16A sprocket, which cannot be used in combination with 16B chain.

Process issue: There is no guarantee that the tooth tip of multiple products is consistent with each other

Offset between tooth top and keyway ±0.5mm  
\* For keyway size, refer to GB/T 1095

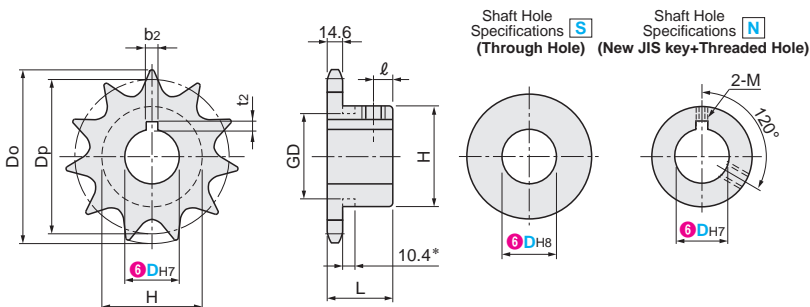

Shaft Hole Specifications **S** (Through Hole) Shaft Hole Specifications **N** (New JIS key+Threaded Hole)

Material: S45C Equivalent (Teeth Tip: Induction hardening)  
Attachments: Set Screw (Only Shaft Hole Specifications N)

Part Number				Hole Specifications	Shaft Hole Diameter (D)		Dp	Do	H	L	l
Type	Nominal Model	Hub Type	Number of Teeth (T)		S Specifications (H8)	N Specifications (H7)					
C-SPA	80	B	12	S N	15	40	98.14	110	67	40	12
			14		16	25	114.15	127	77		
			15		20	50	122.17	135	93		
			16			25	130.2	143			
			17			50	138.23	151			
			20			35	162.37	176			

Please visit MISUMI website for details of the models available for sale.

Ordering Example

Please order after selecting part number and parameters according to the selection steps 1 to 6.

Part Number (1)Type · (2)Nominal Model · (3)Hub Type · (4)Number of Teeth) - (5)Hole Specifications - (6)Shaft Hole Diameter  
C-SPA80B12 - S - 15

How to search on website



By Type

Search on MISUMI official website

C-SPA



By Keyword

Step 1 Search on MISUMI official website

sprocket 80



Step 2 Select MISUMI economy series brand



MISUMI contact

Tel: 038-959200 or 1382  
Email: cs@misumi.co.th

MISUMI WEB "Chat"



Install MISUMI APP



Representative model: C-CHE80-60



Link Pitch 25.4

Save Up to **46%**  
vs Standard Type

**1,160** THB

**Shipping from 1 day**

Volume Discount

Quantity	1~3	4~5	6~
Discount	Unit Price	15%	30%



Shipping days may differ by Quantity.  
Quantity of volume discount above is for representative Part No. It may differ by the Part.

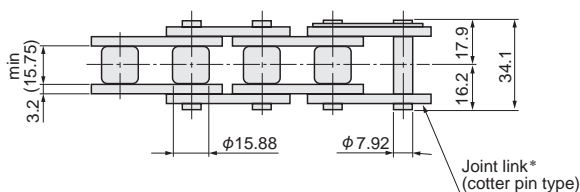
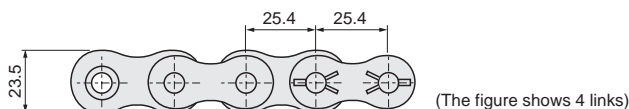

\* Joint links are provided and needed to be installed by yourself.  
\* Joints can also be purchased separately. Search "Joint Link" on the official website.

Material: Steel

### Sprocket and Chain Selection

This series is ISO Standard 16A (ANSI 80) roller chain, and can be used in combination with our 80B series sprocket. Do not use in combination with 16B series sprocket, which may cause the chain sprocket mechanism to fail to function properly! Please choose joint links nominal No. 80.

① Type	② Number of links		Allowable Maximum Tension (kN)
	Specified Type	Fixed Type	
C-CHE80	4~9998 (2-link increments)	60 links (circumference length 1,524mm)	14.71

Please order after selecting part number and parameters according to the selection steps ① to ②.

**Ordering Example**  
Part Number (① Type) - (② Number of links)  
C-CHE80 - 60

How to search on website



By Type  
Search on MISUMI official website  
C-CHE80

By Keyword  
Step 1 Search on MISUMI official website  
Step 2 Select MISUMI economy series brand  
chain 80



### MISUMI contact

Tel: 038-959200 or 1382  
Email: cs@misumi.co.th

### MISUMI WEB "Chat"



### Install MISUMI APP



Representative model: C-SPB06B10-S-8



Link Pitch 9.525

Save Up to **30%** vs Standard Type

# 175

# THB



Volume Discount

Quantity	2~3	4~5	6~
Discount	Unit Price	15%	30%



Shipping days may differ by Quantity.  
Quantity of volume discount above is for representative Part No. It may differ by the Part.

Shaft Hole Machining Size Table

Shaft Hole Diameter D	Keyway b2xzt2	Fixing Screw M
10	3x1.4	3
11-12	4x1.8	3
14-17	5x2.3	4
18-22	6x2.8	5
24-30	8x3.3	6

Do not use in combination with 06A chain.  
Process issue: There is no guarantee that the tooth tip of multiple products is consistent with each other.  
Offset between tooth top and keyway ±0.5mm  
\* For keyway size, refer to GB/T 1095

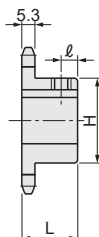
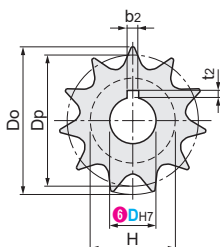

Shaft Hole Specifications **S** (Through Hole)

Shaft Hole Specifications **N** (New JIS key+Threaded Hole)

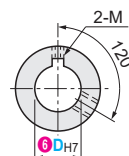
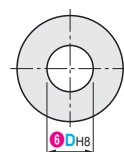

Material: S45C Equivalent (Teeth Tip: Induction hardening)  
Attachments: Set Screw (Only Shaft Hole Specifications N)

Part Number				5 Hole Specifications	6 Shaft Hole Diameter (D)					Dp	Do	H	L	l
1 Type	2 Nominal Model	3 Hub Type	4 Number of Teeth (T)		S Specifications (H8)	N Specifications (H7)								
C-SPB	06	B	10	S N	8	10 11 12	30.82	34.5	20	20	7	29	8	10
			11			14			26			30		
			12			15			31			31		
			13			16			26			30		
			14			17			29			34		
			15			18			30			34		
			16			19			30			34		
			18			20			25			34		
			19			21			25			34		
			20			22			25			34		
			21		23	25	34							
			22		24	25	34							
			23		25	25	34							
			25		26	25	34							
			25		27	25	34							
			25		28	25	34							
			25		29	25	34							
			25		30	25	34							
			25		31	25	34							
			25		32	25	34							

Please visit MISUMI website for details of the models available for sale.

Ordering Example

Please order after selecting part number and parameters according to the selection steps 1 to 6.

Part Number (1 Type · 2 Nominal Model · 3 Hub Type · 4 Number of Teeth) - 5 Hole Specifications - 6 Shaft Hole Diameter  
**C-SPB06B10 - S - 8**

How to search on website



By Type

Search on MISUMI official website

C-SPB



By Keyword

Step 1 Search on MISUMI official website

sprocket 06b



Step 2 Select MISUMI economy series brand

MISUMI



MISUMI contact

Tel: 038-959200 or 1382  
Email: cs@misumi.co.th

MISUMI WEB "Chat"



Install MISUMI APP



Representative model: C-CHE06B-160

Save Up to **58%**  
vs Standard Type

Shipping from **1 day**



Link Pitch 9.525

## 299

THB

Volume Discount

Quantity	1~3	4~5	6~
Discount	Unit Price	15%	30%



Shipping days may differ by Quantity.  
 Quantity of volume discount above is for representative Part No. It may differ by the Part.

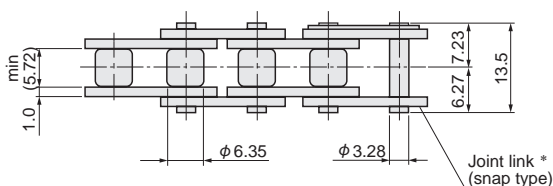
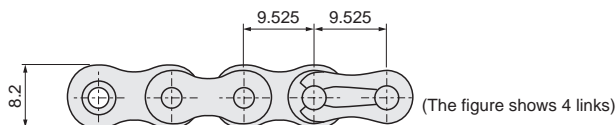

\* Joint links are provided and needed to be installed by yourself.  
\* Joints can also be purchased separately. Search "Joint Link" on the official website.

Material: Steel

### Sprocket and Chain Selection

This series is ISO Standard 06B roller chain, which can be used in combination with our 06B series sprocket. Do not use in combination with Japanese standard type or American standard type sprocket, which may cause the chain sprocket mechanism to fail to function properly! Please choose joint links nominal No. 06B.

① Type	② Number of links		Allowable Maximum Tension (kN)
	Specified Type	Fixed Type	
C-CHE06B	4~9998 (2-link increments)	160 links (circumference length 1,524mm)	1.93

Ordering Example

Please order after selecting part number and parameters according to the selection steps ① to ②.

Part Number (① Type) - ② Number of links  
C-CHE06B - 160

How to search on website



By Type

Search on MISUMI official website

C-CHE06B

By Keyword

Step 1 ▶ Search on MISUMI official website

chain 06b

Step 2 ▶ Select MISUMI economy series brand

MISUMI



### MISUMI contact

Tel: 038-959200 or 1382  
Email: cs@misumi.co.th

### MISUMI WEB "Chat"



### Install MISUMI APP





Representative model: C-SPB08B10-S-10



Link Pitch 12.7

Save Up to **30%** vs Standard Type

## 355

## THB



Volume Discount

Quantity	1~3	4~5	6~
Discount	Unit Price	15%	30%



Shipping days may differ by Quantity.  
Quantity of volume discount above is for representative Part No. It may differ by the Part.

Shaft Hole Machining Size Table

Shaft Hole Diameter D	Keyway b2x <sub>t</sub> z <sub>t</sub>	Fixing Screw M
10	3x1.4	3
12	4x1.8	3
14~17	5x2.3	4
18~22	6x2.8	5
24~30	8x3.3	6
35~38	10x3.3	8

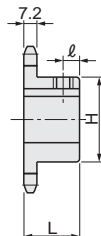
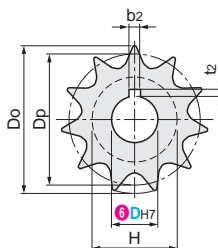

Shaft Hole Specifications **S** (Through Hole)

Shaft Hole Specifications **N** (New JIS key+Threaded Hole)

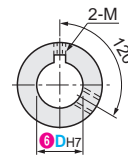
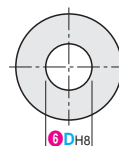

Do not use in combination with 08A chain.

Process issue: There is no guarantee that the tooth tip of multiple products is consistent with each other

Offset between tooth top and keyway ±0.5mm  
\* For keyway size, refer to GB/T 1095

Material: S45C Equivalent (Teeth Tip: Induction hardening)

Attachments: Set Screw (Only Shaft Hole Specifications N)

1 Type	2 Part Number		4 Number of Teeth (T)	5 Hole Specs.	6 Shaft Hole Diameter (D)		Dp	Do	H	L	ℓ
	Nominal Model	Hub Type			S Specifications (H8)	N Specifications (H7)					
C-SPB	08	B	10	S	N	12 14	41.1	45.9	26	25	8
			15 16								
			12 15								
			24								
			12 16 18 19 20								
			24								
			12 14 15 19 24								
			12 14 15 16 18 20 24 25								
			30								
			16 30								
			15 16 24 30								
			19 35								
			19 20 25 30								
			16 18 20 22 25 28 38								
			25 28 35								
			20 24 25								
25 28											
101.33	106.2	70	28	10							

Please visit MISUMI website for details of the models available for sale.

Ordering Example: Please order after selecting part number and parameters according to the selection steps 1 to 6.  
 Part Number (1) Type · (2) Nominal Model · (3) Hub Type · (4) Number of Teeth - (5) Hole Specifications - (6) Shaft Hole Diameter  
 C-SPB08B10 - S - 10

How to search on website

By Type: Search on MISUMI official website

By Keyword: Step 1 Search on MISUMI official website Step 2 Select MISUMI economy series brand   MISUMI  MISUMI economy

MISUMI contact

Tel: 038-959200 or 1382  
Email: cs@misumi.co.th

MISUMI WEB "Chat"



Install MISUMI APP



Representative model: C-CHE08B-120

Save Up to **49%**  
vs Standard Type

Shipping from **1 day**



Link Pitch 12.7

# 329

THB

Volume Discount

Quantity	1~3	4~5	6~
Discount	Unit Price	15%	30%



Shipping days may differ by Quantity.  
Quantity of volume discount above is for representative Part No. It may differ by the Part.

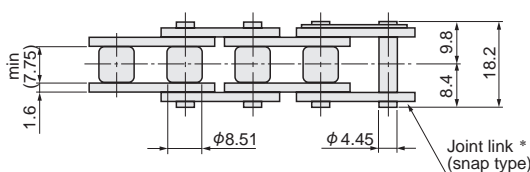
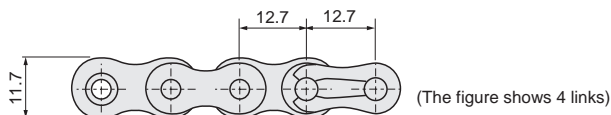

\* Joint links are provided and needed to be installed by yourself.  
\* Joints can also be purchased separately. Search "Joint Link" on the official website.

Material: Steel

### Sprocket and Chain Selection

This series is ISO Standard 08B roller chain, which can be used in combination with our 08B series sprocket. Do not use in combination with Japanese standard type or American standard type sprocket, which may cause the chain sprocket mechanism to fail to function properly! Please choose joint links nominal No. 08B.

① Type	② Number of links		Allowable Maximum Tension (kN)
	Specified Type	Fixed Type	
C-CHE08B	4~9998 (2-link increments)	120 links (circumference length 1,524mm)	3.76

Please order after selecting part number and parameters according to the selection steps ① to ②.

**Ordering Example**

Part Number (① Type) - ② Number of links  
C-CHE08B - 120

**How to search on website**

By Type: Search on MISUMI official website  
C-CHE08B

By Keyword: Step 1 Search on MISUMI official website Step 2 Select MISUMI economy series brand  
chain 08b

MISUMI  MISUMI economy

### MISUMI contact

Tel: 038-959200 or 1382  
Email: cs@misumi.co.th

### MISUMI WEB "Chat"



### Install MISUMI APP



Representative model: C-SPB10B10-S-10



Link Pitch 15.875

Save Up to **30%** vs Standard Type

**179**

THB



Volume Discount

Quantity	2~3	4~5	6~
Discount	Unit Price	15%	30%



Shipping days may differ by Quantity.  
Quantity of volume discount above is for representative Part No. It may differ by the Part.

Shaft Hole Machining Size Table

Shaft Hole Diameter D	Keyway b <sub>2</sub> x <sub>t</sub> 2	Fixing Screw M
12	4x1.8	3
14~17	5x2.3	4
18~22	6x2.8	5
24~30	8x3.3	6
32-35-38	10x3.3	8
40	12x3.3	10

Do not use in combination with 10A chain.  
Process issue: There is no guarantee that the tooth tip of multiple products is consistent with each other.  
Offset between tooth top and keyway ±0.5mm  
\* For keyway size, refer to GB/T 1095

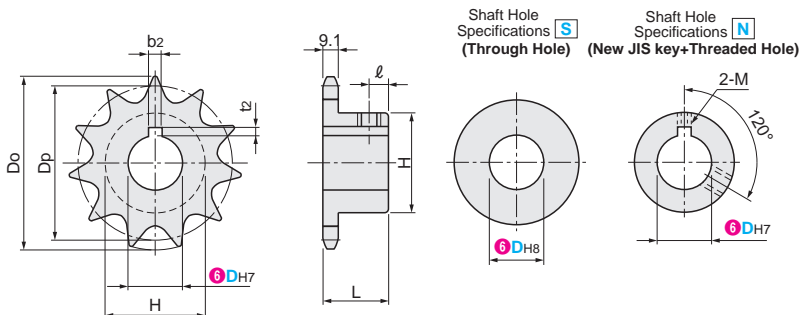

Material: S45C Equivalent (Teeth Tip: Induction hardening)  
Attachments: Set Screw (Only Shaft Hole Specifications N)

Part Number				Hole Specifications	Shaft Hole Diameter (D)					Dp	Do	H	L	ℓ	
Type	Nominal Model	Hub Type	Number of Teeth (T)		S Specifications (H8)	N Specifications (H7)									
C-SPB	10	B	10	S N	10	20					51.37	58.3	35	25	7
			12		12	15	19 20	28			61.34	68.2	42	30	10
			13			15 18	24	30	66.32	73.2	47				
			15			32			76.36	83.2	57				
			17		28 30			86.39	93.3	60					
			18		14	20 22	25	32 35 38	91.42	98.3	70				
			19			20	30	35 38 40	96.45	103.3	75				
			21			20 22 24	30	106.52	113.4	75					
			22		16	22	32 35			111.55	118.4	80			
			23			25			38 40	116.58	123.5				
			24			25	30	35	121.62	128.5					
			25			20				126.66	133.6				

Please visit MISUMI website for details of the models available for sale.

Ordering Example

Please order after selecting part number and parameters according to the selection steps 1 to 6.

Part Number (1)Type · (2)Nominal Model · (3)Hub Type · (4)Number of Teeth - (5)Hole Specifications - (6)Shaft Hole Diameter  
C-SPB10B10 - S - 10

How to search on website



By Type Search on MISUMI official website  
C-SPB

By Keyword Step 1 Search on MISUMI official website  
sprocket 10b

Step 2 Select MISUMI economy series brand  
 MISUMI  MISUMI economy

MISUMI contact

Tel: 038-959200 or 1382  
Email: cs@misumi.co.th

MISUMI WEB "Chat"



Install MISUMI APP



Representative model: C-CHE10B-96

Save Up to **45%**  
vs Standard Type

Shipping from **1 day**



Link Pitch 15.875

**455** THB

Volume Discount

Quantity	1~3	4~5	6~
Discount	Unit Price	15%	30%



Shipping days may differ by Quantity.  
 Quantity of volume discount above is for representative Part No. It may differ by the Part.

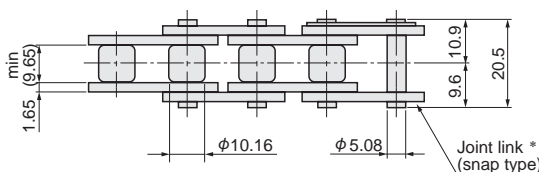
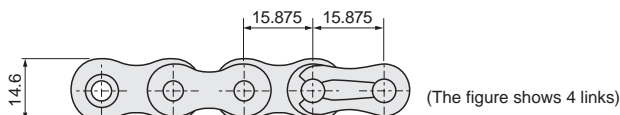

\* Joint links are provided and needed to be installed by yourself.  
\* Joints can also be purchased separately. Search "Joint Link" on the official website.  
\* The joint link snap type and cotter pin type are shipped randomly. Please be careful

Material: Steel

### ■ Sprocket and Chain Selection

This series is ISO Standard 10B roller chain, which can be used in combination with our 10B series sprocket. Do not use in combination with Japanese standard type or American standard type sprocket, which may cause the chain sprocket mechanism to fail to function properly! Please choose joint links nominal No. 10B.

1 Type	2 Number of links		Allowable Maximum Tension (kN)
	Specified Type	Fixed Type	
C-CHE10B	4-9998 (2-link increments)	96 links (circumference length 1,524mm)	4.5

Ordering Example

Please order after selecting part number and parameters according to the selection steps 1 to 2.

Part Number (1 Type) - Number of links  
C-CHE10B - 96

How to search on website



By Type

Search on MISUMI official website

C-CHE10B

By Keyword

Step 1 Search on MISUMI official website

chain 10b

Step 2 Select MISUMI economy series brand



### MISUMI contact

Tel: 038-959200 or 1382  
Email: cs@misumi.co.th

### MISUMI WEB "Chat"



### Install MISUMI APP





Representative model: C-SPB16B12-S-16



Link Pitch 25.4

Save Up to **64%** vs Standard Type

# 601

# THB



Volume Discount

Quantity	2~3	4~5	6~
Discount	Unit Price	15%	30%



Shipping days may differ by Quantity.  
Quantity of volume discount above is for representative Part No. It may differ by the Part.

Shaft Hole Machining Size Table

Shaft Hole Diameter D	Keyway b×t×2	Fixing Screw M
25-30	8×3.3	8
35-38	10×3.3	8
40	12×3.3	8
45-48-50	14×3.8	10

Do not use in combination with 16A chain.  
Process issue: There is no guarantee that the tooth tip of multiple products is consistent with each other.  
Offset between tooth top and keyway ±0.5mm  
\* For keyway size, refer to GB/T 1095

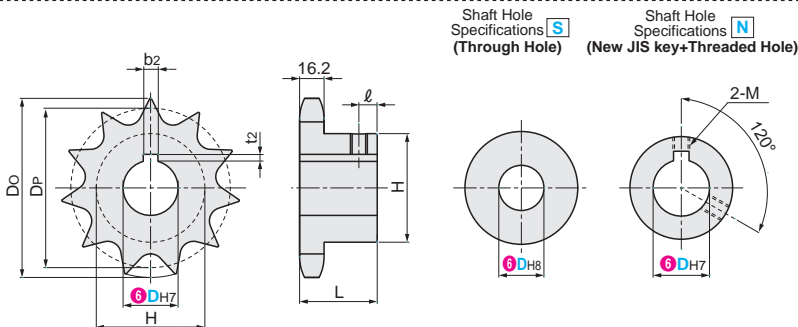

Shaft Hole Specifications **S** (Through Hole)

Shaft Hole Specifications **N** (New JIS key+Threaded Hole)

Material: S45C Equivalent (Teeth Tip: Induction hardening)  
Attachments: Set Screw (Only Shaft Hole Specifications N)

1 Type	2 Nominal Model	3 Hub Type	4 Number of Teeth (T)	5 Hole Specifications	6 Shaft Hole Diameter (D)		Dp	Do	H	L	l					
					S Specifications (H8)	N Specifications (H7)										
C-SPB	16	B	11	S N	16	25 30	90.14	101.7	61	40	12					
			12			25 30 35 38	98.14	109.7	69							
			13			35 38 45 48	106.12	117.7	78							
			14			50	114.15	125.7	84							
			15			40 45	122.17	133.7	92							
			16			25	130.2	141.8	100			45	14			
			18			35	146.28	157.8								
			19			38 45 48	154.33	165.9								
			22			35 40 45 48	178.48	190.1								
			24			35	194.59	206.2						110	50	16
			25			30 40 42 48	202.66	214.2								

Ordering Example

Please order after selecting part number and parameters according to the selection steps 1 to 6.

Part Number (1 Type · 2 Nominal Model · 3 Hub Type · 4 Number of Teeth) - (5 Hole Specifications) - (6 Shaft Hole Diameter)  
C-SPB16B12 - S - 16

How to search on website

By Type Search on MISUMI official website  
C-SPB

By Keyword Step 1 Search on MISUMI official website  
sprocket 16b

Step 2 Select MISUMI economy series brand  
 MISUMI  MISUMI economy

MISUMI contact

Tel: 038-959200 or 1382  
Email: cs@misumi.co.th

MISUMI WEB "Chat"



Install MISUMI APP



Representative model: C-CHE16B-60



Link Pitch 25.4

Save Up to **44%**  
vs Standard Type

**1,203 THB**



Volume Discount

Quantity	1~3	4~5	6~
Discount	Unit Price	15%	30%



Shipping days may differ by Quantity.  
Quantity of volume discount above is for representative Part No. It may differ by the Part.

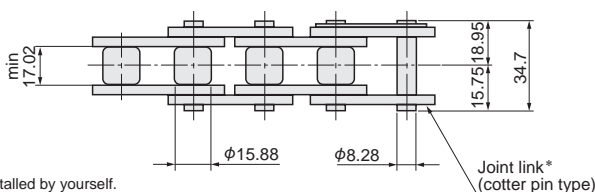
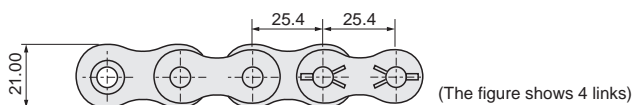

\* Joint links are provided and needed to be installed by yourself.  
\* Joints can also be purchased separately. Search "Joint Link" on the official website.  
\* The joint link snap type and cotter pin type are shipped randomly. Please be careful

Material: Steel

### Sprocket and Chain Selection

This series is ISO Standard 16B roller chain, which can be used in combination with our 16B series sprocket. Do not use in combination with Japanese standard type or American standard type sprocket, which may cause the chain sprocket mechanism to fail to function properly! Please choose joint links nominal No. 16B.

1 Type	2 Number of links		Allowable Maximum Tension (kN)
	Specified Type	Fixed Type	
C-CHE16B	4~9998 (2-link increments)	60 links (circumference length 1,524mm)	13.05

Please order after selecting part number and parameters according to the selection steps 1 to 2.

Ordering Example

Part Number (1 Type) - 2 Number of links  
C-CHE16B - 60

How to search on website

By Type: Search on MISUMI official website  
C-CHE16B

By Keyword: Step 1 Search on MISUMI official website Step 2 Select MISUMI economy series brand  
chain 16b

MISUMI  MISUMI economy

### MISUMI contact

Tel: 038-959200 or 1382  
Email: cs@misumi.co.th

### MISUMI WEB "Chat"



### Install MISUMI APP



Representative model: C-SPB20B12-S-20



Link Pitch 31.75

# 958

# THB



### Volume Discount

Quantity	2~3	4~5	6~
Discount	Unit Price	15%	30%



Shipping days may differ by Quantity.  
Quantity of volume discount above is for representative Part No. It may differ by the Part.

### Shaft Hole Machining Size Table

Shaft Hole Diameter D	Keyway b2xt2	Fixing Screw M
25-30	8x3.3	8
35	10x3.3	8
40	12x3.3	8
45-50	14x3.8	10

Do not use in combination with 20A series chain.  
Process issue: There is no guarantee that the tooth tip of multiple products is consistent with each other.  
Offset between tooth top and keyway ±0.5mm  
\* For keyway size, refer to GB/T 1095

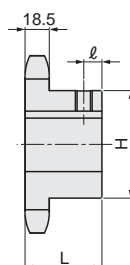
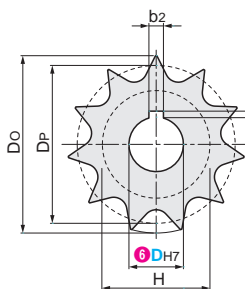

Shaft Hole Specifications **S** (Through Hole)

Shaft Hole Specifications **N** (New JIS key+Threaded Hole)

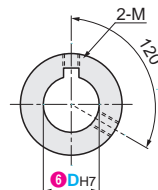
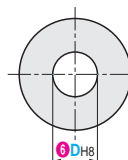

Material: S45C Equivalent (Teeth Tip: Induction hardening)  
Attachments: Set Screw (Only Shaft Hole Specifications N)

1 Type	2 Nominal Model	3 Hub Type	4 Number of Teeth (T)	5 Hole Specifications	6 Shaft Hole Diameter (D)		Dp	Do	H	L	ℓ
					S Specifications (H8)	N Specifications (H7)					
C-SPB	20	B	10	S N	20	25 30	102.74	117	70	40	10
			11			25 30	112.68	127	77	45	13
			12			30 35	122.68	137	88		
			13			30 35 40	132.65	147.5	98		
			14			35 40 45 50	142.68	157.6	108		
			15			40 45 50	152.72	167.7	118	120	50
			16			40 45 50	162.75	177.7			
			17			45 50	172.78	187.8			
			18			45 50	182.85	197.8			
			19			45 50	192.91	207.9			
			20			45 50	202.98	217.9			

### Ordering Example

Please order after selecting part number and parameters according to the selection steps 1 to 6.

Part Number (1 Type · 2 Nominal Model · 3 Hub Type · 4 Number of Teeth) - 5 Hole Specifications - 6 Shaft Hole Diameter  
**C-SPB20B12** - **S** - **20**

### How to search on website



By Type

Search on MISUMI official website

C-SPB

By Keyword

Step 1 ▶ Search on MISUMI official website

sprocket 20b

Step 2 ▶ Select MISUMI economy series brand



### MISUMI contact

Tel: 038-959200 or 1382  
Email: cs@misumi.co.th

### MISUMI WEB "Chat"



### Install MISUMI APP



Representative model: C-CHE20B-48



Link Pitch 31.75

# 1,709

# THB



### Volume Discount

Quantity	1~3	4~5	6~
Discount	Unit Price	15%	30%



Shipping days may differ by Quantity.  
Quantity of volume discount above is for representative Part No. It may differ by the Part.

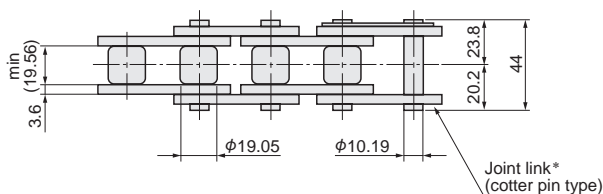
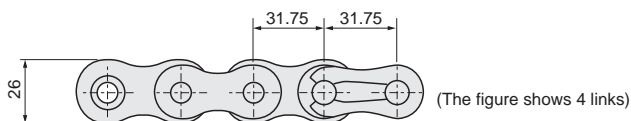

\* The snap type and cotter pin type joint links are shipped randomly. Please be careful.  
\* Joint links are provided and needed to be installed by yourself.  
\* Joints can also be purchased separately. Search "Joint Link" on the official website.

Material: Steel

### Sprocket and Chain Selection

This series is ISO Standard 20B roller chain, which can be used in combination with our 20B series sprocket. Do not use in combination with American standard type or Japanese standard type 20A series sprocket, which may cause the chain sprocket mechanism to fail to function properly! Please choose joint links nominal No. 20B.

Part Number ①Type	②Number of links		Allowable Maximum Tension (kN)
	Specified Type	Fixed Type	
C-CHE20B	4-9998 (2-link increments)	48 links (circumference length 1,524mm)	18.2

### Ordering Example

Please order after selecting part number and parameters according to the selection steps ① to ②.

Part Number (①Type) - ②Number of links  
C-CHE20B - 48

### How to search on website

By Type  
Search on MISUMI official website  
C-CHE20B

By Keyword  
Step 1 ▶ Search on MISUMI official website  
chain 20b

Step 2 ▶ Select MISUMI economy series brand  
 MISUMI  MISUMI economy

### MISUMI contact

Tel: 038-959200 or 1382  
Email: cs@misumi.co.th

### MISUMI WEB "Chat"



### Install MISUMI APP



Representative model: C-CHE50-96

Save Up to **83%** vs Standard Type

**817**

THB

Shipping from **1 day**

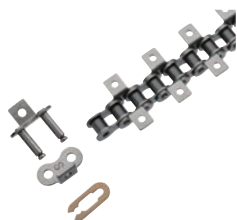

Chain No. 40 / 50 / 60



Volume Discount

Quantity	1~3	4~5	6~
Discount	Unit Price	15%	30%

Shipping days may differ by Quantity.  
Quantity of volume discount above is for representative Part No. It may differ by the Part.

With Attachments / One Side Type (Every Two Links)

**C-CHEL**

Joint Link

Type	Nominal Model
<b>E-JNT-L</b>	40
(One Side Type)	50
	60

With Attachments / Both Side Type (Every Two Links)

**C-CHE5**

Joint Link

Type	Nominal Model
<b>E-JNT-T</b>	40
(Both Side Type)	50
	60

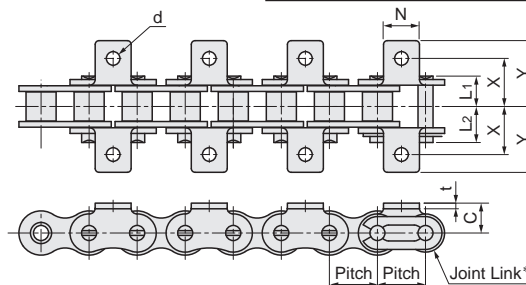
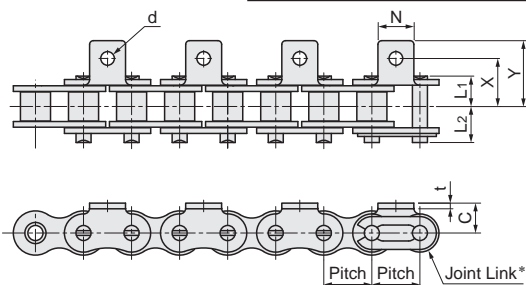

\* Joint links are provided and needed to be installed by yourself.  
\* Joints can also be purchased separately. Search "Joint Link" on the official website.

Material: Steel

Number of links of 1 chain

No.	Number of links of 1 chain
40	120 (circumference length 1,524mm)
50	96 (circumference length 1,524mm)
60	80 (circumference length 1520mm)

Sprocket and Chain Selection

This series is ISO Standard 08A / 10A / 12A / (ANSI 40/50/60) roller chain, which can be used in combination with our 40B / 50B / 60B series sprocket.

Do not use in combination with 08B / 10B / 12B sprocket, which may cause the chain sprocket mechanism to fail to function properly!

The conveyor belt chain with attachments can only be used for transmission, with an additional height difference of  $\pm 0.25\text{mm}$ .

Do not use for precise positioning and heavy load use.

Please choose joint link of corresponding to nominal model.

Part Number	Type	Nominal Model	Number of links	Pitch	Pin		Slab	Attachments				Allowable Maximum Tension kN (kgf)	
					L1	L2		t	C	X	Y		N
<b>C-CHEL</b> (One Side Type)		40	120	12.7	8.3	9.6	1.5	7.9	12.7	17.6	9.5	3.4	2.75(280)
		50	96	15.875	10.25	11.85	2	10.3	15.9	23.1	12.7	5.5	4.41(450)
<b>C-CHE5</b> (Both Side Type)		60	80	19.05	12.65	14.35	2.4	11.9	19.05	27.8	15.9	5.5	6.28(640)

Ordering Example

Please order after selecting part number and parameters according to the selection steps ① to ③.

Part Number (①Type - ②Nominal Model) - ③Number of links  
C-CHE50 - 96

How to search on website

By Type Search on MISUMI official website  
C-CHEL

By Keyword Step 1 Search on MISUMI official website  
chains with attachments

Step 2 Select MISUMI economy series brand  
MISUMI economy

MISUMI contact

Tel: 038-959200 or 1382  
Email: cs@misumi.co.th

MISUMI WEB "Chat"



Install MISUMI APP



Representative model: C-CHE06B-160

Save Up to **91%** vs Standard Type

**505**

THB

Shipping from **1 day**

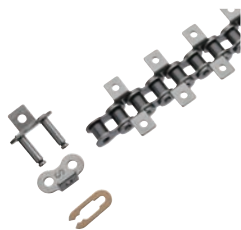

Chain No. 06B / 08B / 10B



### Volume Discount

Quantity	1~3	4~5	6~
Discount	Unit Price	15%	30%

Shipping days may differ by Quantity.  
Quantity of volume discount above is for representative Part No. It may differ by the Part.

With Attachments / One Side Type (Every Two Links)

### C-CHEL

#### Joint Link

Type	Nominal Model
E-JNT-L (One Side Type)	06B
	08B
	10B

With Attachments / Both Side Type (Every Two Links)

### C-CHE0

#### Joint Link

Type	Nominal Model
E-JNT-T (Both Side Type)	06B
	08B
	10B

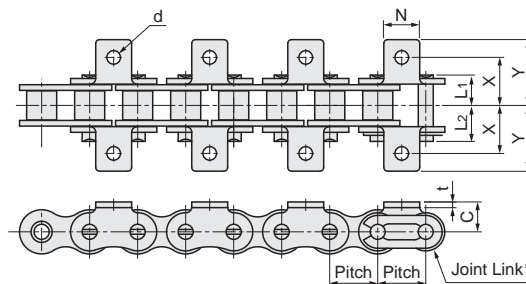
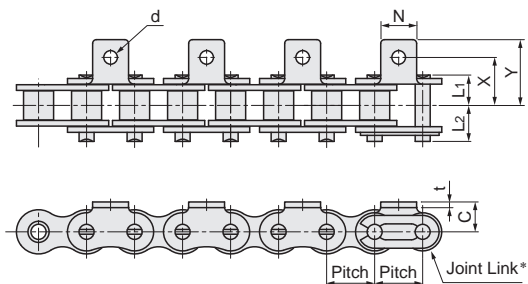

\* Joint links are provided and needed to be installed by yourself.  
\* Joints can also be purchased separately. Search "Joint Link" on the official website.

Material: Steel

#### Number of links of 1 chain

No.	Number of links of 1 chain
06B	160 (circumference length 1,524mm)
08B	120 (circumference length 1,524mm)
10B	96 (circumference length 1,524mm)

#### Sprocket and Chain Selection

This series is ISO Standard 06B / 08B / 10B roller chain, which can be used in combination with our 06B / 08B / 10B series sprocket.

Do not use in combination with 06A / 08A / 10A sprocket, which may cause the chain sprocket mechanism to fail to function properly!

The conveyor belt chain with attachments can only be used for transmission, with an additional height difference of  $\pm 0.25$ mm.

Do not use for precise positioning and heavy load use.

Please choose joint link of corresponding to nominal model.

Part Number	Type	Nominal Model	Number of links	Pitch	Pin		Slab	Attachments					Allowable Maximum Tension kN (kgf)
					L1	L2		t	C	X	Y	N	
C-CHEL (One SideType)	06B	06B	160	9.525	6.27	7.23	1.2	6.35	9.5	14.3	7.9	3.4	1.93(196)
			120	12.7	8.5	9.9	1.65	8.9	12.7	17.6	9.5	4.3	3.76(382)
C-CHE0 (Both SideType)	06B	06B	96	15.875	9.6	10.9	1.65	10.3	15.9	23.1	12.7	5.3	4.5(458)

#### Ordering Example

Please order after selecting part number and parameters according to the selection steps ① to ③.

Part Number (①Type - ②Nominal Model) - ③Number of links  
C-CHE06B - 160

#### How to search on website



By Type Search on MISUMI official website  
C-CHEL

By Keyword Step 1 Search on MISUMI official website  
chains with attachments

Step 2 Select MISUMI economy series brand



#### MISUMI contact

Tel: 038-959200 or 1382  
Email: cs@misumi.co.th

#### MISUMI WEB "Chat"



#### Install MISUMI APP

